

3

2011 043814

STATE OF INDIANA  
LAKE COUNTY  
FILED FOR RECORD

2011 AUG 16 AM 8:48

Mail tax bills to: David J. Hamater (Grantee)  
26729 Dunleith Ct  
Crete, IL 60417

MICROFILMED  
RECORDED

### QUIT CLAIM DEED

THIS INDENTURE WITNESSETH, that **Robert H. Sorge and Denise L. Sorge, Husband and Wife ("Grantors")** of Lake County, State of Indiana QUITCLAIM(s) all of Grantors' rights and interest in the real estate described below to **David J. Hamater ("Grantee")**, of Cook County in the State of Illinois, the following described real estate in Lake County, in the State of Indiana:

\*\*\*\*\* SEE ATTACHED LEGAL DESCRIPTIONS \*\*\*\*\*

Dated on this 5<sup>th</sup> day of August 2011

RAH  
Robert H. Sorge

Denise L. Sorge  
Denise L. Sorge

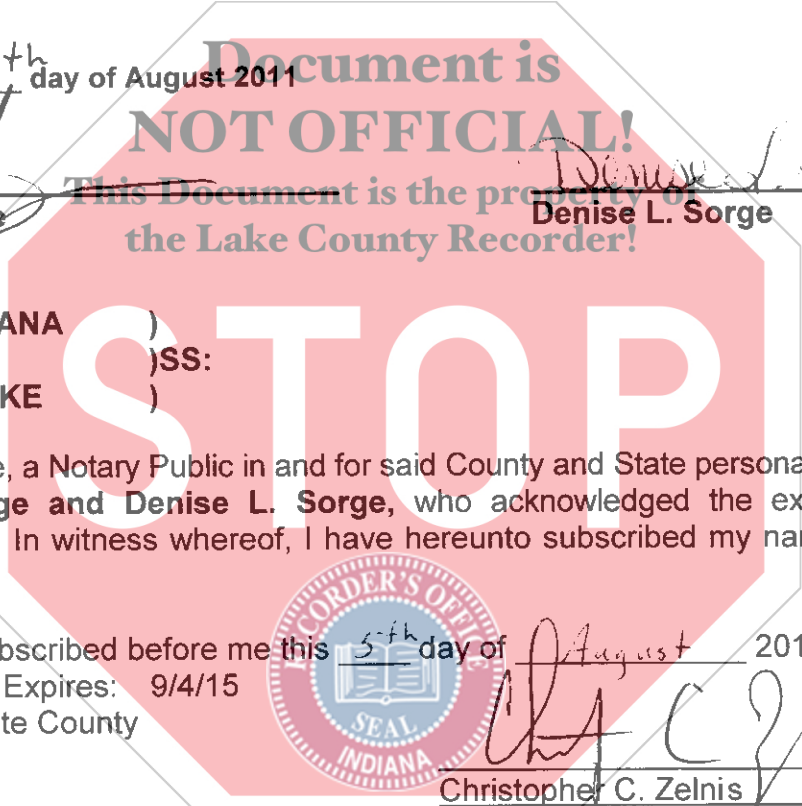

STATE OF INDIANA )  
)SS:  
COUNTY OF LAKE )

Before me, a Notary Public in and for said County and State personally appeared **Robert H. Sorge and Denise L. Sorge**, who acknowledged the execution of the foregoing deed. In witness whereof, I have hereunto subscribed my name and affixed my official seal.

Sworn to and subscribed before me this 5<sup>th</sup> day of August 2011.  
My Commission Expires: 9/4/15  
Resident of White County

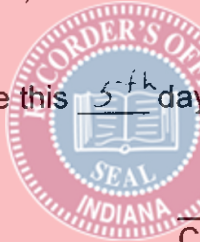

Christopher C. Zelnis  
/NOTARY PUBLIC

"I AFFIRM, UNDER THE PENALTIES FOR PERJURY, THAT I HAVE TAKEN REASONABLE CARE TO REDACT EACH SOCIAL SECURITY NUMBER IN THIS DOCUMENT, UNLESS REQUIRED BY LAW."

PREPARED BY: RAH

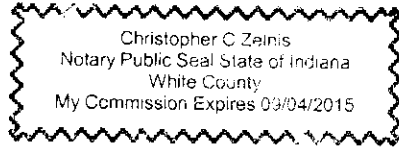

AMOUNT \$ 20<sup>00</sup>  
CASH \_\_\_\_\_ CHARGE \_\_\_\_\_  
CHECK # 7585  
OVERAGE \_\_\_\_\_  
COPY \_\_\_\_\_  
NON-COM \_\_\_\_\_  
CLERK RL JV

This Document Prepared By: Robert H. Sorge, 6243 Hohman Avenue, Hammond, IN 46324 Att. No. 17775-45.

DULY ENTERED FOR TAXATION SUBJECT  
FINAL ACCEPTANCE FOR TRANSFER

054830

AUG 16 2011

PEGGY HOLINGA KATONA  
LAKE COUNTY AUDITOR

**“ATTACHMENT”**

**Legal Description for Lots 6, & 10-15 and Outlot “A” Vine Court Meadows**

Lot 6 of Vine Court Meadows, L.L.C. (A Planned Unit Development) to the City of Hammond as per plat thereof, recorded in Plat Book 91, Page 5, in the office of the Recorder of lake County, Indiana.

**Tax Key No. 26-36-527-6**

**Commonly known as: 6618 Garfield Avenue, Hammond, Indiana 46324**

Lot 10 of Vine Court Meadows, L.L.C. (A Planned Unit Development) to the City of Hammond as per plat thereof, recorded in Plat Book 91, Page 5, in the office of the Recorder of lake County, Indiana.

**Tax Key No. 26-36-527-10**

**Commonly known as: 6615 Garfield Avenue, Hammond, Indiana 46324**

Lot 11 of Vine Court Meadows, L.L.C. (A Planned Unit Development) to the City of Hammond as per plat thereof, recorded in Plat Book 91, Page 5, in the office of the Recorder of lake County, Indiana.

**Tax Key No. 26-36-527-11**

**Commonly known as: 425 Vine Court, Hammond, Indiana 46324**

Lot 12 of Vine Court Meadows, L.L.C. (A Planned Unit Development) to the City of Hammond as per plat thereof, recorded in Plat Book 91, Page 5, in the office of the Recorder of lake County, Indiana.

**Tax Key No. 26-36-527-12**

**Commonly known as: 426 Vine Court, Hammond, Indiana 46324**

Lot 13 of Vine Court Meadows, L.L.C. (A Planned Unit Development) to the City of Hammond as per plat thereof, recorded in Plat Book 91, Page 5, in the office of the Recorder of lake County, Indiana.

**Tax Key No. 26-36-527-13**

**Commonly known as: 6635 Garfield, Hammond, Indiana 46324**

Lot 14 of Vine Court Meadows, L.L.C. (A Planned Unit Development) to the City of Hammond as per plat thereof, recorded in Plat Book 91, Page 5, in the office of the Recorder of lake County, Indiana.

**Tax Key No. 26-36-527-14**

**Commonly known as: 6641 Garfield, Hammond, Indiana 46324**

Lot 15 of Vine Court Meadows, L.L.C. (A Planned Unit Development) to the City of Hammond as per plat thereof, recorded in Plat Book 91, Page 5, in the office of the Recorder of lake County, Indiana.

**Tax Key No. 26-36-527-15**

**Commonly known as: 6647 Garfield, Hammond, Indiana 46324**

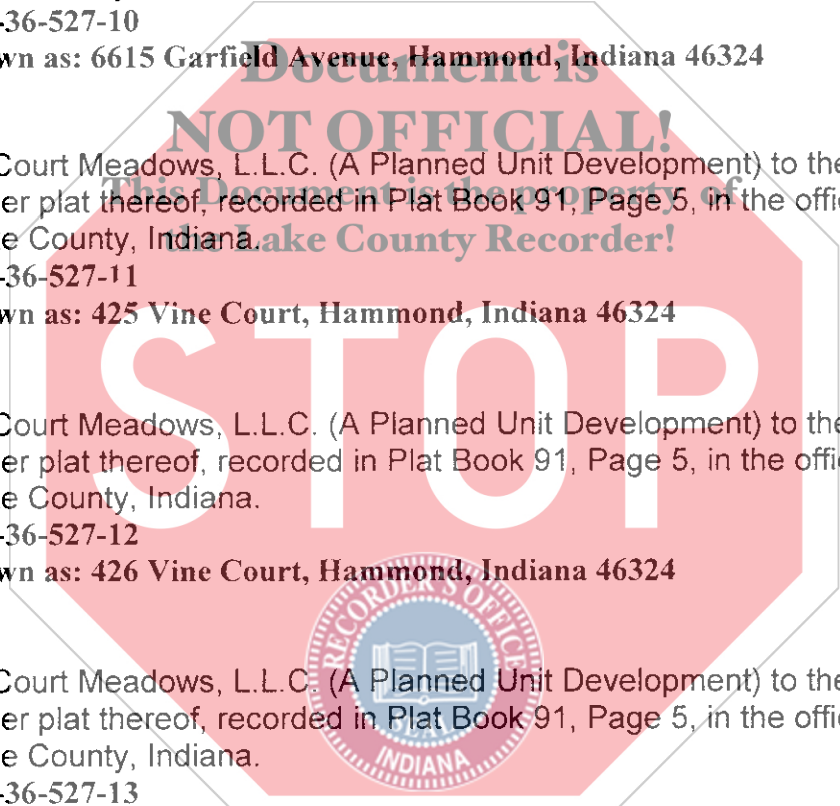

**“ATTACHMENT” CONTINUED**

Outlot “A” of Vine Court Meadows, L.L.C. (A Planned Unit Development) to the City of Hammond as per plat thereof, recorded in Plat Book 91, Page 5, in the office of the Recorder of lake County, Indiana.

**Tax Key No. 26-36-527-16**

**Commonly known as: 6644 Garfield, Hammond, Indiana 46324**

**Legal Description for Lots 1-3 of Aaron’s Park**

LOT 3 OF AARON’S PARK RESUBDIVISION OF KENWOOD ANNEX LOTS 27 THRU 33, BLOCK 1, ADDITION TO THE CITY OF HAMMOND

**Tax Key No: 45-06-01-331-016.000-023**

**Commonly known as: 6252 Hohman Ave, Hammond, Indiana 46324**

LOT 2 OF AARON’S PARK RESUBDIVISION OF KENWOOD ANNEX LOTS 27 THRU 33, BLOCK 1, ADDITION TO THE CITY OF HAMMOND

**Parcel No.: 45-06-01-331-015.000-023**

**Commonly known as: 6248 Hohman Ave, Hammond, Indiana 46324**

LOT 1 OF AARON’S PARK RESUBDIVISION OF KENWOOD ANNEX LOTS 27 THRU 33, BLOCK 1, ADDITION TO THE CITY OF HAMMOND

**Parcel No.: 45-06-01-331-014.000-023**

**Address: 6244 Hohman Ave, Hammond, Indiana 46324**

