

**Certificate of Release of
Federal Estate Tax Lien**

Area Office

Serial number

(For Optional Use by Recording Office)

SB/SE Area #7

I certify that the requirements of section 6325(a) of the Internal Revenue Code have been satisfied for the tax liability (including all statutory additions) shown below on the following-named estate, and that the lien for the tax and statutory additions has been released. The proper officer in the office where notice of internal revenue tax was filed on July 9, 2003, is authorized to note in the books the release of this lien, as far as it relates to the following. 2003 070680

Name of Estate Julia A. Miller

Qualified Heirs:
See Attachment, Page One

Name and address of agent designated by the qualified heirs for dealing with IRS

Lyle E. Miller
22509 Colfax Street
Lowell, IN 46356

Date of death

Decedent's social security number (SSN)

Amount of additional tax

04-14-2001

XXX-XX-4634V

\$ 209,903.00

Description of property to which lien attaches

Document is NOT OFFICIAL!
This Document is the property of the Lake County Recorder!
See Attached Property Description, Page One

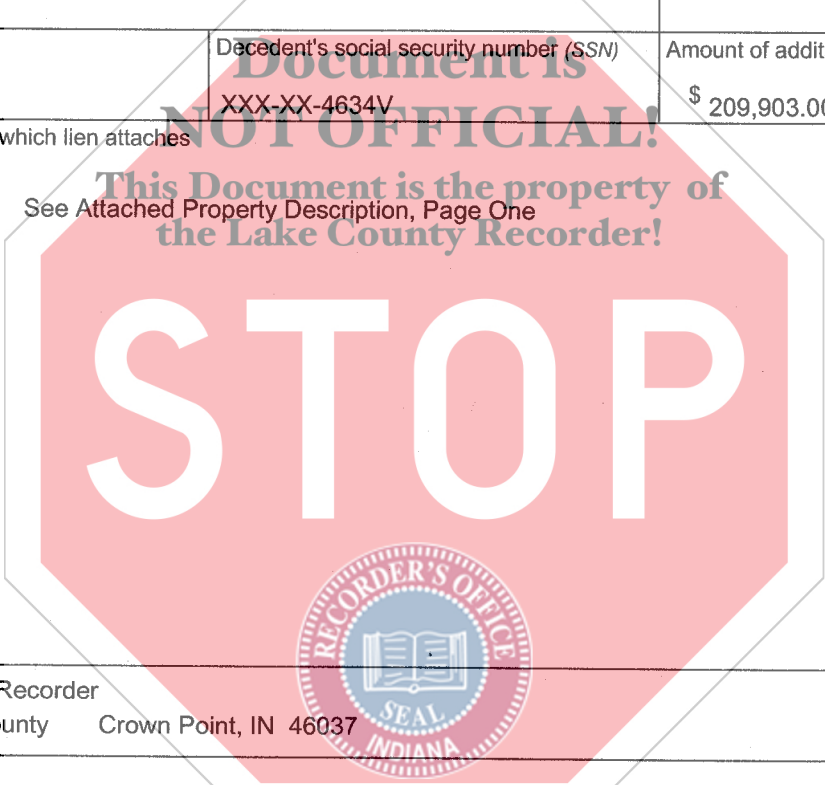

Place of Filing

County Recorder
Lake County Crown Point, IN 46037

This notice was prepared and signed at San Jose, California, on this

the 9th day of May, 2011

Signature

Doug Hottel
Doug Hottel #0682708

Title

Advisor - Estate Tax Lien Group

15-ack
E. V. [Signature]

2011 029248

STATE OF INDIANA
LAKE COUNTY
FILED FOR RECORD
2011 MAY 26 PM 3:49
MICHELLE N. PAUMANN
RECORDER

QUALIFIED HEIRS

Ellen M. Bowers

Kimi-Su Szykowski

Michael W. Miller, Sr.

Lyle E. Miller, individually and as trustee of the Miller Farm Trust, Numbers 1, 3 and 4
Miller Farm Trust Numbers 1, 3 and 4

Karla M. Denton

Marvin A. Miller

Sheldon L. Miller

LEGAL DESCRIPTION

The West One-half of the Southeast Quarter and the Southwest Quarter of the Northeast Quarter of Section 21, Township 33 North, Range 8 West of the Second P.M., in Lake County, Indiana, containing 120 acres, more or less. (Title held in Miller Farm Trust No. 1)

The Northwest Quarter of the Northeast Quarter of Section 21, Township 33 North, Range 8 West of the Second P.M., in Lake County, Indiana, containing 39.25 acres, more or less. (Title held in Miller Farm Trust No. 3)

The North One-half of the Northwest Quarter of Section 25, Township 32 North, Range 9 West of the Second P.M., in Lake County, Indiana, containing 80 acres, more or less. (Title held in the Miller Farm Trust No. 4)

