

LF298-04

2011 028235

2011 MAY 20 PM 1:49

RECORDER'S OFFICE
RECORDED

QUITCLAIM DEED

THIS QUITCLAIM DEED, executed this 11th day of May, 2011 (year),

by first party, Grantor, Judith Ann G. Laux

whose post office address is 2418 Roasting Ear Rd., Onia, AR 72663

to second party, Grantee, Denise R. Sulek

whose post office address is 2243 Keene Dr., Schererville, IN 46375

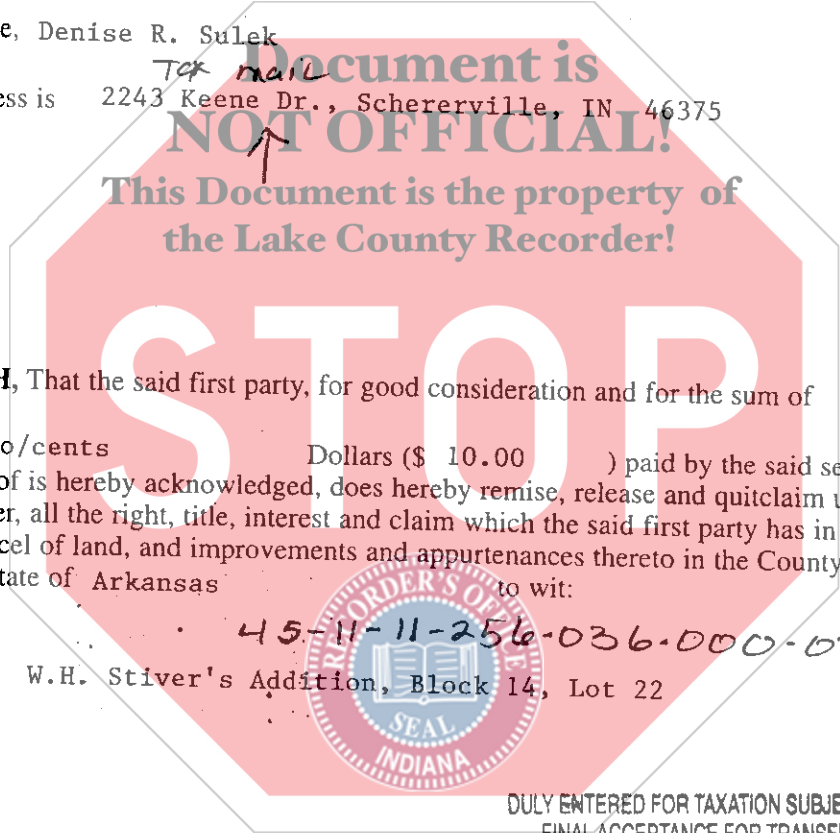

WITNESSETH, That the said first party, for good consideration and for the sum of

Ten Dollars and no/cents Dollars (\$ 10.00) paid by the said second party, the receipt whereof is hereby acknowledged, does hereby remise, release and quitclaim unto the said second party forever, all the right, title, interest and claim which the said first party has in and to the following described parcel of land, and improvements and appurtenances thereto in the County of Stone, State of Arkansas to wit:

45-11-11-256-036-000-032
W.H. Stiver's Addition, Block 14, Lot 22

DULY ENTERED FOR TAXATION SUBJECT TO
FINAL ACCEPTANCE FOR TRANSFER

001822

MAY 20 2011

PEGGY HOLINGA KATONA
LAKE COUNTY AUDITOR

18.00
CASH

IN WITNESS WHEREOF, The said first party has signed and sealed these presents the day and year first above written. Signed, sealed and delivered in presence of:

Susan Chasteen
Signature of Witness

[Signature] 6-4
Signature of First Party

Susan Chasteen
Print name of Witness

Judith-Ann C. Laux
Print name of First Party

Signature of Witness

Signature of First Party

Print name of Witness

Print name of First Party

State of Arkansas
County of Stone

On 5-17-11 before me,
appeared Judith Ann C. Laux
personally known to me (or proved to me on the basis of satisfactory evidence) to be the person(s) whose name(s) is/are subscribed to the within instrument and acknowledged to me that he/she/they executed the same in his/her/their authorized capacity(ies), and that by his/her/their signature(s) on the instrument the person(s), or the entity upon behalf of which the person(s) acted, executed the instrument. WITNESS my hand and official seal.

[Signature]
Signature of Notary

Document is NOT OFFICIAL
This Document is the property of the Lake County Recorder
Affiant Known Produced ID _____
Type of ID _____ (Seal)



State of _____
County of _____
On _____
appeared _____

before me,
personally known to me (or proved to me on the basis of satisfactory evidence) to be the person(s) whose name(s) is/are subscribed to the within instrument and acknowledged to me that he/she/they executed the same in his/her/their authorized capacity(ies), and that by his/her/their signature(s) on the instrument the person(s), or the entity upon behalf of which the person(s) acted, executed the instrument. WITNESS my hand and official seal.

Signature of Notary



Affiant Known Produced ID _____
Type of ID _____ (Seal)

"I AFFIRM, UNDER THE PENALTIES FOR PERJURY, THAT I HAVE TAKEN REASONABLE CARE TO REDACT EACH SOCIAL SECURITY NUMBER IN THIS DOCUMENT, UNLESS REQUIRED BY LAW."
PREPARED BY: [Signature]

Signature of Preparer

Print Name of Preparer

Address of Preparer