

5

STATE OF INDIANA  
LAKE COUNTY  
FILED FOR RECORD

2011 006279

2011 FEB -1 AM 10:00

RELEASE OF MECHANIC'S LIEN

MICHELLE A. JARVIS  
CTC 0200915089  
CM

This is to certify that a certain claim by National Precast, Inc.-30066 Little Mack,  
Roseville MI 48066

against INTAC 697 - 7200 Mississippi St., Merrillville IN 46410  
owned by: INTAC 697 Owners Association INC.

\_\_\_\_\_ In connection with which a Notice of Intention to  
Hold Mechanic's Lien was executed the 20th day of September, 2010 and recorded on the 27th day of  
Sept. 2010 Instrument No. 2010 055970 Book \_\_\_\_\_ Page \_\_\_\_\_, in the office of the

Recorder of Lake \_\_\_\_\_ (insert recording reference) \_\_\_\_\_, Indiana, has been fully paid and satisfied and said lien is hereby released  
this \_\_\_\_\_ day of January, 2011

National Precast, INC by: \_\_\_\_\_  
\*\*see attached exhibit 'a' legal  
\*\*\*see attached copy of mechanics lien

Signature [Signature] Signature \_\_\_\_\_  
Printed JOHN CIULLIS Printed \_\_\_\_\_

CHICAGO TITLE INSURANCE COMPANY

~~STATE OF \_\_\_\_\_ )  
) SS: \_\_\_\_\_  
COUNTY OF \_\_\_\_\_ )  
Before me, a Notary Public in and for the State of Indiana and a resident of \_\_\_\_\_  
County, Indiana, personally appeared \_\_\_\_\_  
who acknowledged execution of the foregoing Release of Mechanic's Lien, under the penalties for perjury, that I have taken reasonable care to redact each  
Witness my hand and Notarial Seal this \_\_\_\_\_ day of \_\_\_\_\_ Social Security number in this document, unless required by law. Jackie Smith  
My commission expires: \_\_\_\_\_  
Notary Name \_\_\_\_\_  
(Organizational Acknowledgment)~~

STATE OF Michigan )  
) SS: \_\_\_\_\_  
COUNTY OF Livingston )  
Before me, a Notary Public in and for the State of Michigan and a resident of Livingston  
County, Michigan, personally appeared John Ciullis, the president  
of National Precast INC (n) who acknowledged execution of the foregoing  
Release of Mechanic's Lien as such president for and on behalf of said  
Witness my hand and Notarial Seal this 27th day of January, 2011

My commission expires: 2/18/2017  
Notary Name John J. MacDonell

Instrument Prepared by: J. Ciullis

JOHN J. MACDONELL  
Notary Public, State of Michigan  
County of Livingston  
My Commission Expires 07-18-2017  
Acting in the County of Macomb

#20  
CT  
CM

No: 620101079

**LEGAL DESCRIPTION**

Unit A, in the INTAC 697 Condominiums, a Horizontal Property Regime, as per Declaration recorded January 15, 2010 as Document No. 2010 002686 and Floor Plans recorded January 15, 2010 as Document No. 2010 002687 in Plat Book 104, page 25, in the Office of the Recorder of Lake County, Indiana, together with the undivided percentage interest in the common areas and facilities appertaining thereto.



LEGAL 6/08 SB

2010 055970

2010 SEP 27 PM 12:53

MICHELLE R. FAJMAN  
RECORDER

**NOTICE OF CLAIM OF LIEN  
(MECHANICS LIEN)**

State of Michigan  
County of Macomb

COMES NOW, John Ciulis, as representative of National Precast, Inc. of 30066 Little Mack, Roseville, MI 48066, a Michigan corporation, and hereby provides notice of the following:

NOTICE IS HEREBY GIVEN that on the 25th day of August, 2010, National Precast, Inc. last provided labor or material to Berglund Construction Company, 126 Venturi Dr., Chesterton, IN 46304 for an improvement to the property located at:

INTAC 697  
7200 MISSISSIPPI ST  
MERRILLVILLE, IN 46410  
BCC PROJECT NO.: 489031  
SEE ATTACHED LEGAL DESCRIPTION EXHIBIT A

The above mentioned property is owned by:  
INTAC 697 OWNERS ASSOC INC  
2835 165TH STREET  
HAMMOND, IN 46323.

The lien claimant's contract amount including extras, is \$483,180.00. The lien claimant has received payment in the total amount of \$432,000 and therefore claims a construction lien upon the above described real property in the amount of \$51,180 representing all labor and material furnished as of August 25, 2010. The lien claimant is entitled to service charges and/or interest at the rate of 18.000% per annum in addition to attorney fees.

NATIONAL PRECAST, INC.

Dated: September 20, 2010

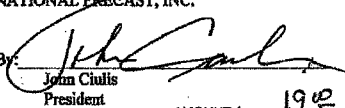
By:   
John Ciulis  
President

AMOUNT \$	190
CASH	CHARGE
CHECK #	23514
COVERAGE	
COPY	
NON-COM	
CLERK	R.M.

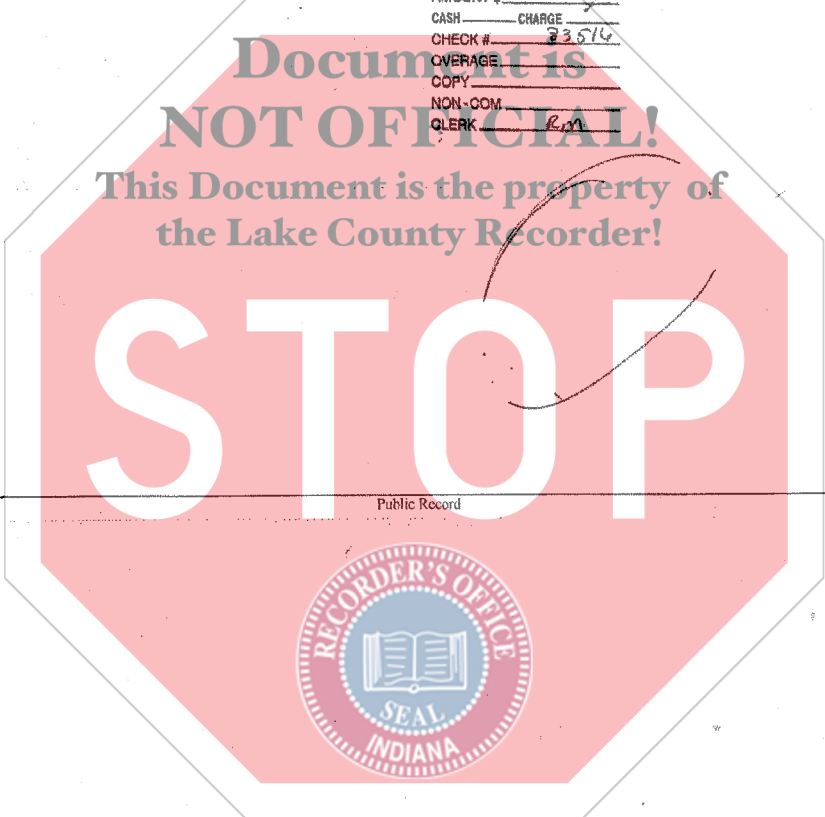

State of Michigan  
County of Macomb

Sworn to and subscribed before me, the undersigned, a Notary Public, in and for said county and State, this 21 day of September, 2010.

  
\_\_\_\_\_  
Notary Public  
Livingston County, Michigan  
Commission Expires 7/18/2010  
Acting in Macomb County, Michigan

Prepared by, recording requested by  
and return to:

James Sarconi  
O'Reilly Rancillo, P.C.  
12900 Hall Road, Suite 350  
Sterling Heights, MI 48313  
(586) 726-1000  
(586) 726-1560 fax

JOHN J. MACDONELL  
Notary Public, State of Michigan  
County of Livingston  
My Commission Expires 07-18-2017  
Acting in the County of Macomb

J:\MacTevla, Trustee\0001 - National Precast\Liens\Clean of Lien 9-20-10.doc

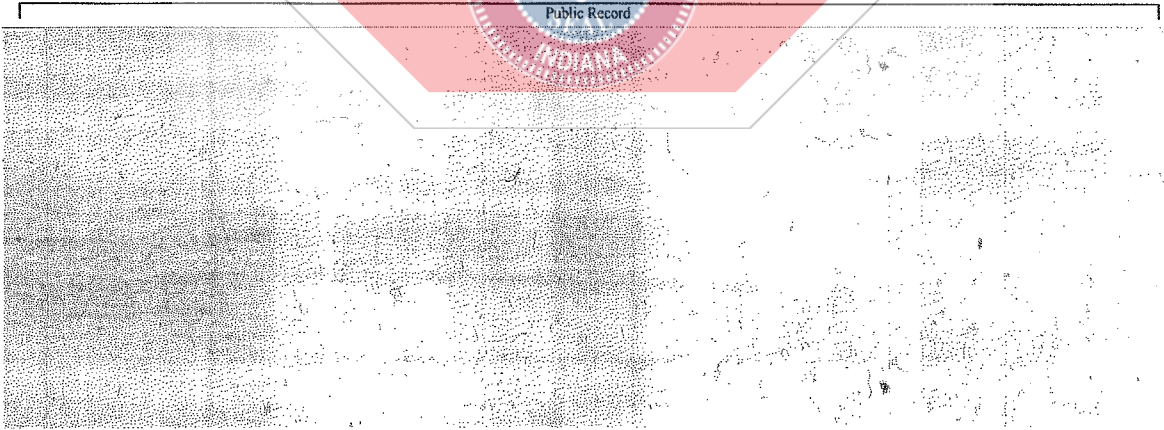
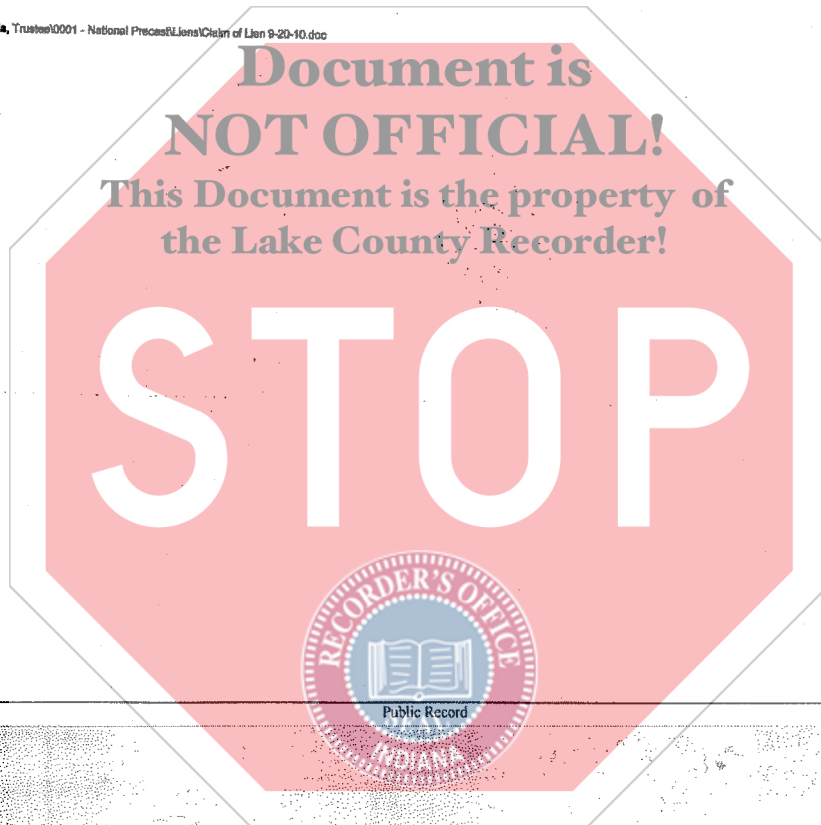

**LEGAL DESCRIPTION**

Land situated in the City of Merrillville, County of Lake, State of Indiana to wit:

Part of the Northeast Quarter and part of the Southeast Quarter, all in Section 15, Township 35 North, Range 8 West, Second Principal Meridian, Lake County, Indiana and being more particularly described as follows:

Commencing at the Northeast corner of said Section 15; thence South 00 degrees 00 minutes 00 seconds West, 1587.37 feet on and along the East line of said Northeast Quarter; thence South 88 degrees 48 minutes 25 seconds West 107.83 feet to a corner of a tract of land described to the Town of Merrillville in Document Number 2002-039431 in the Office of the Recorder of Lake County, Indiana, and being the point of beginning of this description; thence South 88 degrees 48 minutes 25 seconds West, 616.73 feet on and along the south line of said Town of Merrillville tract and its westerly extension to the intersection with an East line of a tract of land described to George A. Rogge in Document Numbers 97051505, 97051506 and 97051507 in said Office of the Recorder; thence on and along the easterly line of said Rogge tract the following three courses: 1) South 00 degrees 00 minutes 00 seconds West, 768.86 feet; 2) thence South 50 degrees 01 minutes 43 seconds East, 277.67 feet; 3) thence South 00 degrees 00 minutes 00 seconds West 516.39 feet to the intersection with the northerly right-of-way line of 73rd Avenue as described in Miscellaneous Record 1229, page 231 in said Office of the Recorder; thence South 78 degrees 03 minutes 31 seconds East, 195.27 feet on and along the northerly right-of-way line of 73rd Avenue to a 5/8-inch diameter rebar; thence North 00 degrees 07 minutes 17 seconds West, 237.66 feet to a 5/8-inch diameter rebar; thence North 89 degrees 52 minutes 43 seconds East, 220.00 feet to a 5/8-inch diameter rebar on a westerly line of said Town of Merrillville tract; thence on and along the westerly lines of said Town of Merrillville tract the following five courses and distances: 1) thence North 04 degrees 10 minutes 04 seconds East, 79.66 feet; 2) thence North 00 degrees 07 minutes 17 seconds West, 300.00 feet; 3) thence North 03 degrees 23 minutes 30 seconds West, 350.57 feet; 4) thence North 03 degrees 41 minutes 34 seconds East, 150.33 feet; 5) thence North 00 degrees 07 minutes 17 seconds West, 399.52 feet to the point of beginning, containing 17.08 acres, more or less. The description is based upon a survey by Duseland Group, Inc., Job No 2464.000.8, dated August 3, 2009.

