

3

STATE OF INDIANA
LAKE COUNTY
FILED FOR RECORD

2010 011294

2010 MAR -2 AM 9:19

MICHELLE R. FAJMAN
RECORDER

(Grantee Address):
MAIL TAX BILLS TO:
THE CITY OF HAMMOND
649 Conkey Street
Hammond, Indiana 46324

WARRANTY DEED

CHIC 020095909CM

THIS INDENTURE WITNESSETH, THAT JAMES BARTOSZEK, ("Grantor") of 2946 98th Street, Highland, County of Lake, State of Indiana

CONVEYS AND WARRANT(S) TO THE CITY OF HAMMOND by and through its REDEVELOPMENT COMMISSION, ("Grantees") of 649 Conkey Street, Hammond, Indiana, for and in consideration of Ten Dollars and other valuable consideration, the receipt and sufficiency of which are hereby acknowledged, the following described real estate in Lake County, in the State of Indiana:

CHICAGO TITLE INSURANCE COMPANY

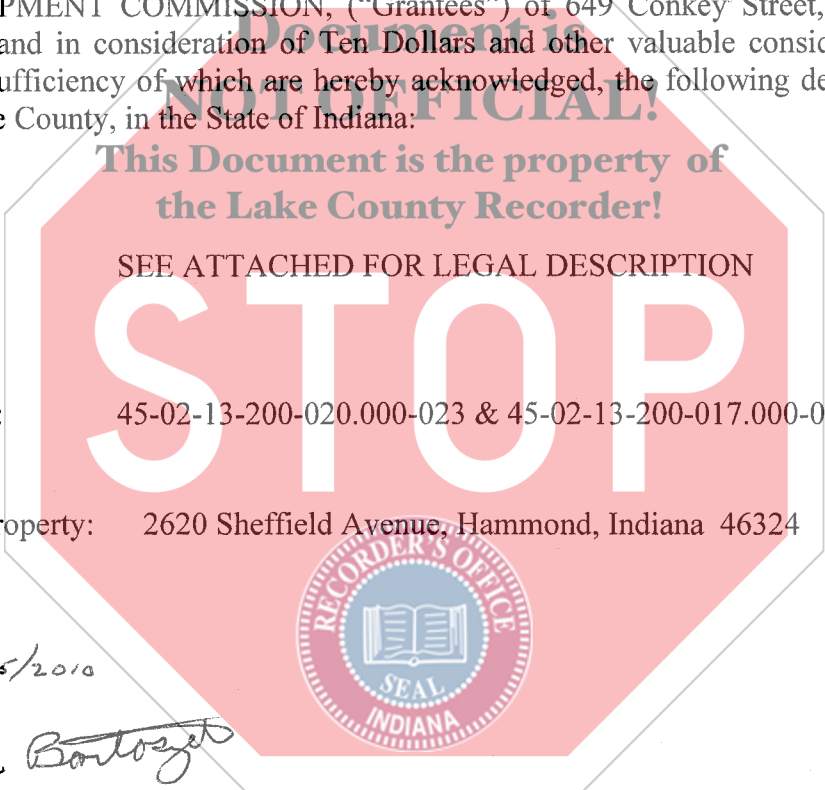

Tax Key No.: 45-02-13-200-020.000-023 & 45-02-13-200-017.000-023

Address of Property: 2620 Sheffield Avenue, Hammond, Indiana 46324

Dated: 2/25/2010

James Bartoszek

JAMES BARTOSZEK

20⁰⁰
CT
RM

DULY ENTERED FOR TAXATION SUBJECT TO
FINAL ACCEPTANCE FOR TRANSFER

MAR 01 2010

PEGGY HOLINGA KATONA
LAKE COUNTY AUDITOR

051127

STATE OF Indiana COUNTY OF LAKE SS:

Before me, the undersigned, a Notary Public in and for said County and State, this 25th day of February, 2010 personally appeared: JAMES BARTOSZEK the execution of the foregoing deed. In witness whereof, I have hereunto subscribed their names and affixed their official seals.

My commission expires: _____ Signature: _____

Resident of _____ County Printed _____, Notary Public

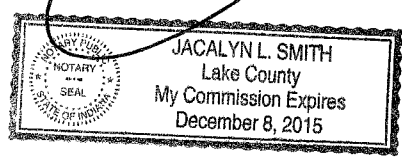

I affirm, under the penalties for perjury, that I have taken reasonable care to redact each Social Security number in this document, unless required by law.

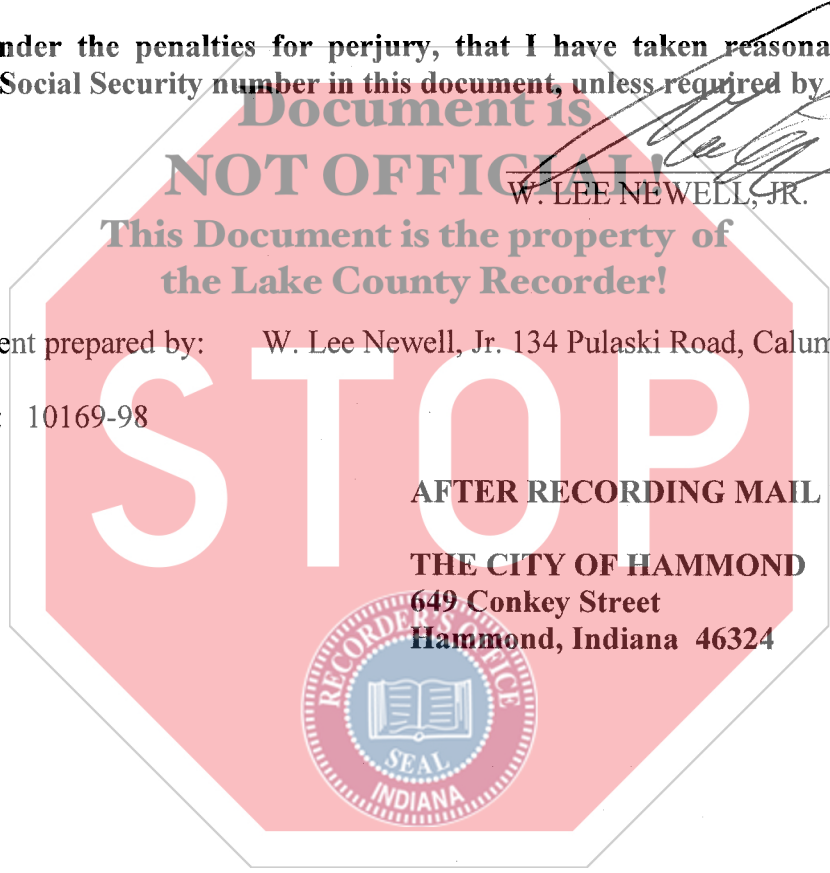

W. LEE NEWELL, JR.

This instrument prepared by: W. Lee Newell, Jr. 134 Pulaski Road, Calumet City, IL

Attorney No: 10169-98

AFTER RECORDING MAIL TO:

THE CITY OF HAMMOND
649 Conkey Street
Hammond, Indiana 46324

No: 620095909

LEGAL DESCRIPTION

Parcel 1: A triangularly shaped parcel of land in the North Half of the Northeast Quarter of Section 13, Township 37 North, Range 10 West of the Second Principal Meridian, in the City of Hammond, in Lake County, Indiana, described as follows: Commencing at a point on the 40-foot Westerly right of way line of Sheffield Avenue, said point of beginning being 587.26 feet Northeasterly of the intersection of the South line of the North Half of the Northeast Quarter of said Section 13 and the 40-foot Westerly right of way line of Sheffield Avenue, measured along said Westerly right of way line; thence continuing Northeasterly on said 40-foot right of way line 767.14 feet to the intersection with the 33-foot Southeasterly right of way line of the Indiana Harbor Belt Railroad; thence Southwesterly along said 33-foot Indiana Harbor Belt Railroad right of way line, 888.05 feet to a point on a line, which is parallel to and 572.28 feet North of the South line of the North Half of the Northeast Quarter of said Section 13; thence Easterly 307.19 feet on a line parallel to and 572.28 feet North of the South line of the North Half of the Northeast Quarter of said Section 13, to the point of beginning.

Parcel 2: That part of a 66 foot wide Indiana Harbor Belt Railroad right of way, situated in the Northeast Quarter of Section 13, and in the Southeast Quarter of Section 12, Township 37 North, Range 10 West of the Second Principal Meridian, in Lake County, Indiana, described as follows: Beginning at the intersection of the Westerly right of way line of Sheffield Avenue and the Easterly line of the Indiana Harbor Belt Railroad right of way; thence South 32 degrees 34 minutes 20 seconds West, along the Easterly Indiana Harbor Belt Railroad right of way, 890.52 feet; thence North 90 degrees 00 minutes 00 seconds West, to the Westerly line of the Indiana Harbor Belt Railroad right of way line, 78.32 feet; thence North 32 degrees 34 minutes 20 seconds East, along the Westerly Indiana Harbor Belt Railroad right of way line, 1,117.02 feet to the Westerly right of way line of Sheffield Avenue; thence South 12 degrees 52 minutes 22 seconds West, along the Westerly right of way line, 195.80 feet to the point of beginning.

Parcel 3: That part of a 66 foot wide Indiana Harbor Belt Railroad right of way, situated in the Northeast Quarter of Section 13, Township 37 North, Range 10 West of the Second Principal Meridian, in Lake County, Indiana, described as follows: Commencing at the intersection of the Westerly right of way line of Sheffield Avenue and the Easterly line of the Indiana Harbor Belt Railroad right of way; thence South 32 degrees 34 minutes 20 seconds West, along the Easterly Indiana Harbor Belt Railroad right of way, 890.52 feet to the point of beginning; thence continuing South 32 degrees 34 minutes 20 seconds West, along said Easterly right of way line, 91.09 feet to a point of tangency; thence Southwesterly along an arc concave Southeasterly, having a radius of 2,831.90 feet, a central angle of 11 degrees 15 minutes 50 seconds and an arc length of 556.73 feet, to the South line of the Northeast Quarter of the Northeast Quarter of said Section 13; thence North 90 degrees 00 minutes 00 seconds West, along said South line, 70.72 feet to the Westerly line of the Indiana Harbor Belt Railroad right of way; thence Northeasterly along an arc concave Southeasterly having a radius of 2,897.90 feet, a central angle of 11 degrees 46 minutes 19 seconds and an arc length of 595.40 feet to a point of tangency; thence North 32 degrees 34 minutes 20 seconds East, along the Westerly line of the Indiana Harbor Belt Railroad right of way, a distance of 48.93 feet; thence South 90 degrees 00 minutes 00 seconds East, 78.32 feet to the point of beginning.