

3

INDIANA
LAKE COUNTY
FILED FOR RECORD

2010 011043

2010 MAR -1 AM 9:20

MIDWEST BANK
REGISTRATION

**RELEASE OF MORTGAGE OR
TRUST DEED (ILLINOIS)**

**FOR THE PROTECTION OF THE OWNER, THIS RELEASE SHALL BE FILED WITH THE RECORDER OF DEEDS
OR THE REGISTRAR OF TITLES IN WHOSE OFFICE THE MORTGAGE OR DEED OF TRUST WAS FILED.**

KNOW ALL MEN BY THESE PRESENTS, That First Midwest Bank, formerly known as Bank Calumet, National Association of the County of Dupage and State of Illinois for and in consideration of the payment of the indebtedness secured by the MORTGAGE hereinafter mentioned, and the cancellation of all the notes thereby secured, and of the sum of one dollar, the receipt whereof is hereby acknowledged, do hereby REMISE, RELEASE, CONVEY and QUIT CLAIM unto GERALD M. STURM and ZINETA STURM and their heirs, legal representatives and assigns, all the right, title, interest, claim or demand whatsoever the bank may have acquired in, through or by a certain MORTGAGE bearing date the 21ST day of JUNE, 2004 and recorded in the Recorder's Office of LAKE County, in the State of Indiana, in book --- of records, on page ---, as Document No. 2004056296 to the premises therein described as follows, situated in the County of LAKE, State of Indiana, to wit:

SEE ATTACHED EXHIBIT "A"

Together with all the appurtenances and privileges thereunto belonging or appertaining.

Address of premises: 10204 CLARK ROAD, CROWN POINT IN 46307

Customer Address: SAME AS ABOVE

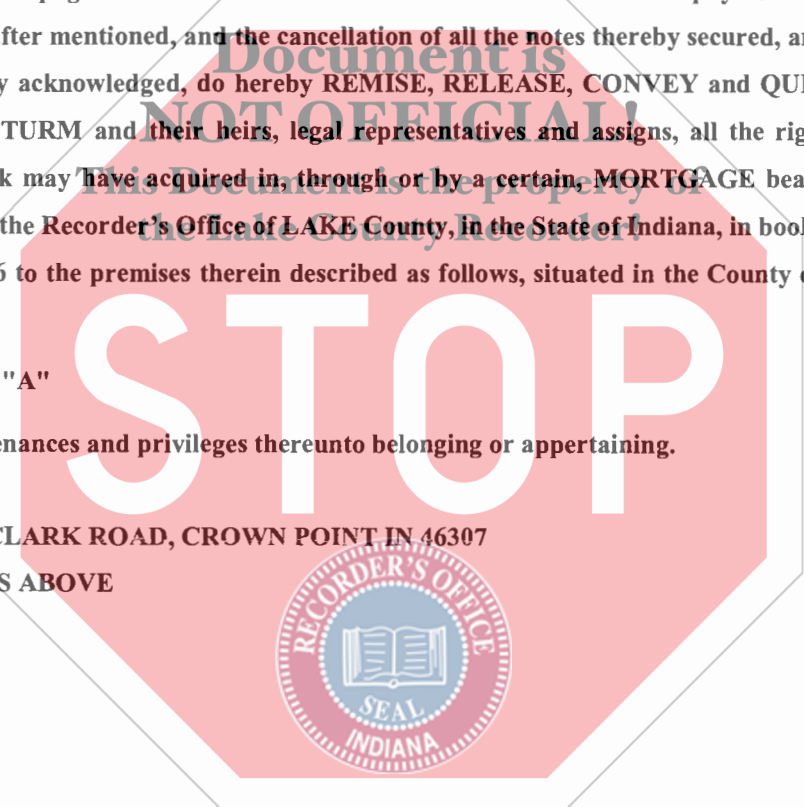

100152531
+
100142892
16⁰⁰
BS

E

Witness our hands, this 22ND day of JANUARY, 2010.

FIRST MIDWEST BANK
F/K/A BANK CALUMET, National Association

By: Haremia Parry
Haremia Parry

Its: Vice President

By: Sonya Frazier
Sonya Frazier

Its: Loan Operations Officer

This instrument was prepared by:

First Midwest Bank
P. O. Box 9003
Gurnee, IL 60031
Murrie

STATE OF ILLINOIS
COUNTY OF LAKE

I, the undersigned, a notary public in and for said County, in the State aforesaid, DO HEREBY CERTIFY that Haremia Parry, personally known to me to be the Vice President of First Midwest Bank, formerly known as Bank Calumet, National Association and Sonya Frazier, personally known to me to be the Loan Operations Officer, of said banking corporation, and personally known to be the same persons whose names are subscribed to the foregoing instrument, appeared before me this day in person and severally acknowledged that as such Vice President and Loan Operations Officer, they signed and delivered the said instrument, pursuant to authority given by the Board of Directors of said banking corporation, as their free and voluntary act, and as the free and voluntary act of said banking corporation, for the uses and purposes therein set forth.

I AFFIRM, UNDER THE PENALTIES FOR PERJURY, THAT I HAVE TAKEN REASONABLE CARE TO REDACT EACH SOCIAL SECURITY NUMBER IN THIS DOCUMENT, UNLESS REQUIRED BY LAW.

GIVEN under my hand and notary seal this 22nd day of January, 20 10.

Kelly A Leith
Notary Public
Commission Expires 2/28/12

MAIL TO: FIRST MIDWEST BANK
P.O. BOX 9003
GURNEE, IL 60031
LN# 3009028216

OFFICIAL SEAL
KELLY A LEITH
NOTARY PUBLIC - STATE OF ILLINOIS
MY COMMISSION EXPIRES 02/28/12

EXHIBIT "A"

Parcel I: Part of the Northeast Quarter of Section 1, Township 34 North, Range 9 West of the Second Principal Meridian Described as: Commencing at a point 665.45 feet South of the North line and 208.71 feet West of the East line of the Northeast Quarter of said Section 1; thence West parallel to the North line of said Section 1, 208 feet; thence South parallel to the East line of said Section 1, 269.35 feet; thence East parallel to the North line of said Section 1, 208 feet; thence North parallel to the East line of said Section 169.35 feet to the point of beginning.

Parcel II: Part of the Northeast Quarter of Section 1, Township 34 North, Range 9 West of the Second Principal Meridian Described as follows: Commencing on the East line of Section at a point 730.48 feet South of the Northeast corner thereof; thence West and parallel to the North line of said Section 208.71 feet; thence North parallel to the East line of said section a distance of 65 feet; thence East parallel to the North line of said section a distance of 208.71 feet to the East line of said section; thence South along the East line of said section a distance of 208.71 feet to the East line of said section; thence South along the East line of said section a distance of 65 feet to the point of beginning.

