

TOWN OF WINFIELD, LAKE COUNTY, INDIANA

ORDINANCE NO.: 2008-179

AN ORDINANCE ANNEXING ADJACENT AND CONTIGUOUS TERRITORY TO THE TOWN OF WINFIELD, INDIANA

WHEREAS, the Town of Winfield, Lake County, Indiana, is aware that certain real estate adjoining and contiguous to the eastern boundary of the Town of Winfield should be annexed to the Town of Winfield; and

WHEREAS, in excess of one-eighth (1/8) of said real estate is contiguous with the existing town limits of the Town of Winfield; and

WHEREAS, the real estate sought to be annexed is needed and can be used by the Town of Winfield for its development in the reasonably near future; and

WHEREAS, the Town of Winfield will, by resolution, develop and adopt a written fiscal plan to furnish said real estate with governmental and proprietary services substantially equivalent in standard scope to those presently provided to other areas located within the corporate limits of the Town of Winfield.

NOW, THEREFORE, BE IT ORDAINED BY THE TOWN COUNCIL OF THE TOWN OF WINFIELD, LAKE COUNTY, INDIANA, AS FOLLOWS:

SECTION ONE: The following described real estate be, and the same is hereby annexed and declared to be a part of the Town of Winfield, Lake County, Indiana, to-wit:

See attached legal description and map for said real estate consisting of approximately 258 acres, which is incorporated herein by reference as Exhibit "A"

SECTION TWO: The real estate being annexed is hereby assigned to be part of the "at-large" voting district in the Town of Winfield pursuant to I. C. 36-4-3-4(g).

SECTION THREE: That the zoning for said real estate is hereby determined to be C-3 General Commercial District except for the developed real estate known as "The Meadows Villages of Four Seasons" which shall be zoned R-4 Residential District and the real estate known as "The Pointe" which shall be zoned Planned Unit Development (PUD) as partially reflected in Town of Winfield Plan Commission Resolution 2009-01, which is incorporated herein by reference.

2009 08 16 86

STATE OF INDIANA
LAKE COUNTY
FILED FOR RECORD
MICHAEL E. SPROW
RECORDER
DEC - 9 AM 11: 59

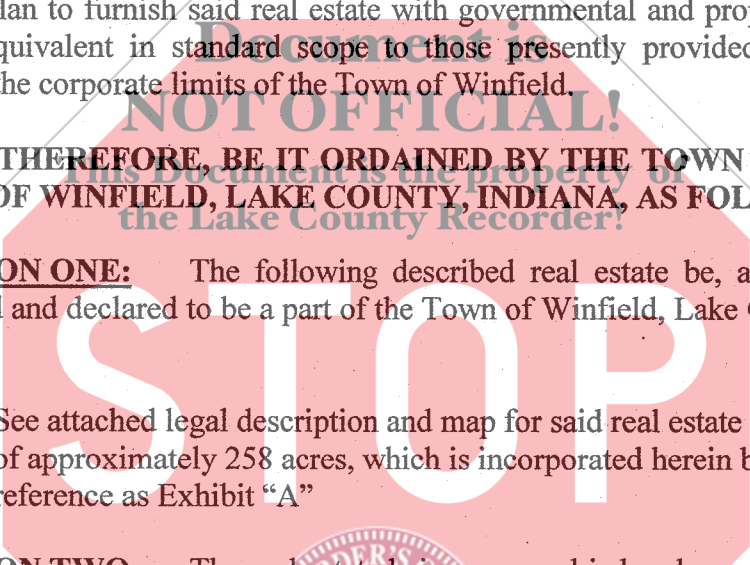

\$20
CS
CWA

FILED

DEC 09 2009

021518

PEGGY HOLINGA KATONA
LAKE COUNTY AUDITOR

SECTION FOUR: That the boundaries of the Town of Winfield, Lake County, Indiana, shall be, and the same are, hereby declared to be extended so as to include all of the real estate hereinabove described as part of the Town of Winfield, Lake County, Indiana.

SECTION FIVE: This ordinance shall be in full force and effect from and after January 2, 2010, and publication in accordance with the law.

ALL OF WHICH IS PASSED AND ADOPTED BY THE TOWN COUNCIL OF THE TOWN OF WINFIELD, LAKE COUNTY, INDIANA, THIS 18TH DAY OF AUGUST, 2009.

AYES

NAYES

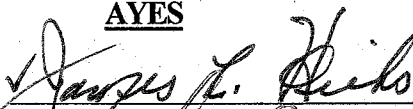
James Hicks, President

James Hicks, President

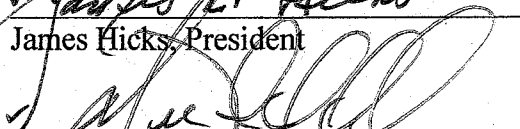
Michael DeNormandie, Vice President

Michael DeNormandie, Vice President

Paulette Skinner, Member

Paulette Skinner, Member

Robert Bult, Member

Robert Bult, Member

Michael Lambert, Member

Michael Lambert, Member

ATTEST:

Richard C. Anderson
Clerk-Treasurer

TOWN COUNCIL
TOWN OF WINFIELD, LAKE COUNTY, INDIANA

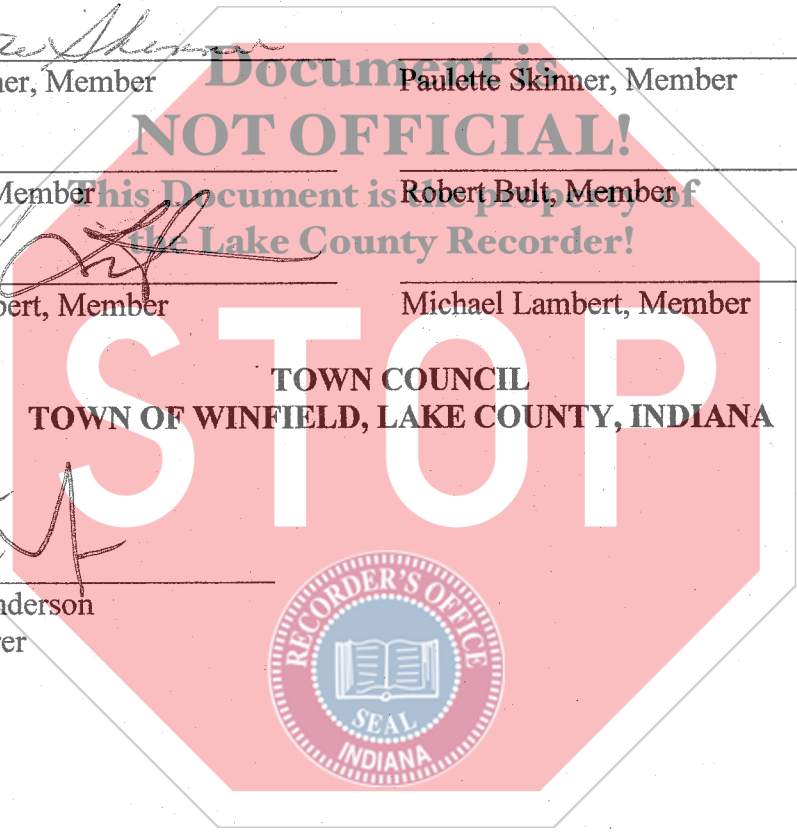
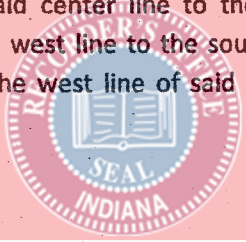

EXHIBIT "A"

Parcel Description:

A parcel of land located in Sections 9 and 16, Township 34 North, Range 7 West of the Second Principal Meridian, in the Town of Winfield, Lake County, Indiana, more particularly described as follows:

Beginning at the Northwest Corner of said Section 9, thence South $89^{\circ}21'19''$ East, 3988.765 feet, along the north line of said Section 9, to the northerly extension of a west line of Lakes of the Four Seasons, Unit No. 1 recorded in Plat Book 37, Page 63 in the office of the Recorder in Lake County, Indiana; thence South $00^{\circ}17'48''$ West, 664.356 feet along said northerly extension and along said west line of Unit No. 1 to a northeast corner of Lakes of the Four Seasons Subdivision, Unit No. 2, recorded in Plat Book 37, Page 76 in said Recorder's office; thence North $89^{\circ}21'49''$ West, 1992.660 feet along a north line of said Unit No. 2 to the southeast corner of Tract No. 15 of said Unit No. 2; thence along the southerly lines of said Tract No. 15 the following four courses and distances, (1) North $89^{\circ}21'49''$ West, 196.06 feet; (2) South $74^{\circ}55'18''$ West, 123.62 feet; (3) South $59^{\circ}57'41''$ West, 105.49 feet; (4) South $46^{\circ}22'07''$ West, 118.80 feet to the eastern most corner of Tract No. 14 of said Unit No. 2; thence, continuing South $46^{\circ}22'07''$ West, 1617.13 feet along the southeast line of said Tract No. 14 and along the southeast line of Tract No. 13 of said Unit No. 2; thence South $00^{\circ}00'00''$ East, 911.374 feet along the east line of said Tract No. 13 to the west corner of Lot number 651 in Lakes of the Four Seasons Subdivision, Unit No. 10, recorded in Plat Book 39, Page 11 in said Recorder's Office; thence along the westerly lines of said Unit No. 10 the following three courses and distances, (1) South $34^{\circ}15'22''$ East, 842.076 feet; (2) South $12^{\circ}59'14''$ West, 582.911 feet; (3) South $00^{\circ}01'46''$ West, 1183.416 feet to the northwest corner of Lakes of the Four Seasons Subdivision, Unit No. 9 recorded in Plat Book 38, Page 78 in said Recorder's office, said northwest corner being on the north line of said Section 16; thence South $00^{\circ}17'12''$ East, 2661.716 feet along the west line of said Unit No. 9; thence South $89^{\circ}39'01''$ East, 1917.606 feet along the south line of said Unit No. 9, to the southwest corner of Lot 1222 in Lakes of the Four Seasons Subdivision, Unit No. 5 recorded in Plat Book 38, Page 62 in said Recorder's office; thence continuing South $89^{\circ}39'01''$ East, 40.975 feet along the south line of said Lot 1222 to the west line of Lot 1224 in said Unit No. 5; thence South $00^{\circ}01'26''$ East, 40.975 feet along said west line to the northwest corner of Lot 1225 in Lakes of the Four Seasons Subdivision, Unit No. 6 recorded in Plat Book 39, Page 12 in said Recorder's office; thence continuing South $00^{\circ}01'26''$ East, 1302.206 feet along the west line of Lot 1225 and along the west line of said Unit No. 6 to the intersection of the southerly extension of said west line and the center line of 123rd Avenue (Platted as County Road 275 South); thence North $89^{\circ}37'26''$ West, 2649.11 feet along said center line to the west line of Section 16; thence North $00^{\circ}04'12''$ East, 4006.20 feet along said west line to the southwest corner of Section 9; thence North $00^{\circ}00'00''$ West, 5319.726 feet along the west line of said section 9, to the point of beginning, and containing 257.787 acres, more or less.



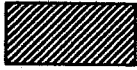
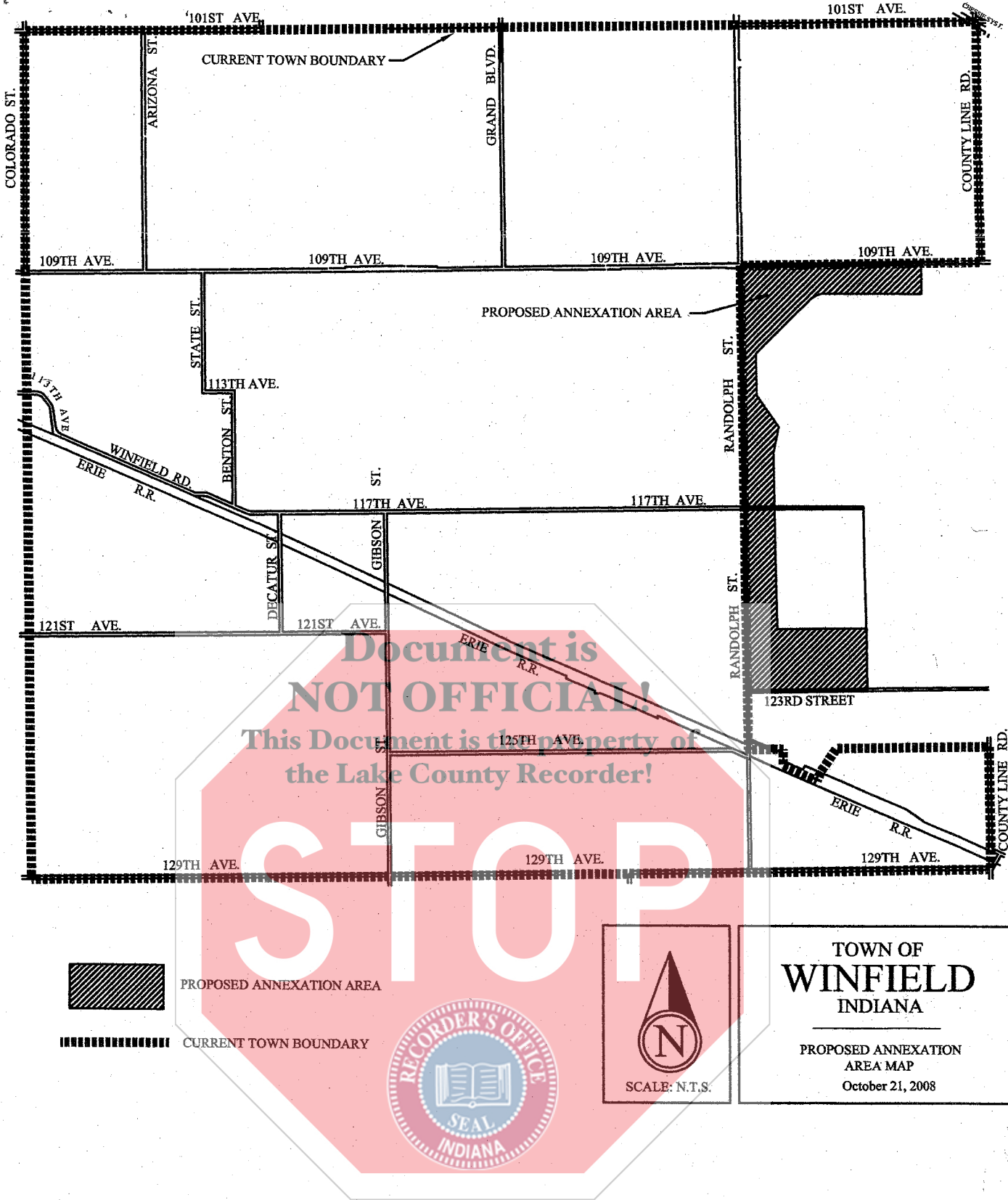

PROPOSED ANNEXATION AREA



CURRENT TOWN BOUNDARY



TOWN OF
WINFIELD
INDIANA

PROPOSED ANNEXATION
AREA MAP
October 21, 2008