

4

STATE OF INDIANA
LAKE COUNTY
FILED FOR RECORD

2009 069052

2009 OCT 13 PH 1:35

MICHAEL A. BROWN
RECORDER

WARRANTY DEED

KNOW ALL MEN BY THESE PRESENT: That **ZION TEMPLE APOSTOLIC CHURCH, An Unincorporated Religious Association** (Grantor), 1525 Jefferson Street, Gary, Indiana 46406, for no consideration CONVEYS AND WARRANTS to: **ZION TEMPLE APOSTOLIC CHURCH, INC.**, 1525 Jefferson Street, Gary, Indiana 46406, the following described parcels located in Lake County, State of Indiana, in fee simple absolute. See attached Parcels for Conveyance exhibit.

IN WITNESS WHEREOF, Grantor has executed this deed through its Trustees,

this 9th day of October, 2009.

[Signature]
Donsero Reynolds

[Signature]
David Golden

[Signature]
Ronald Swope

[Signature]
Ethel L. Pressley

[Signature]
Jacqueline Horton

[Signature]
Linda Reynolds

[Signature]
Cleo Jeffery Jones

[Signature]
Edna Garmon

[Signature]
Ricky Dean

STATE OF INDIANA }
 } SS:
COUNTY OF LAKE }

Before me, a Notary Public in and for said County and State, personally appeared Donsero Reynolds, David Golden, Ronald Swope, Ethel L. Pressley, Jacqueline Horton, Linda Reynolds, Cleo Jeffery Jones, Edna Garmon and Ricky Dean, who acknowledged the execution of the foregoing Warranty Deed, and who, having been duly sworn, stated that all representations therein contained are true.

Witness my hand and Notarial Seal this 9th day of October, 2009.

My Commission Expires: 3/15/10

DULY ENTERED FOR TAXATION SUBJECT TO
[Signature]
Notary Public

This instrument prepared by The Walker Law Group, P.C., 4858 Broadway, Gary, IN 46408, (219) 883-2626

"I AFFIRM, UNDER THE PENALTIES FOR PERJURY, THAT I HAVE TAKEN REASONABLE CARE TO REDACT EACH SOCIAL SECURITY NUMBER IN THIS DOCUMENT, UNLESS REQUIRED BY LAW."
PREPARED BY [Signature]

017157

OCT 13 2009
PEGGY HOLINGA KATONA
LAKE COUNTY AUDITOR

220
CS
Rd

PARCELS FOR CONVEYANCE

Parcel A: 1525 Jefferson Street, Gary, IN

Lots Eighteen (18) and Nineteen (19), in Block Thirteen (13), (except that part in rear of said lots taken for alley purposes), Chicago-Tolleston Land and Investment Company's Fifth Addition to the Town of Tolleston, in the City of Gary, Indiana.

Parcel Number 25-42-112-0010

Parcel B: 1520 Jefferson Street, Gary, IN

Lot Numbers Six (6), Seven (7), Eight (8), Nine (9) Ten (10), Eleven (11), Twelve (12) and Thirteen (13), all inclusive, in Block Number Twelve (12), as marked and laid down on the recorded plat of the Chicago-Tolleston Land and Investment Company Fifth Addition to Tolleston, except those parts of said lots taken for alley purpose, and the East One-Half (E 1/2) of vacated alley Number Four West (4W), abutting these said lots, in the City of Gary, Lake County, Indiana, same as in appears in plat Book Number Two (2), Page Thirty-One (31), in the Recorder's Office of Lake County, Indiana.

Parcel Number 25-42-111-0002

Parcel C: 1531 Jefferson Street, Gary, IN

Lot Numbers Twenty-One (21), Twenty-Two (22), Twenty-Three (23), Twenty-Four (24), Twenty-Five (25) and Twenty-Six (26), all inclusive, in Block Number Thirteen (13), as marked and laid down on the recorded plat of the Chicago-Tolleston Land and Investment Company's Fifth Addition to Tolleston, except those parts of said lots taken for alley purpose, and the West One-Half (W 1/2) of vacated alley Number Three West (3W), abutting these said lots, in the City of Gary, Lake County, Indiana, same as it appears in plat Book Number Two (2), Page Thirty-One (31), in the Recorder's Office of Lake County, Indiana.

Parcel Number 25-42-112-0013

Parcel D: 1625-27 Washington Street, Gary, IN

Lot Number Twenty (20) in Block Number Four (4) in Chicago-Tolleston Land and Investment Company's Fifth Addition to Tolleston in the City of Gary, Lake County, Indiana.

Parcel Number 25-42-103-0011.

Parcel E: 1501 Jefferson Street, Gary, IN

All of Lot Fourteen (14), Block Thirteen (13), and the West One-Half (1/2) of vacated alley adjacent, of Chicago-Tolleston Land and Investment Company's Third Addition to Tolleston in the City of Gary, Lake County, Indiana.

Parcel Number 25-42-0080-0005.

Parcel F: 1507 Jefferson Street, Gary, IN

All of Lot Fifteen (15), Block Thirteen (13) and the West One-Half (1/2) of vacated alley adjacent of Chicago-Tolleston Land and Investment Company's Third Addition to Tolleston in the City of Gary, Lake County, Indiana.

Parcel Number 25-42-0080-0006

Parcel G: 1509 Jefferson Street, Gary, IN

All of Lot Sixteen (16), Block Thirteen (13) and the West One-Half (1/2) of vacated alley adjacent of Chicago-Tolleston Land and Investment Company's Third Addition to Tolleston in the City of Gary, Lake County, Indiana.

Parcel Number 25-42-0080-0007.

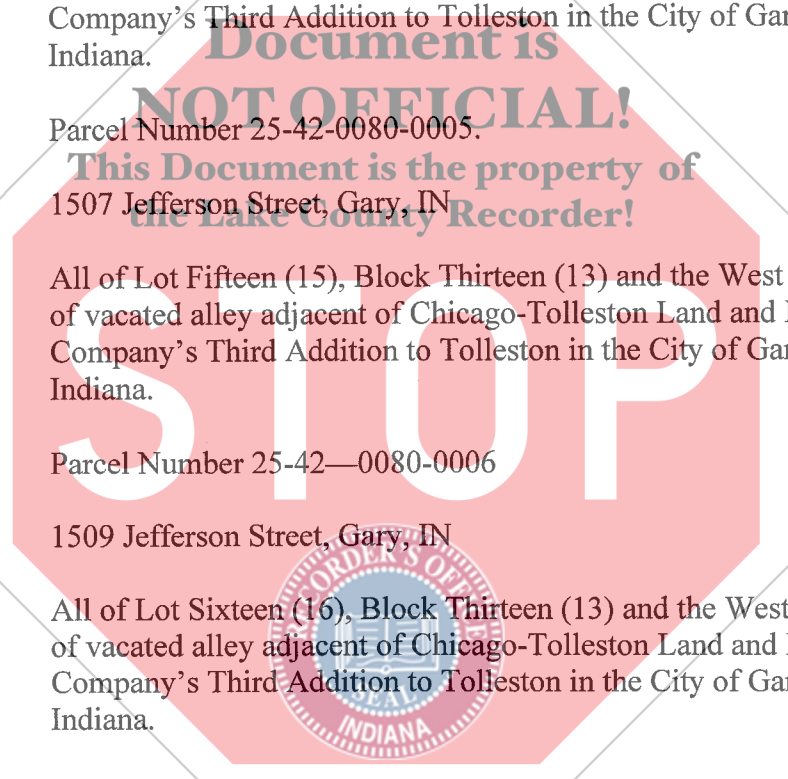

Parcel H: 1513 Jefferson Street, Gary, IN

All of Lot Seventeen (17), block Thirteen (13), and the West One-Half (1/2) of alley adjacent to the North Ten (10) feet of Lot Seventeen (17) of Chicago-Tolleston Land and Investment Company's Third Addition to Tolleston in the City of Gary, Lake County, Indiana.

Parcel Number 25-42-0080-0008.

