

2

STATE OF INDIANA  
LAKE COUNTY  
FILED FOR RECORD

2009 064623

2009 SEP 22 PM 2:00

MICHAEL A. BROWN  
RECORDER

STATE OF INDIANA )  
                                  ) SS:  
COUNTY OF LAKE )

**SWORN STATEMENT AND CLAIM OF LIEN**

To: Comfort INN  
c/o R & P Development, Inc.  
PO Box 106  
DeMotte, IN 46310

I, James R. Williams, being duly sworn, state as follows:

Notice is hereby given that on or about the 28th day of March, 2009, Peerless-Midwest, Inc., 55860 Russell Industrial Parkway, Mishawaka, Indiana, 46545, first provided labor or material for an improvement to the real estate located at 3550 E. 181<sup>st</sup> Ave., Hebron, IN 46341, and legally described as Parcel # 45-20-24-300-010.000-012

The owner of the above-described property is R & P Development, Inc.

The last day of providing the labor or material was on or about the 2nd day of August, 2009.

Peerless-Midwest, Inc., claims a mechanic's lien in the amount of \$19,283.00 on the above-described Property.

WARNING TO OWNER: THIS NOTICE IS REQUIRED BY INDIANA'S MECHANIC'S LIEN STATUTE. IF YOU HAVE QUESTIONS ABOUT YOUR RIGHTS AND DUTIES UNDER THIS ACT, YOU SHOULD CONTACT AN ATTORNEY TO PROTECT YOU FROM THE POSSIBILITY OF PAYING TWICE FOR THE IMPROVEMENTS TO YOUR PROPERTY.

Peerless-Midwest, Inc.

By *James R. Williams*  
James R. Williams, President  
Peerless-Midwest, Inc.  
55860 Russell Industrial Parkway  
Mishawaka, IN 46545

Date: September 22, 2009.

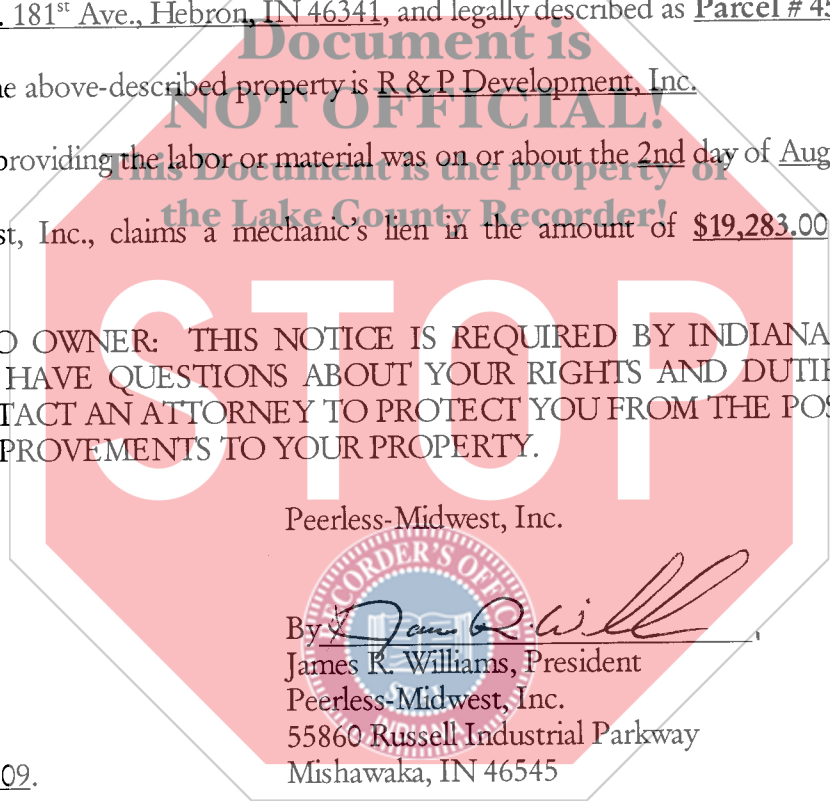

\$13  
CS  
CR

STATE OF INDIANA        )  
                                      ) SS:  
COUNTY OF ST. JOSEPH )

Subscribed and sworn to before me this 22nd day of September, 2009.

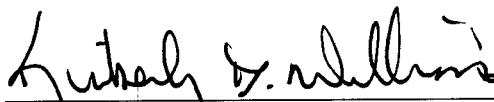

Kimberly D. Williams, Notary Public  
St. Joseph County, Indiana  
My commission expires: March 26, 2014

"I affirm under the penalties for perjury, that I have taken reasonable care to redact each Social Security number in this document, unless required by law."

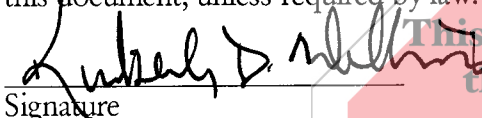

Signature

Kimberly D. Williams

Printed

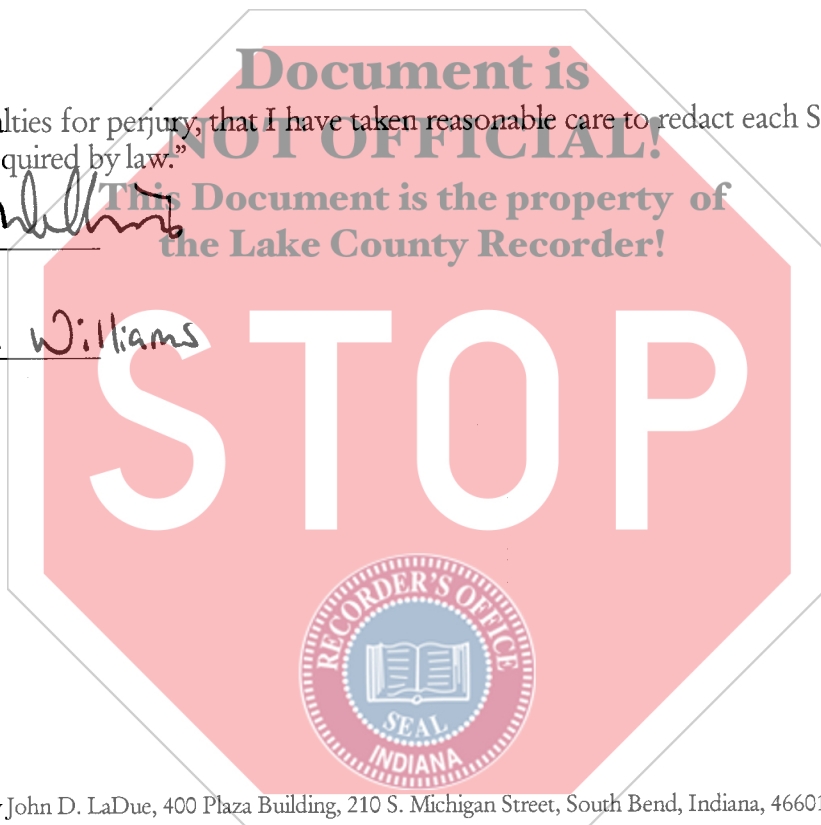

This document was prepared by John D. LaDue, 400 Plaza Building, 210 S. Michigan Street, South Bend, Indiana, 46601.