

2

STATE OF INDIANA )  
 )  
COUNTY OF LAKE )

SS: IN RE: LAURA M. EDDIE, DECEDENT

**COPY**

**AFFIDAVIT FOR TRANSFER OF REAL PROPERTY**

1. That the above-named decedent died intestate on July 16, 1995, while domiciled in Lake County, Indiana.

2. That forty-five (45) days have elapsed since the death of the decedent.

3. That no application or petition for the appointment of a personal representative is pending or has been granted in any jurisdiction, or is contemplated to be filed.

4. That the following named persons is the only heirs of the decedent:

Yolanda E. Eddie, daughter and Jesse E. Eddie, son, 230 Hovey Street, Gary, Indiana 46406.

5. That the value of the decedent's gross probate estate, less liens and encumbrances, does not exceed the sum of Fifty Thousand Dollars (\$50,000), as provided under IC §29-1-8-3, the costs of expenses of administration and reasonable funeral expenses.

6. That among the decedent's probate assets is a parcel of real estate which was owned by the decedent located in Lake County, Indiana, more particularly described as follows:

CORRECTED PLAT OF THE PERFECT ADD. AND THE RESUB. OF THE PERFECT ADD. L. 4 BL. H  
Commonly known as: 230 Hovey Street, Gary, Indiana 46406

7. That the following list of persons, firms, or corporations are the only creditors of the estate and the amount set opposite each name is the sum due said creditor, so far as the same is known to the affiant: NONE.

8. That the individual entitled to the real estate as a result of the decedent's death is Yolanda E. Eddie, daughter and Jesse E. Eddie, son of decedent, 230 Hovey Street, Gary, Indiana 46406.

45-07-01-235-009.000-004

DULY ENTERED FOR TAXATION SUBJECT TO FINAL ACCEPTANCE FOR TRANSFER

MAY 13 2009

PEGGY HOLINGA KATONA  
LAKE COUNTY AUDITOR

2009 03 27 21

2009 MAY 13 AM 10:01

STATE OF INDIANA  
LAKE COUNTY  
FILED FOR RECORD

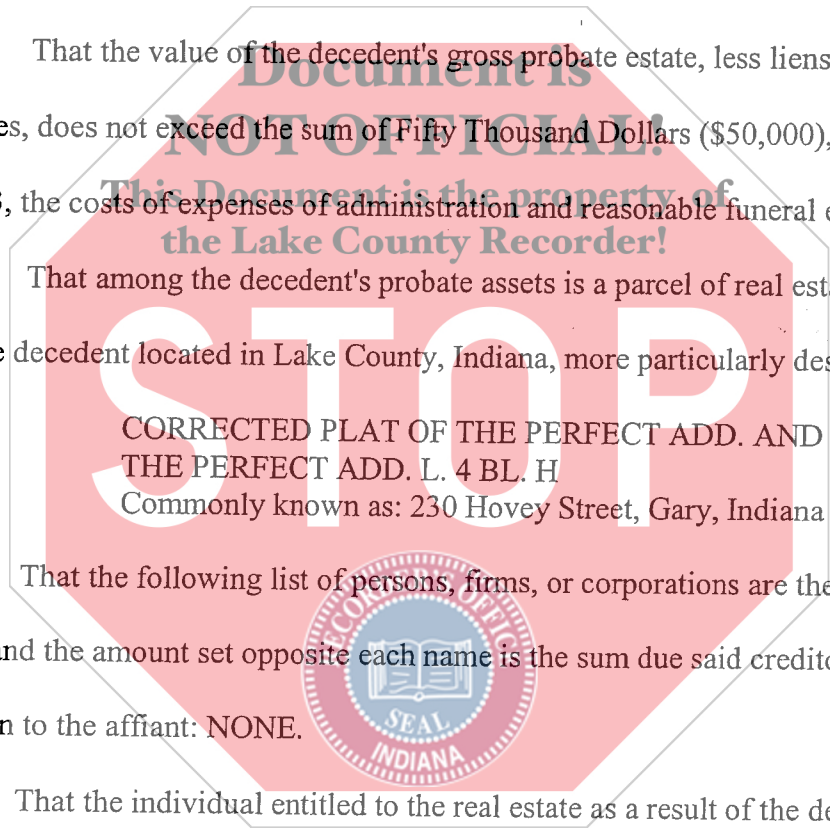

1400  
4933

RM  
003513

9. That by reason of the above-stated matters, the affiant requests that the above-listed real estate of Laura M. Eddie, be transferred to the heirs pursuant to the laws of intestate distribution, in accordance with the provisions of IC §29-1-8-1, §29-1-8-2, and §29-1-8-3.

Yolanda Eddie  
Yolanda E. Eddie, Affiant

I swear or affirm that the foregoing is true and accurate to the best of my knowledge and belief.

Yolanda Eddie  
Yolanda E. Eddie, Affiant

**I affirm under penalties for perjury, that I have taken reasonable care to redact each Social Security number in this document, unless required by law.**

Robert L. Lewis  
Affiant

Robert L. Lewis, 10070-45  
ROBERT L. LEWIS & ASSOCIATES  
Attorneys at Law  
2148 West 11<sup>th</sup> Avenue  
Gary, Indiana 46404  
219) 944-2755-phone

7

