

620070958CM 4 of 8  
\*\* This document is being corrected to correct legal description page 36 \*\*

2009 005495

STATE OF INDIANA  
LAKE COUNTY  
FILED FOR RECORD  
2009 JAN 30 PM 3:06  
MICHAEL A. BROWN  
RECORDER

**QUITCLAIM DEED**  
Lake County

THIS INDENTURE WITNESSETH, that, Elgin, Joliet and Eastern Railway Company, a Delaware corporation ("Grantor") of Allegheny County, in the State of Pennsylvania, QUITCLAIMS to EJ&E West Company, an Illinois corporation, whose address is: 2422 Gaylord Street Joliet, IL 60435, ("Grantee") for the sum of Ten Dollars (\$10.00) and other valuable consideration, the receipt of which is hereby acknowledged, the following described real estate, together with all fixtures and improvements of any kind thereon and including any after acquired title, located in Lake County, State of Indiana and legally described as follows:

See Attached Exhibit "A"

The address of such real estate is commonly known as trackage right of way having no common address. Future tax bills should be sent to Grantee at: 17641 S. Ashland Ave. Homewood, IL 60430.

IN WITNESS WHEREOF, Grantor has executed this deed this 12<sup>th</sup> day of January, 2009.

Grantor:

ELGIN, JOLIET AND EASTERN RAILWAY COMPANY,  
a Delaware corporation

Signature John A. Yokim

Printed: John A. Yokim

Title: Vice President - Finance

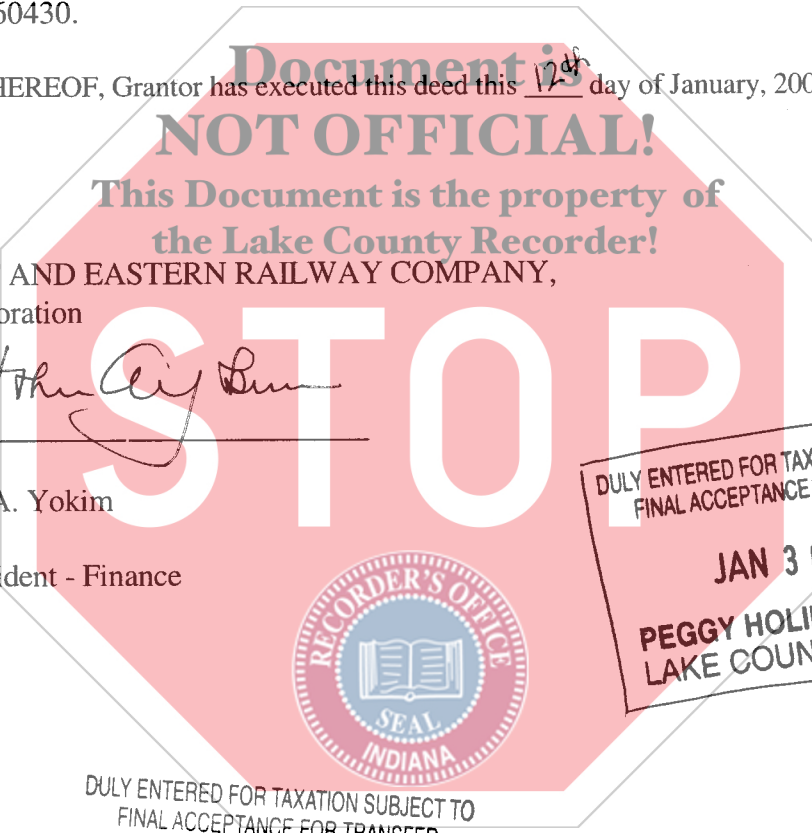

DULY ENTERED FOR TAXATION SUBJECT TO  
FINAL ACCEPTANCE FOR TRANSFER  
JAN 30 2009  
PEGGY HOLINGA KATONA  
LAKE COUNTY AUDITOR

DULY ENTERED FOR TAXATION SUBJECT TO  
FINAL ACCEPTANCE FOR TRANSFER

APR 30 2009

PEGGY HOLINGA KATONA  
LAKE COUNTY AUDITOR

STATE OF INDIANA  
LAKE COUNTY  
FILED FOR RECORD  
2009 MAY -1 AM 9:33  
MICHAEL A. BROWN  
RECORDER

Chicago Title Insurance Company

004113

\$ 112.00 CT PB

003284



# Exhibit A

## LEGAL DESCRIPTION

**Parcel: Map V-9-1:** Griffith—Section 2, Township 35 North, Range 9 West, and Sections 26, and 35 Township 36 North, Range 9 West.

A parcel of land described as follows: a strip of land varying in width located in said Sections 2, 26 and 35, beginning at a point in the north half of the Northwest Quarter of said Section 2 where the center line of the Grantor's main tracks intersects the Northwesterly boundary line of the parcel conveyed by a Quitclaim Deed dated October 10, 1924 from the Grand Trunk Western Railway Company to the Elgin, Joliet and Eastern Railway Company and recorded on November 21, 1924 in Book 341, Page 335 in Lake County, Indiana, thence running in a northerly direction along said railroad on, over and across the tracts of land in the Northwest Quarter of said Section 2, the west half of said Section 35, the west half of said Section 26, to a point in the North line of said Section 26 and there terminating, as conveyed by the following Deeds, Condemnations, and Contracts:

(i) an unrecorded contract dated May 6, 1889 from the Michigan Central Railroad to the Elgin, Joliet and Eastern Railway Company in Lake County, Indiana.

(ii) a Quitclaim Deed dated October 12, 1901 from Charles H. Ackert to the Elgin, Joliet and Eastern Railway Company and recorded on July 13, 1908 in Book 136, Page 322 in Lake County, Indiana.

(iii) a Condemnation dated September Term 1899 from John D. Ennis, et al to the Elgin, Joliet and Eastern Railway Company in Lake County, Indiana.

(iv) a Quitclaim Deed dated March 30, 1910 from Milton Sweigert to the Elgin, Joliet, and Eastern Railway Company and recorded on April 9, 1910 in Book 157, Page 483 in Lake County, Indiana.

(v) a Quitclaim Deed dated October 19, 1909 from Emory Schofield to the Elgin, Joliet, and Eastern Railway Company and recorded on October 20, 1909 in Book 153, Page 145 in Lake County, Indiana.

(vi) a Quitclaim Deed dated November 15, 1909 from Edwin Knight to the Elgin, Joliet, and Eastern Railway Company and recorded on November 24, 1909 in Book 153, Page 301 in Lake County, Indiana.

(vii) a Warranty Deed dated May 11, 1908 from Alice Wayne to the Elgin, Joliet, and Eastern Railway Company and recorded on May 11, 1908 in Book 139, Page 435 in Lake County, Indiana.

(viii) the Ordinance dated April 17, 1907 the Town of Griffith in Lake County, Indiana to the Elgin, Joliet and Eastern Railway Company in Lake County, Indiana, to a point in the north line of said Section 26 and there terminating, including therein all the rights, title and interest of the

Grantor in and to the aforesaid tracts of land and all streets and alleys, open or closed, within said parcel.

(ix) Excepting therefrom the land conveyed by a Quitclaim Deed dated March 17, 1948 from the Elgin, Joliet and Eastern Railway Company to the McFarland Lumber Company and recorded on April 11, 1966 in Book 806, Page 381 in Lake County, Indiana.



## LEGAL DESCRIPTION

**Parcel: Map V-9-2:** Gary and Grand Calumet River (Sections 2, 11, 14 and 23, Township 36 North, Range 9 West, Lake County, Indiana).

A parcel of land described as follows: a one hundred (100) foot strip of land through said Sections 23, 14, 11, and 2 beginning at a point where the center line of the Grantor's main track intersects the south line of said Section 23, and thence in running in a northerly direction along said railroad on, over and across said Section 23, said Section 14, said Section 11, and said Section 2 to a point in the north line of said Section 2, and there terminating.

Also, lots numbered (1) thru (13) in Block No. (5), as marked and laid down on the recorded plat of A.A. Lewis & Co.'s Oak Wood Subdivision being a subdivision of part of the west half of the Southeast Quarter of said Section 14, as the same appears of record Plat Book 23, Page 5 in the Recorder's Office of Lake County, Indiana, excepting therefrom those parcels of land conveyed by a Warranty Deed dated January 30, 1976 from the Elgin, Joliet and Eastern Railway Company to the Westinghouse Broadcasting Company in Lake County, Indiana.

Also, that parcel of land located in the north half of said Section 23 as conveyed by a Warranty Deed dated November 28, 1952 from A.H. Tapper to the Elgin, Joliet and Eastern Railway and recorded on November 28, 1952 in Book 927, Page 574 in Lake County, Indiana.

Also, those parcels of land described in a Deed of Conveyance dated April 27, 1931 from the Griffith and Northern Railway Company to the Elgin, Joliet and Eastern Railway Company in Lake County, Indiana.

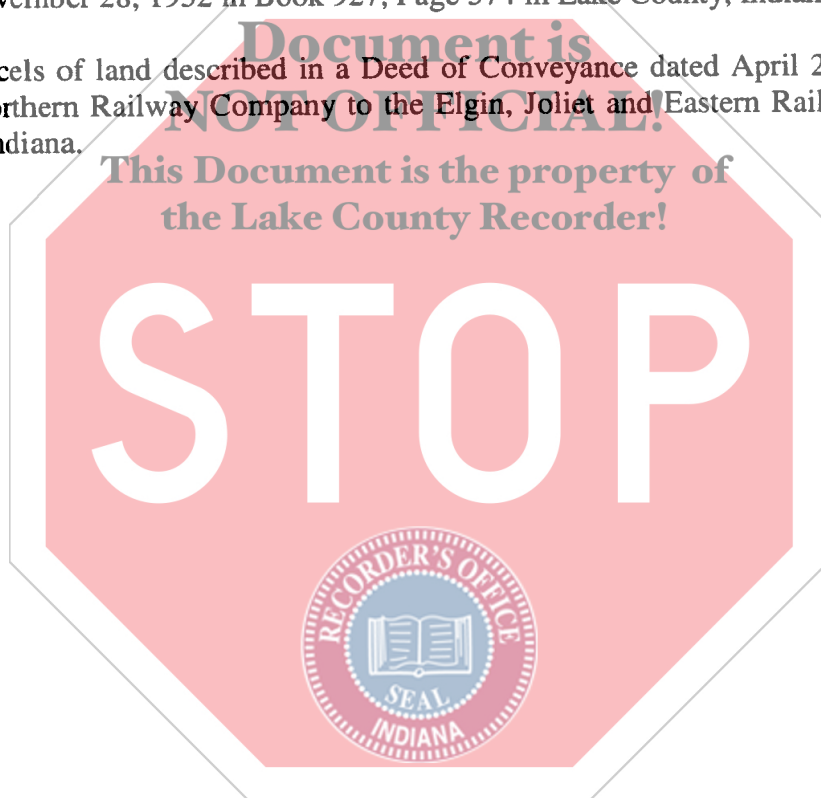

## LEGAL DESCRIPTION

**Parcel: Map V-9-3:** Shearson and Cavanaugh (Sections 33, 34 and 35, Township 37 North, Range 9 West, Lake County, Indiana).

A parcel of land described as follows: a one hundred (100) foot strip of land through the Southwest Quarter of said Section 35, beginning at point where the center line of the Grantor's main tracks intersects the south line of the Southwest Quarter of said Section 35 and thence running in a northerly direction along said railroad over and across the Southwest Quarter of said Section 35 to a point in the north line of the Southwest Quarter of said Section 35, and there terminating.

Also, that part of Lot 3 of the Southwest Quarter of said Section 35 conveyed by a Warranty Deed dated October 12, 1901 from Charles Ackert to the Elgin, Joliet and Eastern Railway Company and recorded on July 13, 1908 in Book 136, Page 322 in Lake County, Indiana, part of which is within said one hundred (100) foot strip.

Also, that part of Government Lot (3), lying East of the said one hundred (100) foot strip (as now located) in the Southwest Quarter of said Section 35, as conveyed by a Special Warranty Deed dated October 29, 1951 from Nicholas D. Connelly to the Elgin, Joliet, and Eastern Railway Company and recorded on November 7, 1951 as Document No. 572184 in Book 902, Page 391 in Lake County, Indiana.

Also, a parcel of land located in the Northwest Quarter of said Section 35, as conveyed by a Warranty Deed dated October 12, 1901 from Charles Ackert to the Elgin, Joliet and Eastern Railway Company and recorded on July 13, 1908 in Book 136, Page 322 in Lake County, Indiana.

Also, a one hundred (100) foot strip of land through the north half of said Section 34 as conveyed by a Warranty Deed dated October 12, 1901 from Charles Ackert to the Elgin, Joliet and Eastern Railway Company and recorded on July 13, 1908 in Book 136, Page 322 in Lake County.

Also, an irregular strip located in the Northeast Quarter of said Section 34 lying south of and adjacent to the last described one hundred (100) foot strip as conveyed by a Warranty Deed dated October 12, 1901 from Charles Ackert to the Elgin, Joliet and Eastern Railway Company and recorded on July 13, 1908 in Book 136, Page 322 in Lake County.

Also, a parcel land located in the Northeast Quarter of said Section 33, as conveyed by a Warranty Deed dated October 12, 1901 from Charles Ackert to the Elgin, Joliet and Eastern Railway Company and recorded on July 13, 1908 in Book 136, Page 322 in Lake County, Indiana.

Also, a strip of land located in the Northwest Quarter of said Section 35, as conveyed by a Quit Claim Deed dated June 19, 1941 from Gary Land Company to the Elgin, Joliet and Eastern Railway Company in Lake County, Indiana.

Also, a strip of land located in the Northwest Quarter of said Section 35, as conveyed by Special Warranty Deed dated March 17, 1951 from Vulcann Detinning Company to the Elgin, Joliet and Eastern Railway Company in Lake County, Indiana.

Also, those parcels of land described in a Deed of Conveyance dated April 27, 1931 from the Griffith & Northern Railway Company to the Elgin, Joliet and Eastern Railway Company in Lake County, Indiana.

Also, those parcels of land located in the west half of said Section 35, as conveyed by a Warranty Deed dated February 22, 1983 from Indiana Department of Highways Toll Road Division to the Elgin, Joliet and Eastern Railway Company in Lake County, Indiana.

Also, a strip of land located in the Northwest Quarter of said Section 34, as conveyed by a Quitclaim Deed dated November 17, 1930 from Grasselli Chemical Company to the Elgin, Joliet and Eastern Railway Company and recorded on January 1, 1931 in Book 472, Page 551 in Lake County, Indiana.

Also, all the rights title and interest in and to the land located in the Northeast Quarter of said Section 34 granted to the Grantor pursuant to that unrecorded contract dated November 9, 1908 between the City of East Chicago and the Elgin, and Joliet and Eastern Railway Company in Lake County, Indiana.



## LEGAL DESCRIPTION

**Parcel: Map V-5-1:** Illinois/Indiana Border Section 12, Township 35 North, Range 10 West, and Sections 7, Township 35 North, Range 9 West, Lake County, Indiana.

Parcel 1:

Tracts of land (varying in width) containing Grantor's main tracks commencing a point where the center line of said tracks intersect the west line of the Southwest Quarter of said Section 12 (which is also the county line for Lake County, Indiana) and thence running in an easterly direction over and across the following tracts of land conveyed by the following deeds:

A Warranty Deed dated February 20, 1888 from Martha R. Hart to the Elgin, Joliet and Eastern Railway Company and recorded on May 15, 1888 in Book 44, Page 35 in Lake County, Indiana.

A Warranty Deed dated December 10, 1951 from Frank H. Keilman to the Elgin, Joliet and Eastern Railway Company and recorded on March 8, 1952 in Book 909, Page 513 in Lake County, Indiana.

A Warranty Deed dated February 14, 1888 from Julia B. Hart to the Elgin, Joliet and Eastern Railway Company and recorded on February 16, 1888 in Book 42, Page 498 in Lake County, Indiana.

A Warranty Deed dated January 17, 1888 from Malcom T. Hart to the Elgin, Joliet and Eastern Railway Company and recorded on January 23, 1888 in Book 42, Page 426 in Lake County, Indiana.

A Warranty Deed dated January 7, 1888 from Nicholas Hoffman to the Elgin, Joliet and Eastern Railway Company and recorded on January 23, 1888 in Book 42, Page 422 in Lake County, Indiana.

A Warranty Deed dated February 6, 1888 from John Rohrman to the Elgin, Joliet and Eastern Railway Company and recorded on February 10, 1888 in Book 42, Page 480 in Lake County, Indiana.

A Warranty Deed dated May 21, 1888 from Anthony Scheidt to the Elgin, Joliet and Eastern Railway Company and recorded on May 25, 1888 in Book 44, Page 49 in Lake County, Indiana.

A Warranty Deed dated March 25, 1950 from Frank J. Johnson to the Elgin, Joliet and Eastern Railway Company and recorded on May 12, 1950 in Book 861, Page 283 in Lake County, Indiana.

A Warranty Deed dated May 19, 1950 from Jess O. Young to the Elgin, Joliet and Eastern Railway Company and recorded on June 19, 1950 in Book 864, Page 377 in Lake County, Indiana.



A Warranty Deed dated March 25, 1950 from Wilmer T. Harbath to the Elgin, Joliet and Eastern Railway Company and recorded on May 23, 1950 in Book 861, Page 282 in Lake County, Indiana.

A Quit Claim dated January 1, 1892 from F.E. Worchester to the Elgin, Joliet and Eastern Railway Company and recorded on February 1, 1892 in Book 59, Page 336 in Lake County, Indiana, to a point in the east line of the above described Parcel 18, and there terminating located in Southeast Quarter of said Section 12.

Parcel 2:

A parcel of land described as follows: a one hundred (100) foot strip of land through said Sections 12, 7, beginning at a point where the center line of the Grantor's main tracks intersects the east boundary line of Parcel 1 described above (also being the eastern boundary line of Parcel 18), and thence running in an easterly and northeasterly direction along said railroad on, over and across the Southeast Quarter of said Section 12, the south half, and the Northeast Quarter of said Section 7, to a point in the east line of the Northeast Quarter of said Section 7 and there terminating.

Also, a strip of land fifty (50) foot in width adjacent and contiguous to the southerly boundary line said one hundred (100) foot strip described above and located over and across the Southeast Quarter of said Section 12, and the south half of said Section 7 as conveyed by the following deeds:

(i) a Warranty Deed dated July 22, 1927 from Mary Keilman to the Elgin, Joliet and Eastern Railway Company in Lake County, Indiana.

(ii) a Warranty Deed dated April 30, 1927 from John Keilman to the Elgin, Joliet and Eastern Railway Company in Lake County, Indiana.

(iii) a Warranty Deed dated April 30, 1927 from Ideal Land & Development Company to the Elgin, Joliet and Eastern Railway Company in Lake County, Indiana.

Also, a strip of land sixty (60) foot in width connecting the Grantor's said one hundred (100) foot strip with the main track of the Louisville, New Albany and Chicago Railroad located in the Southeast Quarter of said Section 12 as conveyed by a Warranty Deed dated August 29, 1888 from Nicholas Schitz to the Elgin, Joliet and Eastern Railway Company and recorded on September 6, 1888 in Book 44, Page 157 in Lake County, Indiana.

Also, all the rights, title and interest in and to the land located in the Southeast Quarter of said Section 12 and conveyed to the Grantor pursuant to that unrecorded contract dated as the August 30, 1888 from Louisville, New Albany and Chicago Railroad to the Elgin, Joliet and Eastern Railway Company.

Also, all the rights, title and interest in and to the land located over and across the Southeast Quarter of said Section 12 and conveyed to the Grantor pursuant to that unrecorded Agreement

dated August 1, 1895 by and between Louisville, New Albany and Chicago Railroad and the Elgin, Joliet and Eastern Railway Company.

Also, all the rights, title and interest in and to the right of way located in the Southeast Quarter of said Section 12 and conveyed to the Grantor pursuant that Instrument of Appropriation dated as the April Term 1894 in Lake County Circuit Court from John Boos, et al to the Elgin, Joliet and Eastern Railway Company.



## LEGAL DESCRIPTION

**Parcel: Map V-5-2:** Hobart—Sections 2, 3, 4, 5 and 8, Township, 35 North, Range 9 West, and Section 35, Township 36 North, Range 9 West, Lake County, Indiana.

A parcel of land described as follows: a one hundred (100) foot strip of land through said Sections 8, 5, 4, 3 and 2, beginning at a point where the center line of the Grantor's main tracks intersects the west boundary line of the Northwest Quarter of said Section 8, and thence running in a northeasterly direction along said railroad on, over and across the north half of said Section 8, Southeast Quarter of said Section 5, the south half of said Section 4, the Southwest Quarter of said Section 3, the north half of said Section 3, and the Northwest Quarter of said Section 2, to a point in the east line of Northwest Quarter of said Section 2 and there terminating.

Also, a strip of land one hundred (100) feet in width adjacent and contiguous to the southern boundary line of said one hundred (100) foot strip located over and across the Southeast Quarter of said Section 4 as conveyed by a Trustees Deed dated June 15, 1950 from George M. Fishtorn et. al as Trustees to the Elgin, Joliet and Eastern Railway Company and recorded on June 19, 1950 in Book 864, Page 281 in Lake County, Indiana.

Also, a strip of land one hundred (100) feet in width, more or less adjacent and contiguous to the southern boundary line of said one hundred (100) foot strip located over and across the west half and the Northeast Quarter of said Section 3 as conveyed by a Warranty Deed dated April 19, 1917 from Solomon H. Goldberg to the Elgin, Joliet and Eastern Railway Company and recorded on April 28, 1917 in Book 232, Page 410 in Lake County, Indiana.

Also, a strip of land forty (40) feet in width, more or less adjacent and contiguous to the southern boundary line of the last described one hundred (100) foot strip located over and across the west half and the Northeast Quarter of said Section 3 as conveyed by a Warranty Deed dated July 25, 1946 from David McIntee et. al Trustees under the Soloman H. Goldberg Properties Trust to the Elgin, Joliet and Eastern Railway Company and recorded as Document No. 235911 in Book 759, Page 234 in Lake County, Indiana.

Also, a strip of land twenty (20) feet in width, more or less adjacent and contiguous to the first described one hundred (100) foot strip located over and across the said Section 3 as conveyed by a Warranty Deed dated July 25, 1946 from David McIntee et. al as Trustees under the Soloman H. Goldberg Properties Trust to the Elgin, Joliet and Eastern Railway Company and recorded as Document No. 235911 in Book 759, Page 234 in Lake County, Indiana.

Also, a parcel of land one hundred twenty (120) feet in width, located over and across the Northeast Quarter of said Section 3 as conveyed by a Warranty Deed dated August 1, 1950 from David McIntee et al. Trustees under the Soloman H. Goldberg Properties Trust to the Elgin, Joliet and Eastern Railway Company and recorded on November 11, 1950 in Book 873, Page 165 in Lake County, Indiana.

Also, those parcels of land adjacent and contiguous to the southern boundary line of the said one hundred (100) foot strip first above described, located over and across the Southeast Quarter and

Southwest West Quarter of said Section 4 as conveyed by a Quitclaim Deed dated December 31, 1913 from the Pittsburgh, Cincinnati, Chicago, and St. Louis Railway Company to the Elgin, Joliet and Eastern Railway Company and recorded on June 26, 1914 in Book 204, Page 101 in Lake County, Indiana. Excepting therefrom those parcels of land conveyed by the following Deeds: (i) a Quitclaim Deed dated July 26, 1966 from the Elgin, Joliet and Eastern Railway Company et al, to C.S. McCrossan, Inc; (ii) a Quitclaim Deed dated February 18, 1970 from the Elgin, Joliet and Eastern Railway Company et al, to the Midwest Piping Coating, Inc.

Also, a parcel of land located in the Northwest Quarter of said Section 2 as conveyed by a Warranty Deed dated July 27, 1888 from George J. Bipphus as Trustee to the Elgin, Joliet and Eastern Railway Company and recorded on October 16, 1888 in Book 44, Page 209.

Also, all the rights title and interest in and to the land granted to the Grantor pursuant to that condemnation dated April 1888 from Mathias Miller, et. al to the Elgin, Joliet and Eastern Railway Company affecting a parcel of land located in the Northwest Quarter of said Section 2.

Also, a parcel of land part of which is included in said one hundred (100) foot strip, first above described, located in the Northwest Quarter of said Section 2 as conveyed by a Quitclaim Deed dated October 10, 1924 from the Grand Trunk Western Railway Company to the Elgin, Joliet and Eastern Railway Company and recorded on November 21, 1924 in Book 341, Page 335 in Lake County, Indiana.

Also, a strip of land located in the north half of the Northeast Quarter of said Section 2 as conveyed by a Warranty Deed dated March 14, 1888 from Peter Young to the Elgin, Joliet and Eastern Railway Company and recorded on March 14, 1888 in Book 42, Page 543 in Lake County, Indiana.

Also, parcels of land located in south half of the Southeast Quarter of said Section 35 as conveyed by a Warranty Deed dated March 26, , 1888 from Jacob Helfen to the Elgin, Joliet and Eastern Railway Company and recorded on July 30, 1888 in Book 44, Page 120 in Lake County, Indiana.

Also, all the rights, title and interest of the Grantor pursuant that unrecorded sublease dated August 26, 2000, between Norfolk Southern Railway Company, as lessee of Pennsylvania line LLC, and the Elgin, Joliet and Eastern Railway Company, and by an agreement dated June 14, 1888 among the Chicago, St. Louis and Pittsburg Railroad Company, the Michigan Central Railroad Company and EJ&E as supplemented by an Agreement dated April 1, 1922 among the Pittsburgh, Cincinnati, Chicago & St. Louis Railroad Company, the EJ&E and the Michigan Central Railroad Company, and supplemental agreements dated January 2, 1934, October 28, 1964 and February 6, 1968.

Also, all the rights title and interest in and to the land granted to the Grantor pursuant to a following conveyances: (i) a Quitclaim Easement dated March 29, 1982 from L.B. Foster to the Elgin, Joliet and Eastern Railway Company and recorded on April 13, 1982 as Document No. 665668 in Lake County, Indiana; (ii) a Quitclaim Deed dated June 1, 1982 from the Chesapeake and Ohio Railway Company to the Elgin, Joliet and Eastern Railway Company and recorded on

July 13, 1982 as Document No. 674504 in Lake County, Indiana; (iii) Quitclaim Deed dated August 5, 1982 from American Chemical Service to the Elgin, Joliet and Eastern Railway Company and recorded on September 8, 1982 as Document No. 680203 in Lake County, Indiana; (iv) a Quitclaim Deed dated February 14, 1984 from United Railroad Corporation to the Elgin, Joliet, and Eastern Railway Company and recorded on June 7, 1984 in Lake County, Indiana.



## LEGAL DESCRIPTION

**Parcel: Map V-10-1:** East Chicago (Sections 33 and 32, Township 37 North, Range 9 West, Lake County, Indiana).

A parcel of land described as follows: a one hundred (100) foot strip of land through said Sections 33 and 32, beginning at a point where the Grantor's main track intersects the east line of the Northwest Quarter of said Section 33, and thence running in a westerly direction along said railroad on, over and across the Northwest Quarter of said Section 33, and the Northeast Quarter of said Section 32, to a point in the west line of the Northeast Quarter of said Section 32 and there terminating.

Also, all the rights, title and interest in and to the land located in the above described said Sections and conveyed to the Grantor pursuant the following unrecorded contracts:

(i) a contract dated December 12, 1896 between the Chicago & Calumet Terminal Railway Company and the Western Indiana Railway Company (a predecessor of EJ&E), as supplemented by an agreement dated June 1, 1906 between the receiver of the Chicago Terminal Transfer Railroad Company and EJ&E;

(ii) a contract dated December 21, 1896 between the Chicago & Calumet Terminal Railway Company and the Western Indiana Railway Company (a predecessor of EJ&E), as supplemented by an agreement dated June 1, 1906 between the receiver of the Chicago Terminal Transfer Railroad Company and EJ&E;

(iii) a contract dated September 1, 1896 between East Chicago Belt Railroad to the Western Indiana Railroad Company.

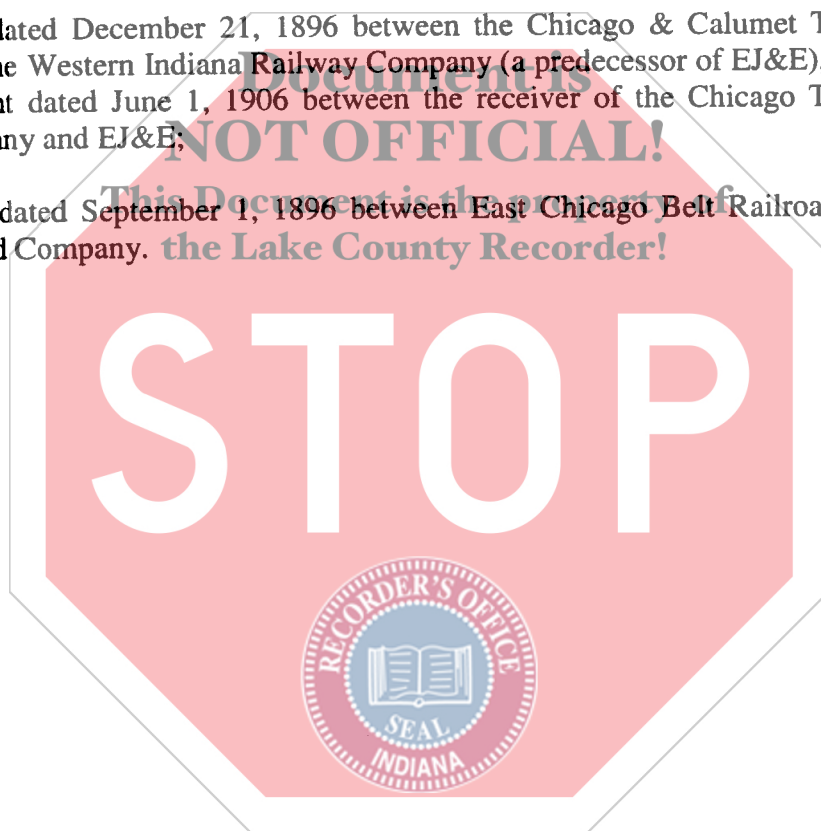

## LEGAL DESCRIPTION

**Parcel: Map V-10-2:** Hammond Sections 31, 32 Township 37 North Range 9 West, and Sections 36 and 25 Township 37 North, Range 10 West in Lake County, Indiana.

A strip of land of variable width through said Sections 32, 31, 36 and 25, beginning at point where the Grantor's main track intersects the east line of the Northwest Quarter of said Section 32, and thence running in a westerly direction along said railroad across the Northwest Quarter of said Section 32, the north half of said Section 31, the Northeast Quarter of said Section 36, and the south half of said Section 25 to a point in the western boundary parcel, as conveyed by a Warranty Deed dated July 20, 1896 from Marcus M. Towle to the Western Indiana Railway Company and recorded on July 12, 1896 in Book 79, Page 179 in Lake County, Indiana and there terminating.

Also, a strip of land located in the west half of the Northeast Quarter of said Section 31 adjacent and contiguous to the above described strip as conveyed by a Quitclaim Deed dated June 13, 1893 from Corning Steel Company to the Western Indiana Railway Company and recorded on August 6, 1896 in Book 78, Page 392 in Lake County, Indiana.

Also, a parcel of land located in the south half of the Southwest Quarter of said Section 25 as conveyed by a Quitclaim Deed dated August 24, 1906 from Sarah Meyer to the Elgin, Joliet and Eastern Railway and recorded on August 29, 1906 in Book 122, Page 551 in Lake County, Indiana.

Also, parcels of land located in the Southeast Quarter of said Section 25 and the Northeast Quarter of said Section 36 as conveyed by a Special Warranty Deed dated September 18, 1972 from Amsted Industries Incorporated to the Elgin, Joliet and Eastern Railway Company and recorded on October 3, 1973 as Document No. 223679 in Lake County, Indiana, excepting therefrom the following Deeds:

- (i) a Quitclaim Deed dated July 20, 1973 from the Elgin, Joliet and Eastern Railway Company to Sheffield Scrap Corporation.
- (ii) a Quitclaim Deed dated September 18, 1972 from the Elgin, Joliet and Eastern Railway Company to Amsted Industries Incorporated and recorded on October 3, 1973 as Document No. 223681 in Lake County, Indiana.

Also, all the rights, title and interest of the Grantor pursuant to the following unrecorded contracts:

- (i) A contract dated September 1, 1896 between East Chicago Belt Railroad and the Western Indiana Railway Company.
- (ii) A contract dated February 16, 1914 between Hammond Asphalt Products Company and the Elgin, Joliet and Eastern Railway.
- (iii) A contract dated October 21, 1912 between Simplex Railroad Appliance Company and the Elgin, Joliet and Eastern Railway.

(iv) A contract dated May 11, 1897 between Hammond Milling Company and the Western Indiana Railway Company.

(v) A contract dated July 2, 1906 between Simplex Railroad Appliance Company and the Elgin, Joliet and Eastern Railway.

(vi) A contract dated April 28 1906 between H.W.& E.C.E. and the Elgin, Joliet and Eastern Railway.





## LEGAL DESCRIPTION

**Parcel: Map V-10-3:** Whiting (Sections 17, 20, 21 28, and 33 Township 37 North, Range 9 West).

A parcel of land described as follows: a one hundred (100) foot strip of land through said Sections, 33, 28, 21, 20, and 17 beginning at a point where the Grantor's main track intersects the west line of the Northeast Quarter of said Section 33, and thence running in a northerly direction along said railroad on, over and across the Northeast Quarter of said Section 33, the east half of said Section 28, the Southeast Quarter of said Section 21, the west half of said Section 21, the Northeast Quarter of said Section 20, the Southeast Quarter of said Section 17, to a point in the North line of the of the Southeast Quarter of the said Section 17 and there terminating.

Also, those parcels of land conveyed by the following deeds:

(i) A Warranty Deed dated March 13, 1918 from Indiana Harbor Belt Railroad Company to Elgin, Joliet and Eastern Railway Company in Lake County, Indiana.

(ii) A Warranty Deed dated October 1, 1917 from Standard Oil Company to Elgin, Joliet and Eastern Railway Company in Lake County, Indiana.

(iii) A Quitclaim Deed dated December 22, 1945 from Indiana Harbor Belt Railroad Company to Elgin, Joliet and Eastern Railway Company in Lake County, Indiana.

(iv) A Quitclaim Deed dated August 27, 1929 from East Chicago Co. to the Elgin, Joliet and Eastern Railway Company in Lake County, Indiana.

(v) A Quitclaim Deed dated August 27, 1929 from East Chicago Co. to the Elgin, Joliet and Eastern Railway Company in Lake County, Indiana.

Also, all the rights, title and interest in and to the land located in the above described said Sections and conveyed to the Grantor pursuant the following unrecorded contracts:

(i) A Contract dated December 31, 1896 from C & CT Railway to the Western Indiana Railroad Company in Lake County, Indiana.

(ii) A Contract dated December 31, 1896 from S.L. & I.C. Railway to the Western Indiana Railroad Company in Lake County, Indiana.

(iii) A Contract dated July 22, 1896 from Calumet Canal & Imp. Co. to the Western Indiana Railroad Company in Lake County, Indiana.

(iv) A Contract dated April 25, 1907 from H.B. Refractories Co. to the Elgin, Joliet and Eastern Railway Company in Lake County, Indiana.

(v) A Contract dated October 20, 1903 from AM Steel Foundries to the Elgin, Joliet and Eastern Railway Company in Lake County, Indiana.

(vi) A Contract dated July 29, 1907 from C.I. & S. Railway to the Elgin, Joliet and Eastern Railway Company in Lake County, Indiana.



## **LEGAL DESCRIPTION**

**Parcel: Map V-12-1:** Calumet Township (Sections 25, 26, 35 Township 37 North, Range 9 West, Lake County, Indiana).

A strip of land of variable width through said Sections 35, 26 and 25, beginning at a point where the Grantor's maintrack intersects the west line of the Northeast Quarter of said Section 35, and thence running in a northeasterly direction along said railroad on, over and across the Northeast Quarter of said Section 35, the Southeast Quarter of said Section 26, and the Southwest Quarter of said Section 25, and thence running in a southeasterly direction along said railroad on, over and across the Southeast Quarter of said Section 25 to a point in the east line of the Southeast Quarter of said Section 25 and there terminating.

Also, a parcel of land located in the Southwest Quarter of said Section 25 and the east half of the Southeast Quarter of said Section 26 part of which is located in the said one hundred fifty (150) foot strip, as conveyed by a Warranty Deed dated October 26, 1908 from So. Chicago & Sou. R.R. to the Chicago, Lake Shore and Eastern Railway Company and recorded on January 18, 1909 in Book 142, Page 198 in Lake County, Indiana.

Also, all the rights title and interest in and to the Grantor pursuant to an unrecorded contract dated September 3, 1907 from the Pennsylvania Company to the Lake Shore and Eastern Railway Company.

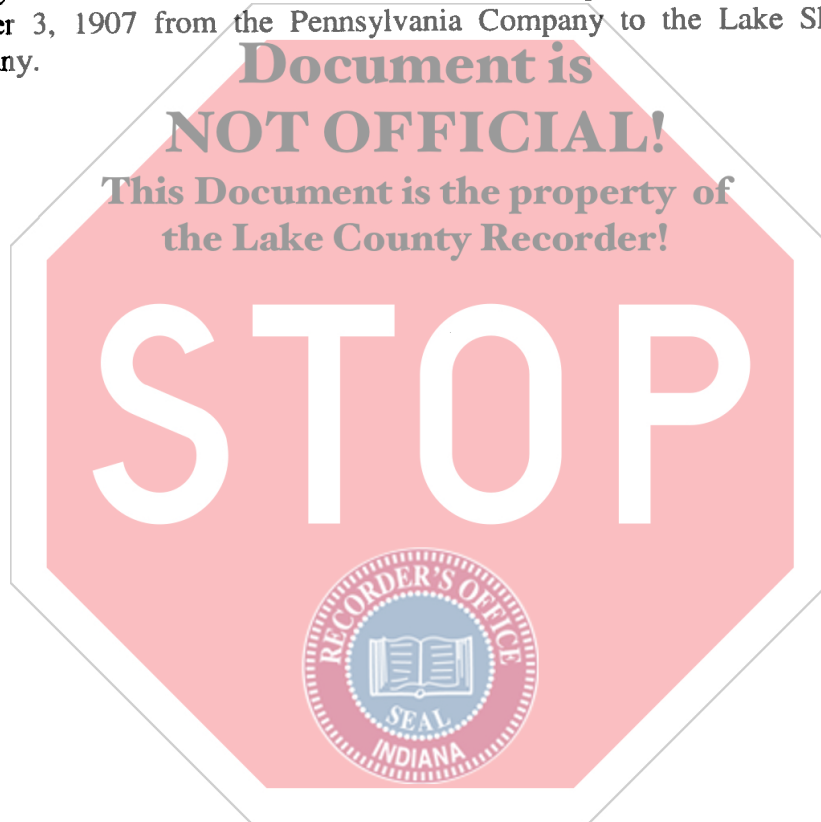

**Parcel: Map V-12-3:** Westmont Lead (Section 2, Township 36 North, Range 8 East, Lake County, Indiana).

Those parcels of land described in (i) the Warranty Deed from Gary Land Company to Elgin, Joliet and Eastern Railway Company dated November 6, 1945 and recorded March 8, 1946, in Book 742, Page 395, in Lake County, Indiana and (ii) the Warranty Deed from Alexander A. Gariup and Mary Gariup, his wife, and Elio L. Largura and Ruth Largura, his wife, to Elgin, Joliet and Eastern Railway Company dated October 1, 1947 and recorded October 24, 1947, in Book 796, Page 249, in Lake County, Indiana, EXCEPTING FROM SUCH PARCELS the land and improvements, if any, conveyed by the following: Warranty Deed from Elgin, Joliet and Eastern Railway Company to Alexander A. Gariup and Elio L. Largura, co-partners doing business as Superior Construction Company, dated September 12, 1947 and recorded October 24, 1947, in Book 796, Page 245, in Lake County, Indiana; Special Warranty Deed from Elgin, Joliet and Eastern Railway Company to Alexander A. Gariup and Elio L. Largura, co-partners doing business as Superior Construction Company, dated May 10, 1959 and recorded May 12, 1950, in Book 861, Page 448, as document number 468293, in Lake County, Indiana; Warranty Deed from Elgin, Joliet and Eastern Railway Company to The Indiana Toll Road Commission, dated January 17, 1956 and recorded January 23, 1956 in Book 1019, Page 587, as document number 899844, in Lake County, Indiana; and Special Warranty Deed from Elgin, Joliet and Eastern Railway Company to the State of Indiana, dated September 15, 1980.



## LEGAL DESCRIPTION

**Parcel: Map V-14-1:** (North Township, Section 36, Township 38 North, Range 10 West, and Section 1, Township 37 North, Range 10 West, Lake County, Indiana).

A parcel of land described as follows: A strip of land, varying in width, beginning at the point where Grantor's main track intersects the west line of the northwest quarter of said Section 36 (said west line of the northwest quarter of Section 36 also being the boundary line between Cook County, Illinois and Lake County, Indiana) and thence running in a southeasterly direction along said railroad on, over and across the west half of said Section 36, the southeast quarter of said Section 36 and the northeast quarter of said Section 1, to a point in the east line of the northeaster quarter of said Section 1 and there terminating, which strip of land is intended to include all land owned by Grantor and used for railroad purposes along each side of such centerline.

Also, those parcels of land, some of which are located wholly or in part within the strip of land described above, conveyed by the following deeds and other instruments:

Warranty Deed from Frederick A. Eggers and Wife to Chicago Lake Shore and Eastern Railway Company dated February 17, 1896 and recorded February 18, 1896 in Book 77, Page 257, in Lake County, Indiana.

Warranty Deed from Baltimore and Ohio and Chicago Railroad to Chicago Lake Shore and Eastern Railway Company dated April 18, 1896 and recorded December 14, 1896 in Book 79, Page 414, in Lake County, Indiana.

Quitclaim Deed from Baltimore & Ohio Railroad to Chicago Lake Shore and Eastern Company dated September 28, 1896 and recorded December 14, 1896 in Book 79, Page 412, in Lake County, Indiana.

Condemnation proceeding by Chicago Lake Shore and Eastern Railway Company against Edward Roby, et al., Cause No. 4191, dated August 17, 1896.

Warranty Deed from Caroline M. Forsyth and Husband to Chicago Lake Shore and Eastern Railway Company dated November 9, 1895 and recorded November 11, 1895 in Book 74, Page 525, in Lake County, Indiana.

Warranty Deed from Baltimore and Ohio and Chicago Railroad to Chicago Lake Shore and Eastern Railway Company dated April 18, 1896 and recorded December 14, 1896 in Book 79, Page 414, in Lake County, Indiana.

Quitclaim Deed from Baltimore and Ohio Railroad to Chicago Lake Shore and Eastern Railway Company dated September 28, 1896 and recorded December 14, 1896 in Book 79, Page 412, in Lake County, Indiana.

EXCEPTING FROM THE FOREGOING PARCELS, TO THE EXTENT INCLUDED THEREIN, THE LAND AND IMPROVEMENTS, IF ANY, AND/OR INTERESTS THEREIN GRANTED AND/OR CONVEYED BY THE FOLLOWING INSTRUMENTS:

Quitclaim Deed from Elgin Joliet & Eastern Railway to Hammond Port Authority dated November 28, 1988.



## LEGAL DESCRIPTION

**Parcel: Map V-14-2:** Whiting (North Township, Sections 5, 6, 7, 8, 9 and 16, Township 37 North, Range 9 West, Lake County, Indiana).

A parcel of land described as follows: A strip of land, varying in width, beginning at the point where Grantor's main track intersects the west line of the northwest quarter of said Section 6, and thence running in a southeasterly direction along said railroad, on, over and across the west half of said Section 6, the southeast quarter of said Section 6, the southwest corner of the southwest quarter of said Section 5, the northeast corner of the northeast quarter of said Section 7, the north half of said Section 8, the southeast quarter of said Section 8, the southwest quarter of said Section 9, the northwest quarter of said Section 16 and the northeast quarter of said Section 16, the northeast corner of the southeast quarter of said Section 16 and the west half of said Section 15, to a point in the south line of said Section 15 and there terminating, which strip of land is intended to include all land owned by Grantor and used for railroad purposes along each side of such centerline.

Also, those parcels of land, some of which are located wholly or in part of the strip of land described above, conveyed by the following deeds and other instruments:

Warranty Deed dated March 27, 1895, from Agnes Roberts, a Widow to William G. Brimson recorded March 28, 1895, in Book 73, Page 552.

Quit Claim Deed dated November 25, 1895, from William G. Brimson and Wife to Chicago Lake Shore & Eastern Railway recorded December 23, 1895, in Book 5508, Page 464.

Warranty Deed dated March 27, 1895, from Agnes Roberts, a Widow to William G. Brimson recorded March 28, 1895, in Book 73, Page 552.

Quit Claim Deed dated November 25, 1895, from William G. Brimson and Wife to Chicago Lake Shore & Eastern Railway recorded December 23, 1895, in Book 5508, Page 464.

Guardian's Deed dated May 22, 1895, from Agnes Roberts, Guardian of Mary A. Roberts and Amy J. Roberts to Chicago Lake Shore & Eastern Railway recorded May 24, 1895, in Book 74, Page 150.

Guardian's Deed dated November 18, 1895, from Agnes Roberts, Guardian of Mary A. Roberts and Amy J. Roberts to Chicago Lake Shore & Eastern Railway recorded December 11, 1895, in Book 77, Page 101.

Warranty Deed dated November 9, 1895, from Caroline M. Forsyth to Chicago Lake Shore & Eastern Railway recorded November 11, 1895, in Book 74, Page 525.

Warranty Deed dated April 18, 1896, from Baltimore & Ohio & Chicago Railway Company to Chicago Lake Shore & Eastern Railway recorded December 14, 1896, in Book 79, Page 414.

Quitclaim Deed dated September 28, 1896, from Baltimore & Ohio Railroad to Chicago Lake Shore & Eastern Railway recorded December 14, 1896, in Book 79, Page 412.

Quit Claim Deed dated February 12, 1896, from Lake Shore & Michigan Southern Railway Company to Chicago Lake Shore & Eastern Railway recorded March 6, 1896, in Book 77, Page 296.

Warranty Deed dated April 18, 1896, from Baltimore & Ohio & Chicago Railway Company to Chicago Lake Shore & Eastern Railway recorded December 14, 1896, in Book 79, Page 414.

Quit Claim Deed dated September 28, 1896, from Baltimore & Ohio Railroad to Chicago Lake Shore & Eastern Railway recorded December 14, 1896, in Book 79, Page 412.

Warranty Deed dated November 9, 1895, from Caroline M. Forsyth to Chicago Lake Shore & Eastern Railway recorded November 11, 1895, in Book 74, Page 525.

Warranty Deed dated August 14, 1895, from Standard Oil Company to Chicago Lake Shore & Eastern Railway recorded September 16, 1895, in Book 74, Page 397.

Warranty Deed dated April 18, 1896, from Baltimore & Ohio & Chicago Railway Company to Chicago Lake Shore & Eastern Railway recorded December 14, 1896, in Book 79, Page 414.

Quit Claim Deed dated September 28, 1896, from Baltimore & Ohio Railroad to Chicago Lake Shore & Eastern Railway recorded December 14, 1896, in Book 79, Page 412.

Warranty Deed dated April 18, 1896, from Baltimore & Ohio & Chicago Railway Company to Chicago Lake Shore & Eastern Railway recorded December 14, 1896, in Book 79, Page 414.

Quit Claim Deed dated September 28, 1896, from Baltimore & Ohio Railroad to Chicago Lake Shore & Eastern Railway recorded December 14, 1896, in Book 79, Page 412.

Condemnation dated April 17, 1899, from Frederick Zuttermeister, et al. to Chicago Lake Shore & Eastern Railway.

Condemnation dated April 17, 1899, from Frederick Zuttermeister, et al. to Chicago Lake Shore & Eastern Railway.

Warranty Deed dated April 18, 1896, from Baltimore & Ohio & Chicago Railway Company to Chicago Lake Shore & Eastern Railway recorded December 14, 1896, in Book 79, Page 414.

Condemnation dated April 17, 1899, from Frederick Zuttermeister, et al. to Chicago Lake Shore & Eastern Railway.

Warranty Deed dated March 1, 1895, from Calumet Canal & Imp. Co. to William G. Brimson recorded March 11, 1895, in Book 74, Page 28-33.



Quit Claim Deed dated March 28, 1896, from William G. Brimson, and Wife to Chicago Lake Shore & Eastern Railway recorded April 7, 1896, in Book 77, Page 397.

Warranty Deed dated March 1, 1895, from Calumet Canal & Imp. Co. to William G. Brimson recorded March 11, 1895, in Book 74, Page 22.

Quit Claim Deed dated March 28, 1896, from William G. Brimson and Wife to Chicago Lake Shore & Eastern Railway recorded February 7, 1896, in Book 77, Page 397.

Warranty Deed dated July 8, 1919, from Baltimore & Ohio & Chicago Railway Company to Chicago Lake Shore & Eastern Railway.

Quit Claim Deed dated March 11, 1915, from Inland Steel Company and New York Central Railroad Company and Baltimore & Ohio & Chicago Railroad Company to Chicago Lake Shore & Eastern Railway.

Warranty Deed dated January 2, 1917, from Baltimore & Ohio & Chicago Railway Company to Chicago Lake Shore & Eastern Railway Company.

Quit Claim Deed dated June 15, 1927, from The New York Trust Company to Baltimore & Ohio & Chicago Railway Company.

Resolution of the Board of Directors dated June 8, 1927, from The New York Trust Company to Baltimore & Ohio & Chicago Railway Company.

Vacation dated December 11, 1931, from City of Whiting to Chicago Lake Shore & Eastern Railway Company.

Resolution 293 Vacation dated November 13, 1931, from Board of Public Works, City of Whiting to Chicago Lake Shore & Eastern Railway Company.

Resolution 294 Vacation dated November 13, 1931, from City of Whiting to Chicago Lake Shore & Eastern Railway Company.

Resolution 294 Dedication dated November 13, 1931, from Chicago Lake Shore & Eastern Railway Company to City of Whiting.

Quit Claim Deed dated October 1, 1958, from Youngstown Sheet & Tube Company to Elgin Joliet and Eastern Railway Company.

Quit Claim Deed dated January 12, 1967, from Youngstown Sheet & Tube Company to Elgin Joliet & Eastern Railway Company.

EXCEPTING FROM THE FOREGOING PARCELS, TO THE EXTENT INCLUDED THEREIN, THE LAND AND IMPROVEMENTS, IF ANY, AND/OR INTERESTS THEREIN GRANTED AND/OR CONVEYED BY THE FOLLOWING INSTRUMENTS:

Quitclaim Deed from Elgin Joliet & Eastern Railway Company to Youngstown Sheet & Tube Company dated June 30, 1941.

Quitclaim Deed from Elgin Joliet & Eastern Railway Company to Youngstown Sheet & Tube Company dated August 31, 1948.

Perpetual Easement from Elgin Joliet & Eastern Railway Company to Youngstown Sheet & Tube Company dated June [11], 1958.

Perpetual Easement from Elgin Joliet & Eastern Railway Company to Youngstown Sheet & Tube Company dated January 26, 1969.

Deed of Easement from Elgin Joliet & Eastern Railway Company to Youngstown Sheet & Tube Company dated August 12, 1959.

Deed of Easement from Elgin Joliet & Eastern Railway Company to Youngstown Sheet & Tube Company dated February 7, 1967.

Warranty Deed from Chicago Lake Shore and Eastern Railway Company to Baltimore and Ohio and Chicago Railroad dated July 8, 1919.

Warranty Deed from Chicago Lake Shore and Eastern Railway Company to Baltimore and Ohio and Chicago Railroad Company dated September 24, 1927.

Dedication from the Chicago Lake Shore and Eastern Railway Company to the City of Whiting dated December 11, 1931.

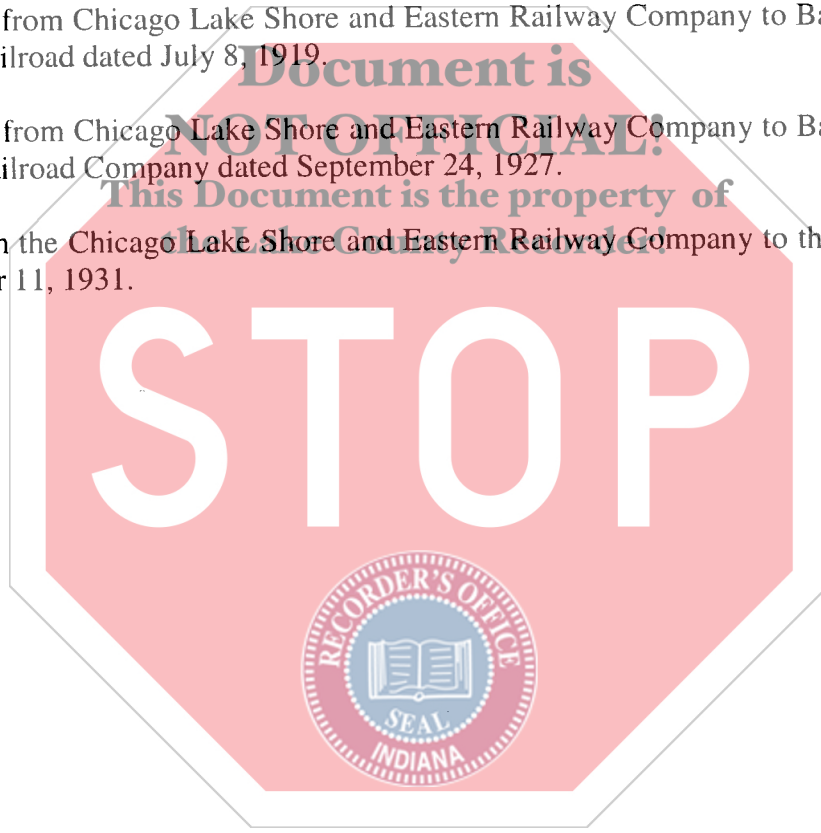

## LEGAL DESCRIPTION

**Parcel: Map V-14-3:** Indiana Harbor (North Township and Calumet Township, Sections 22, 23, 25 and 26, Township 37 North, Range 9 West, Lake County, Indiana).

A parcel of land described as follows: A strip of land, varying in width, beginning at the point where Grantor's main track intersects the north line of said Section 22, and thence running in a southeasterly direction along said railroad, on, over and across the north half of said Section 22, the southwest corner of the northwest quarter of said Section 23, the south half of said Section 23, the northeast quarter of said Section 26, the northwest quarter of said Section 25 and the south half of said Section 25, to a point in the east line of the southeast quarter of said Section 25 and there terminating, which strip of land is intended to include all land owned by Grantor and used for railroad purposes along each side of such centerline.

Also, those parcels of land, some of which are located wholly or in part within the strip of land described above, conveyed by the following deeds and other instruments:

Quit Claim Deed dated March 4, 1915, from Inland Steel Company to Chicago Lake Shore & Eastern Railway.

Contract for Title undated from NYC Railroad and Baltimore & Ohio & Chicago Railway to Chicago Lake Shore & Eastern Railway.

Warranty Deed dated September 20, 1907, from East Chicago Company to Chicago Lake Shore & Eastern Railway recorded December 3, 1907, in Book 139, Page 15.

Contract for Title from Gary Land Company, NYC Railroad and Baltimore & Ohio & Chicago Railway to Chicago Lake Shore & Eastern Railway.

Warranty Deed dated March 30, 1907, from East Chicago Company to Chicago Lake Shore & Eastern Railway recorded April 11, 1907, in Book 127, Page 349.

Warranty Deed dated March 30, 1907, from East Chicago Company to Chicago Lake Shore & Eastern Railway recorded April 11, 1907, in Book 127, Page 349.

Quit Claim Deed dated March 28, 1896, from William G. Brimson and Wife to Chicago Lake Shore & Eastern Railway recorded April 7, 1896, in Book 77, Page 397.

Quit Claim Deed dated March 28, 1896, from William G. Brimson and Wife to Chicago Lake Shore & Eastern Railway recorded April 7, 1896, in Book 77, Page 397.

Warranty Deed dated August 17, 1907, from F. E. Maplestone to Chicago Lake Shore & Eastern Railway recorded November 13, 1907, in Book 135, Page 224.

Warranty Deed dated August 17, 1907, from J.H. O'Brien to Chicago Lake Shore & Eastern Railway recorded November 13, 1907, in Book 135, Page 224.

Warranty Deed dated August 17, 1907, from Benjamin F. Tobin and East Chicago Company to Chicago Lake Shore & Eastern Railway recorded November 13, 1907, in Book 135, Page 224.

Warranty Deed dated August 6, 1908, from Henry Burgwald and Wife to Chicago Lake Shore & Eastern Railway recorded August 25, 1908, in Book 147, Page 145.

Quit Claim Deed dated August 14, 1908, from Lydia Ford and Husband to Chicago Lake Shore & Eastern Railway.

Warranty Deed dated August 12, 1907, from John Ford and Wife to Chicago Lake Shore & Eastern Railway.

Warranty Deed dated February 1909, from Nannie B. Murton and Husband to Chicago Lake Shore & Eastern Railway recorded April 4, 1909, in Book 149, Page 386.

Quit Claim Deed dated June 6, 1908, from Mary E. Doherty and Husband to Chicago Lake Shore & Eastern Railway.

Warranty Deed dated June 12, 1908, from East Chicago Company to Chicago Lake Shore & Eastern Railway recorded June 15, 1908, in Book 142, Page 15.

Warranty Deed dated June 4, 1908, from Maria L. Breslin to Chicago Lake Shore & Eastern Railway recorded June 23, 1908, in Book 140, Page 519.

Warranty Deed dated July 17, 1908, from East Chicago Company to Chicago Lake Shore & Eastern Railway recorded August 7, 1908, in Book 141, Page 360.

Quit Claim Deed dated July 16, 1908, from Jas. A. McGranahan and Wife to Chicago Lake Shore & Eastern Railway.

Warranty Deed dated June 3, 1908, from Philip D. Block and Wife to Chicago Lake Shore & Eastern Railway recorded June 9, 1908, in Book 136, Page 292.

Quit Claim Deed dated May 29, 1908, from John E. Spellacy and Wife to Chicago Lake Shore & Eastern Railway.

Quit Claim Deed dated June 20, 1908, from D. Szymanski and Wife to Chicago Lake Shore & Eastern Railway.

Warranty Deed dated June 20, 1908, from Squire R. Greer and Wife to Chicago Lake Shore & Eastern Railway recorded July 3, 1908, in Book 146, Page 58.

Warranty Deed dated July 9, 1908, from East Chicago Company to Chicago Lake Shore & Eastern Railway recorded July 13, 1908, in Book 136, Page 319.

Quit Claim Deed dated July 2, 1908, from William A. Smith and Wife to Chicago Lake Shore & Eastern Railway.

Warranty Deed dated May 20, 1908, from Walter Alexander, et al. to Chicago Lake Shore & Eastern Railway recorded June 29, 1908, in Book 137, Page 134.

Quit Claim Deed dated May 28, 1908, from Edward V. Walton and Wife to Chicago Lake Shore & Eastern Railway.

Quit Claim Deed dated June 2, 1908, from John C. H. Filson and Wife to Chicago Lake Shore & Eastern Railway.

Warranty Deed dated June 12, 1908, from East Chicago Company to Chicago Lake Shore & Eastern Railway recorded June 15, 1908, in Book 142, Page 15.

Warranty Deed dated June 20, 1908, from Squire R. Greer and Wife to Chicago Lake Shore & Eastern Railway recorded December 11, 1908, in Book 136, Page 535.

Quit Claim Deed dated November 17, 1908, from Jordan R. Brant and Wife to Chicago Lake Shore & Eastern Railway.

Quit Claim Deed dated November 17, 1908, from George E. Brant and Wife to Chicago Lake Shore & Eastern Railway.

Warranty Deed dated August 17, 1907, from East Chicago Company to Chicago Lake Shore & Eastern Railway recorded November 13, 1907, in Book 135, Page 224.

Quit Claim Deed dated May 29, 1907, from William B. McAllister and Wife to Chicago Lake Shore & Eastern Railway.

Quit Claim Deed dated May 18, 1907, from East Chicago Company to Chicago Lake Shore & Eastern Railway recorded November 13, 1907, in Book 133, Page 536.

Warranty Deed dated September 3, 1907, from Lake Shore Land & Building Company to Chicago Lake Shore & Eastern Railway recorded November 13, 1907, in Book 133, Page 534.

Warranty Deed dated January 23, 1917, from Gary Land Company to Chicago Lake Shore & Eastern Railway.

Vacation dated October 22, 1917, from City of East Chicago to Chicago Lake Shore & Eastern Railway.

Warranty Deed dated April 8, 1947, from Elgin Joliet & Eastern Railway Company to City of East Chicago.

Quit Claim Deed dated June 8, 1907, from August Krumrie and Wife to Chicago Lake Shore & Eastern Railway.

Quit Claim Deed dated May, 1907, from Laura E. Van Horn and Husband to Chicago Lake Shore & Eastern Railway.

Quit Claim Deed dated July 6, 1907, from Thomas B. Walker and Wife to Chicago Lake Shore & Eastern Railway.

Quit Claim Deed dated June 8, 1907, from Edward A. Bernot and Wife to Chicago Lake Shore & Eastern Railway.

Quit Claim Deed dated June 28, 1907, from Emanuel J. Block to Chicago Lake Shore & Eastern Railway recorded November 13, 1907, in Book 135, Page 232.

Warranty Deed dated October 15, 1907, from Arthur S. Hook and Wife to Chicago Lake Shore & Eastern Railway recorded November, 1913 in Book 128, Page 319.

Quit Claim Deed dated June 8, 1907, from Phoebe Collins and Husband to Chicago Lake Shore & Eastern Railway.

Quit Claim Deed dated May 18, 1907, from East Chicago Company to Chicago Lake Shore & Eastern Railway recorded November 13, 1907, in Book 128, Page 318.

Special Warranty Deed dated August 2, 1907, from Kemper K. Knapp to Chicago Lake Shore & Eastern Railway recorded November 13, 1907, in Book 135, Page 226.

Quit Claim Deed dated November 6, 1911, from Robert Spear and Wife to Chicago Lake Shore & Eastern Railway recorded November 11, 1911, in Book 173, Page 486.

Warranty Deed dated May 18, 1908, from Willard B. Van Home and Wife to Chicago Lake Shore & Eastern Railway recorded June 19, 1908, in Book 137, Page 128.

Quit Claim Deed dated May 29, 1908, from Phoebe Collins and Husband to Chicago Lake Shore & Eastern Railway.

Warranty Deed dated June 12, 1908, from East Chicago Company to Chicago Lake Shore & Eastern Railway recorded June 15, 1908, in Book 142, Page 15.

Quit Claim Deed dated January, 1908, from Jessie S. Moberly and Husband to Chicago Lake Shore & Eastern Railway.

Quit Claim Deed dated May 20, 1908, from Mary E. O'Grady to Chicago Lake Shore & Eastern Railway.

Quit Claim Deed dated January, 1908, from C.E. Lundquist and Wife to Chicago Lake Shore & Eastern Railway.

Quit Claim Deed dated June 1, 1908, from Archie E. Hardesty and Wife to Chicago Lake Shore & Eastern Railway.

Warranty Deed dated June 5, 1908, from Arthur L. Disbrow to Chicago Lake Shore & Eastern Railway recorded June 16, 1908, in Book 137, Page 117.

Warranty Deed dated June 5, 1908, from Julian H. Youche to Chicago Lake Shore & Eastern Railway recorded May 9, 1908, in Book 136, Page 295.

Quit Claim Deed dated May 29, 1908, from Urian Hardesty and Wife to Chicago Lake Shore & Eastern Railway.

Quit Claim Deed dated June 1, 1908, from Edwin S. Gilbert and Wife to Chicago Lake Shore & Eastern Railway.

Quit Claim Deed dated May 29, 1908, from George A. Smith to Chicago Lake Shore & Eastern Railway.

Warranty Deed dated June 1, 1908, from Albert G. Lundquist and Wife to Chicago Lake Shore & Eastern Railway recorded June 15, 1908, in Book 142, Page 14.

Quit Claim Deed dated June 9, 1908, from East Chicago Company to Chicago Lake Shore & Eastern Railway.

Warranty Deed dated June 1, 1908, from Frank Orth and Wife to Chicago Lake Shore & Eastern Railway recorded June, 1916, in Book 137, Page 118.

Quit Claim Deed dated March 28, 1896, from William G. Brimson and Wife to Chicago Lake Shore & Eastern Railway recorded April 7, 1896, in Book 77, Page 397.

Quit Claim Deed dated March 28, 1896, from William G. Brimson and Wife to Chicago Lake Shore & Eastern Railway recorded April 7, 1896, in Book 77, Page 397.

Warranty Deed dated August 17, 1907, from East Chicago Company to Chicago Lake Shore & Eastern Railway recorded November 13, 1907, in Book 135, Page 224.

Quit Claim Deed dated May 18, 1907, from East Chicago Company to Chicago Lake Shore & Eastern Railway recorded November 13, 1907, in Book 133, Page 536.

Warranty Deed dated September 3, 1907, from Lake Shore Land and Building Company to Chicago Lake Shore & Eastern Railway recorded November 13, 1907, in Book 133, Page 534.

Quit Claim Deed dated August 6, 1907, from Heinrich Burgwald and Wife to Chicago Lake Shore & Eastern Railway.

Quit Claim Deed dated May 29, 1907, from William H. Galvin to Chicago Lake Shore & Eastern Railway.

Quit Claim Deed dated June 8, 1907, from Augustus F. Hartigan and Wife to Chicago Lake Shore & Eastern Railway.

Warranty Deed dated June 24, 1908, from Minnie Bartels and Husband to Chicago Lake Shore & Eastern Railway recorded July 3, 1908, in Book 146, Page 59.

Quit Claim Deed dated June 6, 1907, from Edward L. Davenport and Wife to Chicago Lake Shore & Eastern Railway.

Quit Claim Deed dated July 1, 1907, from Clara E. Glenn to Chicago Lake Shore & Eastern Railway.

Quit Claim Deed dated June 12, 1907, from Fred B. Nebling to Chicago Lake Shore & Eastern Railway recorded November 13, 1907.

Quit Claim Deed dated June 28, 1907, from Emanuel J. Block to Chicago Lake Shore & Eastern Railway recorded November 13, 1907, in Book 135, Page 232.

Warranty Deed dated October 15, 1907, from Arthur S. Hook and Wife to Chicago Lake Shore & Eastern Railway recorded November 13, 1907 in Book 128, Page 319.

Quit Claim Deed dated May 29, 1907, from Dan Kelly and Wife to Chicago Lake Shore & Eastern Railway.

Quit Claim Deed dated January, 1908, from Caroline Fagan and Husband to Chicago Lake Shore & Eastern Railway recorded November 13, 1907.

Special Warranty Deed dated August 2, 1907, from Kemper K. Knapp to Chicago Lake Shore & Eastern Railway recorded in Book 135, Page 226.

Quit Claim Deed dated June 8, 1907, from Austin K. Perkins and Wife to Chicago Lake Shore & Eastern Railway.

Warranty Deed dated August 7, 1908, from Austin K. Perkins and Wife to Chicago Lake Shore & Eastern Railway recorded August 18, 1908, in Book 141, Page 399.

Quit Claim Deed dated May 20, 1908, from Daniel W. Long and Wife to Chicago Lake Shore & Eastern Railway.



Warranty Deed dated May 20, 1908, from Squire R. Greer and Wife to Chicago Lake Shore & Eastern Railway recorded June 9, 1908, in Book 140, Page 466.

Warranty Deed dated June 12, 1908, from East Chicago Company to Chicago Lake Shore & Eastern Railway recorded June 15, 1908, in Book 142, Page 15.

Warranty Deed dated June 16, 1908, from Mary F. Hiner and Husband to Chicago Lake Shore & Eastern Railway recorded June 19, 1908, in Book 137, Page 129.

Warranty Deed dated May 20, 1908, from Walter Alexander and Wife to Chicago Lake Shore & Eastern Railway recorded June 9, 1908, in Book 136, Page 246.

Warranty Deed dated March 11, 1955 from Elgin Joliet & Eastern Railway Company to Inland Steel.

Quit Claim Deed dated June 1, 1908, from Neven G. Ellenberger and Wife to Chicago Lake Shore & Eastern Railway.

Quit Claim Deed dated May 20, 1908, from Sarah E. Lawrence and Husband to Chicago Lake Shore & Eastern Railway.

Quit Claim Deed dated May, 1908, from Apolonia Pound and Husband to Chicago Lake Shore & Eastern Railway.

Warranty Deed dated May 20, 1908, from Harry L. Lewis and Wife to Chicago Lake Shore & Eastern Railway recorded June 5, 1908, in Book 141, Page 152.

Quit Claim Deed dated June 2, 1908, from Wallace W. Loomis and Wife to Chicago Lake Shore & Eastern Railway.

Warranty Deed dated May 29, 1908, from Thomas F. Riggle and Wife to Chicago Lake Shore & Eastern Railway recorded June 16, 1908, in Book 137, Page 116.

Quit Claim Deed dated June 17, 1908, from George Ormond and Wife to Chicago Lake Shore & Eastern Railway.

Warranty Deed dated July 17, 1908, from East Chicago Company to Chicago Lake Shore & Eastern Railway recorded August 7, 1908, in Book 141, Page 360.

Quit Claim Deed dated July 27, 1908, from David M. Brown and Wife to Chicago Lake Shore & Eastern Railway.

Warranty Deed dated May 21, 1908, from Trustees of the School City of East Chicago to Chicago Lake Shore & Eastern Railway recorded May 28, 1908, in Book 137, Page 95.

Quit Claim Deed dated May 20, 1908, from East Chicago Company to Chicago Lake Shore & Eastern Railway.

Quit Claim Deed dated August 17, 1907, from East Chicago Company to Chicago Lake Shore & Eastern Railway.

Quit Claim Deed dated March 30, 1907, from East Chicago Company to Chicago Lake Shore & Eastern Railway recorded April 11, 1907, in Book 127, Page 351.

Quit Claim Deed dated June 24, 1907, from John Lotas and Wife to Chicago Lake Shore & Eastern Railway.

Warranty Deed dated August 17, 1907, from East Chicago Company to Chicago Lake Shore & Eastern Railway recorded November 13, 1907, in Book 135, Page 224.

Quit Claim Deed dated May 5, 1907, from Christopher A. Brockman to Chicago Lake Shore & Eastern Railway.

Quit Claim Deed dated May 31, 1907, from A.A. McGinnis and Wife to Chicago Lake Shore & Eastern Railway.

Quit Claim Deed dated May 18, 1907, from East Chicago Company to Chicago Lake Shore & Eastern Railway recorded November 13, 1907, in Book 133, Page 536.

Warranty Deed dated September 3, 1907, from Lake Shore Land & Building Company to Chicago Lake Shore & Eastern Railway recorded November 13, 1907, in Book 133, Page 534.

Quit Claim Deed dated June 28, 1907, from Emanuel J. Block to Chicago Lake Shore & Eastern Railway recorded November 13, 1907, in Book 35, Page 232.

Warranty Deed dated October 15, 1907, from Arthur S. Hook and Wife to Chicago Lake Shore & Eastern Railway recorded November 13, 1907, in Book 128, Page 319.

Quit Claim Deed dated June 6, 1907, from Clifford C. Robinson and Wife to Chicago Lake Shore & Eastern Railway.

Quit Claim Deed dated June 8, 1907, from Elizabeth M. Sirlin and Husband to Chicago Lake Shore & Eastern Railway.

Warranty Deed dated June 6, 1907, from Ella G. Orth and Husband to Chicago Lake Shore & Eastern Railway recorded November 13, 1907, in Book 135, Page 228.

Quit Claim Deed dated May 18, 1907, from East Chicago Company to Chicago Lake Shore & Eastern Railway recorded November 13, 1907, in Book 128, Page 318.

Warranty Deed dated May 17, 1907, from Martin Y. Wolf and Wife to Chicago Lake Shore & Eastern Railway recorded November 13, 1907, in Book 128, Page 316.

Quit Claim Deed dated June 11, 1907, from Oscar C. Holstrom and Wife to Chicago Lake Shore & Eastern Railway.

Quit Claim Deed dated June 8, 1907, from John P. Walsh to Chicago Lake Shore & Eastern Railway.

Quit Claim Deed dated July 11, 1907, from Thomas W. Lewis and Wife to Chicago Lake Shore & Eastern Railway.

Warranty Deed dated July 29, 1907, from Herman F. Klingen Smith to Chicago Lake Shore & Eastern Railway recorded November 13, 1907, in Book 135, Page 230.

Quit Claim Deed dated July 11, 1907, from Edward A. Renouf and Wife to Chicago Lake Shore & Eastern Railway.

Quit Claim Deed dated May 18, 1907, from Boyd A. Halstead and Wife to Chicago Lake Shore & Eastern Railway.

Quit Claim Deed dated May 24, 1907, from Oprah E. McQuilken and Husband to Chicago Lake Shore & Eastern Railway.

Special Warranty Deed dated August 2, 1907, from Remper K. Knapp to Chicago Lake Shore & Eastern Railway recorded November 13, 1907, in Book 135, Page 226.

Quit Claim Deed dated August 3, 1907, from Harry B. Lennon to Chicago Lake Shore & Eastern Railway.

Warranty Deed dated March 30, 1907, from East Chicago Company to Chicago Lake Shore & Eastern Railway recorded April 11, 1907, in Book 127, Page 349.

Quit Claim Deed dated May 31, 1907, from Alfred R. Johnson to Chicago Lake Shore & Eastern Railway.

Quit Claim Deed dated May 31, 1907, from Maria Carlson and Husband to Chicago Lake Shore & Eastern Railway.

Warranty Deed dated August 17, 1907, from East Chicago Company to Chicago Lake Shore & Eastern Railway recorded November 13, 1907, in Book 135, Page 224.

Quit Claim Deed dated June 8, 1907, from Thomas A. Lawrence and Wife to Chicago Lake Shore & Eastern Railway.

Quit Claim Deed dated May 18, 1907, from East Chicago Company to Chicago Lake Shore & Eastern Railway recorded November 13, 1907, in Book 133, Page 536.

Warranty Deed dated September 3, 1907, from Lake Shore Land & Building Company to Chicago Lake Shore & Eastern Railway recorded November 13, 1907, in Book 133, Page 534.

Quit Claim Deed dated June 8, 1907, from Catherine B. Johnstone to Chicago Lake Shore & Eastern Railway.

Quit Claim Deed dated June 28, 1907, from Emanuel J. Block to Chicago Lake Shore & Eastern Railway recorded November 13, 1907, in Book 135, Page 232.

Warranty Deed dated October 15, 1907, from Arthur S. Hook and Wife to Chicago Lake Shore & Eastern Railway recorded November 13, 1907, in Book 128, Page 319.

Warranty Deed dated March 30, 1907, from East Chicago Company to Chicago Lake Shore & Eastern Railway recorded April 11, 1907, in Book 127, Page 349.

Warranty Deed dated March 30, 1907, from East Chicago Company to Chicago Lake Shore & Eastern Railway recorded April 11, 1907, in Book 127, Page 349.

Warranty Deed dated March 30, 1907, from East Chicago Company to Chicago Lake Shore & Eastern Railway recorded April 11, 1907, in Book 127, Page 349.

Warranty Deed dated April 16, 1910, from Gary Land Company to Chicago Lake Shore & Eastern Railway recorded April 5, 1912, in Book 179, Page 350.

Contract dated October 29, 1906, from Chicago, Indiana & Southern Railroad to Chicago Lake Shore & Eastern Railway.

Warranty Deed dated February 2, 1920 from Gary Land Company to Chicago Lake Shore & Eastern Railway.

Warranty Deed dated April 25, 1895, from George T. Cline to Chicago Lake Shore & Eastern Railway recorded September 26, 1895, in Book 74, Page 423-427.

Contract dated June 1, 1909, from Gary Land Company to Chicago Lake Shore & Eastern Railway.

Release Deed dated November 27, 1928, from Gary Land Company to Chicago Lake Shore & Eastern Railway.

Indenture of Conveyance dated June 20, 1928, from New York Central and the Chicago Lake Shore & Eastern Railway and Gary Land Company to New York Central and the Chicago Lake Shore & Eastern Railway and Gary Land Company.

Perpetual Easement dated March 11, 1955, from Inland Steel Company to Elgin Joliet & Eastern Railway Company.

Perpetual Easement dated November 14, 1957, from Inland Steel Company to Elgin Joliet & Eastern Railway Company and Others.

Resolution (59-1) dated March 31, 1959, from City of East Chicago to Elgin Joliet & Eastern Railway Company.

Resolution (59-2) dated March 31, 1959, from City of East Chicago to Elgin Joliet & Eastern Railway Company.

**EXCEPTING FROM THE FOREGOING PARCELS, TO THE EXTENT INCLUDED THEREIN, THE LAND AND IMPROVEMENTS, IF ANY, AND/OR INTERESTS THEREIN GRANTED AND/OR CONVEYED BY THE FOLLOWING INSTRUMENTS:**

Perpetual Easement from Elgin Joliet & Eastern Railway Company to City of East Chicago, dated November 21, 1957 and recorded December 20, 1957 in Book 708, Page 225, in Lake County, Indiana.

Quitclaim Deed from Elgin Joliet & Eastern Railway Company to the City of East Chicago dated July 16, 1964.

Easement from Elgin Joliet & Eastern Railway Company to Northern Indiana Public Service Company, dated August 18, 1954.

Warranty Deed from Elgin Joliet & Eastern Railway Company to City of East Chicago, dated April 8, 1947.

Warranty Deed from Elgin Joliet & Eastern Railway Company to Inland Steel, dated March 11, 1955.

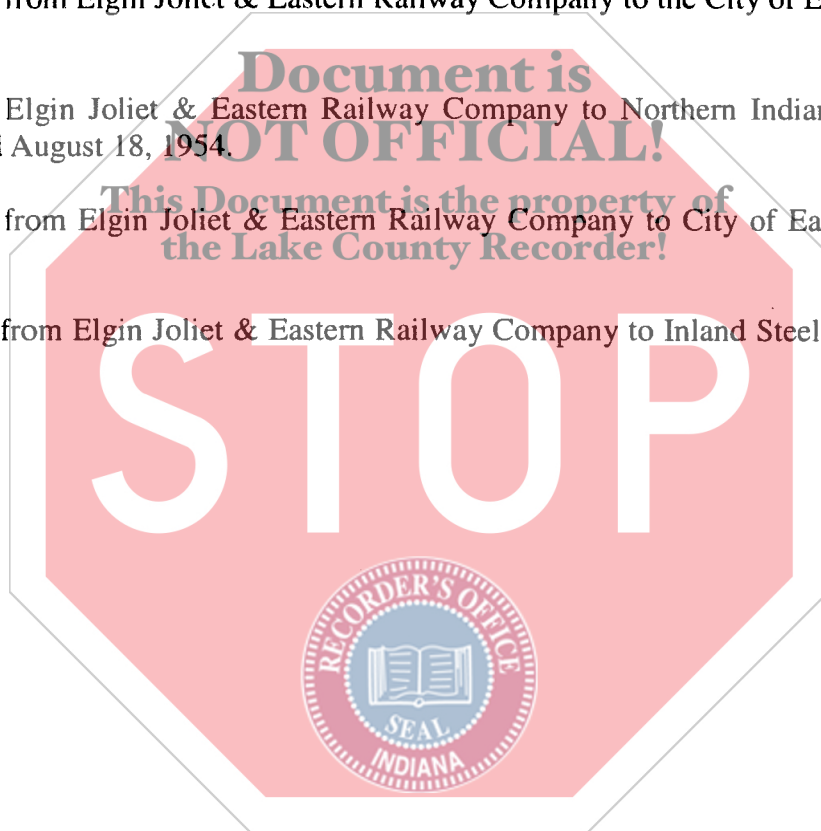

# ELGIN, JOLIET AND EASTERN RAILWAY HUMP AND DIXIE LEAD - REVISED

## LEGAL DESCRIPTION

PART OF THE SOUTH HALF OF SECTION 33 AND THE SOUTH HALF OF SECTION 35, ALL IN TOWNSHIP 37 NORTH, RANGE 8 WEST OF THE SECOND PRINCIPAL MERIDIAN, ALSO PART OF THE NORTH HALF OF SECTION 4, THE NORTH HALF OF SECTION 3, AND THE NORTH HALF OF SECTION 2, ALL IN TOWNSHIP 36 NORTH, RANGE 8 WEST OF THE SECOND PRINCIPAL MERIDIAN, ALL IN LAKE COUNTY INDIANA BEING MORE PARTICULARLY DESCRIBED AS FOLLOWS:

BEGINNING AT THE INTERSECTION OF THE SOUTHERLY LINE OF THE ELGIN, JOLIET AND EASTERN RAILWAY COMPANY (FORMERLY THE CHICAGO LAKE SHORE AND EASTERN RAILWAY COMPANY) AS DESCRIBED IN DEED FROM GARY LAND COMPANY TO CHICAGO LAKE SHORE AND EASTERN RAILWAY COMPANY DATED JUNE 20, 1928 IN DEED RECORD 432 PAGE 553, IN THE OFFICE OF THE RECORDER, LAKE COUNTY, INDIANA, WITH THE WEST LINE OF VEEDER TRACT NO. 1 AS DESCRIBED IN DEED FROM GARY LAND COMPANY TO INDIANA STEEL COMPANY DATED FEBRUARY 21, 1908 IN DEED RECORD 128 PAGE 537 IN SAID OFFICE OF THE RECORDER; THENCE ALONG SAID SOUTHERLY LINE, NORTH 64 DEGREES 24 MINUTES 42 SECONDS WEST, 112.39 FEET; THENCE NORTH 25 DEGREES 38 MINUTES 51 SECONDS EAST, 220.85 FEET; THENCE NORTH 21 DEGREES 46 MINUTES 30 SECONDS EAST, 20.90 FEET TO THE WEST LINE OF SAID VEEDER TRACT NO. 1; THENCE ALONG THE WEST LINE OF SAID VEEDER TRACT NO. 1, SOUTH 00 DEGREES 25 MINUTES 28 SECONDS WEST, 34.12 FEET; THENCE SOUTH 57 DEGREES 15 MINUTES 50 SECONDS EAST, 37.98 FEET; THENCE SOUTH 47 DEGREES 19 MINUTES 56 SECONDS WEST, 22.26 FEET; THENCE SOUTH 42 DEGREES 40 MINUTES 04 SECONDS EAST, 36.60 FEET; THENCE NORTH 47 DEGREES 19 MINUTES 56 SECONDS EAST, 31.79 FEET; THENCE SOUTH 57 DEGREES 15 MINUTES 50 SECONDS EAST, 218.76 FEET TO THE WESTERLY LINE OF PARCEL NO. 3 AS DESCRIBED IN DEED FROM UNITED STATES STEEL CORPORATION TO NORTHERN INDIANA PUBLIC SERVICE COMPANY DATED OCTOBER 24, 1960 IN DEED BOOK 1160 PAGE 361 IN SAID OFFICE OF THE RECORDER; THENCE ALONG SAID WESTERLY LINE, SOUTH 49 DEGREES 19 MINUTES 41 SECONDS WEST, 81.03 FEET TO THE NORTHERLY LINE OF SAID ELGIN, JOLIET AND EASTERN RAILWAY COMPANY PARCEL; THENCE THE FOLLOWING FOUR (4) COURSES ALONG SAID NORTHERLY LINE; (1) SOUTH 64 DEGREES 24 MINUTES 42 SECONDS EAST, ~~346.67~~ <sup>346.67</sup> FEET TO A POINT OF CURVATURE; (2) 3348.85 FEET EASTERLY ALONG A CURVE BEING CONCAVE TO THE NORTHEAST, HAVING A RADIUS OF 11279.20 FEET AND A CHORD BEARING SOUTH 72 DEGREES 55 MINUTES 03 SECONDS EAST, 3336.57 FEET TO A POINT OF COMPOUND CURVATURE; (3) 1714.09 FEET EASTERLY ALONG A CURVE BEING CONCAVE TO THE NORTH, HAVING A RADIUS OF 6297.33 FEET AND A CHORD BEARING SOUTH 89 DEGREES 13 MINUTES 15 SECONDS EAST, 1708.80 FEET; (4) NORTH 82 DEGREES 58 MINUTES 53 SECONDS EAST, 3551.01 FEET; THENCE SOUTH 07 DEGREES 01 MINUTES 07 SECONDS EAST, 50.00 FEET; THENCE NORTH 82 DEGREES 58 MINUTES 53 SECONDS EAST, 918.07 FEET TO A POINT OF CURVATURE; THENCE 1686.67 FEET ALONG A CURVE CONCAVE TO SOUTHEAST, HAVING A RADIUS OF 11459.20 FEET AND A CHORD BEARING NORTH 87 DEGREES 11 MINUTES 53 SECONDS EAST, 1685.18 FEET; THENCE SOUTH 88 DEGREES 43 MINUTES 27 SECONDS EAST, 1532.76 FEET TO A POINT ON A NON-TANGENT CURVE ALSO BEING THE NORTHERLY LINE OF THE NEW YORK CENTRAL RAILROAD; THENCE ALONG SAID NORTHERLY LINE 241.05 FEET SOUTHWESTERLY ALONG A CURVE CONCAVE TO THE SOUTHEAST, HAVING A RADIUS OF 3339.17 FEET AND A CHORD BEARING SOUTH 78 DEGREES 52 MINUTES 16 SECONDS WEST, 241.00 FEET TO THE SOUTHERLY LINE OF SAID ELGIN, JOLIET AND EASTERN RAILWAY COMPANY PARCEL;

(741.07)

THENCE THE FOLLOWING SIX (6) COURSES ALONG SAID SOUTHERLY LINE; (1) NORTH 88 DEGREES 38 MINUTES 46 SECONDS WEST, 1297.52 FEET TO A POINT OF CURVATURE; (2) 1679.31 FEET WESTERLY ALONG A CURVE BEING CONCAVE TO THE SOUTH, HAVING A RADIUS OF 11409.20 FEET AND A CHORD BEARING SOUTH 87 DEGREES 11 MINUTES 53 SECONDS WEST, 1677.82 FEET; (3) SOUTH 82 DEGREES 58 MINUTES 53 SECONDS WEST, 4469.08 FEET TO A POINT OF CURVATURE; (4) 1741.31 FEET WESTERLY ALONG A CURVE BEING CONCAVE TO THE NORTH, HAVING A RADIUS OF 6397.33 FEET AND A CHORD BEARING NORTH 89 DEGREES 13 MINUTES 15 SECONDS WEST, 1735.94 FEET TO A POINT OF COMPOUND CURVATURE; (5) 3378.54 FEET NORTHWESTERLY ALONG A CURVE BEING CONCAVE TO THE NORTHEAST, HAVING A RADIUS OF 11379.20 FEET AND A CHORD BEARING NORTH 72 DEGREES 55 MINUTES 03 SECONDS WEST, 3366.14 FEET; (6) NORTH 64 DEGREES 24 MINUTES 42 SECONDS WEST, 901.69 FEET TO THE POINT OF BEGINNING, SAID PARCEL CONTAINING 27.41 ACRES, MORE OR LESS.

PREPARED BY:  
MANHARD CONSULTING, LTD.  
833 W. LINCOLN HWY, SUITE 113E  
SCHERERVILLE, IN 46375  
219.865.4065  
January 15, 2009



All that part of the Southwest Quarter (SW 1/4) of the Southwest Quarter (SW 1/4) of Section Thirty-six (36) in Township Thirty-six (36) North of Range Nine (9), West of the Second Principal Meridian, which lies South of the southerly right of way line of the Elgin, Joliet and Eastern Railway Company, in Lake County, Indiana.

Key No.: 45-07-36-351-009.000-001





# ELGIN, JOLIET AND EASTERN RAILWAY CITY TRACK - REVISED

## LEGAL DESCRIPTION

PART OF THE SOUTH HALF OF SECTION 25 AND THE NORTH HALF OF SECTION 36, ALL IN TOWNSHIP 37 NORTH, RANGE 9 WEST OF THE SECOND PRINCIPAL MERIDIAN, ALSO PART OF THE NORTH HALF OF SECTION 31, SECTION 32 AND THE SOUTHWEST QUARTER OF SECTION 33, ALL IN TOWNSHIP 37 NORTH, RANGE 8 WEST OF THE SECOND PRINCIPAL MERIDIAN, ALSO PART OF THE NORTH HALF OF SECTION 4, SECTION 3, THE SOUTH HALF OF SECTION 2 AND THE SOUTHWEST QUARTER OF SECTION 1, ALL IN TOWNSHIP 36 NORTH, RANGE 8 WEST OF THE SECOND PRINCIPAL MERIDIAN, ALL IN LAKE COUNTY INDIANA BEING MORE PARTICULARLY DESCRIBED AS FOLLOWS:

BEGINNING AT THE NORTHWEST CORNER OF SECTION 31, TOWNSHIP 37 NORTH, RANGE 8 WEST OF THE SECOND PRINCIPAL MERIDIAN; THENCE ALONG THE NORTH LINE OF SAID SECTION 31, SOUTH 88 DEGREES 25 MINUTES 37 SECONDS EAST, 213.35 FEET TO THE SOUTHWESTERLY RIGHT OF WAY OF LINE OF THE CSX RAILROAD (FORMERLY KNOWN AS THE BALTIMORE & OHIO & CHICAGO RAILROAD COMPANY) AND DESCRIBED IN DEED FROM GARY LAND COMPANY TO SAID BALTIMORE & OHIO & CHICAGO RAILROAD COMPANY DATED APRIL 12<sup>TH</sup>, 1915 IN DEED RECORD 221, PAGE 4 IN THE OFFICE OF THE RECORDER, LAKE COUNTY, INDIANA; THENCE ALONG SAID SOUTHWESTERLY LINE, SOUTH 64 DEGREES 24 MINUTES 42 SECONDS EAST, 1223.42 FEET TO THE EAST LINE OF THE NORTHWEST QUARTER OF THE NORTHWEST QUARTER OF SAID SECTION 31; THENCE ALONG SAID EAST LINE, NORTH 00 DEGREES 33 MINUTES 18 SECONDS EAST, 25.94 FEET TO THE SOUTHWESTERLY RIGHT OF WAY LINE OF SAID CSX RAILROAD; THENCE ALONG SAID SOUTHWESTERLY LINE, SOUTH 64 DEGREES 24 MINUTES 42 SECONDS EAST, 3622.44 FEET; THENCE NORTH 71 DEGREES 33 MINUTES 42 SECONDS WEST, 1193.08 FEET TO A POINT WHICH IS 148.5 FEET, MEASURED AT RIGHT ANGLES, SOUTHWESTERLY FROM THE SOUTHWESTERLY LINE OF SAID CSX RAILROAD, SAID POINT ALSO BEING ON THE NORTH LINE OF PARCEL 5 AS DESCRIBED IN DEED FROM GARY LAND COMPANY TO THE CHICAGO, LAKE SHORE AND EASTERN RAILWAY COMPANY DATED FEBRUARY 2, 1920 IN DEED RECORD 274, PAGE 1, IN SAID OFFICE OF THE RECORDER; THENCE THE FOLLOWING FOUR (4) COURSES ALONG SAID NORTH LINE; (1) SOUTH 64 DEGREES 24 MINUTES 42 SECONDS EAST, 3758.94 FEET; (2) SOUTH 72 DEGREES 32 MINUTES 42 SECONDS EAST, 1066.72 FEET; (3) SOUTH 64 DEGREES 24 MINUTES 00 SECONDS EAST, 5265.89 FEET TO A POINT OF CURVATURE; (4) 1877.49 FEET SOUTHEASTERLY ALONG A CURVE BEING CONCAVE TO THE NORTHEAST, HAVING A RADIUS OF 11509.20 FEET AND A CHORD BEARING SOUTH 69 DEGREES 04 MINUTES 24 SECONDS EAST, 1875.40 FEET; THENCE THE FOLLOWING THREE (3) COURSES ALONG THE NORTH LINE OF PARCEL 14-N AS DESCRIBED IN DEED FROM THE STATE OF INDIANA TO THE ELGIN, JOLIET AND EASTERN RAILWAY COMPANY DATED APRIL 24, 1984 AS DOCUMENT NUMBER 761465, IN SAID OFFICE OF THE RECORDER; (1) SOUTH 75 DEGREES 44 MINUTES 57 SECONDS EAST, 498.29 FEET; (2) SOUTH 77 DEGREES 30 MINUTES 48 SECONDS EAST, 256.63 FEET; (3) SOUTH 79 DEGREES 20 MINUTES 28 SECONDS EAST, 379.46 FEET, TO THE WEST RIGHT OF WAY LINE OF BROADWAY; THENCE SOUTH 79 DEGREES 26 MINUTES 09 SECONDS EAST, 101.83 FEET TO THE EAST RIGHT OF WAY LINE OF BROADWAY; THENCE THE FOLLOWING TWO (2) COURSES ALONG THE NORTH LINE OF PARCEL 14A-N AS DESCRIBED IN DEED FROM THE STATE OF INDIANA TO THE ELGIN, JOLIET AND EASTERN RAILWAY COMPANY DATED APRIL 24, 1984 AS DOCUMENT NUMBER 761465, IN SAID OFFICE OF THE RECORDER; (1) SOUTH 80 DEGREES 22 MINUTES 30 SECONDS EAST, 738.92 FEET TO A POINT OF CURVATURE; (2) 117.09 FEET SOUTHEASTERLY

ALONG A CURVE BEING CONCAVE TO THE SOUTH, HAVING A RADIUS OF 1181.64 FEET AND A CHORD BEARING SOUTH 77 DEGREES 32 MINUTES 11 SECONDS EAST, 117.04 FEET TO THE NORTH LINE OF PARCEL 17-N AS DESCRIBED IN DEED FROM THE STATE OF INDIANA TO THE ELGIN, JOLIET AND EASTERN RAILWAY COMPANY DATED APRIL 24, 1984 AS DOCUMENT NUMBER 761465, IN SAID OFFICE OF THE RECORDER; THENCE ALONG SAID NORTH LINE, SOUTH 82 DEGREES 50 MINUTES 47 SECONDS EAST, 84.54 FEET TO THE EAST LINE OF SAID PARCEL 17-N; THENCE ALONG SAID EAST LINE, SOUTH 67 DEGREES 28 MINUTES 11 SECONDS EAST, 191.71 FEET; THENCE CONTINUING ALONG SAID EAST LINE SOUTH 69 DEGREES 22 MINUTES 55 SECONDS EAST, 344.84 FEET TO THE NORTHERLY LINE OF THE ELGIN, JOLIET AND EASTERN RAILWAY (FORMERLY THE LAKE SHORE & MICHIGAN SOUTHERN RAILROAD COMPANY); THENCE ALONG SAID NORTHERLY LINE, SOUTH 73 DEGREES 19 MINUTES 47 SECONDS EAST, 1363.80 FEET TO THE NORTH LINE OF PARCEL 16C-N AS DESCRIBED IN DEED FROM THE ELGIN, JOLIET AND EASTERN RAILWAY COMPANY TO THE STATE OF INDIANA DATED MAY 14, 1984 AS DOCUMENT NUMBER 761466 IN SAID OFFICE OF THE RECORDER; THENCE THE FOLLOWING THREE (3) COURSES ALONG THE NORTH, WEST AND SOUTH LINES OF SAID PARCEL 16C-N; (1) NORTH 86 DEGREES 03 MINUTES 37 SECONDS WEST, 68.90 FEET; (2) SOUTH 77 DEGREES 35 MINUTES 26 SECONDS EAST, 54.05 FEET; (3) SOUTH 86 DEGREES 42 MINUTES 47 SECONDS EAST, 48.25 FEET TO THE NORTHERLY LINE OF THE ELGIN, JOLIET AND EASTERN RAILWAY; THENCE ALONG SAID NORTHERLY LINE, SOUTH 73 DEGREES 19 MINUTES 47 SECONDS EAST, 349.95 FEET TO THE NORTH LINE OF PARCEL 16E-N AS DESCRIBED IN DEED FROM THE ELGIN, JOLIET AND EASTERN RAILWAY COMPANY TO THE STATE OF INDIANA DATED MAY 14, 1984 AS DOCUMENT NUMBER 761466 IN SAID OFFICE OF THE RECORDER; THENCE ALONG THE NORTH LINE OF SAID PARCEL 16E-N, SOUTH 88 DEGREES 47 MINUTES 43 SECONDS WEST, 70.24 FEET TO THE SOUTHERLY LINE OF SAID PARCEL 16E-N; THENCE ALONG SAID SOUTHERLY LINE, SOUTH 86 DEGREES 42 MINUTES 47 SECONDS EAST, 93.14 FEET TO THE NORTHERLY LINE OF THE ELGIN, JOLIET AND EASTERN RAILWAY; THENCE SOUTH 73 DEGREES 19 MINUTES 47 SECONDS EAST, 7767.71 FEET TO THE WEST LINE OF SECTION 1, TOWNSHIP 36 NORTH, RANGE 8 WEST OF THE SECOND PRINCIPAL MERIDIAN; THENCE SOUTH 00 DEGREES 06 MINUTES 54 SECONDS WEST, 10.43 FEET TO THE NORTHERLY LINE OF THE ELGIN, JOLIET AND EASTERN RAILWAY; THENCE ALONG SAID NORTHERLY LINE, SOUTH 73 DEGREES 19 MINUTES 47 SECONDS EAST, 958.24 FEET TO A POINT OF CURVATURE; THENCE CONTINUING ALONG SAID LINE, 1007.17 FEET SOUTHEASTERLY ALONG A CURVE CONCAVE TO THE NORTH, HAVING A RADIUS OF 6218.00 FEET AND A CHORD BEARING SOUTH 77 DEGREES 58 MINUTES 12 SECONDS EAST, 1006.07 FEET TO A POINT WHICH IS 783.5 FEET WESTERLY AS MEASURED ALONG SAID CURVE FROM THE NORTH SOUTH CENTERLINE OF SAID SECTION 1; THENCE SOUTH 39 DEGREES 25 MINUTES 41 SECONDS WEST, 164.45 FEET TO A NON-TANGENT CURVE BEING THE SOUTHERLY LINE OF THE ELGIN, JOLIET AND EASTERN RAILWAY SAID POINT BEING 889.9 FEET WESTERLY AS MEASURED ALONG SAID CURVE FROM THE NORTH SOUTH CENTERLINE OF SAID SECTION 1; THENCE 942.60 FEET NORTHWESTERLY ALONG SAID CURVE BEING CONCAVE TO THE NORTH, HAVING A RADIUS OF 6358.00 FEET AND A CHORD BEARING NORTH 77 DEGREES 34 MINUTES 37 SECONDS WEST, 941.74 FEET; THENCE CONTINUING ALONG SAID LINE NORTH 73 DEGREES 19 MINUTES 47 SECONDS WEST, 916.63 FEET TO THE WEST LINE OF SECTION 1, TOWNSHIP 36 NORTH, RANGE 8 WEST OF THE SECOND PRINCIPAL MERIDIAN; THENCE ALONG SAID WEST LINE NORTH 00 DEGREES 06 MINUTES 54 SECONDS EAST, 52.16 FEET TO THE SOUTHERLY LINE OF THE ELGIN, JOLIET AND EASTERN RAILWAY; THENCE ALONG SAID SOUTHERLY LINE NORTH 73 DEGREES 19 MINUTES 47 SECONDS WEST, 8210.27 FEET TO THE SOUTH LINE OF PARCEL 16D-N AS DESCRIBED IN DEED FROM THE ELGIN, JOLIET AND EASTERN RAILWAY COMPANY TO THE STATE OF INDIANA DATED MAY 14, 1984 AS DOCUMENT NUMBER 761466 IN SAID OFFICE OF THE RECORDER; THENCE ALONG SAID SOUTH LINE, SOUTH 86 DEGREES 42 MINUTES 47 SECONDS EAST, 37.29 FEET TO THE NORTHERLY LINE OF SAID PARCEL 16D-N; THENCE ALONG SAID NORTHERLY LINE,

NORTH 80 DEGREES 40 MINUTES 51 SECONDS WEST, 67.45 FEET TO THE SOUTHERLY LINE OF THE ELGIN, JOLIET AND EASTERN RAILWAY; THENCE ALONG SAID SOUTHERLY LINE NORTH 73 DEGREES 19 MINUTES 47 SECONDS WEST, 362.62 FEET TO THE EAST LINE OF PARCEL 16B-N AS DESCRIBED IN DEED FROM THE ELGIN, JOLIET AND EASTERN RAILWAY COMPANY TO THE STATE OF INDIANA DATED MAY 14, 1984 AS DOCUMENT NUMBER 761466 IN SAID OFFICE OF THE RECORDER; THENCE THE FOLLOWING FOUR (4) COURSES ALONG THE EAST AND NORTH LINES OF SAID PARCEL 16B-N; (1) NORTH 00 DEGREES 18 MINUTES 59 SECONDS WEST, 36.88 FEET; (2) NORTH 74 DEGREES 52 MINUTES 43 SECONDS WEST, 163.15 FEET; (3) NORTH 67 DEGREES 40 MINUTES 59 SECONDS WEST, 101.43 FEET; (4) NORTH 73 DEGREES 15 MINUTES 31 SECONDS WEST, 54.52 FEET TO THE EAST RIGHT-OF-WAY LINE OF VIRGINIA STREET; THENCE NORTH 73 DEGREES 46 MINUTES 33 SECONDS WEST, 83.50 FEET TO THE WEST RIGHT-OF-WAY LINE OF VIRGINIA STREET, POINT ALSO BEING ON THE NORTHERLY LINE OF PARCEL 16A-N AS DESCRIBED IN DEED FROM THE ELGIN, JOLIET AND EASTERN RAILWAY COMPANY TO THE STATE OF INDIANA DATED MAY 14, 1984 AS DOCUMENT NUMBER 761466 IN SAID OFFICE OF THE RECORDER; THENCE THE FOLLOWING TWELVE (12) COURSES ALONG THE NORTHERLY LINE OF SAID PARCEL 16A-N; (1) NORTH 73 DEGREES 15 MINUTES 31 SECONDS WEST, 71.77 FEET; (2) NORTH 72 DEGREES 06 MINUTES 48 SECONDS WEST, 381.31 FEET; (3) NORTH 70 DEGREES 58 MINUTES 05 SECONDS WEST, 612.41 FEET TO A POINT OF CURVATURE; (4) 131.76 FEET NORTHWESTERLY ALONG A CURVE BEING CONCAVE TO THE SOUTHWEST, HAVING A RADIUS OF 1452.39 FEET AND A CHORD BEARING NORTH 73 DEGREES 34 MINUTES 00 SECONDS WEST, 131.71 FEET; (5) NORTH 16 DEGREES 44 MINUTES 29 SECONDS EAST, 15.44 FEET TO A POINT ON A NON-TANGENT CURVE; (6) 229.53 FEET WESTERLY ALONG SAID CURVE BEING CONCAVE TO THE SOUTH, HAVING A RADIUS OF 2849.93 FEET AND A CHORD BEARING NORTH 77 DEGREES 33 MINUTES 05 SECONDS WEST, 229.47 FEET; (7) NORTH 79 DEGREES 51 MINUTES 32 SECONDS WEST, 124.50 FEET; (8) SOUTH 10 DEGREES 08 MINUTES 28 SECONDS WEST, 7.87 FEET TO A POINT ON A NON-TANGENT CURVE; (9) 121.12 FEET WESTERLY ALONG SAID CURVE BEING CONCAVE TO THE SOUTH HAVING A RADIUS OF 1165.92 FEET AND A CHORD BEARING NORTH 76 DEGREES 53 MINUTES 13 SECONDS WEST, 121.07 FEET; (10) NORTH 79 DEGREES 51 MINUTES 48 SECONDS WEST, 312.00 FEET; (11) NORTH 39 DEGREES 01 MINUTES 50 SECONDS WEST, 19.88 FEET; (12) NORTH 79 DEGREES 41 MINUTES 39 SECONDS WEST, 20.64 FEET TO THE EAST RIGHT-OF-WAY OF BROADWAY; THENCE NORTH 79 DEGREES 41 MINUTES 39 SECONDS WEST, 101.75 FEET TO THE WEST RIGHT-OF-WAY LINE OF BROADWAY, POINT ALSO BEING ON THE NORTHERLY LINE OF PARCEL 16-N AS DESCRIBED IN DEED FROM THE ELGIN, JOLIET AND EASTERN RAILWAY COMPANY TO THE STATE OF INDIANA DATED MAY 14, 1984 AS DOCUMENT NUMBER 761466 IN SAID OFFICE OF THE RECORDER; THENCE THE FOLLOWING SEVEN (7) COURSES ALONG THE NORTHERLY LINE OF SAID PARCEL 16-N; (1) NORTH 79 DEGREES 41 MINUTES 39 SECONDS WEST, 9.00 FEET; (2) SOUTH 48 DEGREES 18 MINUTES 19 SECONDS WEST, 31.22 FEET TO A POINT ON A NON-TANGENT CURVE; (3) 595.27 FEET WESTERLY ALONG SAID CURVE BEING CONCAVE TO THE NORTH HAVING A RADIUS OF 7546.00 FEET AND A CHORD BEARING NORTH 77 DEGREES 42 MINUTES 08 SECONDS WEST, 595.12 FEET; (4) NORTH 75 DEGREES 26 MINUTES 32 SECONDS WEST, 865.06 FEET TO A POINT OF CURVATURE; (5) 170.00 FEET NORTHWESTERLY ALONG SAID CURVE BEING CONCAVE TO THE NORTH, HAVING A RADIUS OF 1909.86 FEET AND A CHORD BEARING NORTH 72 DEGREES 53 MINUTES 32 SECONDS WEST, 169.94 FEET TO A POINT OF COMPOUND CURVE; (6) 534.89 FEET NORTHWESTERLY ALONG SAID CURVE BEING CONCAVE TO THE NORTH, HAVING A RADIUS OF 6631.75 FEET AND A CHORD BEARING OF NORTH 68 DEGREES 01 MINUTES 54 SECONDS WEST, 534.75 FEET; (7) NORTH 68 DEGREES 26 MINUTES 25 SECONDS WEST, 239.98 FEET; THENCE NORTH 65 DEGREES 25 MINUTES 30 SECONDS WEST, 47.65 FEET TO A POINT OF CURVATURE; THENCE 442.57 FEET NORTHWESTERLY ALONG SAID CURVE BEING CONCAVE TO THE NORTHEAST, HAVING A RADIUS OF 11541.20 FEET AND A CHORD BEARING NORTH 66 DEGREES 08 MINUTES 05 SECONDS WEST, 442.54 FEET; THENCE SOUTH 23 DEGREES 26 MINUTES 00

SECONDS WEST, 0.69 FEET TO A POINT ON A NON-TANGENT CURVE; THENCE 298.52 FEET WESTERLY ALONG SAID CURVE BEING CONCAVE TO THE SOUTH, HAVING A RADIUS OF 5789.58 FEET AND A CHORD BEARING NORTH 67 DEGREES 54 MINUTES 08 SECOND WEST, 298.49 FEET TO THE SOUTH LINE OF PARCEL 5 AS DESCRIBED IN DEED FROM GARY LAND COMPANY TO THE CHICAGO, LAKE SHORE AND EASTERN RAILWAY COMPANY DATED FEBRUARY 2, 1920 IN DEED RECORD 274, PAGE 1, IN SAID OFFICE OF THE RECORDER; THENCE THE FOLLOWING THREE (3) COURSES ALONG SAID SOUTH LINE; (1) NORTH 64 DEGREES 24 MINUTES 00 SECOND WEST, 5065.50 FEET; (2) NORTH 72 DEGREES 32 MINUTES 42 SECONDS WEST, 1066.71 FEET; (3) NORTH 64 DEGREES 24 MINUTES 42 SECONDS WEST, 7365.46 FEET TO A POINT OF CURVATURE AND ALSO BEING THE SOUTHERLY LINE OF PARCEL 6 AS DESCRIBED IN DEED FROM GARY LAND COMPANY TO THE CHICAGO, LAKE SHORE AND EASTERN RAILWAY COMPANY DATED FEBRUARY 2, 1920 IN DEED RECORD 274, PAGE 1, IN SAID OFFICE OF THE RECORDER; THENCE ALONG SAID SOUTHERLY LINE 616.64 FEET NORTHWESTERLY ALONG SAID CURVE BEING CONCAVE TO THE SOUTH, HAVING A RADIUS OF 1407.70 FEET AND A CHORD BEARING NORTH 76 DEGREES 57 MINUTES 39 SECONDS WEST, 611.72 FEET TO A LINE BEING 50 FEET SOUTH OF AND PARALLEL WITH THE NORTH LINE OF SECTION 36, TOWNSHIP 37 NORTH, RANGE 9 WEST OF THE SECOND PRINCIPAL MERIDIAN, SAID LINE ALSO BEING THE SOUTH LINE OF PARCEL 2 AS DESCRIBED IN DEED FROM GARY LAND COMPANY TO THE CHICAGO, LAKE SHORE AND EASTERN RAILWAY COMPANY DATED FEBRUARY 2, 1920 IN DEED RECORD 274, PAGE 1, IN SAID OFFICE OF THE RECORDER; THENCE ALONG SAID SOUTH LINE NORTH 89 DEGREES 30 MINUTES 36 SECONDS WEST, 2318.08 FEET TO THE WESTERLY LINE OF PARCEL 1 AS DESCRIBED IN DEED FROM GARY LAND COMPANY TO THE CHICAGO, LAKE SHORE AND EASTERN RAILWAY COMPANY DATED FEBRUARY 2, 1920 IN DEED RECORD 274, PAGE 1, IN SAID OFFICE OF THE RECORDER; THENCE ALONG SAID WESTERLY LINE, NORTH 43 DEGREES 37 MINUTES 37 SECOND WEST, 2049.20 FEET TO THE SOUTHERLY LINE OF PARCEL 2 AS DESCRIBED IN DEED FROM GARY LAND COMPANY TO THE CHICAGO, LAKE SHORE AND EASTERN RAILWAY COMPANY DATED APRIL 16, 1910 IN DEED RECORD 179, PAGE 350, IN SAID OFFICE OF THE RECORDER; THENCE ALONG SAID SOUTHERLY LINE, NORTH 59 DEGREES 57 MINUTES 37 SECONDS EAST, 599.39 FEET TO A POINT ON A NON-TANGENT CURVE ALSO BEING THE EASTERLY LINE OF PARCEL 1 AS DESCRIBED IN DEED FROM GARY LAND COMPANY TO THE CHICAGO, LAKE SHORE AND EASTERN RAILWAY COMPANY DATED FEBRUARY 2, 1920 IN DEED RECORD 274, PAGE 1, IN SAID OFFICE OF THE RECORDER; THENCE 706.54 FEET SOUTHWESTERLY ALONG SAID CURVE BEING CONCAVE TO THE EAST, HAVING A RADIUS OF 390.80 FEET AND A CHORD BEARING SOUTH 08 DEGREES 10 MINUTES 00 SECONDS WEST, 614.17 FEET; THENCE CONTINUING ALONG SAID EASTERLY LINE, SOUTH 43 DEGREES 37 MINUTES 37 SECONDS EAST, 949.43 FEET TO A POINT OF CURVATURE, ALSO BEING THE NORTHERLY LINE OF PARCEL 3 AS DESCRIBED IN DEED FROM GARY LAND COMPANY TO THE CHICAGO, LAKE SHORE AND EASTERN RAILWAY COMPANY DATED FEBRUARY 2, 1920 IN DEED RECORD 274, PAGE 1, IN SAID OFFICE OF THE RECORDER; THENCE ALONG SAID NORTHERLY LINE, 1147.32 FEET SOUTHEASTERLY ALONG SAID CURVE, HAVING A RADIUS OF 1432.70 FEET AND A CHORD BEARING SOUTH 66 DEGREES 34 MINUTES 07 SECONDS EAST, 1116.91 FEET TO THE SOUTH LINE OF SECTION 25, TOWNSHIP 37 NORTH, RANGE 9 WEST OF THE SECOND PRINCIPAL MERIDIAN ALSO BEING THE NORTH LINE OF PARCEL 2 AS DESCRIBED IN DEED FROM GARY LAND COMPANY TO THE CHICAGO, LAKE SHORE AND EASTERN RAILWAY COMPANY DATED FEBRUARY 2, 1920 IN DEED RECORD 274, PAGE 1, IN SAID OFFICE OF THE RECORDER; THENCE ALONG SAID LINE SOUTH 89 DEGREES 30 MINUTES 36 SECONDS EAST, 2035.32 FEET TO THE POINT OF BEGINNING, EXCEPTING THEREFROM THE FOLLOWING DESCRIBED PARCEL: COMMENCING AT THE INTERSECTION OF THE SOUTHERLY LINE OF THE ELGIN, JOLIET AND EASTERN RAILWAY COMPANY (FORMERLY THE CHICAGO LAKE SHORE AND EASTERN RAILWAY COMPANY) AS DESCRIBED IN DEED FROM GARY LAND COMPANY TO CHICAGO LAKE SHORE AND EASTERN RAILWAY COMPANY DATED JUNE 20, 1928 IN DEED RECORD 432 PAGE 553, IN THE OFFICE OF THE RECORDER,

LAKE COUNTY, INDIANA, WITH THE WEST LINE OF VEEDER TRACT NO. 1 AS DESCRIBED IN DEED FROM GARY LAND COMPANY TO INDIANA STEEL COMPANY DATED FEBRUARY 21, 1908 IN DEED RECORD 128 PAGE 537 IN SAID OFFICE OF THE RECORDER; THENCE ALONG SAID SOUTHERLY LINE, NORTH 64 DEGREES 24 MINUTES 42 SECONDS WEST, 111.87 FEET; THENCE SOUTH 25 DEGREES 35 MINUTES 18 SECONDS WEST, 229.89 FEET TO THE NORTH LINE OF PARCEL 5 AS DESCRIBED IN DEED FROM GARY LAND COMPANY TO THE CHICAGO, LAKE SHORE AND EASTERN RAILWAY COMPANY DATED FEBRUARY 2, 1920 IN DEED RECORD 274, PAGE 1, IN SAID OFFICE OF THE RECORDER, ALSO BEING THE POINT OF BEGINNING OF SAID EXCEPTION; THENCE SOUTH 25 DEGREES 36 MINUTES 00 SECONDS WEST, 50.00 FEET TO THE SOUTH LINE OF SAID PARCEL 5; THENCE ALONG THE SOUTH LINE OF SAID PARCEL 5 NORTH 64 DEGREES 24 MINUTES 00 SECONDS WEST, 56.00 FEET; THENCE NORTH 25 DEGREES 36 MINUTES 00 SECONDS EAST, 50.00 FEET TO THE NORTH LINE OF SAID PARCEL 5; THENCE ALONG THE NORTH LINE OF SAID PARCEL 5 SOUTH 64 DEGREES 24 MINUTES 00 SECONDS EAST, 56.00 FEET TO THE POINT OF BEGINNING, SAID PARCEL CONTAINING 70.60 ACRES, MORE OR LESS.

Prepared by:  
Manhard Consulting, Ltd.  
833 W. Lincoln Hwy, Suite 113E  
Schererville, IN 46375  
219.865.5665  
January 16, 2009



**ELGIN, JOLIET AND EASTERN RAILWAY  
KIRK YARD ACCESS ROAD  
USS to EJ&E**

**LEGAL DESCRIPTION**

THAT PART OF THE SOUTHWEST QUARTER OF SECTION 33, TOWNSHIP 37 NORTH, RANGE 8 WEST OF THE SECOND PRINCIPAL MERIDIAN, IN LAKE COUNTY, INDIANA, BEING DESCRIBED AS FOLLOWS:

COMMENCING AT A POINT ON THE WEST LINE OF SECTION 32, TOWNSHIP 37 NORTH, RANGE 8 WEST OF THE SECOND PRINCIPAL MERIDIAN, 70.59 FEET SOUTH OF THE NORTHWEST CORNER OF SAID SECTION 32 MEASURED ALONG THE WEST LINE OF SAID SECTION, ALSO BEING THE POINT OF COMMENCEMENT OF PARCEL 5 AS DESCRIBED IN DEED TO CHICAGO, LAKE SHORE & EASTERN RAILWAY COMPANY, RECORDED IN DEED BOOK 179 PAGE 350, IN THE OFFICE OF THE RECORDER, LAKE COUNTY, INDIANA; THENCE ALONG A NORTHERLY LINE OF SAID PARCEL 5, SOUTH 64 DEGREES 24 MINUTES 42 SECONDS EAST (THIS AND ALL SUBSEQUENT BEARINGS BASED ON THE INDIANA COORDINATE SYSTEM OF 1983, WEST ZONE), 2794.45 FEET TO A POINT BEING THE POINT OF BEGINNING OF A PARCEL DESCRIBED IN DEED TO UNITED STATES STEEL CORPORATION RECORDED SEPTEMBER 23, 1976 AS DOCUMENT NUMBER 371422; THENCE THE FOLLOWING FOUR (4) COURSES ALONG THE SOUTHERLY LINE OF SAID UNITED STATES STEEL CORPORATION PARCEL, (1) SOUTH 48 DEGREES 00 MINUTES 20 SECONDS EAST, 129.91 FEET; (2) SOUTH 27 DEGREES 14 MINUTES 42 SECONDS EAST, 261.00 FEET TO A POINT OF CURVATURE; (3) SOUTHEASTERLY 244.72 FEET ALONG A CURVE BEING CONCAVE TO THE NORTHEAST, HAVING A RADIUS OF 377.26 FEET AND A CHORD BEARING SOUTH 45 DEGREES 49 MINUTES 42 SECONDS EAST, 240.45 FEET TO A POINT OF TANGENCY; (4) SOUTH 64 DEGREES 24 MINUTES 42 SECONDS EAST, 2698.44 FEET TO A POINT ON THE NORTHERLY LINE OF SAID PARCEL 5, ALSO BEING THE POINT OF BEGINNING; THENCE SOUTH 60 DEGREES 45 MINUTES 11 SECONDS EAST, 511.20 FEET TO A POINT ON THE NORTHERLY LINE OF SAID PARCEL 5; THENCE ALONG SAID NORTHERLY LINE FOR THE FOLLOWING FOUR (4) COURSES; (1) WESTERLY 103.20 FEET ALONG A CURVE CONCAVE TO THE NORTH, HAVING A RADIUS OF 458.74 FEET AND A CHORD BEARING NORTH 70 DEGREES 51 MINUTES 08 SECONDS WEST, 102.99 FEET TO A POINT OF TANGENCY; (2) NORTH 64 DEGREES 24 MINUTES 26 SECONDS WEST, 194.00 FEET; (3) NORTH 54 DEGREES 52 MINUTES 56 SECONDS WEST, 185.80 FEET, TO A POINT OF CURVATURE; (4) NORTHWESTERLY 33.39 FEET ALONG A CURVE BEING CONCAVE TO THE NORTHEAST, HAVING A RADIUS OF 1247.09 FEET AND A CHORD BEARING NORTH 40 DEGREES 45 MINUTES 24 SECONDS WEST, 33.39 FEET TO THE POINT OF BEGINNING, SAID PARCEL CONTAINING 0.226 ACRES, MORE OR LESS.

Prepared by:  
Manhard Consulting, Ltd.  
833 W. Lincoln Hwy, 113E  
Schererville, IN 46375  
219.865.5665  
January 27, 2009



THAT PART OF THE SOUTH HALF OF SECTION 30, PART OF THE NORTH HALF OF SECTION 31, PART OF SECTION 32 AND PART OF THE WEST HALF OF SECTION 33, ALL IN TOWNSHIP 37 NORTH, RANGE 8 WEST OF THE SECOND PRINCIPAL MERIDIAN, IN LAKE COUNTY, INDIANA, BEING DESCRIBED AS FOLLOWS:

COMMENCING AT A POINT ON THE WEST LINE OF SAID SECTION 32, 70.59 FEET SOUTH OF THE NORTHWEST CORNER OF SAID SECTION 32 MEASURED ALONG THE WEST LINE OF SAID SECTION, ALSO BEING THE POINT OF COMMENCEMENT OF PARCEL 5 AS DESCRIBED IN DEED TO CHICAGO, LAKE SHORE & EASTERN RAILWAY COMPANY, RECORDED IN DEED BOOK 179 PAGE 350, IN THE OFFICE OF THE RECORDER, LAKE COUNTY, INDIANA; THENCE ALONG SAID WEST LINE SOUTH 01 DEGREES 01 MINUTES 25 SECONDS WEST, 38.10 FEET TO THE POINT OF BEGINNING; THENCE SOUTH 71 DEGREES 29 MINUTES 51 SECONDS EAST, 280.92 FEET TO THE NORTHERLY LINE OF SAID PARCEL 5; THENCE ALONG THE NORTHERLY LINE OF SAID PARCEL 5, SOUTH 64 DEGREES 24 MINUTES 42 SECONDS EAST (THIS AND ALL SUBSEQUENT BEARINGS BASED ON THE INDIANA COORDINATE SYSTEM OF 1983, WEST ZONE), 2499.83 FEET TO A POINT BEING THE POINT OF BEGINNING OF A PARCEL DESCRIBED IN DEED TO UNITED STATES STEEL CORPORATION RECORDED SEPTEMBER 23, 1976 AS DOCUMENT NUMBER 371422; THENCE THE FOLLOWING FOUR (4) COURSES ALONG THE SOUTHERLY LINE OF SAID UNITED STATES STEEL CORPORATION PARCEL, (1) SOUTH 48 DEGREES 00 MINUTES 20 SECONDS EAST, 129.91 FEET; (2) SOUTH 27 DEGREES 14 MINUTES 42 SECONDS EAST, 261.00 FEET TO A POINT OF CURVATURE; (3) SOUTHEASTERLY 244.72 FEET ALONG A CURVE BEING CONCAVE TO THE NORTHEAST, HAVING A RADIUS OF 377.26 FEET AND A CHORD BEARING SOUTH 45 DEGREES 49 MINUTES 42 SECONDS EAST, 240.45 FEET TO A POINT OF TANGENCY; (4) SOUTH 64 DEGREES 24 MINUTES 42 SECONDS EAST, 2698.44 FEET TO A POINT ON A NON-TANGENT CURVE ALSO BEING A POINT ON THE NORTHERLY LINE OF SAID PARCEL 5; THENCE ALONG SAID NORTHERLY LINE FOR THE FOLLOWING FOUR (4) COURSES; (1) SOUTHEASTERLY 33.39 FEET ALONG A CURVE BEING CONCAVE TO THE NORTHEAST, HAVING A RADIUS OF 1247.09 FEET AND A CHORD BEARING SOUTH 40 DEGREES 45 MINUTES 24 SECONDS EAST, 33.39 FEET; (2) SOUTH 54 DEGREES 52 MINUTES 56 SECONDS EAST, 185.80 FEET; (3) SOUTH 64 DEGREES 24 MINUTES 26 SECONDS EAST, 194.00 FEET TO A POINT OF CURVATURE; (4) EASTERLY 103.20 FEET ALONG A CURVE CONCAVE TO THE NORTH, HAVING A RADIUS OF 458.74 FEET AND A CHORD BEARING SOUTH 70 DEGREES 51 MINUTES 08 SECONDS EAST, 102.99 FEET TO A POINT ON A NON-TANGENT LINE; THENCE SOUTH 61 DEGREES 12 MINUTES 08 SECONDS EAST, 214.67 FEET TO A POINT OF CURVATURE; THENCE SOUTHEASTERLY 495.16 FEET ALONG A CURVE CONCAVE TO THE SOUTHWEST HAVING A RADIUS OF 500.00 FEET WITH A CHORD BEARING SOUTH 32 DEGREES 49 MINUTES 54 SECONDS EAST, 475.17 FEET TO A POINT OF TANGENCY; THENCE SOUTH 04 DEGREES 27 MINUTES 41 SECONDS EAST, 430.26 FEET; THENCE SOUTH 00 DEGREES 10 MINUTES 19 SECONDS WEST, 354.11 FEET TO A POINT ON A NON-TANGENT CURVE; THENCE SOUTHWESTERLY 189.46 FEET ALONG A CURVE BEING CONCAVE TO THE SOUTHEAST, HAVING A RADIUS OF 112.29 FEET WITH A CHORD BEARING SOUTH 48 DEGREES 45 MINUTES 05 SECONDS WEST, 167.77 FEET TO A NON-TANGENT LINE; THENCE SOUTH 30 DEGREES 18 MINUTES 24 SECONDS EAST, 216.79 FEET; THENCE SOUTH 09 DEGREES 23 MINUTES 38 SECONDS WEST, 66.04 FEET; THENCE SOUTH 21 DEGREES 34 MINUTES 51 SECONDS WEST, 150.51 FEET TO THE SOUTHERLY LINE OF A PARCEL DESCRIBED IN DEED TO CHICAGO, LAKE SHORE & EASTERN RAILWAY COMPANY,

RECORDED IN DEED BOOK 432 PAGE 557, REFERENCED AS ARTICLE III; THENCE THE FOLLOWING THREE (3) COURSES ALONG SAID SOUTHERLY LINE; (1) NORTH 64 DEGREES 24 MINUTES 42 SECONDS WEST, 7374.11 FEET TO A POINT OF CURVATURE; (2) NORTHWESTERLY 874.70 FEET ALONG A CURVE CONCAVE TO THE NORTHEAST, HAVING A RADIUS OF 5779.61 FEET AND A CHORD BEARING NORTH 60 DEGREES 04 MINUTES 34 SECONDS WEST, 873.87 FEET TO A POINT OF TANGENCY; (3) NORTH 55 DEGREES 44 MINUTES 25 SECONDS WEST, 735.82 FEET TO THE SOUTHERLY LINE OF PARCEL 4 DESCRIBED IN DEED TO CHICAGO, LAKE SHORE & EASTERN RAILWAY COMPANY, RECORDED FEBRUARY 16, 1920 IN DEED BOOK 274 PAGE 1, IN THE OFFICE OF THE RECORDER, LAKE COUNTY, INDIANA; THENCE NORTH 64 DEGREES 24 MINUTES 42 SECONDS WEST, 3831.64 FEET TO THE WEST LINE OF SAID SECTION 30; THENCE NORTH 00 DEGREES 20 MINUTES 42 SECONDS WEST ALONG SAID WEST LINE, 576.73 FEET; THENCE NORTH 90 DEGREES 00 MINUTES 00 SECONDS EAST, 191.69 FEET TO A POINT OF CURVATURE; THENCE 361.90 FEET EASTERLY ALONG A CURVE BEING CONCAVE TO THE NORTH HAVING A RADIUS OF 650.00 FEET WITH A CHORD BEARING NORTH 74 DEGREES 02 MINUTES 58 SECONDS EAST, 357.25 FEET TO A POINT OF TANGENCY; THENCE NORTH 58 DEGREES 05 MINUTES 57 SECONDS EAST, 69.22 FEET; THENCE SOUTH 31 DEGREES 54 MINUTES 03 SECONDS EAST, 82.71 FEET TO A POINT OF CURVATURE; THENCE 331.40 FEET SOUTHEASTERLY ALONG A CURVE BEING CONCAVE TO THE NORTHEAST HAVING A RADIUS OF 540.00 FEET WITH A CHORD BEARING SOUTH 49 DEGREES 28 MINUTES 56 SECONDS EAST, 326.22 FEET TO A POINT OF TANGENCY; THENCE SOUTH 67 DEGREES 03 MINUTES 48 SECONDS EAST, 3124.11 FEET; THENCE NORTH 84 DEGREES 13 MINUTES 28 SECONDS EAST, 973.88 FEET TO A POINT OF CURVATURE; THENCE EASTERLY 211.87 FEET ALONG A CURVE BEING CONCAVE TO THE SOUTH HAVING A RADIUS OF 500.00 FEET WITH A CHORD BEARING SOUTH 83 DEGREES 38 MINUTES 11 SECONDS EAST, 210.28 FEET TO A POINT OF TANGENCY; THENCE SOUTH 71 DEGREES 29 MINUTES 51 SECONDS EAST, 369.46 FEET TO THE POINT OF BEGINNING, SAID PARCEL CONTAINING 384.97 ACRES, MORE OR LESS.

