

2

STATE OF INDIANA  
LAKE COUNTY  
FILED FOR RECORD

2009 APR 17 AM 8:51

MICHAEL A. BROWN  
RECORDER

2009 024622

**SATISFACTION OF MORTGAGE**

**This Certifies**, that a certain Mortgage executed by BRIAN J. GARCIA. This Security Instrument is given to LAKE MORTGAGE COMPANY, INC. on the 21<sup>ST</sup> day of AUGUST 2002 calling for \$69,000.00 recorded in Mortgage Record No. Page No. Document #2002 078377 LAKE COUNTY, State of INDIANA has been fully paid and satisfied, and the same is hereby released.

WITNESS our hand(s) and seal(s) RD day of MARCH 2009.

ATTEST:

*Susan M. Bristow*



Lake Mortgage Company, Inc.

SUSAN M. BRISTOW, SECRETARY

*Peter S. Briggs II*

PETER S. BRIGGS II, ASST. VICE PRES.

State of Indiana, LAKE County, ss: Before me, the undersigned, a Notary Public in and for said County, this 23<sup>RD</sup> day of MARCH 2009. Personally appeared Susan M. Bristow and Peter S. Briggs II respectively Secretary and Assistant Vice President acknowledged the execution of the annexed satisfaction of mortgage.

Witness my hand and official seal. *Donna S. Rust* Donna S. Rust Notary Public.

My Commission expires 11/18/16 County Residence Lake, Indiana. This instrument was prepared by: Jackie Creighton, Lake Mortgage Co. 4000 West Lincoln Hwy. Merrillville, IN 46410 "I affirm, under penalties for perjury, that I have taken reasonable care to redact each social security number in this document, unless required by law". Jackie Creighton

**LEGAL DESCRIPTION**

PART OF THE WEST 25 ACRES OF THE SOUTHEAST 1/4 OF THE NORTHEAST 1/4 OF SECTION 26, TOWNSHIP 35 NORTH, RANGE 9 WEST OF THE SECOND PRINCIPAL MERIDIAN, IN LAKE COUNTY, INDIANA, DESCRIBED AS: BEGINNING AT A POINT 42 6/17 RODS SOUTH AND 284.15 FEET WEST OF THE NORTHEAST CORNER OF SAID WEST 25 ACRE TRACT AND RUNNING THENCE WEST 100 FEET; THENCE SOUTH TO THE SOUTH LINE OF THE SOUTHEAST

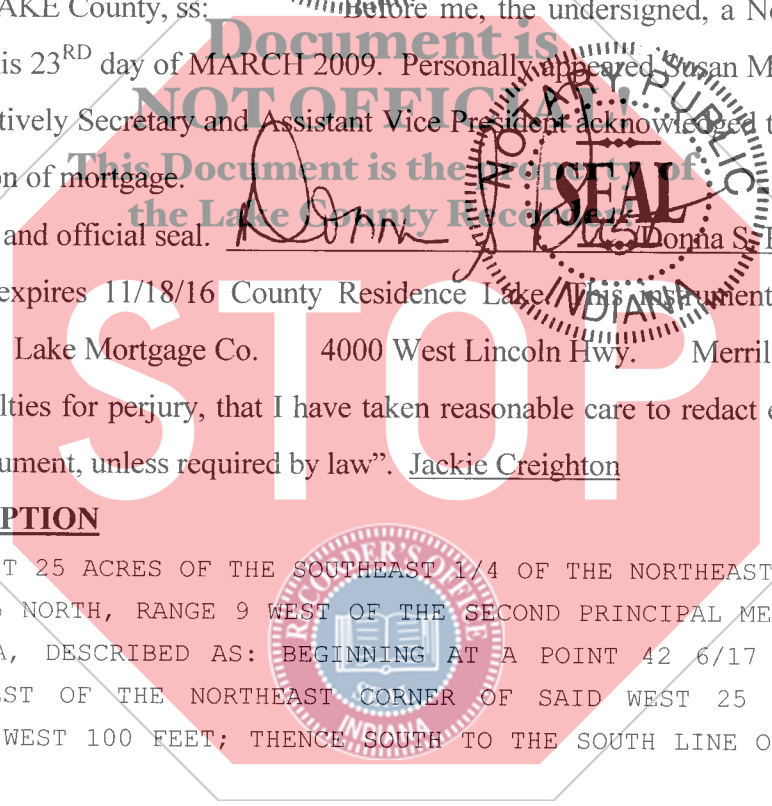

14.00  
addms  
#637#  
E

1/4 OF THE NORTHEAST 1/4 OF SAID SECTION 26; THENCE EAST ALONG SAID SOUTH LINE  
100 FEET; THENCE NORTH TO THE POINT OF BEGINNING.

PTN#45-11-26-276-005.000-050      505393/21547

