

Affidavit to Transfer to Real Estate

State Form 51409 (10/06)

2009 023488

OWNERS of REAL ESTATE: RANDALL ZEMOLA

Lien Holder(s) of Record: NONE

Address of Property: 1845 JEFFREY DRIVE

City: LOWELL State: IN Zip code: 46356

The Indiana Bureau of Motor Vehicles also certifies that the Indiana Title Record Number 09804048000014 for this Manufactured Home has been "Retired" from the Indiana Bureau of Motor Vehicle's active title files, and no further transactions will be allowed. It is the responsibility of the owner of the manufactured home/real estate, in accordance with I. C. 9-17-6-15.3, to deliver this document to the county auditor for endorsement. The application with the manufactured home description and property description is attached.

Furthermore, it is also the responsibility of the owner of the manufactured home/real estate to record the Affidavit to Transfer to Real Estate, the Application for Affidavit to Transfer Real Estate, and Certificate of Title in the county in which the real estate is located.

By: Wanda Morris
Signature
Wanda Morris
Printed Name
ATRE Supervisor
Title

STATE OF INDIANA } SS: (SEAL)
COUNTY OF MARION } SS:

I, Andrew J. Miller, Commissioner of the Indiana Bureau of Motor Vehicles and custodian of the records therein, hereby certify that the attached is a full, true and complete copy of the record as it appears in the files of the Indiana Bureau of Motor Vehicles.

In testimony whereof, I and my duly authorized representative execute this certification and affix the seal of the Indiana Bureau of Motor Vehicles this 20TH day of MARCH, 2009

Andrew J. Miller

Andrew J. Miller

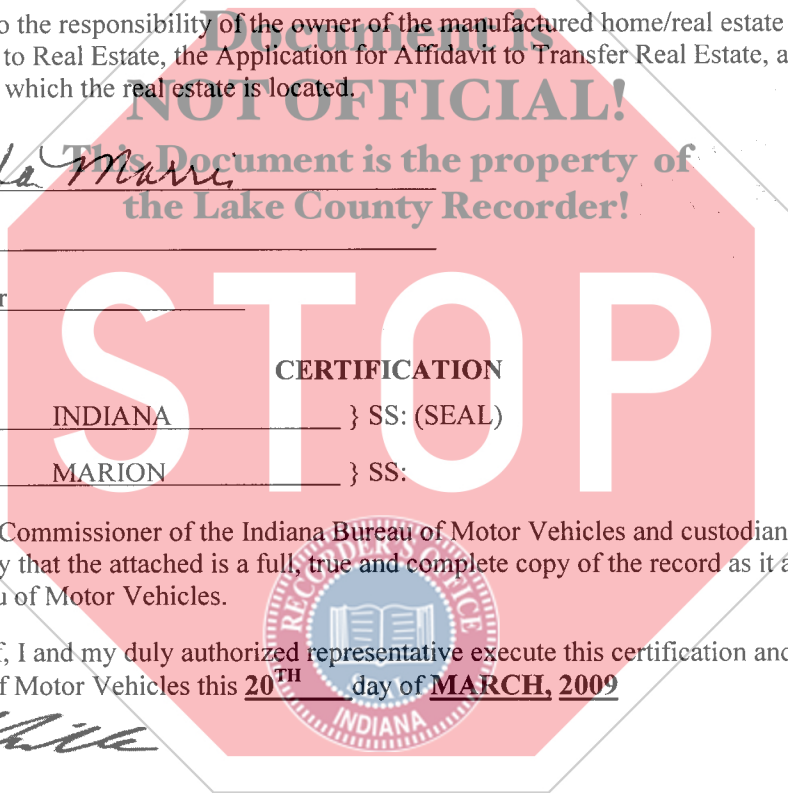

STATE OF INDIANA
LAKE COUNTY
FILED FOR RECORD
MARCH 14 AM 8:42
MICHAELA BROWN
RECORDER

2200
193281
PB

E



STATE OF INDIANA

CERTIFICATE OF TITLE FOR A VEHICLE

MAKE PALM HARBOR	MODEL NAME RTRD	YEAR 1992	VIN 201445030
TITLE TYPE CORRECTION	FORMER TITLE/STATE 08804172000013 / IN	PURCHASE DATE 11/12/93	BODY TYPE MH
		USAGE TAX PAID 0	ISSUE DATE 03/18/09

MAILING ADDRESS
 RANDALL ZEMOLA
 1845 JEFFREY DRIVE
 LOWELL IN 46356

ODOMETER/BRAND
 EXEMPT

/EXEMPT

BRAND(S)

OWNER(S) NAME
 RANDALL ZEMOLA
 1845 JEFFREY DRIVE
 LOWELL IN 46356

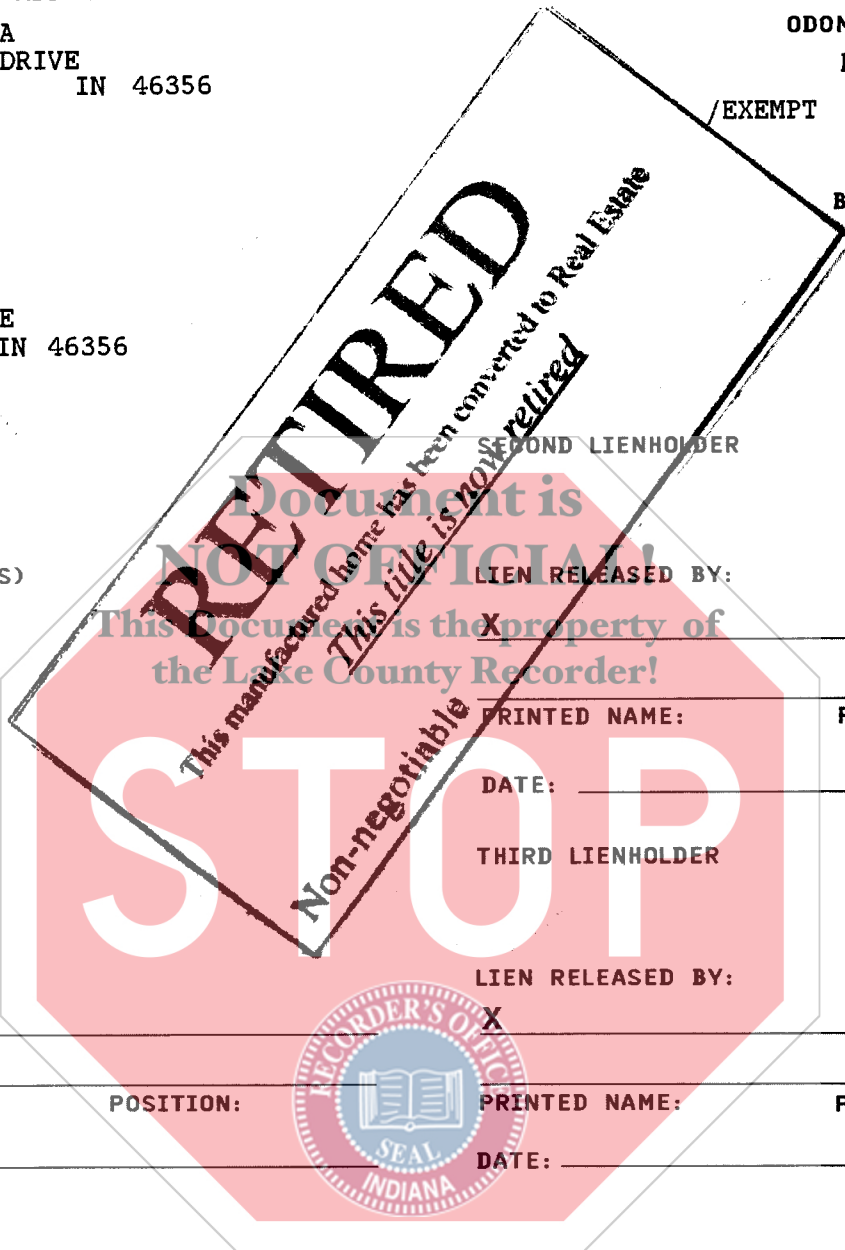

ADDITIONAL OWNER(S)

SECOND LIENHOLDER

LIEN RELEASED BY:

This document is NOT OFFICIAL!
This document is the property of the Lake County Recorder!

PRINTED NAME:

POSITION:

DATE:

FIRST LIENHOLDER

THIRD LIENHOLDER

LIEN RELEASED BY:

LIEN RELEASED BY:

X

X

PRINTED NAME:

POSITION:

PRINTED NAME:

POSITION:

DATE:

DATE:



The Commissioner of the Bureau of Motor Vehicles, pursuant to the laws of the State of Indiana, certifies that the vehicle/watercraft has been duly titled and the owner of the described vehicle/watercraft is subject to the liens set forth.

INDIANA BUREAU OF MOTOR VEHICLES
 Andrew J. Miller, Commissioner

TITLE NUMBER
 09804048000014

DO NOT ACCEPT TITLE SHOWING ANY ERASURES, ALTERATIONS OR MUTILATIONS

PLEASE TYPE OR PRINT INFORMATION

REQUIREMENTS: Federal and State law requires that you state the mileage in connection with the transfer of ownership. Failure to complete, or providing a false statement may result in fines and or imprisonment.

TO SELLER: Seller is responsible for completing form. If title is in more than one name, all owners must sign as seller. Do not sign as a Seller until all areas of the assignment are completed. Any person signing for a company must state position.

TO PURCHASER: You must apply for a new certificate of title within thirty-one days of the date of purchase, or pay a delinquent penalty fee. All liens shown on the face of this title must be released before you apply for a new title. Take this to your local BMVC License Branch to complete your application for a new title.

We swear or affirm that the information on this form is correct. We understand that a false statement may constitute the crime of perjury.

I (We) certify to the best of my (our) knowledge that the odometer now reads and is the ACTUAL MILEAGE of the vehicle unless one of the following statements is checked.

No Tenth's MILES

The odometer reading stated is in excess of its mechanical limits. The odometer reading is not the actual mileage.

WARNING - ODOMETER DISCREPANCY

SELLER INFORMATION

PURCHASER INFORMATION

Signature of Seller		Position	
Signature of Seller		Position	
Print name of seller		Dealer Number	
Print name of seller			
Date of sale (month, day, year)	Selling price	Trade in price(if any)	Total price paid

Name of Purchaser		Dealer Number	
Address			
City		State	Zip Code
Name of Lienholder			
Address			
City		State	Zip Code
I AM AWARE OF THE ABOVE ODOMETER CERTIFICATION MADE BY THE SELLER(S)			
Signature of purchaser		Print name of purchaser	

FIRST RE-ASSIGNMENT BY REGISTERED DEALER ONLY

I certify to the best of my knowledge that the odometer reading is the ACTUAL MILEAGE of the vehicle unless one of the following statements is checked.

The odometer reading stated is in excess of its mechanical limits.
 The odometer reading is not actual mileage
WARNING ODOMETER DISCREPANCY

Name of dealership	
Signature	
Print Name	
Position	Dealer Number
Date of sale(month,day,year)	

Name of Purchaser		Dealer Number	
Address			
City		State	Zip Code
Name of Lienholder			
Address			
City		State	Zip Code
I AM AWARE OF THE ABOVE ODOMETER CERTIFICATION MADE BY THE SELLER(S)			
Signature of purchaser		Print name of purchaser	

SECOND RE-ASSIGNMENT BY REGISTERED DEALER ONLY

I certify to the best of my knowledge that the odometer reading is the ACTUAL MILEAGE of the vehicle unless one of the following statements is checked.

The odometer reading stated is in excess of its mechanical limits.
 The odometer reading is not actual mileage
WARNING ODOMETER DISCREPANCY

Name of dealership	
Signature	
Print Name	
Position	Dealer Number
Date of sale(month,day,year)	

Name of Purchaser		Dealer Number	
Address			
City		State	Zip Code
Name of Lienholder			
Address			
City		State	Zip Code
I AM AWARE OF THE ABOVE ODOMETER CERTIFICATION MADE BY THE SELLER(S)			
Signature of purchaser		Print name of purchaser	

THIRD RE-ASSIGNMENT BY REGISTERED DEALER ONLY

I certify to the best of my knowledge that the odometer reading is the ACTUAL MILEAGE of the vehicle unless one of the following statements is checked.

The odometer reading stated is in excess of its mechanical limits.
 The odometer reading is not actual mileage
WARNING ODOMETER DISCREPANCY

Name of dealership	
Signature	
Print Name	
Position	Dealer Number
Date of sale(month,day,year)	

Name of Purchaser		Dealer Number	
Address			
City		State	Zip Code
Name of Lienholder			
Address			
City		State	Zip Code
I AM AWARE OF THE ABOVE ODOMETER CERTIFICATION MADE BY THE SELLER(S)			
Signature of purchaser		Print name of purchaser	

NO ADDITIONAL RE-ASSIGNMENTS PERMITTED



APPLICATION FOR AFFIDAVIT TO TRANSFER TO REAL ESTATE

State Form 51408 (R / 8-07)
BUREAU OF MOTOR VEHICLES

147541666
144967959
Home Owner Information

RECEIVED
OCT 22 2008

Name of Applicant Randall Zemola, Sr.	County Lake
Current Address (number & street, city, state, & ZIP code) 1845 Jeffrey Dr. Lowell, IN 46356	

Return Packet to (Title Company, Bank, etc.)

Name Transcontinental Title Co. / Attn. Team B E. Kenig
Address (number & street, city, state, & ZIP code) 2605 Enterprise Rd. E # 300 Clearwater, FL 33759

Manufactured Home Information

Current Address (number & street, city, state, & ZIP code) 1845 Jeffrey Dr. Lowell, IN 46356
County Lake
Description of Home manufactured home
HUD Certification Number PES246495
Year 1992
Name of Manufacturer Palm Harbor Homes
Serial Number 201445030

Real Estate Information

Parcel Number 17-04-0087-0003
Description of Real Estate (please see attached)

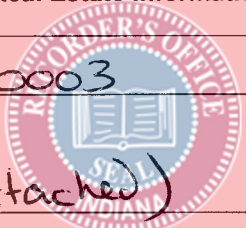
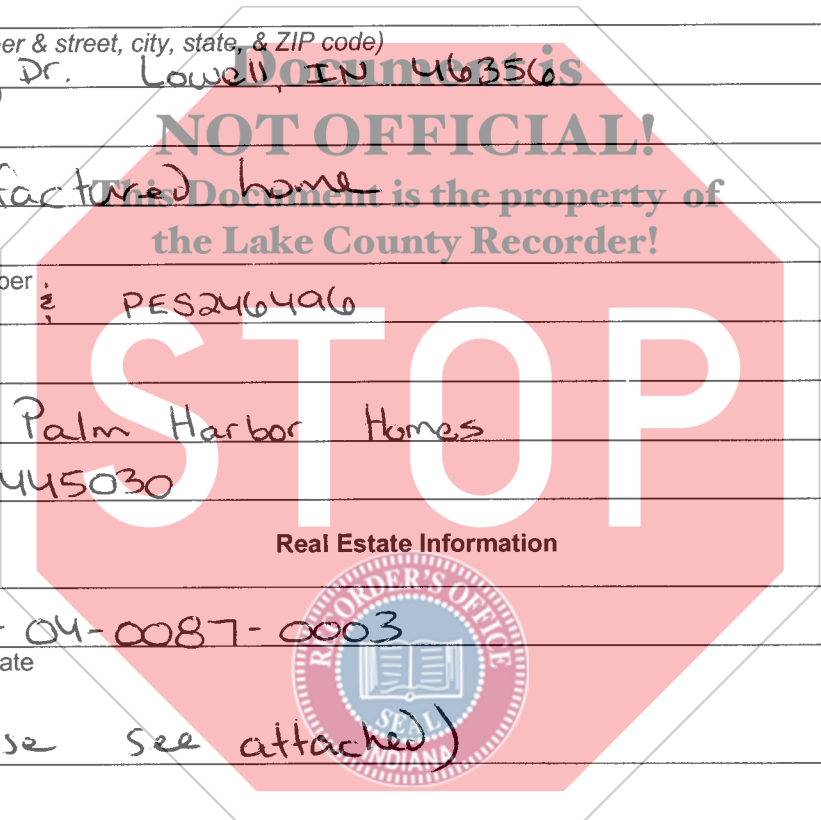

Attestation to permanent attachment to real estate of a manufactured home

"The manufactured home, aforementioned in this application, is permanently attached to real estate, as described in the legal description of the real estate. I swear or affirm that the information I have entered on this form is correct. I understand that making a false statement on this form may constitute the crime of perjury."

Signature <i>Randall Zimola</i>	Printed Name RANDALL ZIMOLA	Date (month, day, year) 8/5/08
Signature	Printed Name	Date (month, day, year)

Notary Certification

STATE OF Indiana

COUNTY OF Lake

Document is NOT OFFICIAL! (SEAL)

Sworn to before me, a Notary Public, in and for said County, this 5 day of August, 2008

Printed Name and Signature of Notary Public Abby N Mummery - Abby N Mummery

Per IC 36-2-11-15(d): "I affirm, under the penalties for perjury, that I have taken reasonable care to redact each Social Security number in this document, unless required by law."

Signature <i>Lisa Kenig</i>	Printed Name LISA KENIG	Date (month, day, year) 08.04.08
--------------------------------	----------------------------	-------------------------------------



EXHIBIT "A"

10-01040702

THE FOLLOWING DESCRIBED REAL ESTATE SITUATE IN LAKE COUNTY, INDIANA, DESCRIBED AS FOLLOWS, TO WIT:

BEL-AIRE ESTATES UNIT 4, LOT 16 UNIT 4 IN THE TOWN OF LOWELL AS SHOWN IN PLAT BOOK 45, PAGE 90, LAKE COUNTY, INDIANA.

BEING THE SAME PROPERTY CONVEYED TO RANDALL J. ZEMOLA BY DEED FROM KENLYN D. ZEMOLA RECORDED 07/30/1998 IN DOCUMENT NO. 98058695, IN THE RECORDER'S OFFICE OF LAKE COUNTY, INDIANA.

TOGETHER WITH MANUFACTURED HOME:

1992 Palm Harbor

VIN #: 201445030

