

Merri L. Shand Doll as President of Merri Inc. and also as Landlord of the real estate known as 7925 Nevada, Hammond, Indiana acknowledges that Merri Inc. has validly exercised it's first option to renew the lease dated December 18, 1996 for five years. The terms of the lease shall remain the same except that the monthly rent shall be increased to Three Thousand and Fifty Dollars (\$3,050) per month starting on August 1, 2006. This \$3,050 amount shall include the Tenant's share of real estate taxes on the premises and no additional amount for real estate taxes shall be due from the Tenant. This increased rental amount shall be retroactive to August 1, 2006.

Date Aug. 1st, 2006

Landlord:  
Merri L. Shand Doll  
Merri L. Shand Doll

Tenant:  
Merri, Inc.

By Connie Black

DOC. NO. 98031298

LEGAL Desf.

1. Kennedy Park Industrial Park
- 2 PT. Lot 4
- 3 Parcel 250X145.832 AC.

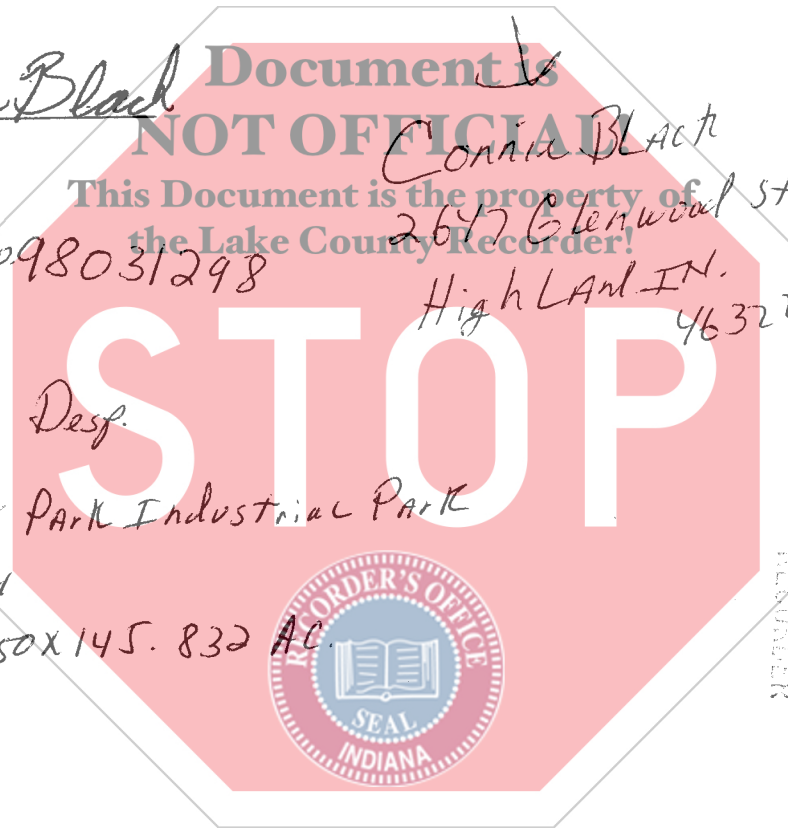

Connie Black  
2677 Glenwood St  
Highland IN. 46322

2008 079677

2008 NOV 21 11:11:32

PROCESSED BY  
RECORDER

300  
CASH  
PB