

Assignment of Mortgage

HOLLOWAY LUMBER & CONSTRUCTION CO., INC.

_____ of the County of
Lake _____ and State of Indiana _____ in consideration of the
sum of Five thousand two hundred and twenty two & no/cents Dollars, to me in hand paid by
Property Owner's S & T, Inc. _____ of the County of _____

Lake _____ do hereby sell, transfer and assign, without recou to said
Property Owner's S & T, Inc. _____ all my right, title and interest in and to a certain
mortgage executed to me by Benjamin F. & Dottie Griffin
of the County of Lake _____ and State of Indiana, on the 20th day of
January 19~~20~~2004, on the real estate therein described, situate in the County of
Lake _____ and State of Indiana, to seure the payment of one principal note bearing date
October 16, 19⁹⁵, for the sum of
Five thousand two hundred and twenty two & no/cents Dollars, and becoming due on the
_____ day of _____ 19 _____ and _____ coupon interest notes thereto attached
which said notes have been sold and assigned, without recourse, by me to said
Property Owner's S & T, Inc. _____

_____ for the consideration above named.
Said mortgage having been recorded in mortgage record 96049212 on page _____ on the
Recorder's office of the County of Lake _____ and State of Indiana on the 24th
day of July 19⁹⁶

In Witness Whereof, I have hereunto set my hand and seal

20th day of January, 2004 19 _____
Donna M. Pearson, Manager (Seal) _____ Lake _____ County _____

2008 075856

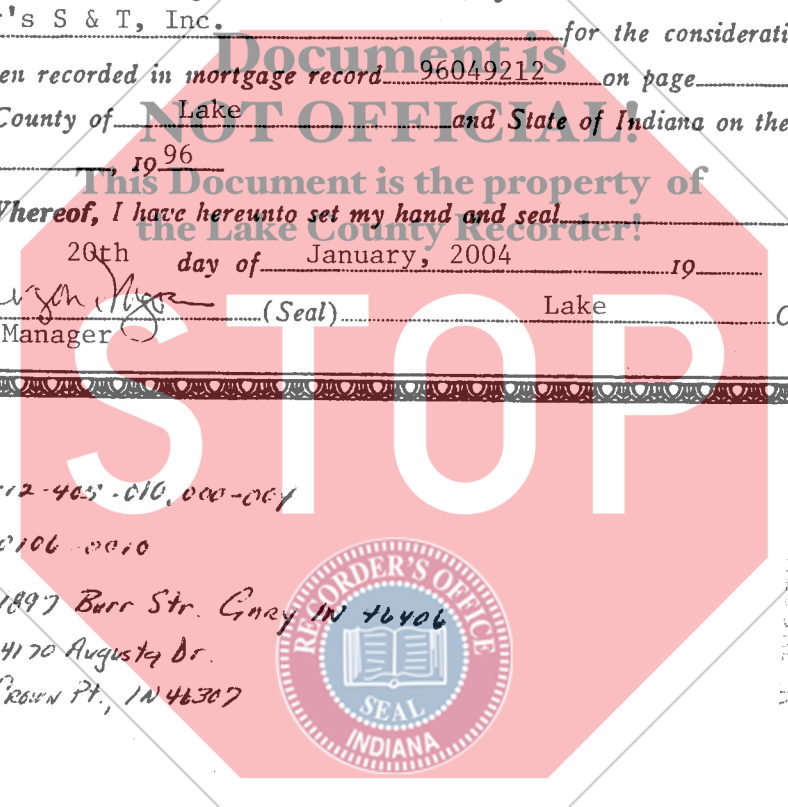

New Parcel # 45-07-12-405-010, 000-001
Old Parcel # 25-40-0106-0010
commonly known as 1897 Burr Str. Gary IN 46406
After recording send to: 4170 Auguster Dr.
Crown Pt., IN 46307



RECORDER'S OFFICE
LAKE COUNTY, INDIANA
2008-07-24 10:57

141-00
CS
RB



STATE OF INDIANA }
Lake County }
Sct.

Before me, Bessie Miazga a Notary

in and for said County and State, this _____ day of _____ 19____

personally appeared the above named Donna M. Pearson, Manager of Holloway Lumber & Construction Co., Inc.

to me well known, and acknowledged the above and foregoing assignment.

Witness my hand _____ seal.

Bessie Miazga
Bessie Miazga, Porter County Resident
Commission Expires: 1/28/05

Assignment of Mortgage

TO

Received for Record

The _____ day of _____
A. D. 19____ at _____ o'clock _____ M.

and recorded in Record _____

Page _____

Recorder _____ County

Recorder's fee _____