

H

STATE OF INDIANA
LAKE COUNTY
FILED FOR RECORD

DC-1307
TOWN OF MUNSTER

2008 067011 2008 SEP 25 AM 11:15
FLOOD PROTECTION LEVEL EASEMENT

MICHAEL A. CROWN
RECORDER

TOWN OF MUNSTER, of the County of Lake, State of Indiana, hereinafter called "Grantor", hereby grants, transfers, conveys and warrants to the **STATE OF INDIANA, LITTLE CALUMET RIVER BASIN DEVELOPMENT COMMISSION**, hereinafter called "Grantee", for One Dollar and other Good and Valuable Consideration, the receipt and sufficiency of which is hereby acknowledged, a perpetual and assignable levee easement in, over and across the following described Real Estate owned by the "Grantor" and situated in the County of Lake, State of Indiana, described as follows:

(EXHIBIT "A" AND "A-1" ATTACHED HERETO)

in connection with the Little Calumet River, Indiana Local Flood Protection and Recreation Project as authorized by Section 401 of the Water Resources Development Act of 1986 (P.L. 99-662) to construct, maintain, repair, operate, patrol and replace a flood protection levee, including all appurtenances thereto; reserving, however, to the owners, their heirs and assigns, all such rights and privileges in the land as may be used without interfering with or abridging the rights and easement hereby acquired; subject however to existing easement for public roads and highways, public utilities, railroads and pipelines as long as they do not interfere with the project.

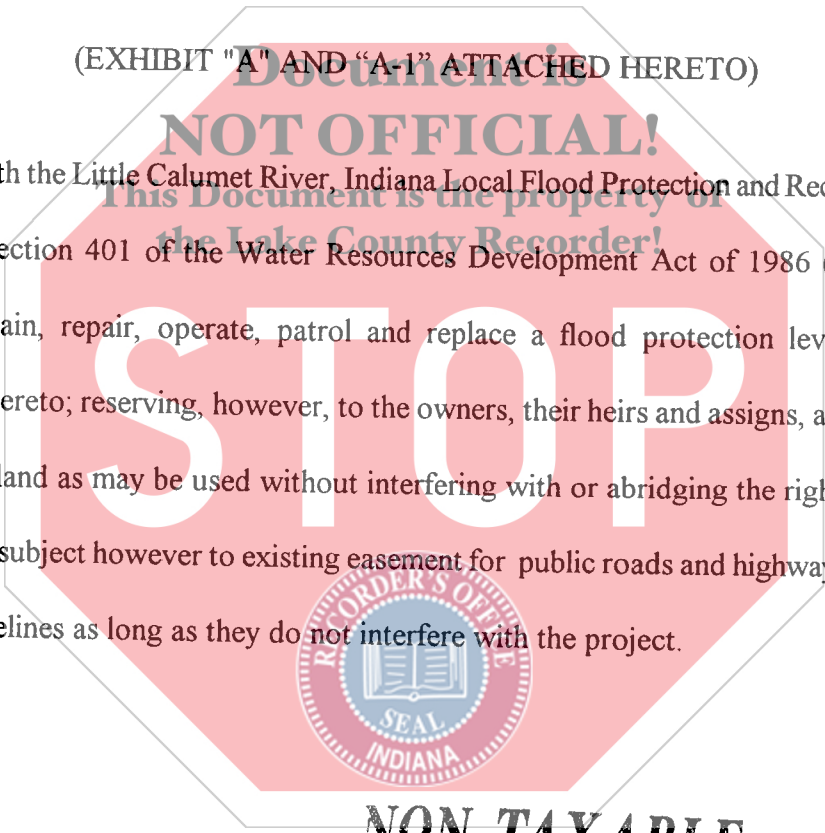

NON-TAXABLE

SEP 25 2008

PEGGY HOLINGA KATONA
LAKE COUNTY AUDITOR

*Return to
Grantee's address:*

Little Calumet River Basin
Development Commission
6100 Southport Road
Portage, IN 46368

#18
CK#
010145
VJ

015914

COUNTY: LAKE
SECTION: 13 & 18
TOWNSHIP: 36 NORTH
RANGE: 9 & 10 WEST
TAX KEY: NONE

OWNER: TOWN OF MUNSTER

FLOOD PROTECTION LEVEE EASEMENT

DC-1307



POINT OF COMMENCEMENT
LEVEE EASE. & TEMP. EASE.

POINT OF BEGINNING
LEVEE EASE.

40.00'

LITTLE CALUMET RIVER

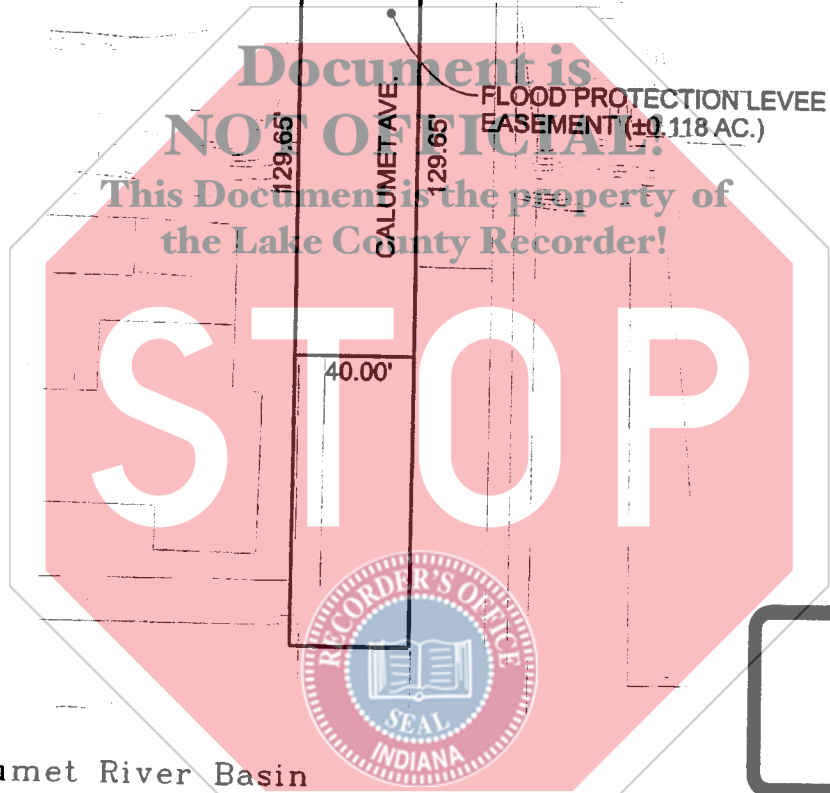

Document is
NOT OFFICIAL!
This Document is the property of
the Lake County Recorder!

129.65'

CALUMET AVE

129.65'

FLOOD PROTECTION LEVEE
EASEMENT (±0.118 AC.)

40.00'

EXHIBIT

A

 Little Calumet River Basin
Development Commission

6100 Southport Road Portage, Indiana 46368

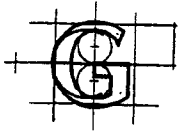

7501 Indianapolis Boulevard
Hammond, IN 46324

Phone: 219.989.1954
Fax: 219.989.3321

www.garcia-consulting.com

GARCIA
CONSULTING

FLOOD PROTECTION LEVEE
EASEMENT (±0.119 AC.)

LITTLE CALUMET RIVER, INDIANA
LOCAL FLOOD PROTECTION
STAGE VIII - MUNSTER

SHEET 3 OF 4

SCALE: 1" = 60'

REVISED DATE: 03/31/08

DC-1307

PHASE 2

COUNTY: LAKE
SECTION: 13 & 18
TOWNSHIP: 36 NORTH
RANGE: 9 & 10 WEST
TAX KEY: NONE

OWNER: TOWN OF MUNSTER

FLOOD PROTECTION LEVEE EASEMENT

DC-1307

A parcel of land in the Southeast Quarter of Section 13, Township 36 North, Range 10 West of the Second Principal Meridian in the City of Hammond, Lake County, Indiana being more particularly described as follows:
Commencing at the southeast corner of Lot 20, Block 8 in Calumet Terrace Addition to the City of Hammond, as per Plat Book 18, Page 26, in the Office of the Recorder of Lake County, Indiana; thence South 00°03'18" West along the west line of Calumet Avenue a distance of 25.68 feet to the Point of Beginning;
thence South 90°00'00" East a distance of 40.00 feet to the east line of the Southeast Quarter of said Section 13;
thence South 00°03'18" West along said line a distance of 129.65 feet;
thence North 90°00'00" West a distance of 40.00 feet to the west line of Calumet Avenue;
thence North 00°03'18" East along said line a distance of 129.65 feet to the Point of Beginning, said parcel containing 0.119 acres, more or less.

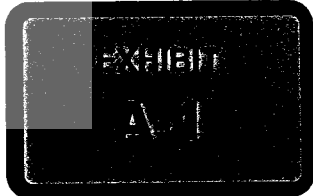
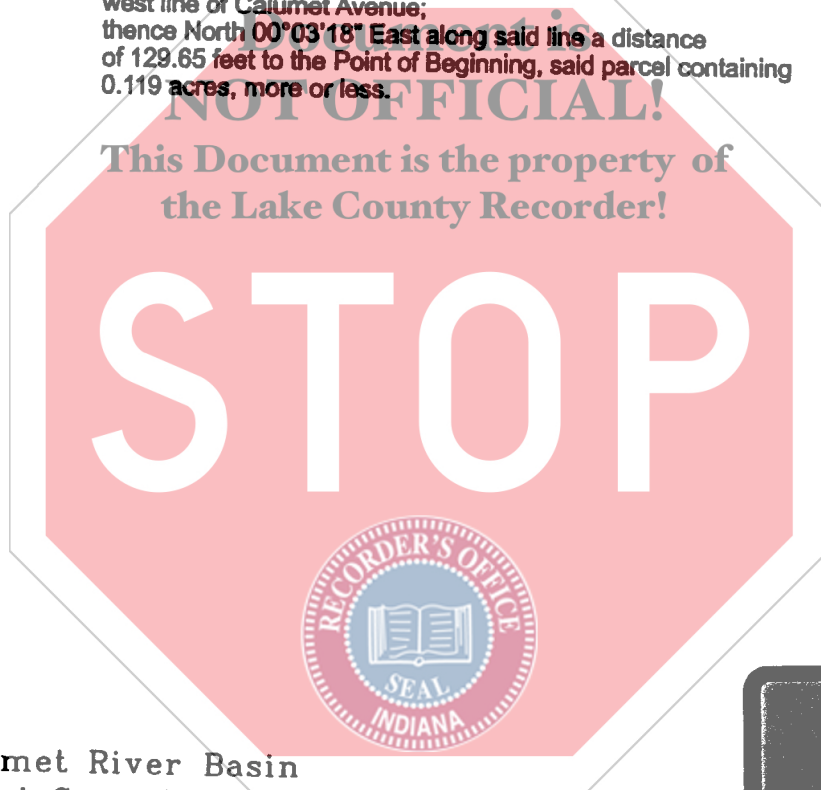

**Little Calumet River Basin
Development Commission**

6100 Southport Road Portage, Indiana 46368



GARCIA
CONSULTING

7501 Indianapolis Boulevard
Hammond, IN 46324

Phone: 219.989.1954
Fax: 219.989.3321

www.garcia-consulting.com

LITTLE CALUMET RIVER, INDIANA
LOCAL FLOOD PROTECTION
STAGE VIII - MUNSTER

SHEET 4 OF 4	SCALE: N/A
REVISED DATE: 03/31/08	DC-1307

PHASE 2