

2

STATE OF INDIANA
LAKE COUNTY
FILED FOR RECORD
2008 SEP 24 AM 8:35
MICHAEL A. BROWN
RECORDER

2008 066410

SATISFACTION OF MORTGAGE

This Certifies, that a certain Mortgage executed by LAWRENCE BRIAN VANDERWALL AND PAMELA G. VANDERWALL, HUSBAND AND WIFE. This Security Instrument is given to LAKE MORTGAGE COMPANY, INC. on the 14TH day of MARCH 1996 calling for \$39,000.00 recorded in Mortgage Record No. Page No. Document #960652 NEWTON COUNTY, State of INDIANA has been fully paid and satisfied, and the same is hereby released.

WITNESS our hand(s) and seal, this 18TH day of SEPTEMBER 2008.

ATTEST:

Susan M. Bristow



Lake Mortgage Company, Inc.

SUSAN M. BRISTOW, SECRETARY

PETER BRIGGS II, ASST. VICE PRES.

State of Indiana, LAKE County, ss. Before me, the undersigned, a Notary Public in and for said County, this 18TH day of SEPTEMBER 2008. Personally appeared Susan M. Bristow and Peter Briggs II respectively Secretary and Assistant Vice President acknowledged the execution of the annexed satisfaction of mortgage.

Witness my hand and official seal.

Donna S. Rust

Donna S. Rust Notary Public.

My Commission expires 11/18/08. County Residence Lake. This instrument was prepared by: Jackie Creighton, Lake Mortgage Co. 4000 West Lincoln Hwy. Merrillville, IN 46410 "I affirm, under penalties for perjury, that I have taken reasonable care to redact each social security number in this document, unless required by law". Jackie Creighton

LEGAL DESCRIPTION

A PART OF THE NORTHWEST QUARTER OF THE NORTHEAST QUARTER OF SECTION TWENTY-EIGHT (28), TOWNSHIP TWENTY-NINE (29) NORTH, RANGE NINE (9) WEST OF THE SECOND PRINCIPAL MERIDIAN, NEWTON COUNTY, INDIANA, DESCRIBED AS FOLLOWS: COMMENCING AT A POINT 30 FEET SOUTH OF THE NORTHWEST CORNER OF THE NORTHEAST QUARTER OF SECTION

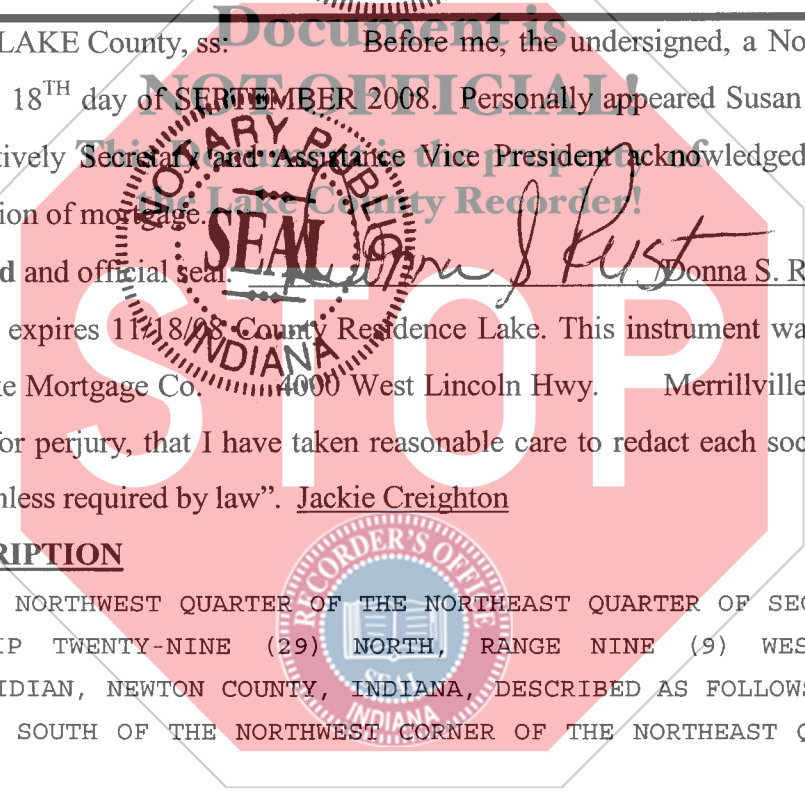

E
✓ #2359
14-
BB

SECTION 28 AND RUNNING THENCE SOUTH A DISTANCE OF 208.3 FEET; THENCE DUE EAST A DISTANCE OF 208.3 FEET; THENCE DUE NORTH A DISTANCE OF 208.3 FEET TO THE SOUTH RIGHT OF WAY LINE OF STATE HIGHWAY 114; THENCE WEST ALONG SAID SOUTH RIGHT OF WAY LINE OF STATE HIGHWAY 114 A DISTANCE OF 208.3 FEET TO THE POINT OF BEGINNING.

PTN#001-03640-00

500175/21155

