

2

STATE OF INDIANA
LAKE COUNTY
FILED FOR RECORD

Known All Men by These Presents, that the
PARK NATIONAL BANK N.A.,
successor to
Pullman Bank and Trust

2008 065999

2008 SEP 19 PM 12:10

MICHAEL A. BROWN
RECORDER

Corporation existing under the laws of the United States of America for and in consideration of One Dollar, and for other good and valuable considerations, the receipt whereof is hereby Confessed, do hereby Remise, Convey, Release and Quit-Claim unto:

Roberta J. Yamtich

Of the County of Lake, State of Indiana, all the right, title, interest, claim or demand whatsoever it may have acquired in, through or by a certain Mortgage Deed bearing the date, October 8, 2004 A .D. and recorded in the Recorder's Office of Lake County, the State of Indiana, as Document #2004 090146 to the premises therein described, situated in the County of Lake, State of Indiana as follows to wit:

MORTGAGE RECORDED: October 21, 2004

LEGAL DESCRIPTION:

UNIT 907 WINDSOR LANE IN WINDSOR LANE TOWNHOMES AS SHOWN IN PLAT BOOK 76 PAGE 45 BEING THAT PART OF LOT 1 IN PARKVIEW TERRACE 7TH ADDITION TO THE TOWN OF DYER AS PER PLAT THEREOF RECORDED IN PLAT BOOK 76 PAGE 6 IN THE OFFICE OF THE RECORDER OF LAKE COUNTY, INDIANA DESCRIBED AS COMMENCING AT THE NORTHWEST CORNER OF SAID LOT 1; THENCE SOUTH 00 DEGREES 16 MINUTES 46 SECONDS WEST ALONG THE WEST LINE OF SAID LOT 1 A DISTANCE OF 198.60 FEET TO THE POINT OF BEGINNING; THENCE SOUTH 89 DEGREE 43 MINUTES 14 SECONDS EAST A DISTANCE OF 89.0 FEET; THENCE SOUTH 00 DEGREES 16 MINUTES 46 SECONDS WEST A DISTANCE OF 36.0 FEET; THENCE NORTH 89 DEGREES 43 MINUTE 14 SECONDS WEST A DISTANCE OF 39.0 FEET TO A POINT ON WEST LINE OF LOT 1; THENCE NORTH 00 DEGREES 16 MINUTES 46 SECONDS EAST ALONG THE WEST LINE OF LOT 1 A DISTANCE OF 36.0 FEET TO A POINT OF BEGINNING ALL IN LAKE COUNTY, INDIANA

The Real Property of its address is commonly known as 907 Windsor Lane, Dyer, IN. 46311

Permanent Index Numbers: 12-14-0246-0004

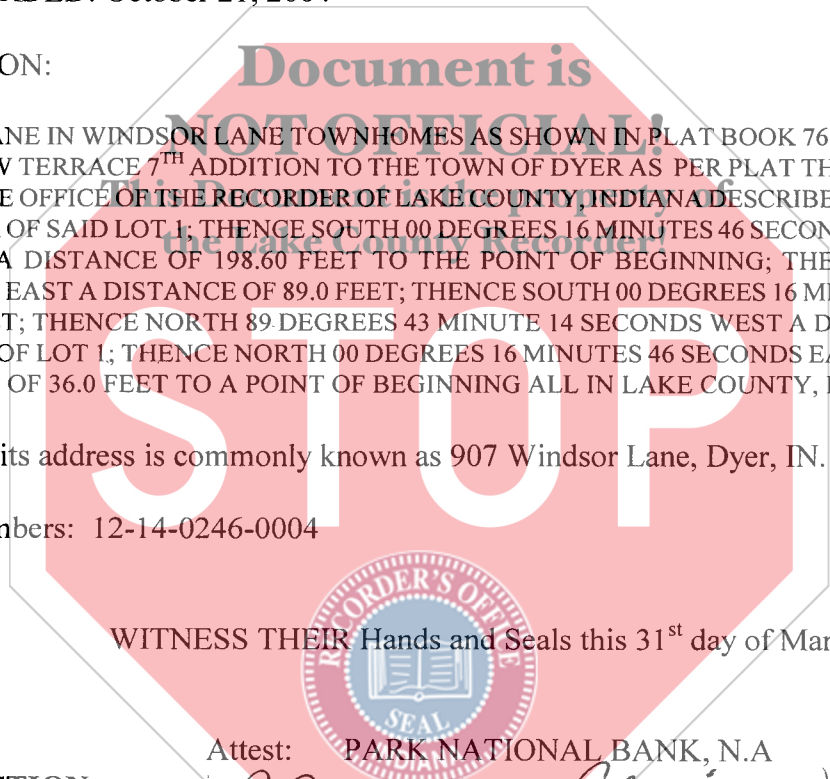

WITNESS THEIR Hands and Seals this 31st day of March 2008

Attest: PARK NATIONAL BANK, N.A

FOR THE PROTECTION OF THE OWNER, THIS RELEASE SHOULD BE FILED IN THE COUNTY IN WHICH THE MORTGAGE OR DEED OF TRUST WAS FILED.

Mary M. Blevins
Mary M. Blevins Assistant Vice President

Thomas R. Perry
Thomas R. Perry Assistant Vice President

1400
CASH
PB

