

2

STATE OF INDIANA
DEPARTMENT OF
PUBLIC SAFETY

2008 042749

2008 JUN 11 PM 12:57

MICHAEL A. BROWN
RECORDER

WARRANTY DEED

Grantee's Mailing Address:

same →

Property Address:

7149 Delaware Avenue
Hammond, IN 46323

Tax Parcel No.: 26-35-0395-0018

This Indenture Witnesseth, That **Timothy Weaver and Sandra Weaver**

Convey(s) and Warrant(s) to **Jesus Maldonado**

for the sum of **Ten & 00/100 Dollars (\$10.00)** and other valuable consideration, the following described real estate in **Lake County**, in the State of **Indiana**:

Lot 18 in Parrish Avenue Second Addition, in the City of Hammond, as per plat thereof, recorded in Plat Book 28 page 24, in the Office of the Recorder of Lake County, Indiana.

Subject to real estate taxes not yet due and payable.

Subject To any and all easements, agreements, and restrictions of record, and to legal highways.

Signed this 9th day of May, 2008.

[Signature]
Timothy Weaver

[Signature]

[Signature]
Sandra Weaver

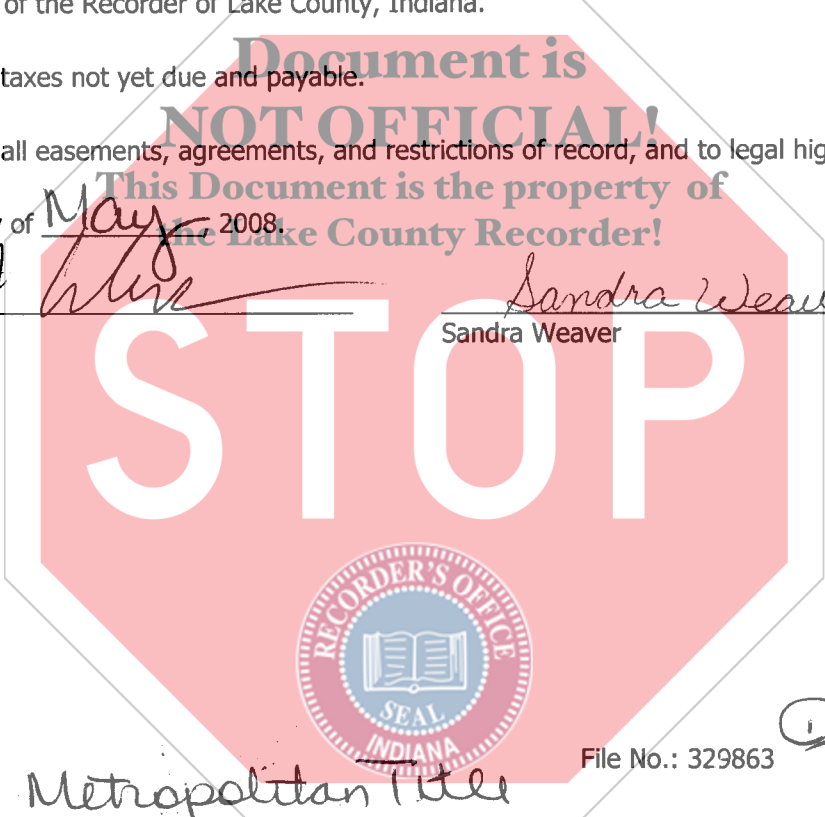

Metropolitan Title

File No.: 329863

Page 1 of 2

009647

DULY ENTERED FOR TAXATION SUBJECT TO
FINAL ACCEPTANCE FOR TRANSFER

JUN 09 2008

PEGGY HOLINGA KATONA
LAKE COUNTY AUDITOR

1800
OK # 6318201429
90

Acknowledgement

State of Indiana; Lake County:

Before me, a Notary Public in and for the said County and State, personally appeared **Timothy Weaver and Sandra Weaver**, who acknowledged the execution of the foregoing Warranty Deed, and who, having been duly sworn, stated that any representations therein contained are true.

Witness my hand and notarial seal this 9th day of May, 2008.

My commission expires:

4-18-2009

Signature Antoinette M Skog

Printed ANTOINETTE M. SKOG, Notary Public

Residing in LAKE County, Indiana

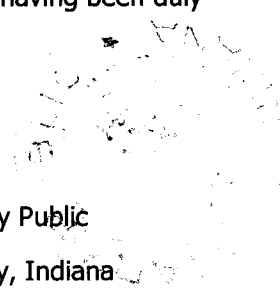

This instrument prepared by: Louis Klatch, Attorney at Law

I affirm, under the penalties for perjury, that I have taken reasonable care to redact each Social Security number in this document, unless required by law.

Name: Antoinette M. Skog

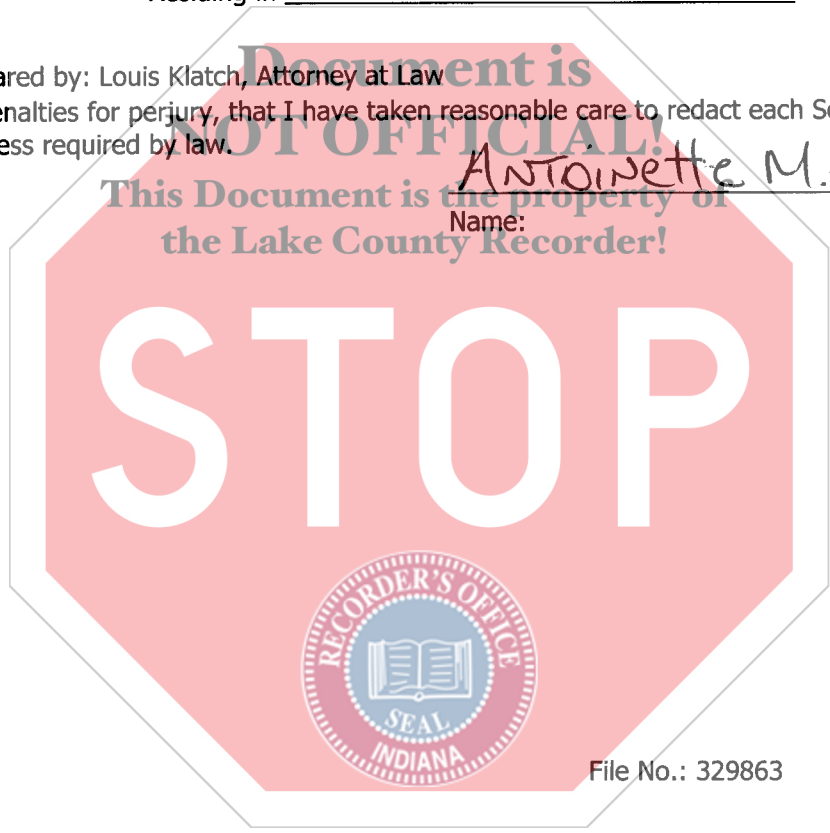

File No.: 329863

Page 2 of 2