

10

2007 101276

2007 DEC 28 11:31

MICHAEL A. ...
RECORDER

QUITCLAIM DEED

THIS INDENTURE WITNESSETH, That the TOWN OF CEDAR LAKE, LAKE COUNTY, INDIANA, an Indiana municipal corporation ("Grantor") QUITCLAIMS to CEDAR LAKE REDEVELOPMENT AUTHORITY, a separate body corporate and politic and an instrumentality of the Town of Cedar Lake, Lake County, Indiana ("Grantee"), for the sum of One Dollar (\$1.00) and other valuable consideration, the receipt and sufficiency of which are hereby acknowledged, the real estate in Lake County, in the State of Indiana more particularly described on Exhibit A attached hereto and incorporated herein by this reference.

The undersigned person executing this Quitclaim Deed on behalf of Grantor represents and certifies that such person is duly authorized to execute and deliver this Quitclaim Deed; that Grantor has full organizational capacity to convey the real estate described herein; and that all necessary limited liability company action for the making of such conveyance has been taken and done.

IN WITNESS WHEREOF, Grantor has executed this deed this 19th day of December, 2007.

TOWN OF CEDAR LAKE, LAKE COUNTY,
INDIANA

By: Robert H. Carnahan
Robert H. Carnahan, Town Council President

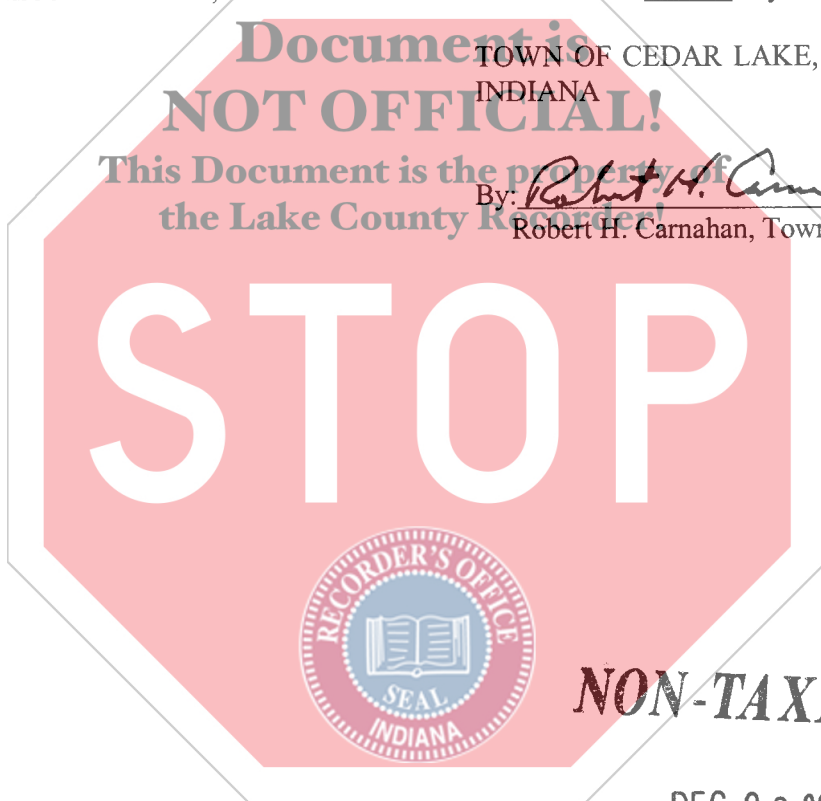

NON-TAXABLE

025632

DEC 28 2007

PEGGY HOLINGA KATONA
LAKE COUNTY AUDITOR

350
014673
A
4

STATE OF INDIANA)
) SS:
COUNTY OF LAKE)

Before me, a Notary Public in and for said County and State, personally appeared Robert H. Carnahan, the Town Council President, of the Town of Cedar Lake, Lake County, Indiana, an Indiana municipal corporation, who acknowledged the execution of the foregoing document for and on behalf of said entity and stated that the facts contained therein are true and correct.

Witness my hand and Notarial Seal this 19th day of December, 2007.

My Commission Expires:

3-7-2015

Amy J. Sund
(Signature)
Notary Public Residing in Lake County, Indiana
Amy J. SUND
(Printed Name)

This Instrument prepared by Mark J. Adey, Barnes & Thornburg LLP, 600 1st Source Bank Center, 100 North Michigan Street, South Bend, Indiana 46601

Document is NOT OFFICIAL!
This Document is the property of the Lake County Recorder!

I affirm, under the penalties for perjury, that I have taken reasonable care to redact each Social Security number in this document, unless required by law.

David M. Austgen
David M. Austgen



EXHIBIT A

DESCRIPTION OF REAL ESTATE

Those following parcels of real estate, consisting of portions of roads and streets, the common addresses for which are set forth below, in the Town of Cedar Lake, Indiana:

- E 129th Avenue from Fairbanks Street to Colfax Street
- E 130th Avenue from Fairbanks Street to Colfax Street
- E Colfax Street from 129th Avenue south to end of Colfax Street
- E 131st Avenue from Fairbanks Street to Colfax Street
- W 136th Place from Ivy Avenue to Drummond Avenue
- E Orchard Street from Binyon Avenue to 140th Avenue
- E Wheeler Court from 131st Avenue south to end of Wheeler Court cul-de-sac
- E Stevenson Court from 131st Avenue south to end of Stevenson Court cul-de-sac
- E Hobart Court from 131st Avenue south to end of Hobart Court cul-de-sac
- E 133rd Place from Morse Street to Rocklin Street
- E Reeder Road from 149th Avenue to 147th Avenue
- W 126th Avenue from West Town Limits to Wicker Avenue
- E 127th Avenue/Vermillion Drive from Cline Avenue to Fairbanks Street
- E 143rd Lane from Morse Street to Lake Shore Drive
- E 143rd Place from Morse Street to west end of 143rd Place
- E Surprise Street from 143rd Place to 143rd Avenue
- E Poplar Street from 143rd Place to south end of Poplar Street
- W 131st Place from Marquette Street to Polk Street
- W Truman Circle from Grimm Street to west end of Truman Circle
- W Huseman Street from 138th Place to 140th Avenue
- E 136th Place from Morse Street to Cedar Street
- W Harding Boulevard from Marquette Street to Dodge Street
- E 129th Place from Murton Street to Fulton Street
- E Fulton Street from 129th Place to south end of Fulton Street
- W 131st Avenue from Lake Shore Drive to Polk Street
- W Marquette Street from Lake Shore Drive to 132nd Place
- W 131st Lane from Marquette Street to east end of 131st Lane
- W 132nd Avenue from Marquette Street to Polk Street

more particularly described on the following seven (7) pages (collectively, the “Real Estate”):

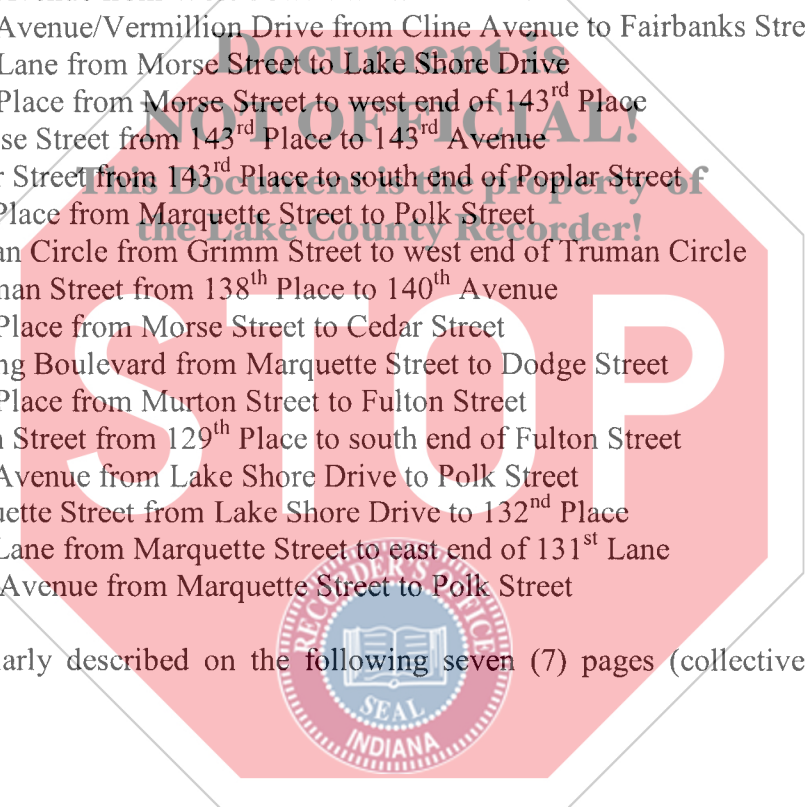

FOR THOSE PARCELS LOCATED ON THE EAST SIDE OF CEDAR LAKE:

127th Avenue/Vermillion Drive from Cline Avenue to Fairbanks Street: Beginning at the intersection of the north right-of-way line of 127th Avenue/Vermillion Drive and the east right-of-way line of Cline Avenue; thence northeasterly along said north right-of-way line to the west right-of-way line of Fairbanks Street; thence south to the intersection of the south right-of-way line of 127th Avenue/Vermillion Drive and the west right-of-way line of Fairbanks Street; thence southwesterly along the said south right-of-way line to the east right-of-way line of Cline Avenue; thence north to the place of beginning, located in the North Half of Section 23 Township 34 North Range 9 West of the Second Principal Meridian in Lake County, Indiana.

129th Place from Murton Street to Fulton Street: Beginning at the intersection of the north right-of-way line of 129th Place and the west right-of-way line of Murton Street; thence east along said north right-of-way line to the west right-of-way line of Fulton Street extended north; thence south to the intersection of the south right-of-way line of 129th Place and the west right-of-way line of Fulton Street; thence west along the said south right-of-way line extended west to the west right-of-way line of Murton Street; thence north to the place of beginning, located in the Southwest Quarter of Section 23 Township 34 North Range 9 West of the Second Principal Meridian in Lake County, Indiana.

Fulton Street from 129th Place to south end of Fulton Street: Beginning at the intersection of the north right-of-way line of 129th Place and the west right-of-way line of Fulton Street extended north; thence south along said west right-of-way line to the south end of west right-of-way line for Fulton Street; thence east to the south end of the east right-of-way line for Fulton Street; thence north along the said east right-of-way line to the intersection of the north right-of-way line of 129th Place and the east right-of-way line of Fulton Street; thence west to the place of beginning, located in the Southeast Quarter of Section 23 Township 34 North Range 9 West of the Second Principal Meridian in Lake County, Indiana.

129th Avenue from Fairbanks Street to Colfax Street: Beginning at the intersection of the north right-of-way line of 129th Avenue and the east right-of-way line of Fairbanks Street; thence east along said north right-of-way line to the west right-of-way line of Colfax Street extended north; thence south to the intersection of the south right-of-way line of 129th Avenue and the west right-of-way line of Colfax Street; thence west along the said south right-of-way line to the east right-of-way line of Fairbanks Street; thence north to the place of beginning, located in the Southeast Quarter of Section 23 Township 34 North Range 9 West of the Second Principal Meridian in Lake County, Indiana.

130th Avenue from Fairbanks Street to Colfax Street: Beginning at the intersection of the north right-of-way line of 130th Avenue and the east right-of-way line of Fairbanks Street; thence east along said north right-of-way line to the west right-of-way line of Colfax Street; thence south to the intersection of the south right-of-way line of 130th Avenue and the west right-of-way line of Colfax Street; thence west along the said south

right-of-way line to the east right-of-way line of Fairbanks Street; thence north to the place of beginning, located in the Southeast Quarter of Section 23 Township 34 North Range 9 West of the Second Principal Meridian in Lake County, Indiana.

131st Avenue from Fairbanks Street to Colfax Street: Beginning at the intersection of the north right-of-way line of 131st Avenue and the east right-of-way line of Fairbanks Street; thence east along said north right-of-way line to the west right-of-way line of Colfax Street; thence south to the intersection of the south right-of-way line of 131st Avenue and the west right-of-way line of Colfax Street; thence west along the said south right-of-way line to the east right-of-way line of Fairbanks Street; thence north to the place of beginning, located in the Southeast Quarter of Section 23 Township 34 North Range 9 West of the Second Principal Meridian in Lake County, Indiana.

Colfax Street from 129th Avenue south to end of Colfax Street: Beginning at the intersection of the north right-of-way line of 129th Avenue and the west right-of-way line of Colfax Street extended north; thence south along said west right-of-way line to the south end of west right-of-way line for Colfax Street; thence east to the south end of the east right-of-way line for Colfax Street; thence north along the said east right-of-way line to the intersection of the north right-of-way line of 129th Avenue and the east right-of-way line of Colfax Street; thence west to the place of beginning, located in the Southeast Quarter of Section 23 Township 34 North Range 9 West of the Second Principal Meridian in Lake County, Indiana.

Wheeler Court from 131st Avenue south to end of Wheeler Court cul-de-sac: Beginning at the intersection of the south right-of-way line of 131st Avenue and the west right-of-way line of Wheeler Court; thence south along said west right-of-way line to the intersection with a circular curve concave to the north with a radius of fifty (50) feet; thence counterclockwise along said circular curve to the intersection with the east right-of-way line for Wheeler Court; thence north along the said east right-of-way line to the intersection of the south right-of-way line of 131st Avenue and the east right-of-way line of Wheeler Court; thence west to the place of beginning, located in the Southeast Quarter of Section 23 Township 34 North Range 9 West of the Second Principal Meridian in Lake County, Indiana.

Stevenson Court from 131st Avenue south to end of Stevenson Court cul-de-sac: Beginning at the intersection of the south right-of-way line of 131st Avenue and the west right-of-way line of Stevenson Court; thence south along said west right-of-way line to the intersection with a circular curve concave to the north with a radius of fifty (50) feet; thence counterclockwise along said circular curve to the intersection with the east right-of-way line for Stevenson Court; thence north along the said east right-of-way line to the intersection of the south right-of-way line of 131st Avenue and the east right-of-way line of Stevenson Court; thence west to the place of beginning, located in the Southeast Quarter of Section 23 Township 34 North Range 9 West of the Second Principal Meridian in Lake County, Indiana.

Hobart Court from 131st Avenue south to end of Hobart Court cul-de-sac: Beginning at the intersection of the south right-of-way line of 131st Avenue and the west right-of-way line of Hobart Court; thence south along said west right-of-way line to the intersection with a circular curve concave to the north with a radius of fifty (50) feet; thence counterclockwise along said circular curve to the intersection with the east right-of-way line for Hobart Court; thence north along the said east right-of-way line to the intersection of the south right-of-way line of 131st Avenue and the east right-of-way line of Hobart Court; thence west to the place of beginning, located in the Southeast Quarter of Section 23 Township 34 North Range 9 West of the Second Principal Meridian in Lake County, Indiana.

133rd Place from Morse Street to Rocklin Street: Beginning at the intersection of the north right-of-way line of 133rd Place and the east right-of-way line of Morse Street; thence east along said north right-of-way line to the east right-of-way line of Rocklin Street; thence south to the intersection of the south right-of-way line of 133rd Place extended east and the east right-of-way line of Morse Street; thence west along the said south right-of-way line to the east right-of-way line of Morse Street; thence north to the place of beginning, located in the Northeast Quarter of Section 26 Township 34 North Range 9 West of the Second Principal Meridian in Lake County, Indiana.

136th Place from Morse Street to Cedar Street: Beginning at the intersection of the north right-of-way line of 136th Place and the west right-of-way line of Morse Street; thence west along said north right-of-way line extended west to the west right-of-way line of Cedar Street; thence southeasterly along said west right-of-way line to the south right-of-way line of 136th Place; thence west along the said south right-of-way line to the east right-of-way line of Morse Street; thence north to the place of beginning, located in the Northwest Quarter of Section 26 Township 34 North Range 9 West of the Second Principal Meridian in Lake County, Indiana.

Orchard Street from Binyon Avenue to 140th Avenue: Beginning at the intersection of the southerly right-of-way line of Binyon Avenue and the westerly right-of-way line of Orchard Street; thence southwesterly along said westerly right-of-way line to the north right-of-way line of 140th Avenue; thence east to the intersection of the easterly right-of-way line of Orchard Street and the north right-of-way line of 140th Avenue; thence northeasterly along the said easterly right-of-way line to the southerly right-of-way line of Binyon Avenue; thence westerly to the place of beginning, located in the Southwest Quarter of Section 26 Township 34 North Range 9 West of the Second Principal Meridian in Lake County, Indiana.

143rd Place from Morse Street to west end of 143rd Place: Beginning at the intersection of the north right-of-way line of 143rd Place and the west right-of-way line of Morse Street; thence west along said north right-of-way line to the west end of the right-of-way for 143rd Place; thence south to the west end of the south right-of-way line for 143rd Place; thence east along the said south right-of-way line to the west right-of-way line of Morse Street; thence north to the place of beginning, located in the Northwest Quarter of

Section 35 Township 34 North Range 9 West of the Second Principal Meridian in Lake County, Indiana.

143rd Lane from Morse Street to Lake Shore Drive: Beginning at the intersection of the north right-of-way line of 143rd Lane and the west right-of-way line of Morse Street; thence west along said north right-of-way line to the east right-of-way line of Lake Shore Drive; thence south to the intersection of the east right-of-way line of Lake Shore Drive and the south right-of-way line of 143rd Lane; thence east along the said south right-of-way line to the west right-of-way line of Morse Street; thence north to the place of beginning, located in the Northwest Quarter of Section 35 Township 34 North Range 9 West of the Second Principal Meridian in Lake County, Indiana.

Surprise Street from 143rd Place to 143rd Avenue: Beginning at the intersection of the south right-of-way line of 143rd Place and the west right-of-way line of Surprise Street; thence southwesterly along said west right-of-way line to the north right-of-way line of 143rd Lane; thence east to the intersection of the east right-of-way line of Surprise Street and the north right-of-way line of 143rd Lane; thence northeasterly along the said east right-of-way line to the south right-of-way line of 143rd Place; thence west to the place of beginning, located in the Northwest Quarter of Section 35 Township 34 North Range 9 West of the Second Principal Meridian in Lake County, Indiana.

Poplar Street from 143rd Place to south end of Poplar Street: Beginning at the intersection of the south right-of-way line of 143rd Place and the west right-of-way line of Poplar Street; thence south along said west right-of-way line to the south end of the right-of-way for Poplar Street; thence east to the south end of the east right-of-way line of Poplar Street; thence north along the said east right-of-way line to the south right-of-way line of 143rd Place; thence west to the place of beginning, located in the Northwest Quarter of Section 35 Township 34 North Range 9 West of the Second Principal Meridian in Lake County, Indiana.

Reeder Road from 149th Avenue to 147th Avenue: Beginning at the intersection of the north right-of-way line of 149th Avenue and the west right-of-way line of Reeder Road; thence northeasterly along said west right-of-way line to the north right-of-way line of 147th Avenue extended west; thence east to the intersection of the north right-of-way line of 147th Avenue and the east right-of-way line of Reeder Road; thence southwesterly along the said east right-of-way line to the north right-of-way line of 149th Avenue; thence north to the place of beginning, located in the Southeast Quarter of Section 35 Township 34 North Range 9 West of the Second Principal Meridian in Lake County, Indiana.

FOR THOSE PARCELS LOCATED ON THE WEST SIDE OF CEDAR LAKE:

126th Avenue from West Town Limits to Wicker Avenue: Beginning at the intersection of the north right-of-way line of 126th Avenue and the east line of the Northeast Quarter of Section 20, said line also being the west Town limit; thence east along said north right-of-way line to the west right-of-way line of Wicker Avenue, also designated as U.S. Route 41; thence south to the intersection of the south right-of-way line of 126th Avenue and the west right-of-way line of Wicker Avenue; thence west along said south right-of-way line to the intersection of said south right-of-way line with said west Town limit; thence north to the place of beginning, located in the Northeast Quarter of Section 20 Township 34 North Range 9 West of the Second Principal Meridian in Lake County, Indiana.

136th Place from Ivy Avenue to Drummond Avenue: Beginning at the intersection of the north right-of-way line of 136th Place and the east right-of-way line of Ivy Avenue; thence west along said north right-of-way line to the east right-of-way line of Drummond Avenue; thence south to the intersection of the south right-of-way line of 136th Avenue and the east right-of-way line of Drummond Avenue; thence west along said south right-of-way line to the intersection of said south right-of-way line and the east right-of-way line of Ivy Avenue; thence north to the place of beginning, located in the Northeast Quarter of Section 28 Township 34 North Range 9 West of the Second Principal Meridian in Lake County, Indiana.

131st Avenue from Lake Shore Drive to Polk Street: Beginning at the intersection of the north right-of-way line of 131st Avenue and the easterly right-of-way line of Lake Shore Drive; thence southeasterly along said north right-of-way line to the east right-of-way line of Polk Street; thence south to the intersection of the south right-of-way line of 131st Avenue and the east right-of-way line of Polk Street; thence northwesterly along said south right-of-way line to the intersection of said south right-of-way line and the easterly right-of-way line of Lake Shore Drive; thence northeasterly to the place of beginning, located in the South Half of Section 22 Township 34 North Range 9 West of the Second Principal Meridian in Lake County, Indiana.

131st Place from Marquette Street to Polk Street: Beginning at the intersection of the north right-of-way line of 131st Place and the easterly right-of-way line of Marquette Street; thence northeasterly along said north right-of-way line to the east right-of-way line of Polk Street; thence south to the intersection of the south right-of-way line of 131st Place and the east right-of-way line of Polk Street; thence southeasterly along said south right-of-way line to the intersection of said south right-of-way line and the easterly right-of-way line of Marquette Street; thence northerly to the place of beginning, located in the South Half of Section 22 Township 34 North Range 9 West of the Second Principal Meridian in Lake County, Indiana.

131st Lane from Marquette Street to east end of 131st Lane: Beginning at the intersection of the north right-of-way line of 131st Lane and the easterly right-of-way line of Marquette Street; thence easterly along said north right-of-way line to the east end of

the right-of-way line for 131st Lane; thence south to the south end of the south right-of-way line of 131st Lane; thence westerly along said south right-of-way line to the intersection of said south right-of-way line and the easterly right-of-way line of Marquette Street; thence northerly to the place of beginning, located in the South Half of Section 22 Township 34 North Range 9 West of the Second Principal Meridian in Lake County, Indiana.

132nd Avenue from Marquette Street to Polk Street: Beginning at the intersection of the north right-of-way line of 132nd Avenue and the easterly right-of-way line of Marquette Street; thence easterly along said north right-of-way line to the east right-of-way line of Polk Street; thence south to the intersection of the south right-of-way line of 132nd Avenue extended west and the east right-of-way line of Polk Street; thence westerly along said south right-of-way line to the intersection of said south right-of-way line and the easterly right-of-way line of Marquette Street; thence northerly to the place of beginning, located in the South Half of Section 22 Township 34 North Range 9 West of the Second Principal Meridian in Lake County, Indiana.

Marquette Street from Lake Shore Drive to 132nd Place: Beginning at the intersection of the easterly right-of-way line of Marquette Street and the southerly right-of-way line of Lake Shore Drive; thence south along said easterly right-of-way line to the south right-of-way line of 132nd Place; thence west to the intersection of the south right-of-way line of 132nd Place and the westerly right-of-way line of Marquette Street; thence north along said westerly right-of-way line to the intersection of said westerly right-of-way line and the southerly right-of-way line of Lake Shore Drive; thence northeasterly to the place of beginning, located in the South Half of Section 22 Township 34 North Range 9 West of the Second Principal Meridian in Lake County, Indiana.

Truman Circle from Grimm Street to west end of Truman Circle: Beginning at the intersection of the northerly right-of-way line of Truman Circle and the easterly right-of-way line of Grimm Street; thence easterly along said northerly right-of-way line to the west end of the right-of-way line for Truman Circle; thence south to the west end of the southerly right-of-way line Truman Circle; thence westerly along said southerly right-of-way line to the intersection of said southerly right-of-way line and the east right-of-way line of Grimm Street extended south; thence northeasterly to the place of beginning, located in the South Half of Section 22 Township 34 North Range 9 West of the Second Principal Meridian in Lake County, Indiana.

Harding Boulevard from Marquette Street to Dodge Street: Beginning at the intersection of the northerly right-of-way line of Harding Boulevard and the westerly right-of-way line of Marquette Street; thence southwest along said northerly right-of-way line to the easterly right-of-way line of Dodge Street; thence southeasterly to the intersection of the southerly right-of-way line of Harding Boulevard and the easterly right-of-way line of Dodge Street; thence northwesterly along said southerly right-of-way line to the intersection of said southerly right-of-way line and the easterly right-of-way line of Marquette Street; thence northerly to the place of beginning, located in the

South Half of Section 22 Township 34 North Range 9 West of the Second Principal Meridian in Lake County, Indiana.

Huseman Street from 138th Place to 140th Avenue: Beginning at the intersection of the westerly right-of-way line of Huseman Street and the south right-of-way line of 138th Place; thence southeasterly along said westerly right-of-way line to the north right-of-way line of 140th Avenue; thence east to the intersection of the north right-of-way line of 140th Avenue extended east and the easterly right-of-way line of Huseman Street; thence northwesterly along said easterly right-of-way line to the intersection of said easterly right-of-way line and the south right-of-way line of 138th Place extended east; thence west to the place of beginning, located in the Southeast Quarter of Section 27 Township 34 North Range 9 West of the Second Principal Meridian in Lake County, Indiana.

