

3

2007 100032

2007 DEC 21 2:11:10

WARRANTY DEED

GARY BUILDING CORPORATION

the Grantor

Conveys and Warrants to

CITY OF GARY, INDIANA

the Grantee

for and in consideration of Ten and 00/100 Dollars (\$10.00), the receipt of which is hereby acknowledged, Real Estate in Lake County, in the State of Indiana, as described on Exhibit A hereto.

Dated: May 1, 2007.

This Document is the property of the Lake County Recorder!

GARY BUILDING CORPORATION

Alexis D. Colver
President

Attest:

Clifford Hammond
Secretary

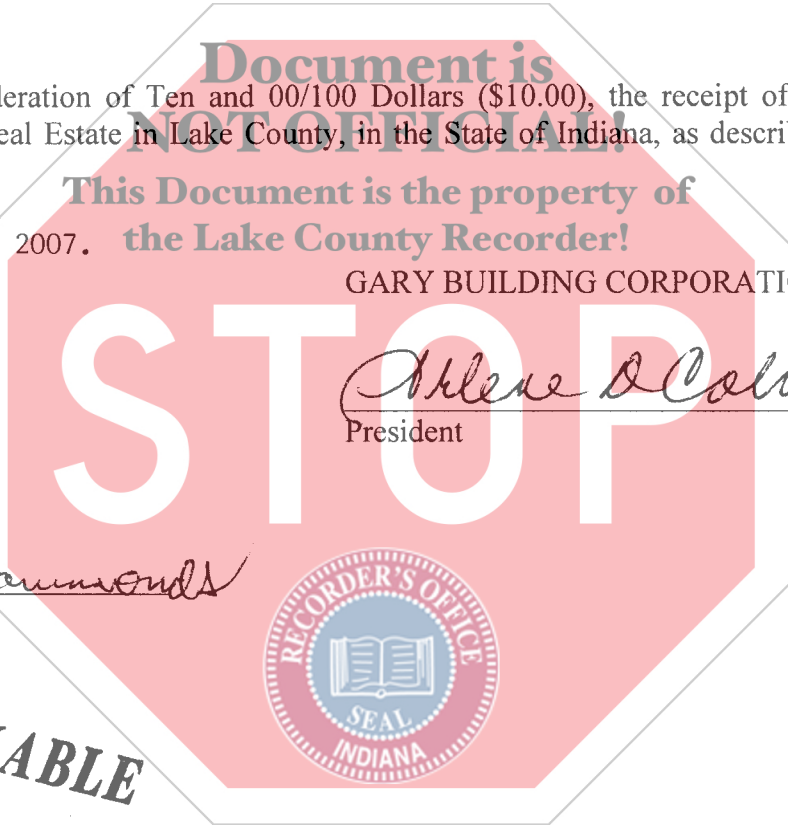

NON-TAXABLE

DEC 21 2007
PEGGY HOLINGA KATONA
LAKE COUNTY AUDITOR

DULY ENTERED FOR TAXATION SUBJECT TO
FINAL ACCEPTANCE FOR TRANSFER

DEC 21 2007

PEGGY HOLINGA KATONA
LAKE COUNTY AUDITOR

21⁰⁰
106871
SL

24682

STATE OF INDIANA)
) ss:
LAKE COUNTY)

Before me, the undersigned, a Notary Public in and for said County and State, personally appeared Arlene D. Colvin and Alfred Hammonds, the President and Secretary, respectively, of the Gary Building Corporation, and acknowledged the execution and attestation, respectively, of the foregoing deed on behalf of said Building Corporation on the 15th day of May, 2007.

Victoria Portis Ward
Notary Public, Signature
Victoria Portis Ward
Typed or Printed Name

My Commission expires: 10-24-2013
Resident of Lake County, Indiana

This instrument prepared by
and return deed to:

Document is NOT OFFICIAL!
This document is the property of
the Lake County Recorder!
Randolph R. Rompola, Esq.
Baker & Daniels LLP
205 W. Jefferson Blvd., Suite 250
South Bend, IN 46601

Send tax bills to:

401 Broadway, Suite 100
Gary, IN 46402
Attention: City Controller

Granted

I affirm, under the penalties for perjury, that I have taken reasonable care to redact each Social Security number in this document, unless required by law. Randolph R. Rompola

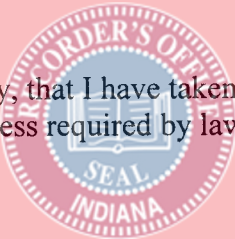

Exhibit A

Legal Description

The property commonly known as the Sears Building located at 839 Broadway, Gary, Indiana, more particularly described as follows:

Lots 4 to 15, both inclusive, Block 12, Gary Land Company's First Subdivision, in the City of Gary, as shown in Plat Book 6, Page 15, in Lake County, Indiana.

