

STATE OF INDIANA  
LAKE COUNTY  
FILED FOR RECORD

2007 098967

2007 DEC 19 AM 8:52

MICHAEL A. BROWN  
RECORDER

Parcel No. 15-26-122-47

**WARRANTY DEED**

ORDER NO. 920076899

THIS INDENTURE WITNESSETH, That Catherine A. Mills and Edward J. Kliza, Jr., as joint tenants with full rights of survivorship (Grantor)

of Lake County, in the State of INDIANA CONVEY(S) AND WARRANT(S)

to Larry Luebcke (Grantee)  
\*N.

of Lake County, in the State of INDIANA, for the sum of TEN AND 00/100 Dollars (\$ 10.00 )

and other valuable consideration, the receipt and sufficiency of which is hereby acknowledged, the following described real estate in Lake County, State of Indiana:

Lots 47 and 48 in Block 2 in Original Town of Griffith, as per plat thereof, recorded in Plat Book 2, page 45, in the Office of the Recorder of Lake County, Indiana.

Subject to Real Estate taxes for 2006 payable 2007 taxes together with delinquency and penalty, if any, and all Real Estate taxes due and payable thereafter.

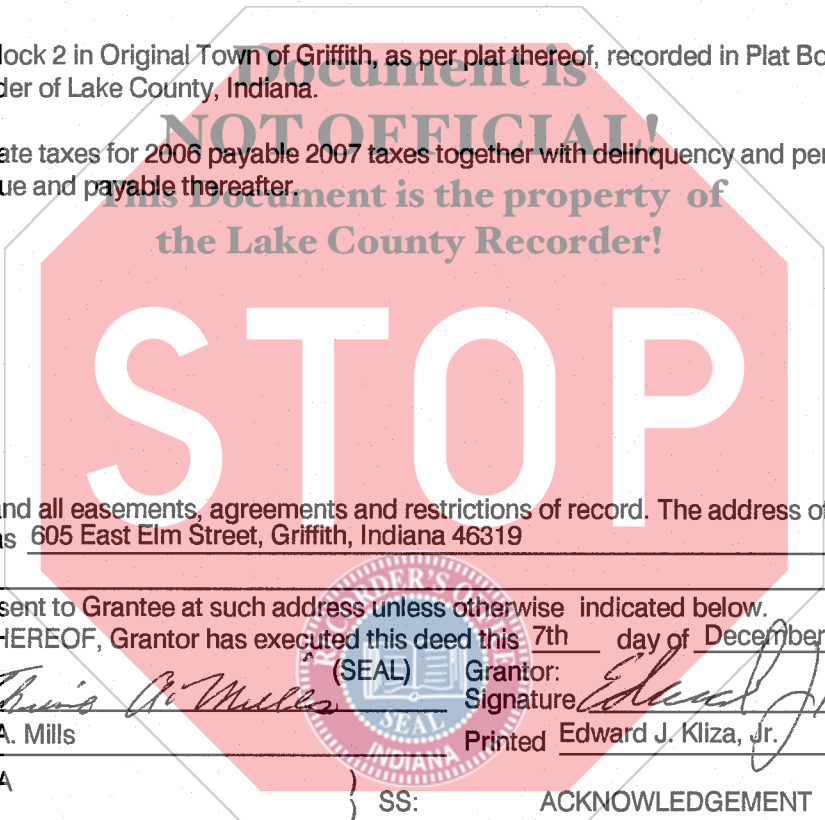

Subject to any and all easements, agreements and restrictions of record. The address of such real estate is commonly known as 605 East Elm Street, Griffith, Indiana 46319

Tax bills should be sent to Grantee at such address unless otherwise indicated below.

IN WITNESS WHEREOF, Grantor has executed this deed this 7th day of December 2007

Grantor: Catherine A. Mills (SEAL)  
Signature  
Printed Catherine A. Mills

Grantor: Edward J. Kliza, Jr. (SEAL)  
Signature  
Printed Edward J. Kliza, Jr.

STATE OF INDIANA

SS: ACKNOWLEDGEMENT

COUNTY OF Lake

Before me, a Notary Public in and for said County and State, personally appeared Catherine A. Mills and Edward J. Kliza, Jr.

who acknowledge the execution of the foregoing Warranty Deed, and who, having been duly sworn, stated that any representations therein contained are true.

Witness my hand and Notarial Seal this 7th day of December 2007

My commission expires:  
NOVEMBER 9, 2012

Signature Becky Selman  
Printed Becky Selman, Notary Name  
Resident of Porter County, Indiana.

This instrument prepared by Atty. Mark S. Lucas

I affirm, under the penalties for perjury, that I have taken reasonable care to redact each Social Security number in this document, unless required by law. Becky Selman

Return deed to 605 East Elm Street, Griffith, Indiana 46319 10350 Doubletree Dr. South, Crown Point, IN 46307

Send tax bills to 605 East Elm Street, Griffith, Indiana 46319 10350 Doubletree Dr. South, Crown Point, IN 46307

TICOR HBT 920076899

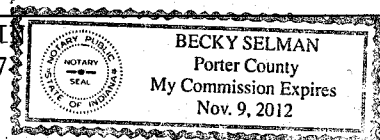

DULY ENTERED FOR TAXATION SUBJECT TO  
FINAL ACCEPTANCE FOR TRANSFER

DEC 17 2007

PEGGY HOLINGA KATONA  
LAKE COUNTY

025206

HT 1659