

2

2007 098894

2007 DEC 18 12:48

MICHAEL A. BROWN
RECORDER

MAIL TAX STATEMENTS TO:

Countrywide Home Loans, Inc.
7105 Corporate Drive, Mail Stop PTX-B-35
Plano, TX 75024-3632

F&H Received

GRANTEE'S ADDRESS OF:

Bank of New York as Successor in Interest to
JPMorganChase Bank, N.A. as Trustee for FFMLT 04-
FF10
7105 Corporate Drive, Mail Stop PTX-B-35
Plano, TX 75024-3632

DEC 06 2007 SHERIFF'S DEED

THIS INDENTURE WITNESSETH, that Rogelio Roy Dominguez as Sheriff of Lake County, State of Indiana, conveys to **Bank of New York as Successor in Interest to JPMorgan Chase Bank, N.A. as Trustee for FFMLT 04-FF10**, in consideration of the sum of **\$31,500.00**, the receipt of which is hereby acknowledged, on sale made by virtue of a decree judgment, issued from Lake Superior Court, in the State of Indiana, pursuant to the laws of said State on June 21, 2007, in Cause No. 45D11-0605-MF-00253, wherein **JPMorgan Chase Bank as Trustee, on Behalf of First Franklin Mortgage Loan Trust 2004-FF10 Asset-Backed Certificates, Series 2004-FF10 was Plaintiff, and Darlene M. Williams a/k/a Darlene Marie Williams, and The Methodist Hospitals, Inc., were Defendants**, in consideration of said sum aforesaid, the following described real estate in Lake County, Indiana, to-wit:

LOT 11, BLOCK "C", PARK MANOR SUBDIVISION, CITY OF GARY ALSO KNOWN AS 3661 JEFFERSON STREET.

More commonly known as: 3661 Jefferson Street, Gary, IN 46408
Parcel # 25-46-0326-0011

Subject to assessed but unpaid taxes, not yet delinquent, and subject also to easements and restrictions of record.

To have and to hold the premises aforesaid with the privileges and appurtenances to said purchaser, their grantees and assigns, forever, in full and ample manner with all rights, title and interest held or claimed by the aforesaid Defendants.

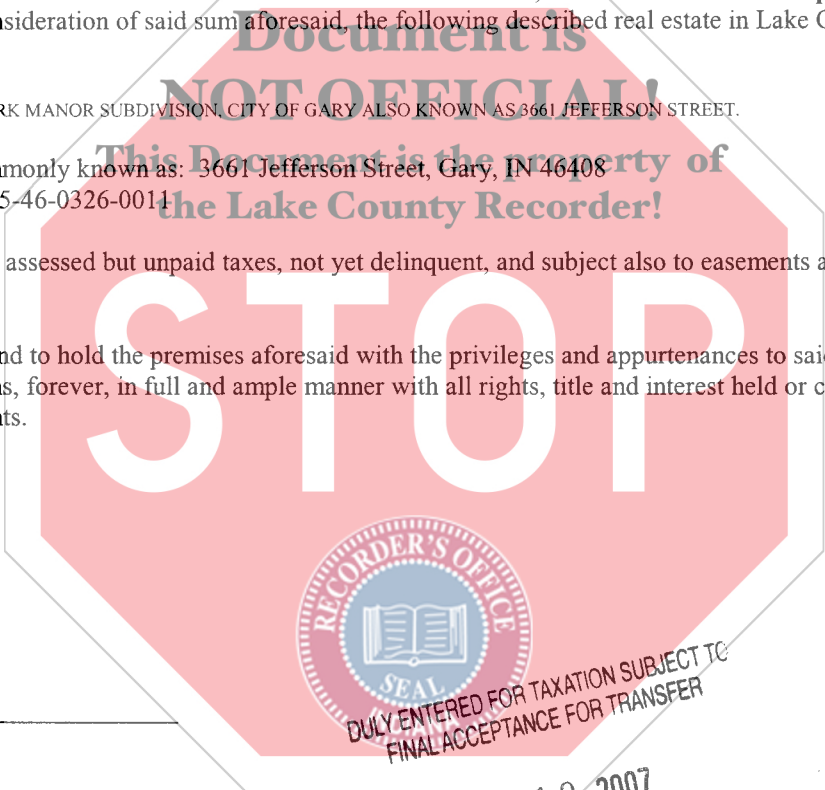

143167
18
DG

CWD/2364-7015.
Williams, Darlene M.

DEC 18 2007

PEGGY HOLINGA KATONA
LAKE COUNTY AUDITOR

024640

Feiwell & Hannoy, PC
251 N. Illinois Street
Suite 1700
Indianapolis IN 46204



