

12

2007 JUN 11 11:38:52
STATE OF INDIANA
SUPERIOR COURT OF LAKE COUNTY
CIVIL DIVISION COURT ROOM 2

2007 052897

Mail Tax Bills to:
Betty Chelich
316 E. 13th Place
Hobart, IN 46342

STATE OF INDIANA)
) SS:
COUNTY OF LAKE)

IN THE LAKE SUPERIOR COURT
EAST CHICAGO, INDIANA

Filed in Open Court

IN THE MATTER OF THE ESTATE)
OF:)
)
THELMA FAY SAMS,)
Deceased.)

JUN 27 2007

ESTATE NO. 45D02-0612-ES-145

William E. Davis
SUPERIOR COURT OF LAKE COUNTY
CIVIL DIVISION COURT ROOM 2

PERSONAL REPRESENTATIVE'S DEED

Betty Chelich, as Executrix of the estate of Thelma Fay Sams, deceased, which estate is under the supervision of the Superior Court of Lake County, under cause number 45D02-0612-ES-00145, in the office of the Clerk of the Superior Court of Lake County, Indiana, pursuant to an Order of the Superior Court of Lake County, Indiana, dated the ___ day of June, 2007, hereby conveys to Betty Chelich and Elsie Mae Ramsey, as Tenants in Common, of Lake County, State of Indiana, for the sum of One Dollar (\$1.00), the receipt of which is hereby acknowledged, the following described real estate in Lake County, State of Indiana, to-wit:

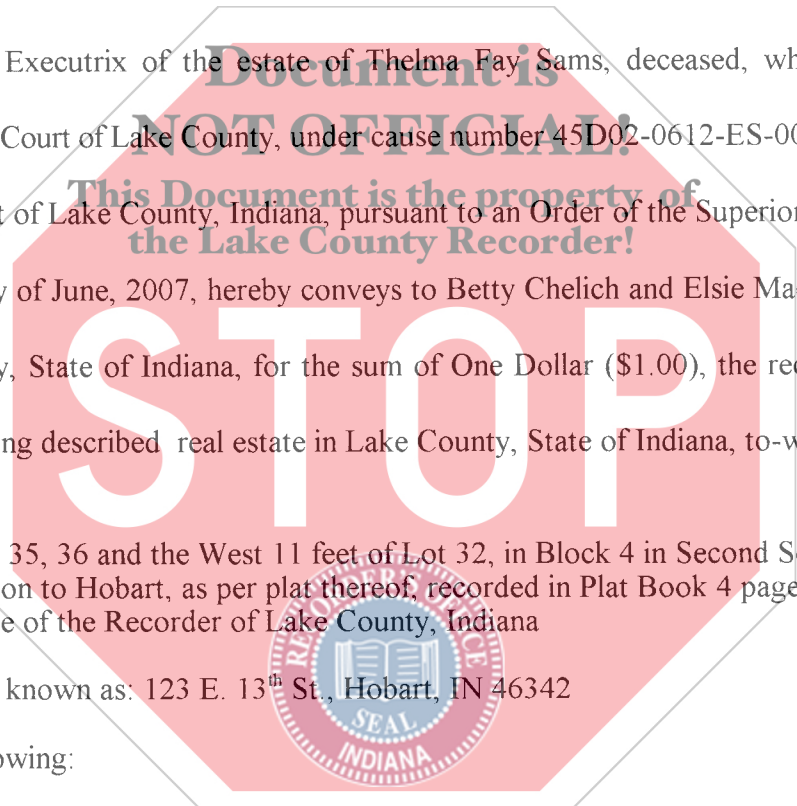

Lot 33, 34, 35, 36 and the West 11 feet of Lot 32, in Block 4 in Second South Side Addition to Hobart, as per plat thereof, recorded in Plat Book 4 page 12, in the Office of the Recorder of Lake County, Indiana

Commonly known as: 123 E. 13th St., Hobart, IN 46342

Subject to the following:

- 1. Real Estate taxes, beginning with the installment due 2006, payable 2007, and taxes for all subsequent years, not yet due and payable.

DULY ENTERED FOR TAXATION SUBJECT TO
FINAL ACCEPTANCE FOR TRANSFER

12341

JUN 26 2007

PEGGY HOLINGA KATONA
LAKE COUNTY AUDITOR

18107
9302
20

2. Easements, covenants and restrictions contained in prior instruments of record; all building and zoning laws, ordinances, legal drains, right-of-way, and other matters which would be disclosed by an accurate survey of the premises.
3. Liens and encumbrances, if any, created by the acts of the herein grantees.

IN WITNESS WHEREOF, the said Betty Chelich, Executrix of the estate of Thelma Fay Sams, has hereunto set her hand and seal this 6th day of June, 2007.

Betty Chelich
 Betty Chelich, Executrix of the Estate of
 Thelma Fay Sams, Deceased.

STATE OF INDIANA)
) SS:
 COUNTY OF LAKE)

Before me, the undersigned, a Notary Public in and for said county and state, personally appeared Betty Chelich, and being first duly sworn by me upon her oath, says that the facts alleged in the foregoing instrument are true.

Signed and sealed this 6th day of June, 2007.

Patricia A. Rees
 Patricia A. Rees, Notary Public
 Resident of Lake County

My Commission Expires:
 03/25/2010

I affirm, under the penalties of perjury, that I have taken reasonable care to redact each Social Security number in this document, unless required by law.

Patricia A. Rees
 Patricia A. Rees

ALL OF WHICH IS FOUND AND RECOMMENDED this 27 day of June, 2007.

ITSIA D. RIVERA
 ITSIA D. RIVERA
 Probate Commissioner

Filed in Open Court

JUN 27 2007

ALL OF WHICH IS ORDERED AND APPROVED this 27 day of June, 2007.

William E. Davis
 SUPERIOR COURT OF LAKE COUNTY
 CIVIL DIVISION, COURT ROOM 2

William E. Davis
 WILLIAM E. DAVIS,
 Judge, Lake Superior Court, Room II

This instrument prepared by Patricia A. Rees, 5341 Central Ave., Portage, IN 46348. (219) 947-1692