

Continuation
Certificate

Westfield Insurance Co.
 Westfield National Insurance Co.
 Ohio Farmers Insurance Co.

Westfield Group, One Park Circle, P O Box 5001
 Westfield Center, Ohio 44251-5001

In consideration of an agreed premium payable in advance the Bond described below is hereby continued in force for the period indicated. Continuation is subject to the condition that the maximum aggregate liability under the Bond and any and all continuations thereof shall in no event exceed the amount of liability shown herein. This endorsement shall be valid only when executed by an attorney-in-fact of this Company.

BOND NO. 5938579	ORIGINAL EFFECTIVE DATE 06/03/03	BOND AMOUNT \$5,000.00	RENEWAL PREMIUM \$100.00	CONTINUED	
				FROM 06/03/07	TO 06/03/08
PRINCIPAL G & W Contractors, Inc. - scope of work: Framing Contractors					
OBLIGEE the Board of Commissioners of the County of Lake, State of Indiana, and any Cities and Towns in Lake County, IN					
TYPE OF BOND (DESCRIBE)		EXECUTED AT (City - State)		DATE EXECUTED	
PUB. OFFICIAL	SURETY X	Bremen, IN		03/09/07	

Miller/Norcen Ins. 13-00052

Agency

By *Rickie L. Hand*
 Rickie L. Hand

Attorney-in-Fact

Attorney-in-Fact

Bremen, IN

City & State

BD 5403 (01-2000)

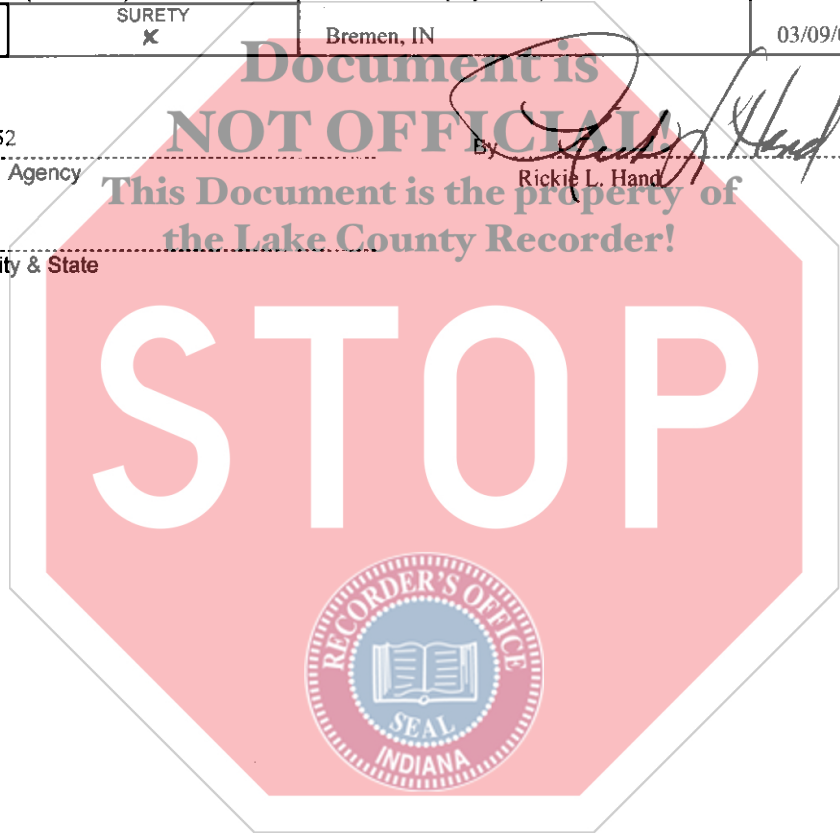

2007 051924

2007 JUN 26 AM 10:26

MICHAEL A. GROW
 RECORDER

STATE OF INDIANA
 LAKE COUNTY
 FILED FOR RECORD

12
 DG
 3234