

3

STATE OF INDIANA  
LAKE COUNTY  
FILED FOR RECORD

2007 048954

2007 JUN 15 AM 9:56

MICHAEL A. BROWN  
RECORDER

**PARTIAL RELEASE OF MECHANIC'S LIEN**

STATE OF INDIANA, LAKE COUNTY, ss:

WHEREAS, the undersigned DIBAKAR SUNDI, President of K & S Engineers, Inc., located at 9715 Kennedy Avenue, Highland, IN 46322, had been heretofore employed by BRIAR RIDGE COUNTRY CLUB 16 LLC, to furnish certain labor and material to the following real estate legally described as follows:

SEE ATTACHED  
and commonly known as : SEE ATTACHED

A written notice of Intention to Hold Lien was filed in the office of the Recorder of Lake County, State of Indiana, and recorded as Document No. 2006 093231 on October 24, 2006.

NOW, THEREFORE, KNOW YE, that the undersigned, in consideration of the payment of FOUR THOUSAND SIX HUNDRED and 00/100 (\$4,600.00), the receipt of which is hereby acknowledged, hereby and now partially waives and releases unto the said BRIAR RIDGE COUNTRY CLUB UNIT 16 LLC, the owner of said premises, any and all lien, right of lien, or claim of whatsoever kind or character on account of any and all labor or material, or both, furnished for or incorporated into the following real estate only, legally described as:

Lot Numbered 32 as shown on the recorded plat of Briar Ridge Country Club Addition, Unit 16 recorded in Plat Book 98, page 98 in the Office of the Recorder of Lake County, Indiana

commonly known as 545 Shannon Bridge, Dyer, IN 46311, Parcel No. 12-14-448-032.

The undersigned further certifies that the consideration moving to the undersigned for executing this Partial Release of Mechanic's Lien, has been mutually given and accepted as a

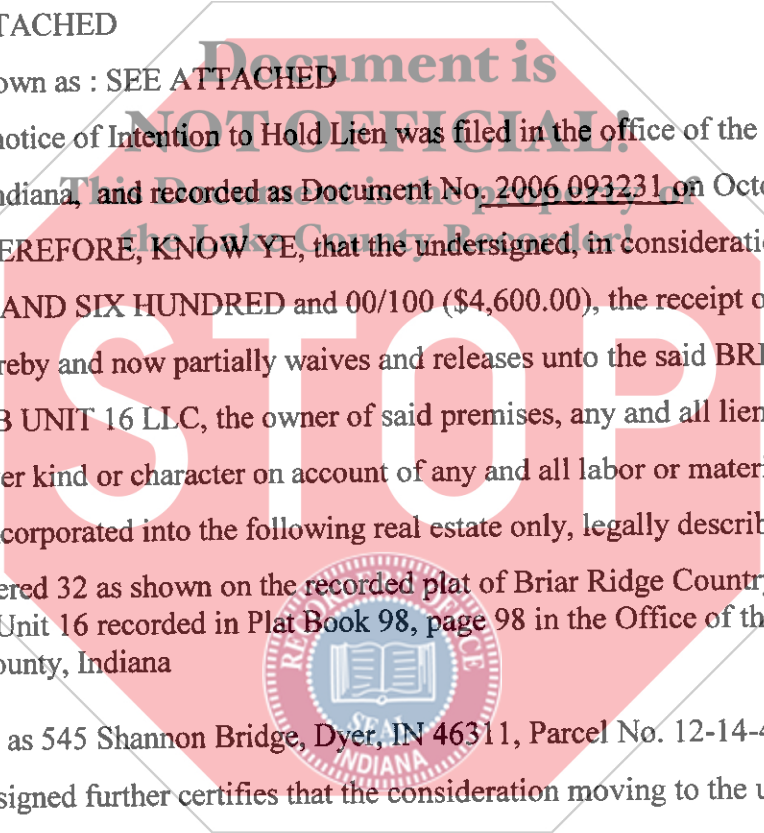

\$16  
MT  
CA

1850407 HOLD FOR MERIDIAN TITLE CORP

partial payment of the debt secured by the aforesaid Mechanic's Lien, and that said Mechanic's Lien will remain in full force and effect as it pertains to the remainder of the real estate legally described therein.

Signed, sealed and delivered this 1st day of May, 2007.



\_\_\_\_\_  
DIBAKAR SUNDI, President

State of Indiana, County of Lake, ss.

Before me, the undersigned, a Notary Public in and for said County, this date May 1, 2007, came DIBAKAR SUNDI, President of K & S ENGINEERS, INC., and acknowledged the execution of the foregoing Partial Release of Mechanic's Lien, and who having been duly sworn, under the penalties of perjury, stated that the facts and matters there set forth are true and correct.

Witness my hand and official seal.

My commission expires: 12/14/08

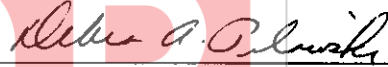

\_\_\_\_\_  
Notary Public

County of Residence: Lake County, Indiana

This instrument prepared by: Dibakar Sundi, 9715 Kennedy Avenue, Highland, IN 46322

I affirm, under the penalties for perjury, that I have taken reasonable care to redact each social security number in this document, unless required by law.

Name \_\_\_\_\_  

Briar Ridge Country Club Unit 16, Lots 1, 2, 7, 10, 11, 13, 15, 16, 17, 18, 19, 21, 22, 25, 26, 27, 28, 29, 30, 32, 33, 34, 35, 36, 37, 38, 39, Outlot A, Outlot B, and Private Road, being part of the East Half of the Fractional Northwest Quarter of Section 6, Township 35 North, Range 9 West of the Second Principal Meridian, in Lake County, Indiana,

Commonly known as 501 Shannon Bridge, 504 Shannon Bridge, 601 Shannon Bridge, 631 Shannon Bridge, 641 Shannon Bridge, 705 Shannon Bridge, 723 Shannon Bridge, 740 Shannon Bridge, 734 Shannon Bridge, 726 Shannon Bridge, 720 Shannon Bridge, 700 Shannon Bridge, 650 Shannon Bridge, 630 Shannon Bridge, 624 Shannon Bridge, 618 Shannon Bridge, 612 Shannon Bridge, 606 Shannon Bridge, 600 Shannon Bridge, 545 Shannon Bridge, 639 Shannon Bridge, 533 Shannon Bridge, 527 Shannon Bridge, 521 Shannon Bridge, 515 Shannon Bridge, 509 Shannon Bridge, 804 Royal Dublin Lane, Outlot A, Outlot B, and Private Road, Dyer, IN 46311.

Parcel numbers 12-14-448-001, 12-14-448-002, 12-14-448-007, 12-14-48-010, 12-14-48-011, 12-14-448-013, 12-14-448-015, 12-14-448-016, 12-14-448-017, 12-14-448-018, 12-14-448-019, 12-14-448-021, 14-14-448-022, 12-14-448-025, 12-14-448-026, 12-14-448-027, 12-14-448-028, 12-14-448-029, 12-14-448-030, 12-14-448-032, 12-14-448-033, 12-14-448-034, 12-14-448-035, 12-14-448-036, 12-14-448-037, 12-14-448-038, 12-14-448-042, 12-14-448-039, 12-14-448-040, 12-14-448-041

