

2

2007 047658

2557 JUN 12 10:33  
REC'D  
2007

MAIL TAX BILLS TO: 8535 Moraine  
Munster, IN 46321

PARCEL NO. 26-35-0192-0043

**TRUSTEE'S DEED**

**This indenture witnesseth that JOYCE KLISSER, SUCCESSOR TRUSTEE OF THE THOMAS E. GILBOE TRUST OF 2000, of Lake County in the State of Indiana**

**Conveys and warrants to JOYCE S. KLISSER of Lake County, Indiana; JANET E. WALSH of Dane County, Wisconsin; and GREGORY L. GILBOE of Orange County, California; as tenants in common**

for and in consideration of Ten (\$10.00) Dollars and other good and valuable consideration, the receipt of which is hereby acknowledged, the following Real Estate in Lake County in the State of Indiana, to-wit:

The West 44 feet of the East 132 feet of Lot 26 in the Oak Park Addition to the City of Hammond, Lake County, Indiana.

Commonly known as: 250 Locust Street  
Hammond, Indiana 46324

**Dated this 8th day of June, 2007.**

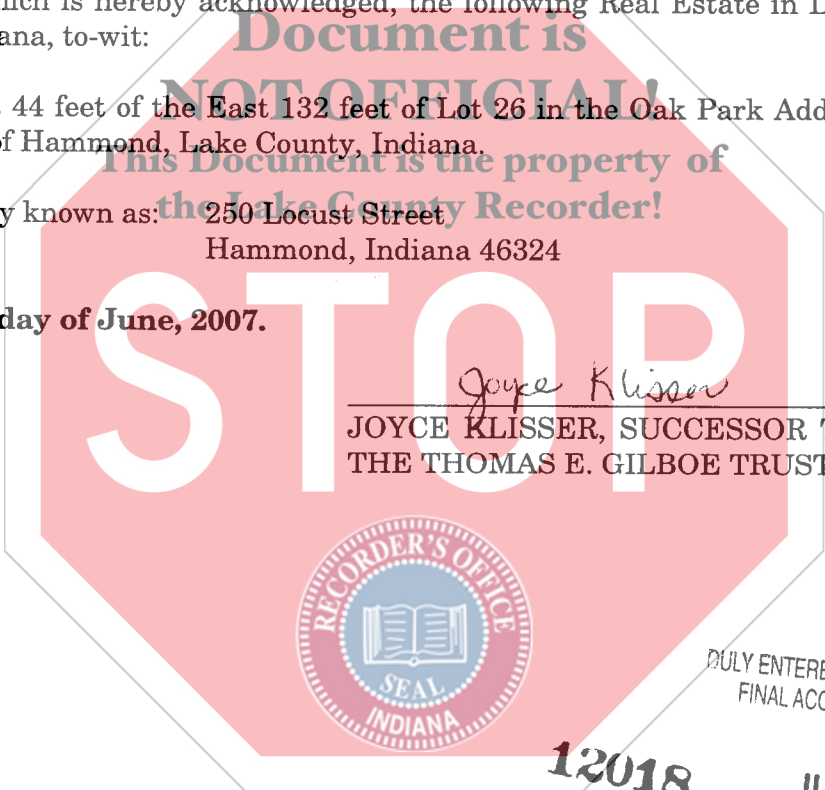

*Joyce Klisser*  
\_\_\_\_\_  
JOYCE KLISSER, SUCCESSOR TRUSTEE OF  
THE THOMAS E. GILBOE TRUST OF 2000

12018

DULY ENTERED FOR TAXATION SUBJECT TO  
FINAL ACCEPTANCE FOR TRANSFER

JUN 12 2007

\$ 18

PEGGY HOLINGA KATONA  
LAKE COUNTY AUDITOR

*CA*  
*CK# 14033*

STATE OF INDIANA        )  
  )SS:  
COUNTY OF LAKE        )

Before me, the undersigned, a Notary Public in and for said County and State, this 8th day of June, 2007, personally appeared JOYCE KLISSER, SUCCESSOR TRUSTEE OF THE THOMAS E. GILBOE TRUST OF 2000, and acknowledged the execution of the foregoing deed. In witness whereof, I have hereunto subscribed my name and affixed my official seal.

Benjamin T. Ballou  
Benjamin T. Ballou, Notary Public

My Commission Expires:                               Resident of Lake County  
November 21, 2007

I affirm, under the penalties for perjury, that I have taken reasonable care to redact each social security number in this document, unless required by law.

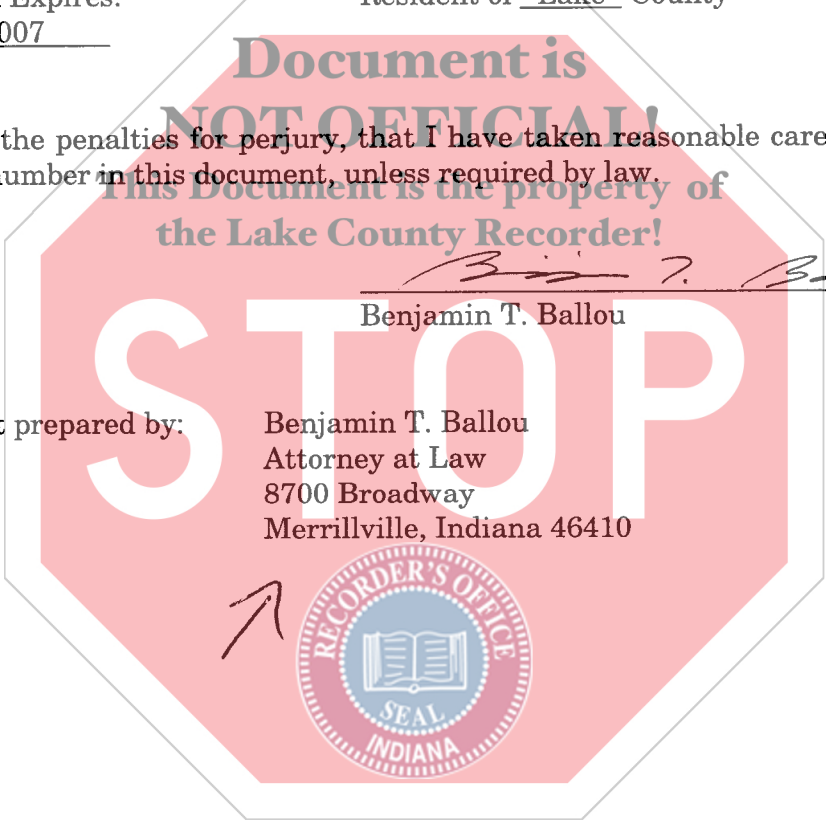

This instrument prepared by: Benjamin T. Ballou  
Attorney at Law  
8700 Broadway  
Merrillville, Indiana 46410

54164.1  
17,027-2