

Prenuptial Agreement between Russell Waid Dillon and Monica Pawlowski

2007 031588

→ Russell Waid Dillon and Monica Pawlowski, hereby stipulate and agree to the following terms in case of a divorce following marriage.

A] PROPERTY SETTLEMENT @ 7348 Taylor St., Schererville, IN ←
Russell would be entitled to the first 35 thousand in equity after any related mortgages were paid and related sale fees, if required. If a move of primary residence occurs, same would apply to primary residence only.
Any subsequent property purchased would be divided equally.

B] RETIREMENT PLANS
Russell would retain all rights to both ComEd related retirements [Fidelity 401K and ComEd Lump sum plan] and any successor thereof. Russell would retain full rights to his Lake County PERF fund and any successor thereof.

C] BENEFITS FROM MEYERS
Any financial or property gain from Dennis Meyers or Meyers Development would remain in the possession of Monica.

D] PERSONAL PROPERTY
Each Party will be granted sole possession of any property or possessions owned at time of marriage. Any personal property obtained after marriage, would be split equally. Aforesaid applies unless specifically identified in this agreement.

E] PROFESSIONAL LAND SURVEYING P.C.
Russell would retain all possessions of Professional Land Surveying P.C. He would be also responsible for any related debt created from the business/himself.

F] DEBT
Any debt, whether created before or during the marriage, would remain the responsibility of the individual who created the debt. Any debt, created with the joint knowledge of both Monica and Russell simultaneously, during the marriage, would be divided proportionally to income.

Russell W. Dillon R W Dillon 4/17/07
Monica M. Pawlowski Monica M Pawlowski 4/17/07
Notary Mary Beth Naujokas
My Commission Expires July 5, 2009

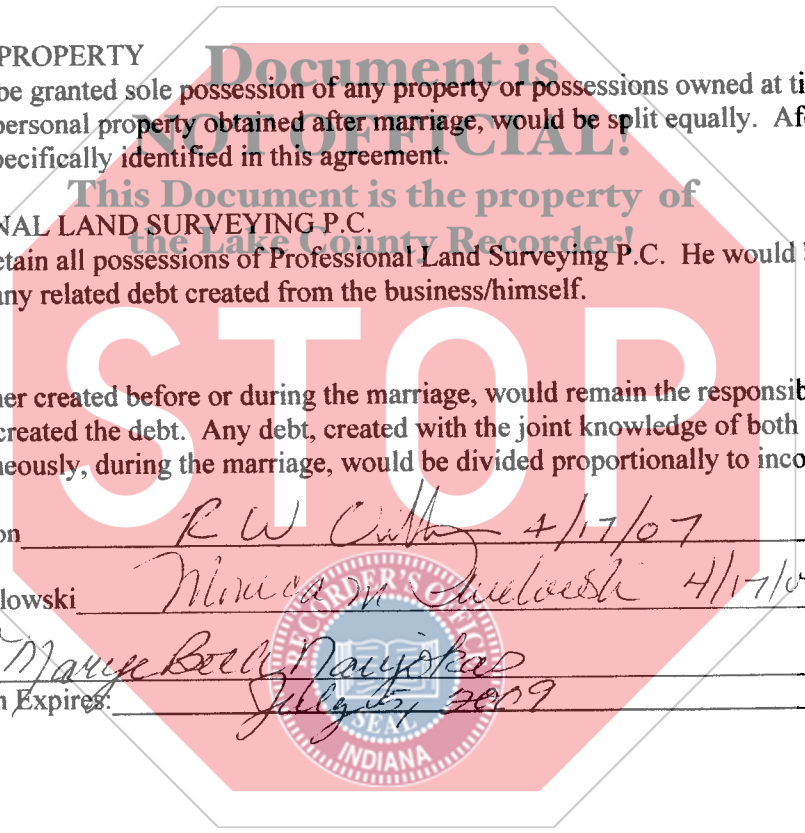

"I AFFIRM, UNDER THE PENALTIES FOR PERJURY, THAT I HAVE TAKEN REASONABLE CARE TO REDACT EACH SOCIAL SECURITY NUMBER IN THIS DOCUMENT, UNLESS REQUIRED BY LAW."
PREPARED BY: [Signature]

12:00 P.M. CS.