

CHICAGO TITLE INSURANCE COMPANY

STATE OF INDIANA
LAKE COUNTY
FILED FOR RECORD

2007 027260

2007 FEB -3 AM 9:44

Parcel No. 15-26-196-22

MICHAELA TOWNE
RECORDER

QUITCLAIM DEED

Order No. BT700117

2

THIS INDENTURE WITNESSETH, That Robert A. Lail and Bina L. Lail (Grantor)

of 15-26-0198-0022 County, in the State of INDIANA QUITCLAIM(S) to Martha Swafford

(Grantee)

of Lake County, in the State of INDIANA, for the sum of ONE DOLLAR AND 00/100 Dollars (\$ 1.00)

and other valuable consideration, the receipt and sufficiency of which is hereby acknowledged, the following described real estate in Lake County, State of Indiana:

See Attached Legal Description

Subject to covenants and restrictions, easements and building lines as contained in plat of subdivision and as contained in all other documents of record; and real estate taxes and assessments for 2005 payable 2006 together with delinquency and penalty, if any, and all real estate taxes and assessments due and payable thereafter which the grantee herein assumes and agrees to pay.

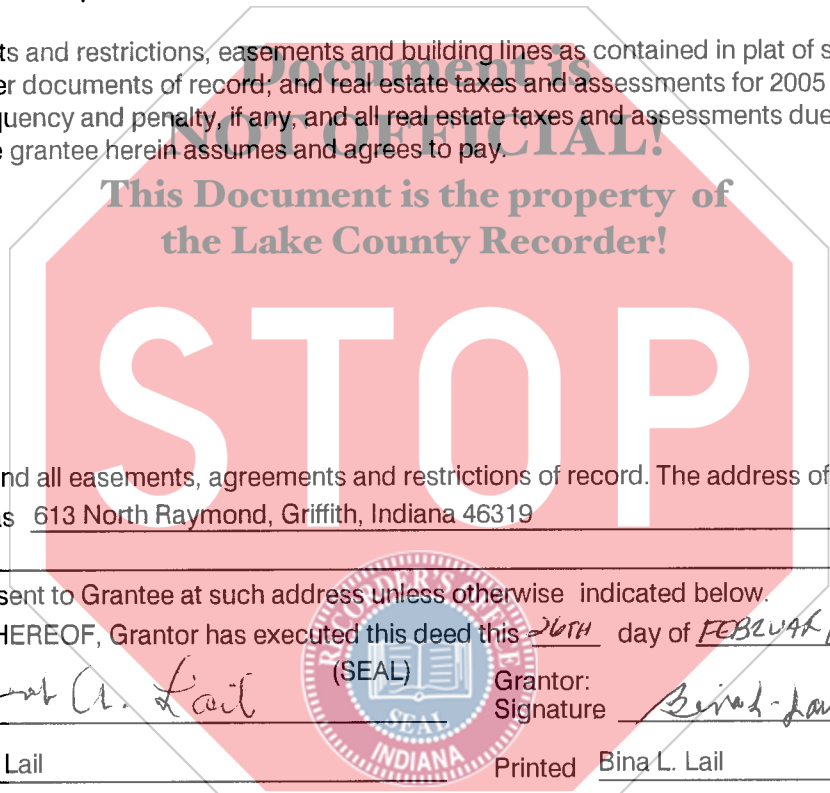

Subject to any and all easements, agreements and restrictions of record. The address of such real estate is commonly known as 613 North Raymond, Griffith, Indiana 46319

Tax bills should be sent to Grantee at such address unless otherwise indicated below.

IN WITNESS WHEREOF, Grantor has executed this deed this 26TH day of FEBRUARY, 2007

Grantor: Robert A. Lail (SEAL)
Signature

Grantor: Bina L. Lail (SEAL)
Signature

Printed Robert A. Lail

Printed Bina L. Lail

STATE OF INDIANA
COUNTY OF Lake

} SS: ACKNOWLEDGEMENT

Before me, a Notary Public in and for said County and State, personally appeared Robert A. Lail and Bina L. Lail

who acknowledged the execution of the foregoing Quitclaim Deed, and who, having been duly sworn, stated that any representations therein contained are true.

Witness my hand and Notarial Seal this 26TH day of FEBRUARY, 2007

My commission expires: 02/04/2008

Signature Donna LaMere

Printed DONNA LAMERE, Notary Name

Resident of _____ County, Indiana.

This instrument prepared by Donna LaMere, Attorney at Law, #03089-64 lgk/sch

I affirm, under the penalties for perjury, that I have taken reasonable care to redact each Social Security number in this document, unless required by law. [Signature]

Return deed to 613 North Raymond, Griffith, Indiana 46319

Send tax bills to 613 North Raymond, Griffith, Indiana 46319

DULY ENTERED FOR TAXATION SUBJECT TO
FINAL ACCEPTANCE FOR TRANSFER

APR - 2 2007

PEGGY HOLINGA KATONA
LAKE COUNTY AUDITOR

004254

18-
LP
CT

EXHIBIT A

LEGAL DESCRIPTION

LOT 22 EXCEPT THE NORTH 5 FEET AND THE NORTH 10 FEET OF LOT 21 IN BLOCK 3 IN PARK MANOR 1ST ADDITION TO GRIFFITH, AS PER PLAT THEREOF, RECORDED IN PLAT BOOK 28, PAGE 94, IN THE OFFICE OF THE RECORDER OF LAKE COUNTY, INDIANA.

