

13

STATE OF INDIANA
LAKE COUNTY
FILED

2007 JUN 19 11:04

MICHELLE A. BROWN
RECORDER

2007 021003

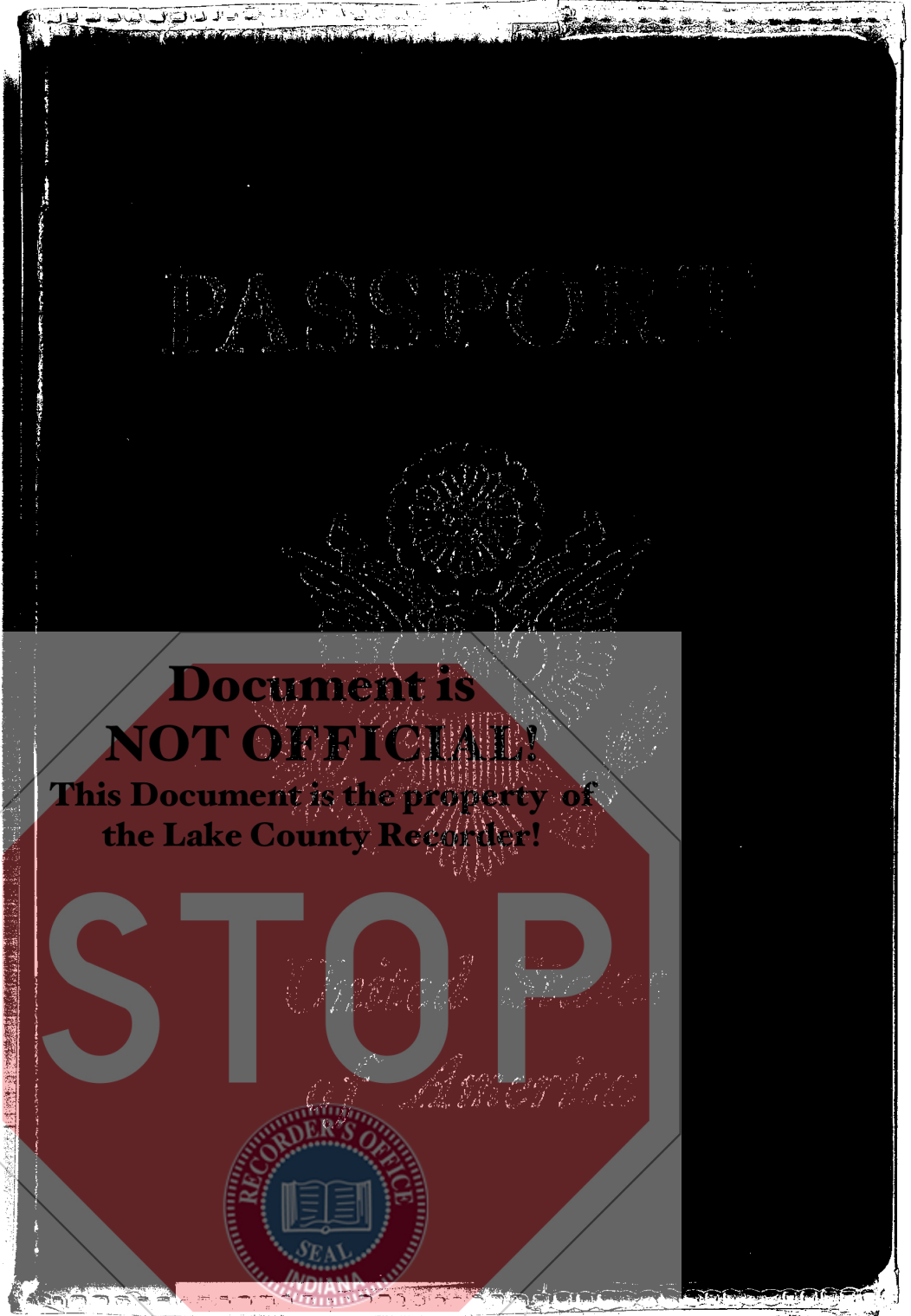

36-
CS/SLS

IMPORTANT INFORMATION

VISAS. IT IS THE RESPONSIBILITY OF THE PASSPORT BEARER TO OBTAIN THE NECESSARY VISAS.

LE TITULAIRE DU PASSEPORT EST SEUL RESPONSABLE DE L'OBTENTION DES VISAS REQUIS

HEALTH. Under the International Health Regulations, a country may require an International Certificate of Vaccination only against yellow fever. Smallpox vaccination is **NOT** required by any country. **NO** immunizations are required to return to the United States. Prophylactic medication for malaria and certain other preventive measures are advisable for some travelers; check with your health care provider or local health department. Also, ensure that your immunizations for measles, mumps, rubella, polio, diphtheria, tetanus, and pertussis are up to date. If you become ill upon returning to the United States, inform your physician of your recent travel abroad. For more information, call (404) 332-4559 or see "Health Information for International Travel," stock no. 017-023-00192-2, P.O. Box 371954, Pittsburgh, PA 15250-7954.

HEALTH INSURANCE. Persons considering foreign travel should determine what health insurance coverage, if any, they require while outside the United States. Medicare does not cover health care costs outside the United States and its territories, except under limited circumstances in Canada and Mexico.

CUSTOMS SERVICE. The pamphlet "Know Before You Go" gives you current information about Customs requirements and how they apply to articles acquired abroad. Obtain a copy from your nearest Customs Office or from the U.S. Customs Service, P.O. Box 7407, Washington, DC 20044. The transportation of currency or bearer instruments in any amount is legal; however, if you take out or bring into the United States more than \$10,000 (U.S. or foreign currency, travelers checks, money orders, or other bearer monetary instruments), you are required by U.S. law to file a report with the U.S. Customs Service.

IMPORTANT INFORMATION

TREASURY. As of November 1993, the purchase or importation of Cuban, North Korean, Vietnamese, Libyan, Iraqi, or Yugoslav (Serbian and Montenegrin) goods or services and the importation of Haitian or Iranian goods or services are generally prohibited, except for informational materials and limited goods imported directly as accompanied baggage. Transactions related to travel in or to Cuba, Libya, or Iraq are generally prohibited. For current restrictions and licensing information, write the Office of Foreign Assets Control, U.S. Department of the Treasury, Second Floor Annex, Washington, DC 20220, or call (202) 622-2490.

AGRICULTURE. Your reentry into the United States will be speeded if you bring with you **NO** foreign meat or other animal products, birds, animals, fruits, vegetables, plants, soil, or other agricultural items. It is unlawful to import foreign agricultural items without permission, since they may carry destructive plant or animal pests and diseases. For specific information, write "Quarantines," PPO, APHIS, U.S. Department of Agriculture, 6505 Belcrest Road, Hyattsville, MD 20782.

INTERNAL REVENUE SERVICE. All U.S. citizens working and residing overseas are required to file and report on their worldwide income. See IRS Publication 54 for an explanation of filing requirements and benefits.

LOSS, THEFT, OR DESTRUCTION OF PASSPORT should be reported immediately to local police authorities and to the Passport Services Office, Washington, DC 20520-4818, or, if overseas, to the nearest American Embassy or Consulate. Your passport is a valuable citizenship and identity document, so it should be carefully safeguarded. Its loss could cause you unnecessary travel complications, as well as significant expense.

THIS PASSPORT IS THE PROPERTY OF THE UNITED STATES GOVERNMENT. IT MUST BE SURRENDERED UPON DEMAND IF MADE BY AN AUTHORIZED REPRESENTATIVE OF THE UNITED STATES GOVERNMENT.

Document is
NOT OFFICIAL!
This Document is the property of
the Lake County Recorder!

IMPORTANT INFORMATION

ALTERATION OR MUTILATION OF PASSPORT. This passport must not be altered or mutilated in any way. Alteration may make it **INVALID**, and it willful may subject you to prosecution (Title 18, U.S. Code, Section 1543). Only authorized officials of the United States or of foreign countries, in connection with official matters, may place stamps or make statements, notations, or additions in this passport. You may amend or update personal information for your own convenience on page 5.

LOSS OF CITIZENSHIP. Under certain circumstances, you may lose your U.S. citizenship by performing any of the following acts: (1) being naturalized in a foreign state; (2) taking an oath or making a declaration to a foreign state; (3) serving in the armed forces of a foreign state; (4) accepting employment with a foreign government; or (5) formally renouncing U.S. citizenship before a U.S. consular officer overseas. For detailed information, consult the nearest American Embassy or Consulate, or contact the Office of Citizens Consular Services, Department of State, Washington, DC 20520-4818, or call (202) 647-3444.

DUAL CITIZENS. A person who has the citizenship of more than one country at the same time is considered a dual citizen. Citizenship may be based on facts of birth, marriage, parentage, or naturalization. A dual citizen may be subject to all of the laws of the other country that considers that person its citizen while in its jurisdiction. This includes conscription for military service. Dual citizens who encounter problems abroad should contact the nearest American Embassy or Consulate.

TRAVEL INFORMATION for countries you may visit may be heard by calling (202) 647-5225. Travel information is also posted at U.S. Passport Agencies and U.S. Embassies and Consulates overseas.

WHEN TRAVELING IN DISTURBED OR REMOTE AREAS OR RESIDING ABROAD, you should register and keep in touch with the nearest American Embassy or Consulate. You may listen to the latest Department of State travel information by calling (202) 647-5225.

NOTICE: IT IS UNLAWFUL FOR ANY PERSON NOT THE BEARER TO USE THIS PASSPORT. TO USE THIS PASSPORT IN CONTRAVENTION OF THE PASSPORT REGULATIONS OR OF THE CONDITIONS OR RESTRICTIONS SET OUT IN THIS PASSPORT OR TO USE THIS PASSPORT FOR TRAVEL TO COUNTRIES WHERE A U.S. PASSPORT IS NOT VALID, TITLE 18, U.S. CODE, SECTION 1544, FOR FURTHER INFORMATION, CONTACT THE NEAREST U.S. EMBASSY OR CONSULATE OR THE DEPARTMENT OF STATE, (202) 326-6188.

FOR YOUR PROTECTION, PENCIL IN THE NAMES AND ADDRESSES BELOW.

PLEASE KEEP THESE ENTRIES UP TO DATE.

BEARER'S ADDRESS IN THE UNITED STATES:
ADRESSE DU TITULAIRE AUX ETATS-UNIS:

BEARER'S FOREIGN ADDRESS:
ADRESSE DU TITULAIRE A L'ETRANGER:

IN CASE OF EMERGENCY, NOTIFY THE NEAREST AMERICAN EMBASSY, OR CONSULATE OR THE STATE DEPARTMENT, CITIZENS EMERGENCY CENTER, AT (202) 647-5225, AND THE INDIVIDUAL NAMED BELOW.

EN CAS D'URGENCE, PRIERE D'AVISER L'AMBASSADE OU LE CONSULAT DES ETATS-UNIS LE PLUS PROCHE OU LE CENTRE DES URGENCES CONSULAIRES DU DEPARTEMENT D'ETAT, AU (202) 647-5225, AINSI QUE LA PERSONNE DONT LE NOM FIGURE CI-DESSOUS.

Name
Nom

Address
Adresse

Telephone
Téléphone

Document is
NOT OFFICIAL!
This Document is the property of
the Lake County Recorder!

TIPS FOR TRAVELERS

1. Make sure you have a valid passport, and visas, if required, in case of an emergency, a relative in the U.S. should have a passport also.
2. Call the State Department's Citizens Emergency Center, at (202) 647-5225 for information on the areas to be visited. Stay aware of events in the country you are visiting.
3. Make two photocopies of your passport identification page. Leave one copy at home. Carry the other with you in a separate place from your passport. This will facilitate replacement if your passport is lost or stolen.
4. Leave a copy of your itinerary with family or friends at home, so that you can be contacted in case of emergency.
5. When traveling in disturbed or remote areas, or if residing abroad, register and keep in touch with the nearest American Embassy or Consulate.
6. Do not leave luggage unattended in public areas or accept packages from strangers.
7. Avoid conspicuous clothing and expensive jewelry and do not carry excessive amounts of money or unnecessary credit cards.
8. In order to avoid violating local laws, deal only with authorized agents when exchanging money or purchasing souvenirs.
9. Familiarize yourself with local laws and customs of the countries to which you are traveling. While in a foreign country, you are subject to its laws.
10. Contact the nearest U.S. consul if you get into trouble.

Document is NOT OFFICIAL!

This Document is the property of the Wake County Recorder!

IT IS THE RESPONSIBILITY OF THE PASSPORT BEARER TO OBTAIN THE NECESSARY VISAS.

LE TITULAIRE DU PASSEPORT EST SEUL RESPONSABLE DE L'OBTENTION DES VISAS REQUIS.

Entrées/ Entrées

Visas Departures/Sorties

Entrées/ Entrées

Visas Departures/Sorties

68/45

ผู้เดินทางมีชื่อเดินทางเลขที่ 023317424
 ลงวันที่ 30 JAN 1990 ออกให้ที่ USA
 เดินทางเข้ามาในประเทศไทย เมื่อวันที่ 24 FEB 1993
 โดยพาหนะ AIR
 ได้รับอนุญาตให้อยู่ถึง 27 FEB 2000
 และได้เปลี่ยนหนังสือเดินทางเดิม คอลัมน์ที่ 3 ของนี้
 เนื่องจากหนังสือเดินทางเก่าขาด สกน. 19 นู. 1001
 จึงหมายเหตุไว้เป็นหลักฐาน
 (M.C.P.)
 วันที่ 28 FEB 2000

IMMIGRATION
 VISA CLASS NON-O
 ADMITTED 27 FEB 1993
 UNTIL 27 FEB 1993
 SIGNED A 257

26 FEB 2000

ALL INFORMATION CONTAINED HEREIN IS UNCLASSIFIED
 DATE 01-28-2001 BY 60322 UCBAW/STP

APPLICANTS WHOSE VISAS EXPIRE WITHIN THIS DATE
 AND WHOSE APPLICANTS OFFENSES WILL BE PROSECUTED

IMMIGRATION 100/100/100/100
 IMMIGRATION OFFICER
 26 APR 1999

เลขที่ 2018942
 26 FEB 2000

Signature
 28 FEB 2000

Signature
 28 FEB 2000

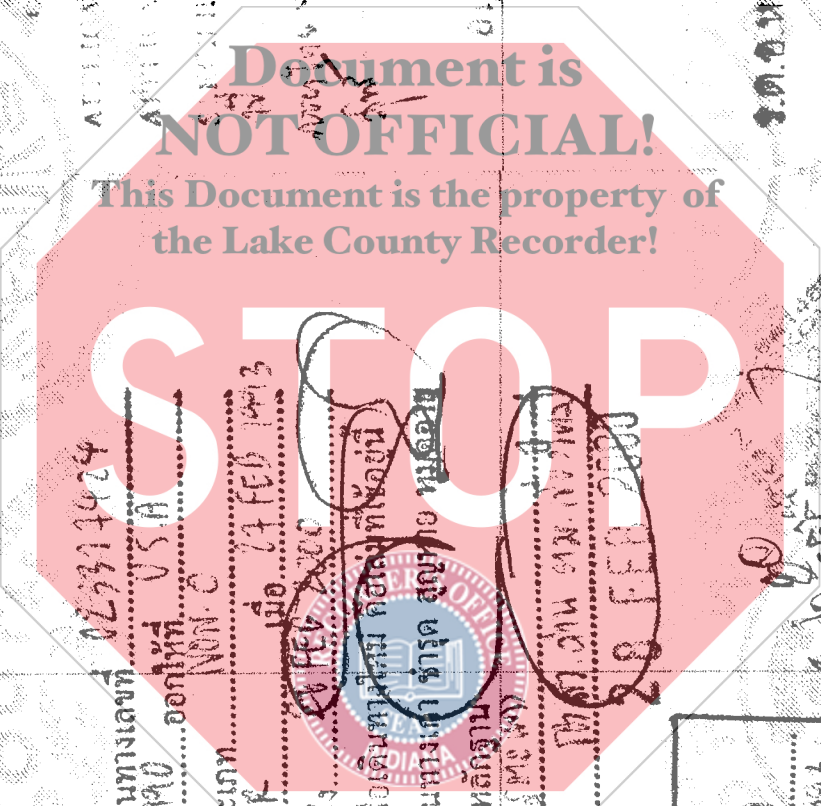

3.0.0.0.0.0.0

RECEIVED
 14 FEB 2001
 023317424

Entries / Entrées

Visas

Departures / Sorties

4915 / 423

CHIANGMAI IMMIGRATION OFFICE
Departures / Sorties

APPLICATION OF STAY IS UNDER CONSIDERATION OF

THE IMMIGRATION BUREAU APPLICANT MUST CONTACT
THIS OFFICE AGAIN IN PERSON ON **29 MAY 2000**

CHIANGMAI IMMIGRATION OFFICE
APPLICATION OF STAY IS UNDER CONSIDERATION OF
THE IMMIGRATION BUREAU APPLICANT MUST CONTACT
THIS OFFICE AGAIN IN PERSON ON **28 MAR 2000**

[Signature]
28 MAR 2000



CHIANGMAI IMMIGRATION OFFICE

APPLICATION OF STAY IS UNDER CONSIDERATION OF

THE IMMIGRATION BUREAU APPLICANT MUST CONTACT

THIS OFFICE AGAIN IN PERSON ON **28 APR 2000**

SIGNED *[Signature]*
IMMIGRATION OFFICER

28 MAR 2000

Document is NOT OFFICIAL!

This Document is the property of the Lake County Recorder!

SIGNED *[Signature]*
IMMIGRATION OFFICER
28 APR 2000

CHIANGMAI IMMIGRATION OFFICE
APPLICATION OF STAY IS PERMITTED UP TO **26 FEB 2001**
APPLICANT MUST LEAVE THE KINGDOM WITHIN THE DATE
SPECIFIED HEREIN OFFENDERS WILL BE PROSECUTED

SIGNED *[Signature]*
IMMIGRATION OFFICER

29 MAY 2000

อนุญาตคน ๖. ๓ ๐๐๒๒.๔ (๑๑.) ๗๗๖ ๑๙ ม. ๔๓

Please contact the Immigration office for a RE-ENTRY PERMIT before leaving Thailand.

Entries / Entrées

582 744

Visas

Departures / Sorties

CHANGMAI IMMIGRATION OFFICE
APPLICATION OF STAY IS FORWARDED TO... 26 FEB 2002
ADVISE THE BUREAU OF THE INFORMATION WHEN THE DATE
SPECIFIED IN THE VISAS FOR DEPARTURES / SORTIES

CHANGMAI IMMIGRATION OFFICE
APPLICATION OF STAY IS UNDER CONSIDERATION OF
THE IMMIGRATION BUREAU APPLICANT MUST CONTACT
THIS OFFICE AGAIN IN PERSON ON... 28 MAR 2001

IMMIGRATION OFFICER
26 FEB 2001
[Signature]

CHANGMAI IMMIGRATION OFFICE
APPLICATION OF STAY IS UNDER CONSIDERATION OF
THE IMMIGRATION BUREAU APPLICANT MUST CONTACT
THIS OFFICE AGAIN IN PERSON ON... 25 APR 2001

IMMIGRATION OFFICER
25 APR 2001
[Signature]

SIGNED... [Signature]
IMMIGRATION OFFICER

25 APR 2001

768
[Signature] AT L.N.E. KY

Please contact the Immigration
office for a RE-ENTRY PERMIT
before leaving Thailand.

CHANGMAI IMMIGRATION OFFICE
APPLICATION OF STAY IS UNDER CONSIDERATION OF
THE IMMIGRATION BUREAU APPLICANT MUST CONTACT
THIS OFFICE AGAIN IN PERSON ON... 27 MAR 2002

SIGNED... [Signature]
IMMIGRATION OFFICER

25 FEB 2002

[Signature]
[Signature]



Document is NOT OFFICIAL
This Document is the property of
the Lake County Recorder!

CHIANGMAI IMMIGRATION OFFICE

APPLICATION OF STAY IS UNDER CONSIDERATION OF

THE IMMIGRATION BUREAU APPLICANT MUST CONTACT THIS OFFICE AGAIN IN PERSON ON 27 APR 2002

Entries/Entrées

Visas (NO. VISA) *[Signature]*

Entries/Entrées

Visas

Departures/Sorties

SIGNED

IMMIGRATION OFFICER

28 MAR 2002
26 FEB 2003

CHIANGMAI IMMIGRATION OFFICE

APPLICATION OF STAY IS PERMITTED UP TO
APPLICANT MUST LEAVE THE KINGDOM WITHIN THE DATE
SPECIFIED HEREIN OFFENSES WILL BE PROSECUTED

SIGNED *[Signature]*
IMMIGRATION OFFICER

26 APR 2002

เลขที่ 2.10022.4 (ร.ก.)

708/46

CHIANGMAI IMMIGRATION OFFICE

APPLICATION OF STAY IS UNDER CONSIDERATION OF

THE IMMIGRATION BUREAU APPLICANT MUST CONTACT

THIS OFFICE AGAIN IN PERSON ON 28 MAR 2003

SIGNED *[Signature]*

IMMIGRATION OFFICER
26 FEB 2003

CHIANGMAI IMMIGRATION OFFICE

APPLICATION OF STAY IS UNDER CONSIDERATION OF

THE IMMIGRATION BUREAU APPLICANT MUST CONTACT THIS OFFICE AGAIN IN PERSON ON 27 APR 2003

[Signature]
IMMIGRATION OFFICER

IMMIGRATION OFFICER

28 MAR 2003

CHIANGMAI IMMIGRATION OFFICE

APPLICATION OF STAY IS UNDER CONSIDERATION OF

THE IMMIGRATION BUREAU APPLICANT MUST CONTACT THIS OFFICE AGAIN IN PERSON ON 7 MAY 2003

SIGNED *[Signature]*

IMMIGRATION OFFICER

28 APR 2003

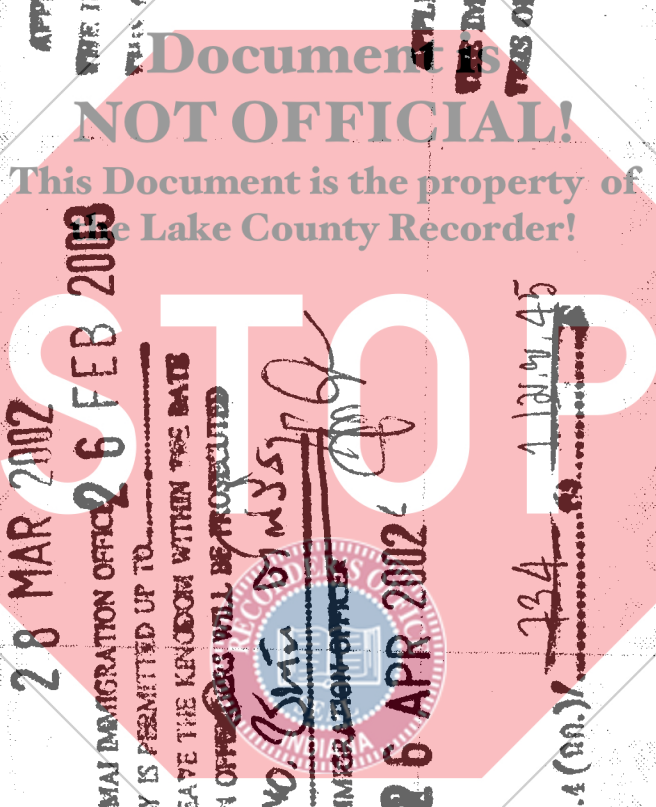

Entries/Entrées

Visas

Departures/Sorties

CHANGAI IMMIGRATION OFFICE 6 FEB 2004

APPLICANT'S PERMITS OF STAY IS PERMITTED UP TO...

APPLICANT MUST RETURN TO THE KINGDOM WITHIN THE DATE

SPECIFIED HEREIN OFFENDERS WILL BE PROSECUTED

SIGNED: *[Signature]*

IMMIGRATION OFFICER

27 MAY 2003

290.4b

290.4b

"I AFFIRM, UNDER THE PENALTIES FOR PERJURY, THAT I HAVE TAKEN REASONABLE CARE TO REDACT EACH SOCIAL SECURITY NUMBER IN THIS DOCUMENT, UNLESS REQUIRED BY LAW."

PREPARED BY: *[Signature]*

Departures/Sorties

12 MAY 2004

12 MAY 2004

12 MAY 2004

12 MAY 2004

12 MAY 2004

12 MAY 2004

12 MAY 2004

12 MAY 2004

12 MAY 2004

12 MAY 2004

12 MAY 2004

12 MAY 2004

12 MAY 2004

12 MAY 2004

12 MAY 2004

12 MAY 2004

12 MAY 2004

12 MAY 2004

12 MAY 2004

12 MAY 2004

12 MAY 2004

12 MAY 2004

12 MAY 2004

12 MAY 2004

12 MAY 2004

12 MAY 2004

12 MAY 2004

12 MAY 2004

12 MAY 2004

12 MAY 2004

12 MAY 2004

12 MAY 2004

12 MAY 2004

12 MAY 2004

12 MAY 2004

12 MAY 2004

12 MAY 2004

12 MAY 2004

A1203A1203A1203A1203A1203A

IMMIGRATION OFFICE BANGKOK THAILAND

ADMITTED UNTIL 7 MAY 2006

SIGNED: *[Signature]*

Document is NOT OFFICIAL!

This Document is the property of the Lake County Recorder!

STOP

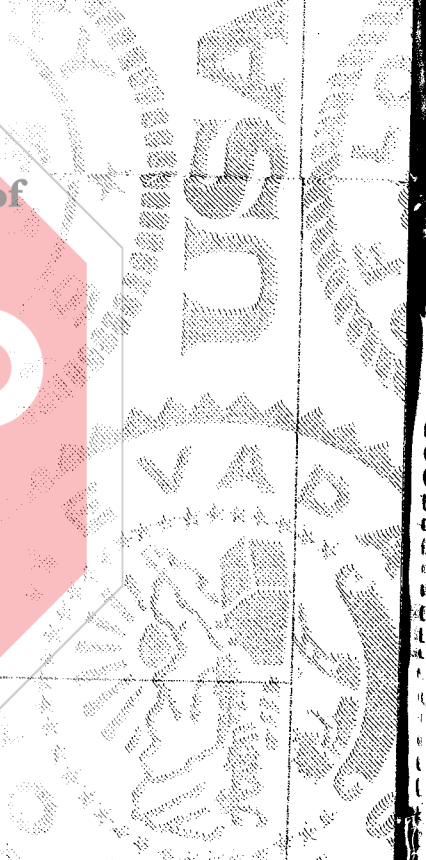
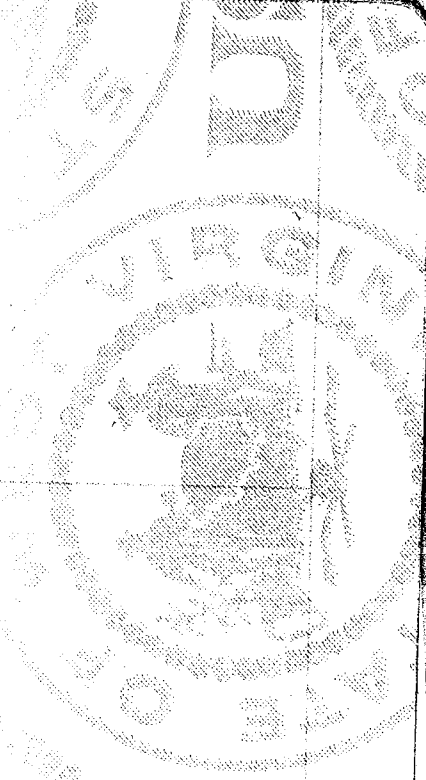
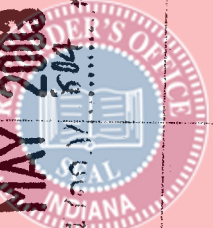



OFFICE OF THE LAKE COUNTY RECORDER

LAKE COUNTY GOVERNMENT CENTER
2293 NORTH MAIN STREET
CROWN POINT, INDIANA 46307

MICHAELA A. BROWN
Recorder



PHONE (219) 755-3730
FAX (219) 755-3257

MEMORANDUM

DISCLAIMER

Document is
This document has been recorded as presented.
It may not meet with State of Indiana Recordation requirements.
This Document is the property of
the Lake County Recorder!

STOP





OFFICE OF THE LAKE COUNTY RECORDER

LAKE COUNTY GOVERNMENT CENTER
2293 NORTH MAIN STREET
CROWN POINT, INDIANA 46307

MICHAEL A. BROWN
Recorder



PHONE (219) 755-3730
FAX (219) 755-3257

MEMORANDUM

DISCLAIMER

Document is

**This document has been recorded as presented.
It may not meet with State of Indiana Recordation requirements.**

**This Document is the property of
the Lake County Recorder!**

STOP



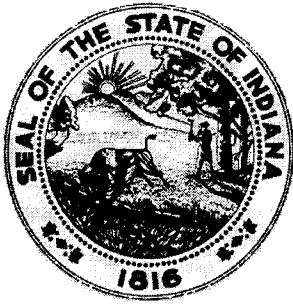

Michael A. Brown

Recorder of Deeds
Lake County Indiana
2293 North Main Street
Crown Point, In 46307
219-755-3730
fax: 219-648-6028

Certification Letter

State of Indiana)
County of Lake) SS

This is to certify that I, Michael A. Brown, Recorder of Deeds of Lake County, Indiana am the custodian of the records of this office, and that the foregoing is a full, true and complete copy of a

**PASSPORT UNITED STATES OF AMERICA FOR LONNIE ROBERT
PREVOT**

as recorded as **DOCUMENT # 2007-021003**

as this said document was present for the recordation when **Michael A. Brown**

was Recorder at the time of filing of said document.

Dated this **9TH** day of **March**, 2007

Sherry Serences
Deputy Recorder



Michael A. Brown

Michael A. Brown, Recorder of Deeds
Lake County Indiana

Form # 0023 Revised 5/2002