

2007 020761

2007-03-09 AM 9:58

MICHAELA A. BROWN
RECORDER

2

Mail tax bills to:
1870 East 105th Place
Crown Point, Indiana 46307

CORPORATE DEED

BT700068

THIS INDENTURE WITNESSETH that Cartus Corporation, a Delaware Corporation ("Grantor"), CONVEYS and WARRANTS to James F. Barnthouse and Margaret E. Meidell ("Grantee") of Lake County, in the State of Indiana, in consideration of Ten Dollars (\$10) and other good and valuable consideration, the receipt of which is hereby acknowledged, the following described real estate in Lake County, in the State of Indiana, to-wit:

The West 1/2 Of Lot Numbered 160 In Waterside Crossing Phase-1, A Subdivision In Lake County, Indiana, As Per Plat Thereof, Recorded In Plat Book 94, Page 10 In The Office Of The Recorder Of Lake County, Indiana.

Taxing Unit: Crown Point

Parcel No. 23-09-0590-0088

Commonly known as: 1870 East 105th Place, Crown Point, Indiana 46307

Subject to real estate taxes for 2006 payable in 2007 together with delinquency and penalty if any, and all real estate taxes due and payable thereafter.

The undersigned persons executing this deed on behalf of Grantor represent and certify that they are duly elected officers of Grantor and have been fully empowered, by proper resolution of the Board of Directors of Grantor, to execute and deliver this deed; that Grantor has full corporate authority to convey the real estate described herein, and that all necessary corporate action for the making of such conveyance has been taken and done, and that THERE IS NO INDIANA GROSS INCOME TAX DUE AT THIS TIME AS A RESULT OF THIS CONVEYANCE.

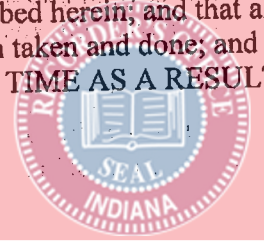
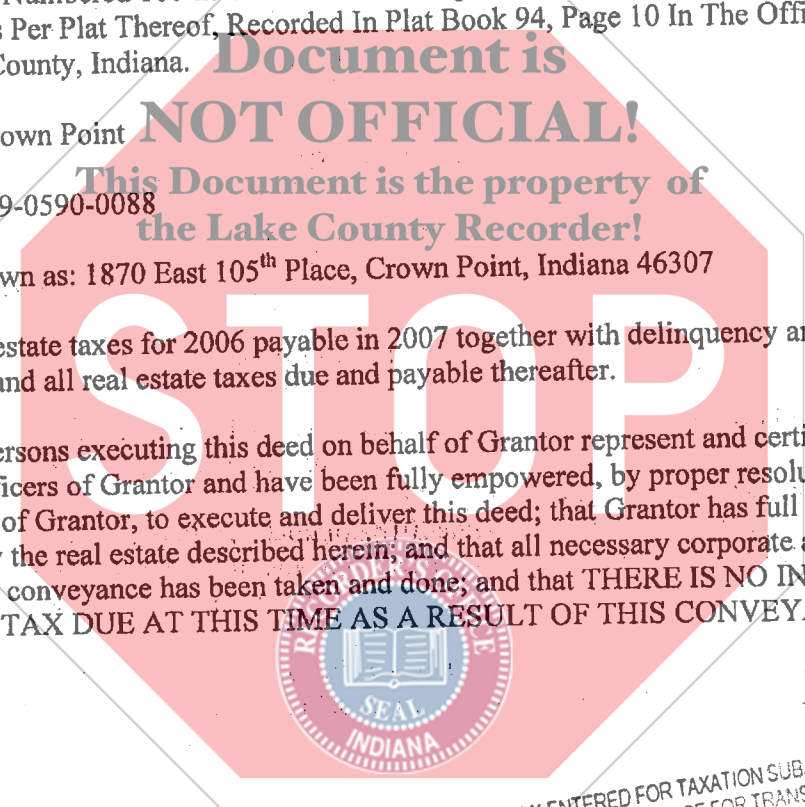

DULY ENTERED FOR TAXATION SUBJECT TO
FINAL ACCEPTANCE FOR TRANSFER

MAR 08 2007

LAKE COUNTY RECORDER

020496

18-
LP
CT

CHICAGO TITLE INSURANCE COMPANY

IN WITNESS WHEREOF, Grantor has caused this deed to be executed this 12 day of Feb, 2007.

CARTUS CORPORATION

By: MaryEllis

MaryEllis
(PRINTED NAME AND OFFICE)

COUNTY OF Burlington, STATE OF New Jersey SS:

Before me, a Notary Public in and for said County and State, personally appeared MaryEllis of Cartus Corporation who acknowledged execution of the foregoing Deed for and on behalf of said Grantor, and who, having been duly sworn, stated that the representations therein contained are true.

Witness my hand and Notarial Seal this 12 day of Feb 2006.

My commission expires: 2-24-2010 Signature: Sharee McKinney

Resident of Burlington County Printed: Sharee McKinney Notary Public

This instrument prepared by:

Burnet Title of Indiana, LLC
14 E. U.S. Highway 30
Scherville, IN 46375
(219) 322-2257

No legal opinion has been rendered during the preparation of this Deed

Mail Deed to:
1870 East 105th Place
Crown Point, Indiana 46307

MM

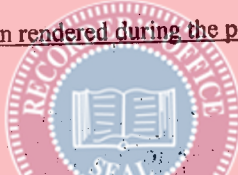

SHAREE MCKINNEY
NOTARY PUBLIC OF NEW JERSEY
Commission Expires 2/24/2010

