

2006 DEC -4 AM 10:07

3

2006 106224

STATE OF INDIANA)
) :SS
COUNTY OF LAKE)

Project: STP-3845(003)
Parcel: 8
Code: 4277
MICHAEL A. BROWN
RECORDER

AFFIDAVIT OF SURVIVING SPOUSE

I, Richard J. Buehler, the undersigned affiant,

being duly sworn upon my oath, hereby say that I am 87 years of age and that I am the owner of the following described real estate interest located in Lake County, State of Indiana, to wit:

See Exhibit "A"

Affiant further says that (he) (she) is the surviving (wife) (husband) of Gwendolyn Buehler, who died intestate in the County of LAKE, State of Indiana on MAY 4, 2003 until he date of decedent's death and were so living together on said date, that no administration was had upon the Estate of the said decedent, but all funeral expenses, expenses of the last illness and debts of every kind and character were fully paid, that no Indiana Inheritance Taxes or Federal Estate Taxes or any other taxes which might have been assessed against such estate are due or payable on said estate or the assets distributed therefrom.

The affiant makes this affidavit for the purpose of inducing the State of Indiana to accept a deed from the grantor thereon conveying all or part of the aforescribed real estate to the State of Indiana.

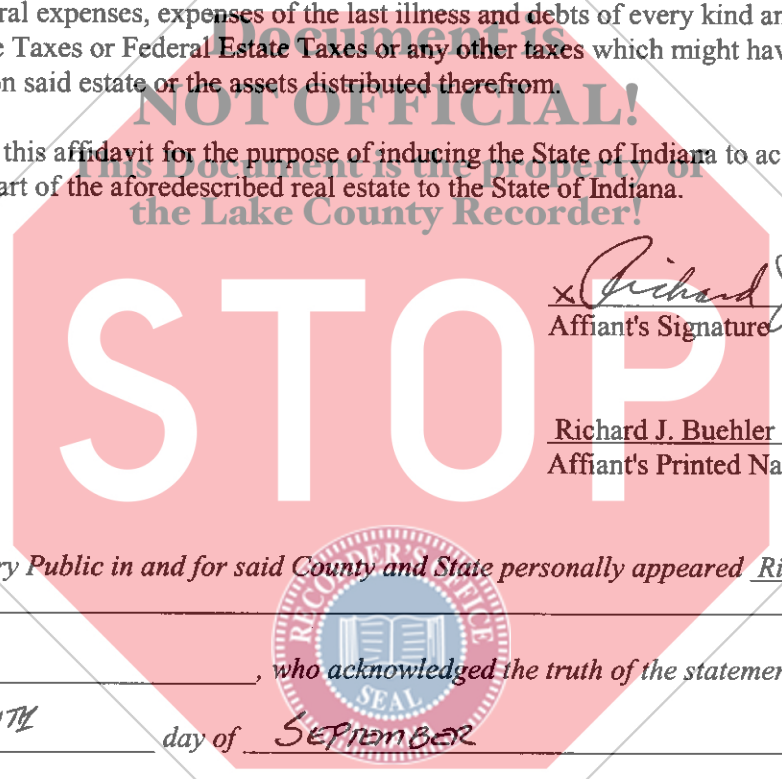

Richard J. Buehler
Affiant's Signature

Richard J. Buehler
Affiant's Printed Name

Before me, a Notary Public in and for said County and State personally appeared Richard J. Buehler

who acknowledged the truth of the statements in the foregoing affidavit on this 14TH day of SEPTEMBER

"I affirm, under the penalties for perjury, that I have taken reasonable care to redact each Social Security number in this document, unless required by law."
Signature: Diana Kile
Printed Name: DIANA KILE

Terry G. Leitner
Notary Public (Signature)
TERRY G. LEITNER
Notary Public (Printed)



My Commission expires 7/06/06

My County of Residence is DELAWARE

This instrument prepared by Terry G. Leitner

MARK G. AHEARN
ATTORNEY AT LAW

025047

FILED

DEC - 12 2006

PEGGY HOLINGA KATONA
LAKE COUNTY AUDITOR

16-
CK#
13484
13574
MG

EXHIBIT "A"

Project: STP-3845(003)

Sheet 1 of 2

Code: 4277

Parcel 8 Fee Simple R/W

A part of the East 80 rods of the Southwest Quarter of Section 12, in Township 32 North, Range 10 West, Lake County, Indiana, and being that part of the grantor's land lying within the right-of-way lines depicted on the attached Right-of-Way Parcel Plat marked Exhibit "B", described as follows: Commencing at the southwest corner of said Section 12; South 89 degrees 33 minutes 14 seconds East 1,243.09 feet (1,252.89 feet per Instrument No. 078779), along the south line of said Section 12, to the centerline of S.R. 2; thence North 63 degrees 55 minutes 15 seconds East 523.09 feet (523.03 feet per Instrument No. 078779), along the centerline of said S.R. 2, to the west line of the East 80 rods of said quarter section; thence South 0 degrees 09 minutes 47 seconds West 33.45 feet, along said west line, to the southeastern boundary of S.R. 2 and the point of beginning of this description: thence North 63 degrees 55 minutes 15 seconds East 807.88 feet, along the boundary of said S.R. 2, to the point designated "695" on said Parcel Plat; thence South 26 degrees 30 minutes 37 seconds East 20.28 feet to the point designated "691" on said Parcel Plat; thence South 63 degrees 13 minutes 41 seconds West 89.22 feet to the point designated "690" on said Parcel Plat; thence North 27 degrees 02 minutes 02 seconds West 20.00 feet to the point designated "689" on said Parcel Plat; thence South 61 degrees 44 minutes 08 seconds West 420.31 feet to the point designated "680" on said Parcel Plat; thence, Southwesterly, 112.61 feet along an arc to the right having a radius of 9,915.08 and subtended by a long chord having a bearing of South 60 degrees 49 minutes 48 seconds West and a length of 112.61 feet to the point designated "678" on said Parcel Plat; thence South 68 degrees 19

EXHIBIT "A"

Project: STP-3845(003)

Sheet 2 of 2

Code: 4277

Parcel 8 Fee Simple R/W

minutes 21 seconds West 126.62 feet to the point designated "677" on said Parcel Plat; thence, Southwesterly, 67.67 feet along an arc to the right having a radius of 9,900.08 feet and subtended by a long chord having a bearing of South 62 degrees 04 minutes 40 seconds West and a length of 67.67 feet to the west line of the East 80 rods of said southwest quarter; thence North 0 degrees 09 minutes 47 seconds East 17.74 feet, along said west line, to the point of beginning and containing 0.262 acres, more or less.

Document is
NOT OFFICIAL!

This Document is the property of
the Lake County Recorder!

This description was prepared for the Indiana Department of Transportation by Perry D. Cloyd, Indiana Registered Land Surveyor, License Number 8700036, on the 7th day of May, 2004.

STOP

