

2006 087860

2006 OCT -6 PM 3:08

MICHAEL J. TOWN  
RECORDER

### COMMISSIONERS QUIT CLAIM DEED

This Indenture Witnesseth, that the Lake County, Indiana Board of Commissioners, of Lake County, in the State of Indiana,

Release and Quit-Claim to **Seatrice Foster**  
**25932 Pastoral Dr.**  
**Plainfield, IL 60544**

of LAKE County, in the State of INDIANA, for and in consideration of (\$450.00), and other valuable consideration, the receipt whereof is hereby acknowledged, the following described Real Estate in LAKE County, Indiana:

Property ID **25-46-0402-0001**  
Property Address **4201 Adams St Gary IN 46408**

Legal Description  
**REISSIGS ADD. GLEN PARK L.1 BL.6**

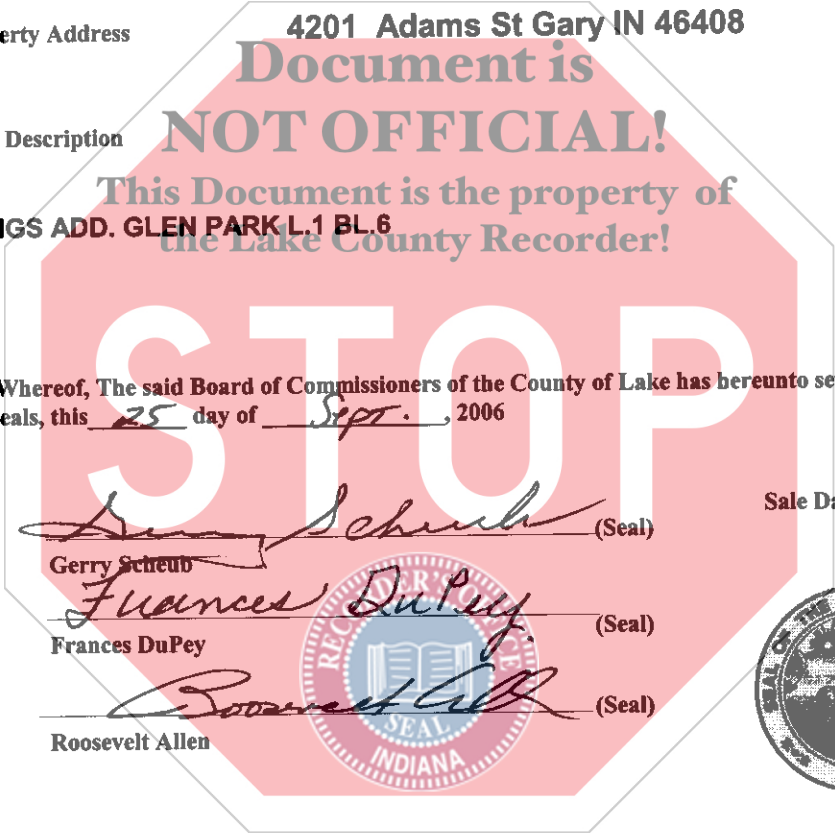

In Witness Whereof, The said Board of Commissioners of the County of Lake has hereunto set their hands and seals, this 25 day of Sept., 2006

Gerry Scheub (Seal)  
Gerry Scheub  
Frances DuPey (Seal)  
Frances DuPey  
Roosevelt Allen (Seal)  
Roosevelt Allen

Sale Date  
**8/16/2006**

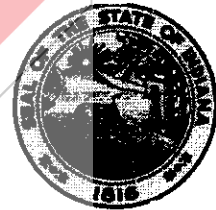

STATE OF INDIANA, LAKE COUNTY, SS

Before me, the undersigned, duly elected, qualified, sworn and acting Auditor in and for said County and State, empowered by law to acknowledge the deeds of the LAKE County Commissioners, under I.C. 36-2-2-11, 36-2-9-7, 32-1-2-18, 32-1-2-23, and City of Gary v. Belovich, 1987, 504 N.E.2d 286, do now attest that on this 25 day of Sept., 2006, personally came the LAKE County Commissioners, all of whom are personally known to me, and acknowledged the execution of the above and foregoing instrument as their true, voluntary and official act.

I affirm, under the penalties for perjury, that I have taken reasonable care to redact each Social Security number in this document, unless required by law.  
Deed prepared by John S. Dull, Attorney for Commissioners

WITNESS MY HAND AND OFFICIAL SEAL  
Peggy Katona  
Peggy Katona, Auditor of LAKE Count

DULY ENTERED FOR TAXATION SUBJECT TO  
FINAL ACCEPTANCE FOR TRANSFER

OCT - 4 2006

PEGGY HOLINGA KATONA  
LAKE COUNTY AUDITOR

019967#16  
C# 040742  
C#