

2

STATE OF INDIANA
LAKE COUNTY
FILED FOR RECORD

2006 052815

2006 JUN 21 AM 9:33

MICHAEL A. BROWN
RECORDER

Mail Tax Bills To: 6800 Swan Lane, Schererville, IN 46375

Tax Key No.: 20-13-599-29

420063406

WARRANTY DEED

①

THIS INDENTURE WITNESSETH, That JOYCE M. HOLIFIELD and WILLIAM J. HOLIFIELD, HUSBAND and WIFE

("Grantor") of LAKE County in the State of INDIANA CONVEY(S) AND WARRANT(S) TO SEAN M. BRENNAN and PEGGY BRENNAN, HUSBAND and WIFE

("Grantee") of LAKE County in the State of INDIANA in consideration of One Dollar and other valuable consideration, the receipt and sufficiency of which are hereby acknowledged, the following described real estate in LAKE County in the State of Indiana:

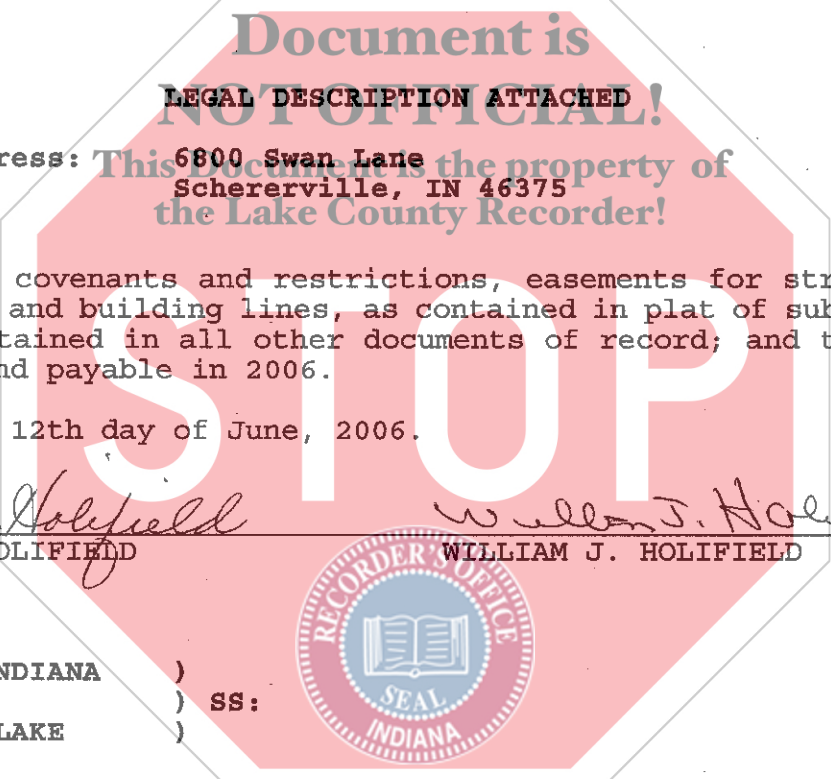

CHICAGO TITLE INSURANCE COMPANY

Common Address: 6800 Swan Lane Schererville, IN 46375

Subject to covenants and restrictions, easements for streets and utilities, and building lines, as contained in plat of subdivision and as contained in all other documents of record; and taxes for 2005 due and payable in 2006.

Dated this 12th day of June, 2006.

Joyce M. Holifield
JOYCE M. HOLIFIELD
William J. Holifield
WILLIAM J. HOLIFIELD

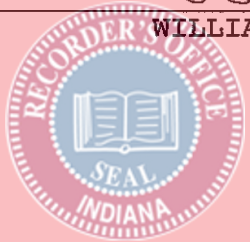

STATE OF INDIANA)
) SS:
COUNTY OF LAKE)

Before me, the undersigned, a Notary Public in and for said County and State, this 12th day of June, 2006, personally appeared:

JOYCE M. HOLIFIELD and WILLIAM J. HOLIFIELD,
HUSBAND and WIFE

and acknowledged the execution of the foregoing deed. In witness whereof I have hereunto subscribed my name and affixed my official seal.

My Comm. Exp.: 25 June, 2007
Resident of LAKE County

Signature *[Signature]*
Printed Name STAR LUGAR

This instrument prepared by ATTY. JOSEPH S. IRAK, 9219 Broadway, M'ville, IN 46410
Atty. I.D. #4851-45 (219) 769-4552

MAIL TO: DULY ENTERED FOR TAXATION SUBJECT TO FINAL ACCEPTANCE FOR TRANSFER

JUN 20 2006

PEGGY HOUNGA KATONA
LAKE COUNTY RECORDER

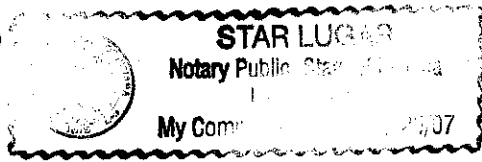

#18
CT
can

010182

LEGAL DESCRIPTION

Lot 521 in Foxwood Estates, Unit 8, an Addition to the Town of Schererville, as per plat thereof, recorded in Plat Book 76 page 76, in the Office of the Recorder of Lake County, Indiana, excepting therefrom that part described as follows: Beginning at the Southeast corner of said Lot 521; thence Northeasterly along a curve concave to the Southeast having a radius of 60 feet through a central angle of 22 degrees 24 minutes 54 seconds, an arc length of 24.18 feet; thence North 51 degrees 25 minutes 59 seconds West along and through a common wall of a duplex, a distance of 307.38 feet to a point on the North line of said Lot 521; thence South 89 degrees 17 minutes 08 seconds West along said North line of Lot 521, a distance of 51.57 feet to the Northwest corner of said Lot 521; thence South 00 degrees 27 minutes 42 seconds East along the Westerly line of said Lot 521, a distance of 92.72 feet to a corner of said Westerly line; thence South 28 degrees 50 minutes 43 seconds East along said Westerly line of Lot 521, a distance of 52.22 feet to the Southwest corner of said Lot 521; thence South 73 degrees 50 minutes 53 seconds East along the Southerly line of said Lot 521, a distance of 265.27 feet to the point of beginning.

