

2

STATE OF INDIANA
LAKE COUNTY
FILED FOR RECORD

2005 082002

2005 SEP 20 AM 8:35

ALVIN A. BRUNN
20050920

SATISFACTION OF MORTGAGE

This Certifies, That a certain Mortgage executed by DONALD J. HYLEK AND SUZETTE C. HYLEK, HUSBAND AND WIFE. This Security Instrument is given to LAKE MORTGAGE COMPANY, INC. on the 25TH day of MARCH 1994 calling for \$30,000.00 recorded in Mortgage Record No. Page No. Document # 94025314 LAKE COUNTY State of INDIANA has been fully paid and satisfied, and the same is hereby released.

WITNESS our hand(s) and seal(s) this 12TH day of SEPTEMBER 2005.

ATTEST:

Susan M. Bristow



Lake Mortgage Company, Inc.

[Signature]

SUSAN M. BRISTOW, SECRETARY

PETER BRIGGS II, ASST. VICE PRES.

State of Indiana, LAKE County. Before me, the undersigned, a Notary Public in and for said County, this 12TH day of SEPTEMBER 2005. Personally appeared Susan M. Bristow and Peter Briggs II respectively Secretary and Assistance Vice President acknowledged the execution of the annexed satisfaction of mortgage.

Witness my hand and official seal *Donna S. Rust* Donna S. Rust Notary Public.

My Commission expires 11/18/08 County Residence Lake. This instrument was prepared by: Jackie Eisfelder, Lake Mortgage Co. 4000 West Lincoln Hwy. Merrillville, IN 46410

LEGAL DESCRIPTION

PART OF THE WEST HALF OF THE SOUTHWEST QUARTER OF THE SOUTHEAST QUARTER OF SECTION 20, TOWNSHIP 34 NORTH, RANGE 9 WEST OF THE SECOND PRINCIPAL MERIDIAN, DECRIBED AS: COMMENCING AT A POINT ON THE SOUTH LINE OF SAID SECTION, 21 RODS EAST OF THE SOUTHWEST CORNER OF THE SOUTHEAST QUARTER THEREOF; THENCE NORTH PARALLEL WITH THE WEST LINE OF SAID SECTION, 15 RODS; THENCE EAST PARALLEL WITH THE SOUTH LINE OF SAID SECTION 11 RODS; THENCE SOUTH PARALLEL WITH THE

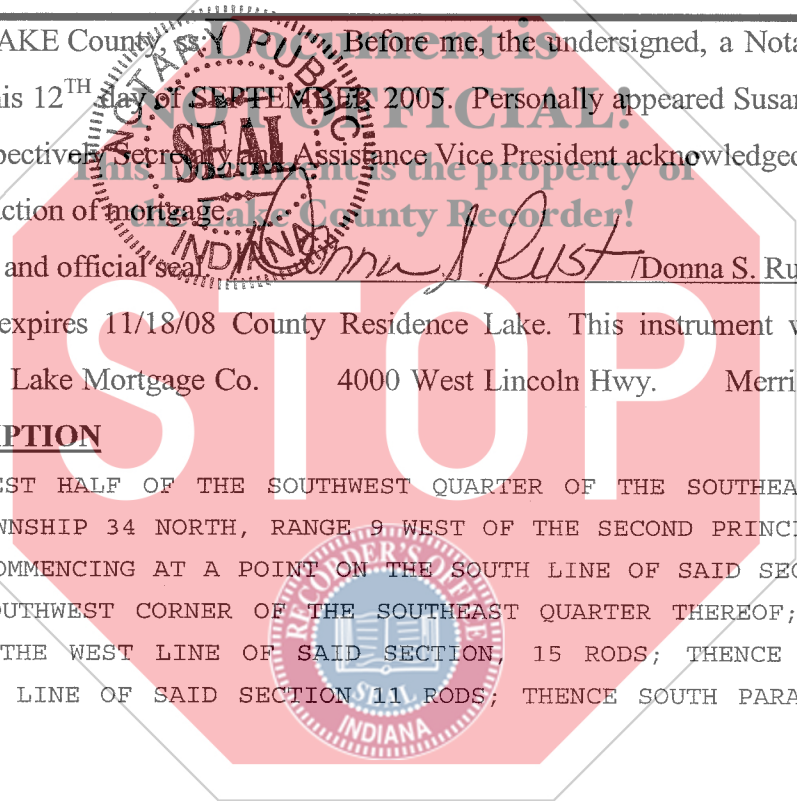

*ckh
136544
12
J.D.M.*

WEST LINE OF SAID SECTION 15 RODS TO THE SOUTH LINE THEREOF; THENCE WEST 11
RODS TO THE PLACE OF BEGINNING, IN LAKE COUNTY, INDIANA.

PTN# 05-06-0020-0010

58177/19812

