

STATE OF INDIANA  
LAKE COUNTY  
FILED FOR RECORD

2005 053507

2005 NOV 09 10:07 AM

WHEN RECORDED MAIL TO:

GLORIA J CARNEY  
2438 SHERMAN ST  
GARY, IN 46406



MICHAEL J. ...  
RECORDER

**SATISFACTION OF MORTGAGE**  
Indiana

KNOW ALL MEN BY THESE PRESENTS that STATE FARM FINANCIAL SERVICES FSB holder of a certain mortgage to secure the amount of \$20,000.00, whose parties, dates and recording information are below, does hereby acknowledge that it has received full payment and satisfaction of the same, and in consideration thereof, does hereby cancel and discharge said mortgage.

Original Mortgagor: **GLORIA J. CARNEY, A SINGLE PERSON**

Original Mortgagee: **STATE FARM FINANCIAL SERVICES FSB**

Dated: **OCTOBER 17, 2001**

Date Recorded: **NOVEMBER 5, 2001**

Book: **N/A**

Page: **N/A**

Document/Instrument #: **2001 089118**

Property Address: **2438 SHERMAN ST, GARY IN 46406**

Legal Description: **LOT NUMBERED 12 IN BLOCK 5, PARTWAY 2<sup>ND</sup>, AN ADDITION TO THE COUNTY OF LAKE AS PER PLAT THEREOF RECORDED IN PLAT BOOK 29, PAGE(S) 3, IN THE RECORDS IN THE OFFICE OF THE RECORDER OF LAKE COUNTY, INDIANA.**

Pin #: **41-49-0485-0012**

County: **LAKE County, State of INDIANA**

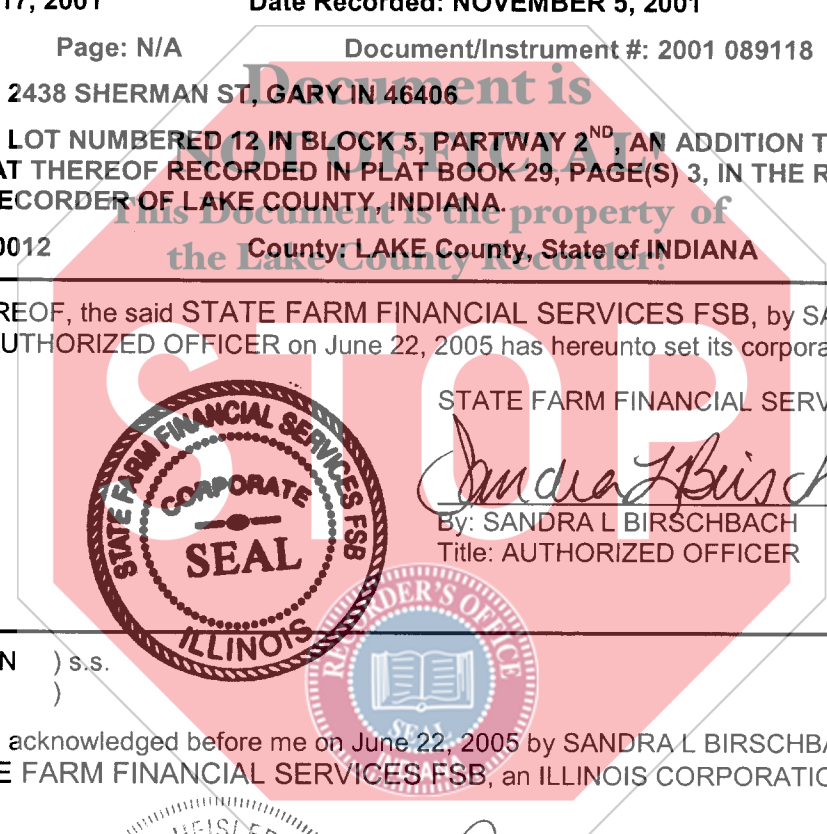

IN WITNESS WHEREOF, the said STATE FARM FINANCIAL SERVICES FSB, by SANDRA L BIRSCHBACH its AUTHORIZED OFFICER on June 22, 2005 has hereunto set its corporate name and seal.

{corporate seal}



STATE FARM FINANCIAL SERVICES FSB

*Sandra L Birschbach*

By: SANDRA L BIRSCHBACH  
Title: AUTHORIZED OFFICER

State of WISCONSIN ) s.s.  
County of DANE )

This instrument was acknowledged before me on June 22, 2005 by SANDRA L BIRSCHBACH, AUTHORIZED OFFICER of STATE FARM FINANCIAL SERVICES FSB, an ILLINOIS CORPORATION, on behalf of said corporation.

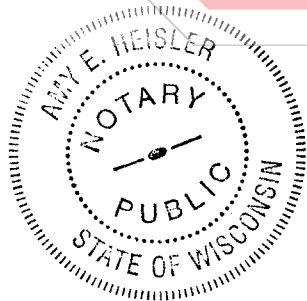

*Amy E Heisler*

AMY E HEISLER  
Notary Public, State of Wisconsin  
My commission expires 12-21-2008

Account No.: 085206626042-00001

This Instrument was Prepared By:

State Farm Bank  
PO Box 5961  
Madison, WI 53705-0961  
Anthony Hunt, Paid Loan Processor  
(877) 638-0158 x 5367

10.00  
Ck#  
343271  
9/2001  
D.J.M.