

STATE OF INDIANA
LAKE COUNTY
FILED FOR RECORD

2005 052486

2005 JUN 27 AM 9:05

MICHAEL A. BROWN
RECORDER

Parcel No. 25-44-15-30

WARRANTY DEED

ORDER NO. 920053648

THIS INDENTURE WITNESSETH, That Sharon Sledge

_____ (Grantor)
of Lake County, in the State of INDIANA CONVEY(S) AND WARRANT(S)
to Isaac Brooks

_____ (Grantee)
of Lake County, in the State of INDIANA, for the sum of _____
TEN AND 00/100 Dollars (\$ 10.00)

and other valuable consideration, the receipt and sufficiency of which is hereby acknowledged, the following described real estate in Lake County, State of Indiana:

Lots 15 and 16, Block 15, Gary Land Company's First Subdivision, in the City of Gary, as per plat thereof recorded in Plat Book 6 page 15, in the Office of the Recorder of Lake County, Indiana.

Subject to real estate taxes for 2004 due and payable in 2005 and thereafter. Subject to all covenants, conditions, restrictions, liens and easements of record.

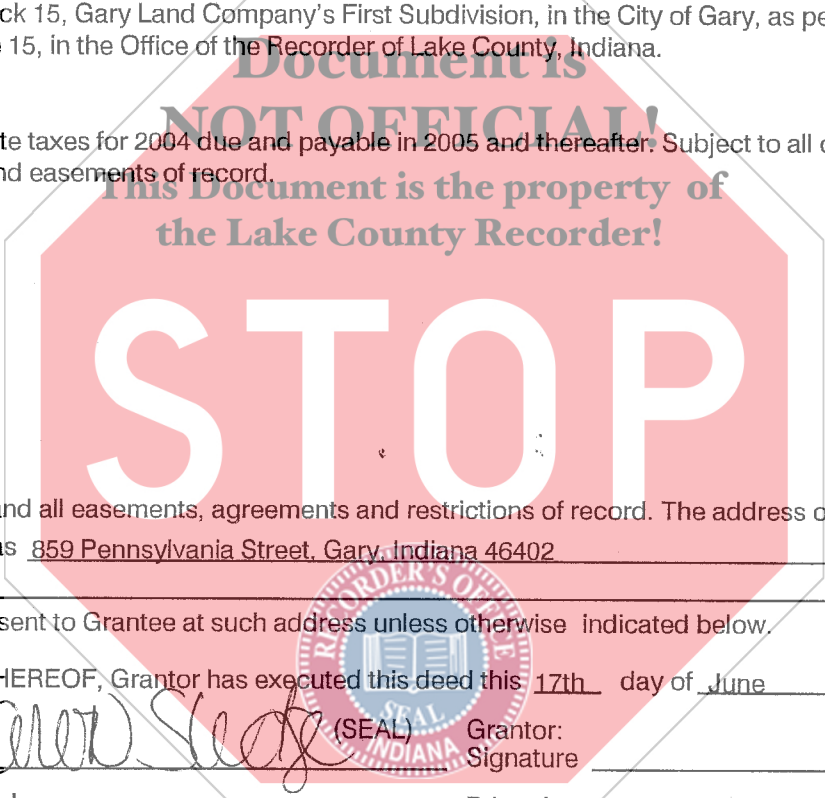

Subject to any and all easements, agreements and restrictions of record. The address of such real estate is commonly known as 859 Pennsylvania Street, Gary, Indiana 46402

Tax bills should be sent to Grantee at such address unless otherwise indicated below.

IN WITNESS WHEREOF, Grantor has executed this deed this 17th day of June, 2005.

Grantor: Sharon Sledge (SEAL) Grantor: _____ (SEAL)
Signature _____ Signature _____

Printed Sharon Sledge Printed _____

STATE OF INDIANA }
COUNTY OF Lake } SS: ACKNOWLEDGEMENT

Before me, a Notary Public in and for said County and State, personally appeared Sharon Sledge who acknowledge the execution of the foregoing Warranty Deed, and who, having been duly sworn, stated that any representations therein contained are true.

Witness my hand and Notarial Seal this 17th day of June, 2005.

My commission expires: DECEMBER 5, 2010

Signature: Ivette S. Westerman
Printed Ivette S. Westerman, Notary Name
Resident of Lake County, Indiana.

This instrument prepared by Attny. Mark S. Lucas, 300 E. 90th Dr., Merrillville, In 46410

Return deed to 859 Pennsylvania Street, Gary, Indiana 46402 7891 Chalice Road Severn, MD

Send tax bills to 859 Pennsylvania Street, Gary, Indiana 46402 7891 Chalice Road Severn, MD

TICOR MO
920053648

DULY ENTERED FOR TAXATION SUBJECT TO
FINAL ACCEPTANCE FOR TRANSFER

JUN 24 2005
STEPHEN R. STIGLICH
LAKE COUNTY AUDITOR

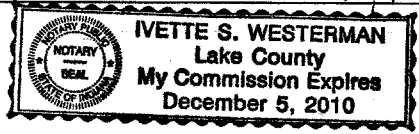

14-
2P
TI
01994