

3

2005 051943

STATE OF INDIANA
LAKE COUNTY
FILED FOR RECORD

2005 JUN 23 11:11 AM

MICHAEL A. STIGLICH
RECORDER

QUITCLAIM DEED

THIS INDENTURE WITNESSETH that Tim Fetsch Townhomes, LLC, an Indiana limited liability company ("Grantor"), QUITCLAIMS to Lake Central School Corporation, an Indiana political subdivision ("Grantee"), for the sum of Ten Dollars (\$10.00) and other valuable consideration, the receipt and sufficiency of which are hereby acknowledged, the real estate, together with all improvements attached thereto, in Lake County, State of Indiana described on the attached Exhibit A.

Grantor is a limited liability company duly organized under the laws of the State of Indiana, and the person executing this Quitclaim Deed on behalf of Grantor is fully empowered to execute and deliver this Quitclaim Deed on behalf of Grantor. Grantor has full capacity to convey the real estate described herein and all necessary action for the making of such conveyance has been taken and done.

IN WITNESS WHEREOF, the Grantor has caused this Quitclaim Deed to be executed this 7th day of ~~February~~ March, 2005.

NOT-TAXABLE

JUN 21 2005
STEPHEN R. STIGLICH
LAKE COUNTY AUDITOR

By: [Signature]
Printed: Tim Fetsch
Title: Manager

 **Metropolitan Title Company**
National Services Division
10355 Citation Drive
Brighton, MI 48116
Commercial Unit: (877) 514-6266
Residential Unit: (877) 514-2533



NU491513

001778

18⁰⁰
CA 56132
RM

STATE OF INDIANA)
 Lake) SS:
COUNTY OF HAMILTON)

Before me, a Notary Public in and for the State of Indiana, personally appeared Tim Fetsch, by me known to be the MANAGER of Tim Fetsch Townhomes, LLC, an Indiana limited liability company, and acknowledged the execution of the foregoing Quitclaim Deed on behalf of said limited liability company.

WITNESS my hand and Notarial Seal this 7 day of ~~February~~ ^{March}, 2005.

My Commission Expires:
6-13-07

Suzette Davis Young
Notary Public

My County of Residence:
LAKE

Suzette Davis Young
(Printed Signature)



Document is NOT OFFICIAL

This Document is the property of the Lake County Recorder!

This instrument was prepared by Thomas L. Kirsch, Thomas L. Kirsch & Associates, 131 Ridge Road, Munster, IN, 46321.

* 8260 Wicker Ave, Saint John, IN 46373
09-11-0328-0150
09-11-0007-0086
09-11-0007-0095

597105

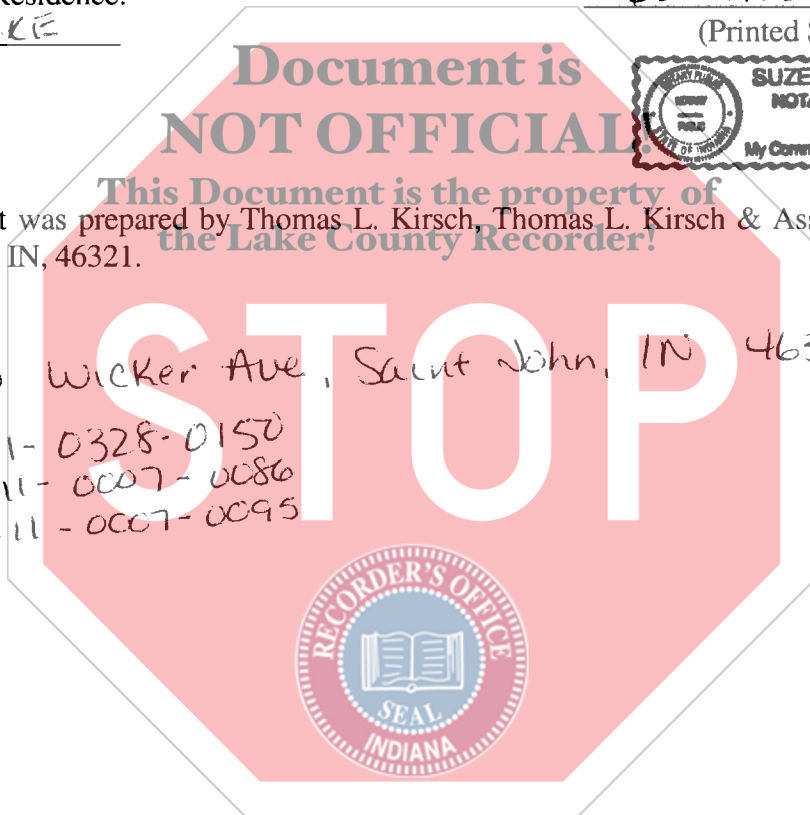

EXHIBIT A

Part of the Southeast Quarter (SE1/4) of the Northwest Quarter (NW1/4) of Section Thirteen (13), Township Thirty-Five (35) North, Range Nine (9) West of the Second Principal Meridian, in Lake County, Indiana, described as follows: Commencing at the Southeast (SE) corner of said Southeast Quarter (SE1/4) of the Northwest Quarter (NW1/4), thence North (N) on the East (E) line thereof a distance of 182.2 feet; thence Northwesterly on a line 20 feet Southwesterly from the Southwesterly Right of Way line of the Chicago and Erie Railroad, and parallel thereto, a distance of 744.0 feet; thence at right angles to the last line running in a Northeasterly direction, 20 feet, to the Southwesterly line of the Chicago and Erie Railroad; thence Northwesterly along said Right of Way line to the center line of State Road #330 a distance of 206.9 feet thence Westerly along the center line of State Road #330 a distance of 330.85 feet; thence Southwesterly at an angle of $86^{\circ}25'$ with the center line of State Road #330 a distance of 255.46 feet; thence Southwesterly at an angle of $0^{\circ}36'$ right of last line prolonged, 1009.12 feet to the South line of the Southeast Quarter (SE1/4) of the Northwest Quarter (NW1/4) of said Section Thirteen (13), thence East (E) on said South (S) line, 1209.12 feet to the place of beginning.

and

All that part of the Northeast Quarter of the Northwest Quarter lying Southwesterly of State Road #330, all in Section 13, Township 35 North, Range 9 West of the Second Principal Meridian, in Lake County, Indiana, Also, Part of the Southeast Quarter of the Northwest Quarter of Section 13, Township 35 North, Range 9 West of the Second Principal Meridian, Lake County, Indiana, more particularly described as follows: Commencing at the Southeast corner of the Northwest Quarter of said Section 13; thence West along the South line of said Northwest Quarter a distance of 1315.12 feet measured to the point of beginning; thence North on the West line of said Southeast Quarter of the Northwest Quarter of Section 13, a distance of 1320.8 feet to the North line of the Southeast Quarter of the Northwest Quarter; thence East along the North line of the Southeast Quarter of the Northwest Quarter a distance of 264.6 feet to a point in the center line of Lincoln Highway thence Southeasterly along the center line of the Lincoln Highway for a distance of 355.0 feet to a point; thence Southwesterly with an external angle of 87 degrees 39 minutes a distance of 255.46 feet; thence Southwesterly deflecting 0 degrees 36 minutes to the right, a distance of 1009.12 feet to a point in the South line of the Northwest Quarter which is also 1209.12 feet West of the Southeast corner of the Northwest Quarter, thence West along the South line of the Northwest Quarter a distance of 106 feet to the point of beginning.