

2

STATE OF INDIANA  
LAKE COUNTY  
FILED FOR RECORD

2005 051723

2005 JUN 23 AM 9:50

MICHAEL J. HOWARD  
RECORDED

**SATISFACTION OF MORTGAGE**

This Certifies, That a certain Mortgage executed GEORGE WEBER AND PEGGY L. WEBER, HUSBAND AND WIFE to Lake Mortgage Company, Inc. on 27<sup>th</sup> FEBRUARY, 2003 calling for \$104,900.00 recorded in Mortgage Record No.      page      Document 2003 021859 LAKE County State of INDIANA has been fully paid and satisfied, and the same is hereby released.

ATTEST: With my hand and seal(s), this 1<sup>st</sup> day of JUNE, 2005.

ATTEST:  Susan M. Bristow  
SUSAN M. BRISTOW, SECRETARY

Lake Mortgage Company, Inc.  
BY: Michael J. Howard  
MICHAEL J. HOWARD, TREASURER

State of Indiana, LAKE County, ss: Before me, the undersigned, a Notary Public in and for said County, this 1<sup>st</sup> day of JUNE, 2005 Personally appeared Susan M. Bristow and Michael J. Howard, respectively Secretary and Treasurer, acknowledged the execution of the annexed satisfaction of mortgage. This Document is the property of Lake County Recorder!  
Donna S. Rust / Donna S. Rust Notary Public.  
My Commission expires 11/18/08 County Residence Lake. This instrument was prepared by: Erica Eitel / Indiana Mortgage Co. 4000 West Lincoln Hwy. Merrillville, IN 46410

**LEGAL DESCRIPTION**

SEE ATTACHED

PTN# 02-03-0057-0030

506577/19638

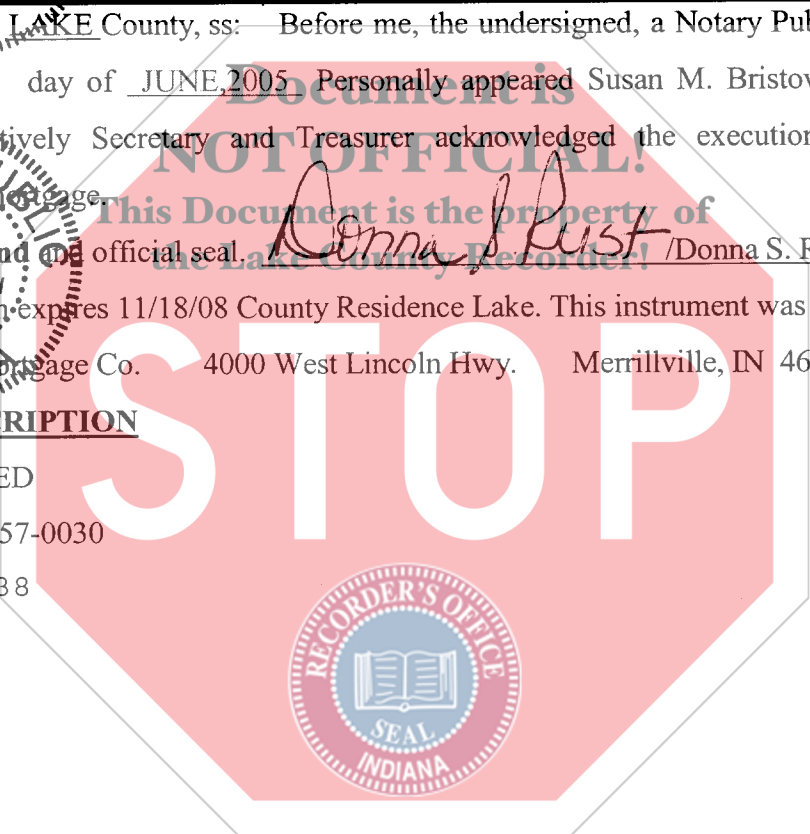

12-2  
OK  
136243

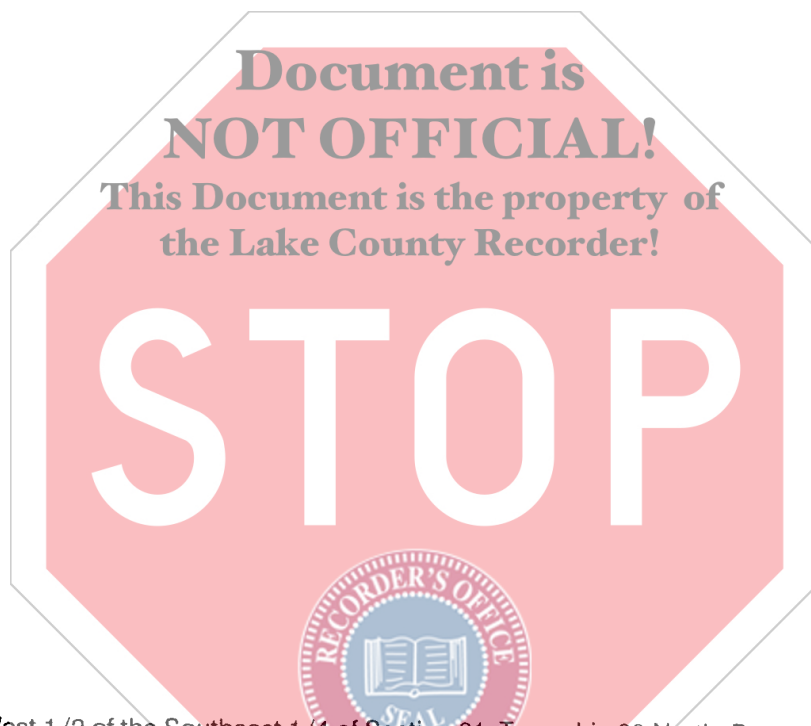

Part of the West 1/2 of the Southeast 1/4 of Section 21, Township 33 North, Range 8 West of the Second Principal Meridian in Lake County, Indiana, more particularly described as follows: Commencing at the Southwest corner of said West 1/2 of the Southeast 1/4; thence North 89 degrees 55 minutes 49 seconds East along the South line of said Southeast 1/4 a distance of 513.46 feet to the Point of Beginning; thence continue along said South line North 89 degrees 55 minutes 49 seconds East 149.37 feet to the East line of the West 1/2 of said West 1/2 of the Southeast 1/4; thence North 01 degrees 25 minutes 18 seconds West along said East line a distance of 361.72 feet; thence South 89 degrees 55 minutes 49 seconds West parallel with the South line of said West 1/2 of the Southeast 1/4 a distance of 157.51 feet; thence South 02 degrees 42 minutes 40 seconds East a distance of 362.00 feet to the Point of Beginning