

Return to: \_\_\_\_\_

8130 Havenwood Pass

Cedar Lake, Ind. 46303

2005 000970

OFFICE OF CLERK  
LAKE COUNTY  
FILED FOR RECORD

2005 JUN 21 10:01 AM

MICHAEL J. ...  
REC'D

Warranty

**THIS INDENTURE  
WITNESSETH**

That THOMAS D. SPRINGFIELD and

CAROL A. SPRINGFIELD, his wife

of Lake County, and State of Indiana

**CONVEY AND WARRANT**

To JOHN GAWRYS

of Lake County, in the State of Indiana

For the sum of -----TEN and 00/100-----dollars the following described REAL ESTATE in Lake County, in the State of Indiana, to-wit:

Lot 99 in Havenwood Subdivision Unit One, as addition to the Town of Cedar Lake, as per plat thereof, recorded in Plat Book 78, Page 27, in the Office of the Recorder of Lake County, Indiana, and amended by a "Certificate of Correction" recorded May 30, 1995 as Document No. 95030324.

X Key no. 30-24-0191-0018

Commonly known as: 8130 Havenwood Pass, Cedar Lake, IN 46303

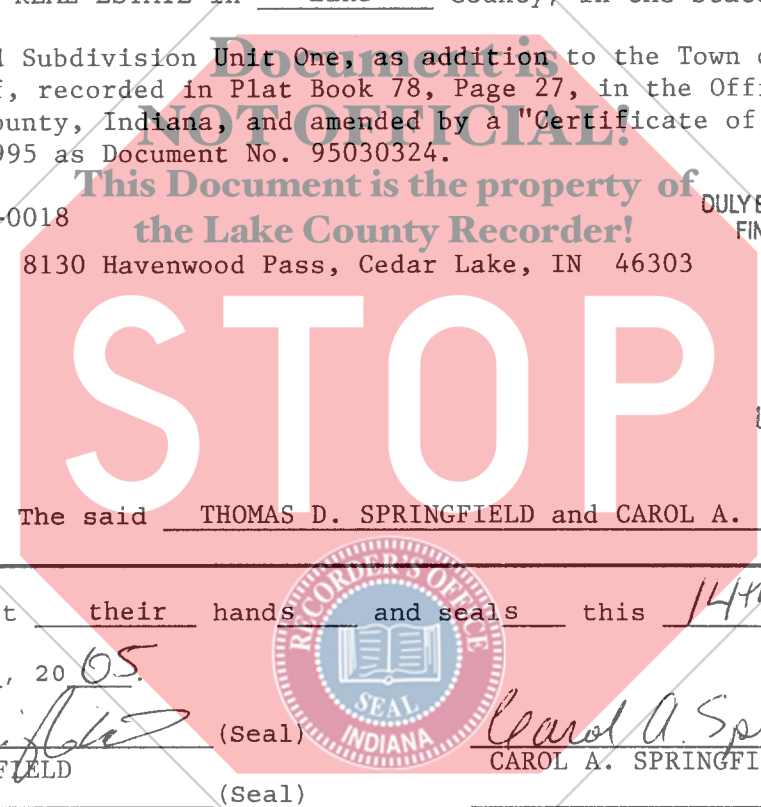

DULY ENTERED FOR TAXATION SUBJECT TO FINAL ACCEPTANCE FOR TRANSFER

JUN 21 2005

STEPHEN R. STIGLICH  
LAKE COUNTY AUDITOR

IN WITNESS WHEREOF, The said THOMAS D. SPRINGFIELD and CAROL A. SPRINGFIELD, his wife

Have hereunto set their hands and seals this 14th day of

May, 20 05.

Thomas D. Springfield (Seal)  
THOMAS D. SPRINGFIELD (Seal)

Carol A. Springfield (Seal)  
CAROL A. SPRINGFIELD (Seal)

STATE OF ~~INDIANA~~ <sup>ILLINOIS</sup>, ~~LAKE~~ <sup>COOK</sup> County, SS:

Before me, the undersigned, a Notary Public in and for said county and State, personally appeared the within named Thomas D. Springfield and Carol A. Springfield, \* who acknowledged the execution of the foregoing Deed to be their voluntary act and deed. \*his wife

WITNESS, my hand and Seal this 14th day of May, 20 05.

My commission expires \_\_\_\_\_, 20\_\_\_\_\_.

Kathleen A. Veldhuizen  
Notary Public

County of Residence COOK

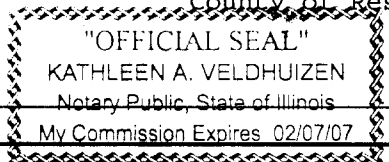

Mail Tax Statements to \_\_\_\_\_

This instrument prepared by Thomas D. Springfield, 8130 Havenwood Pass, Cedar Lake, IN 46303

**HOLD FOR MERIDIAN TITLE CORP**

1608LK05

01700

14.0  
M