

STATE OF INDIANA
LAKE COUNTY
FILED FOR RECORD

2005 050509

2005 JUN 20 AM 10: 21

MICHAEL A. BROWN
RECORDER

WHEN RECORDED, MAIL TO:
FIRST SUBURBAN MORTGAGE CORPORATION
450 EAST 22ND STREET, SUITE 170
LOMBARD, ILLINOIS 60148

This Instrument Prepared By:

Order Number:
Escrow Number: IN
Application Number: 151-7869707 703
Loan Number: 1844229200

[Space Above This Line For Recorder's Use]

Corporation Assignment of Mortgage

FOR VALUE RECEIVED, FIRST SUBURBAN MORTGAGE CORPORATION

having its principal place of business at 450 EAST 22ND STREET, SUITE 170, LOMBARD, ILLINOIS 60148 ("Assignor"),

hereby grants, assigns and transfers to JPMORGAN CHASE BANK, N.A., 1111 POLARIS PARKWAY COLUMBUS, OH 43240 ("Assignee")

all of Assignor's rights, title and interest in, to, and under that certain Mortgage dated JUNE 15, 2005 executed and delivered by LUCIANO C TALAVERA, ~~MARRIED TO ELIZABETH TALAVERA~~

and recorded either _____, Mortgagor,

concurrently herewith; or
 as Instrument No. _____ on _____ in book _____, page _____, County, _____

of Official Records in the County Recorder's office of LAKE _____ covering certain real estate and other property described therein, more particularly described as follows:

LOT 127 IN PRAIRIE ESTATES-PHASE 2, UNIT 3, AN ADDITION TO THE TOWN OF SCHERVILLE, INDIANA. **AS PER PLAT THEREOF, RECORDED IN PLAT BOOK 95 PAGE 67, IN THE OFFICE OF THE RECORDER OF LAKE COUNTY, INDIANA. A.P.N. #: 13-597-3 **SCHERVILLE

TOGETHER with the note or notes therein described or referred to therein and secured thereby, the money due and to become due thereon with interest, and all rights accrued or to accrue under said Mortgage.

TICOR TITLE - SCHERVILLE 920053469

Mtg 2005-050509

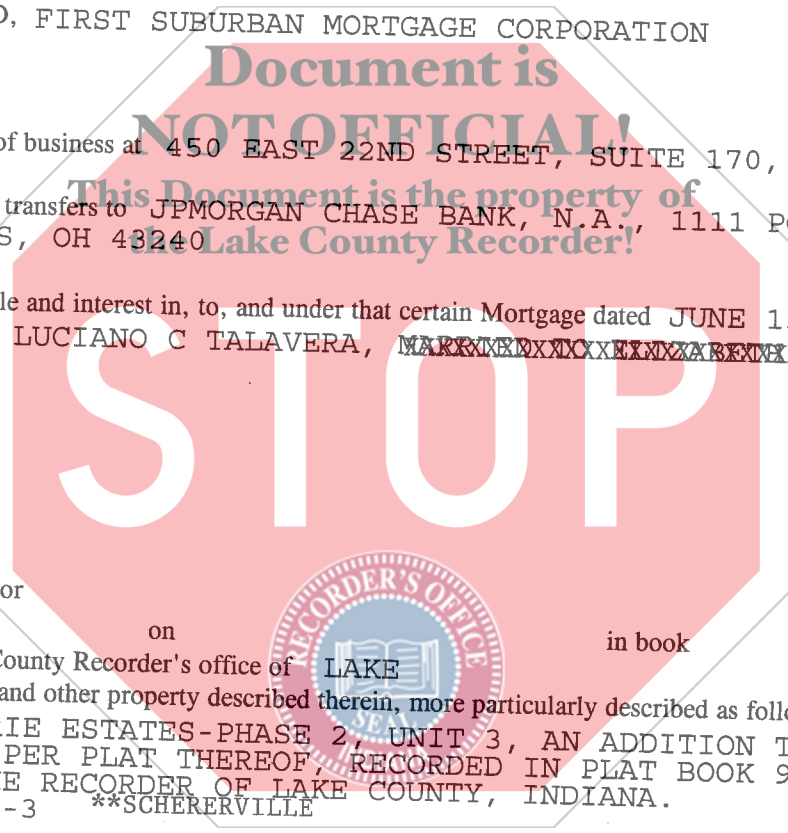

12-
20
TI

IN WITNESS WHEREOF, Assignor has caused this Corporation Assignment of Mortgage to be executed by its duly authorized officer as of the day and year first written below.

FIRST SUBURBAN MORTGAGE CORPORATION, AN ILLINOIS CORPORATION

STATE OF ILLINOIS

Elaine Benes

COUNTY OF DUPAGE SS.

ELAINE BENES
CLOSING MANAGER

On JUNE 15, 2005 before me,

SUSAN VENTURA Notary Public,
personally appeared ELAINE BENES, CLOSING MANAGER

personally known to me (or proved to me on the basis of satisfactory evidence) to be the person(s) whose name(s) is/are subscribed to the within instrument and acknowledged to me that he/she/they executed the same in his/her/their authorized capacity(ies), and that by his/her/their signature(s) on the instrument the person(s), or the entity upon behalf of which the person(s), acted, executed the instrument.

WITNESS my hand and official seal.

Signature

Susan Ventura

SUSAN VENTURA
Name (Typed or Printed)
Notary Public in for said State



(Seal)

"OFFICIAL SEAL"
SUSAN VENTURA
Notary Public, State of Illinois
My Commission Expires 01/24/2007

(This area for official notarial seal)