



2005 049453

STATE OF INDIANA  
LAKE COUNTY  
FILED FOR RECORD

2005 JUN 15 PM 4:05

MICHAEL A. BROWN  
RECORDER

THIS FORM HAS BEEN PREPARED FOR USE IN THE STATE OF INDIANA BY LAWYERS ONLY. SELECTING A FORM OF INSTRUMENT, FILLING IN BLANK SPACES, STRIKING OUT PROVISIONS AND INSERTING SPECIAL CLAUSES MAY CONSTITUTE THE PRACTICE OF LAW, WHICH SHOULD BE PERFORMED ONLY BY A LAWYER.

MAIL TAX BILLS TO:

# QUITCLAIM DEED

THIS INDENTURE WITNESSETH, that Supan K. Hall

GRANTOR(S) of Lake County in the State of Indiana

QUITCLAIM(S) to Alvin B. Hall ←

GRANTEE(S) of Lake County in the State of Indiana

in consideration of One Dollar (\$1.00) and other valuable consideration, the receipt and sufficiency of which are hereby acknowledged, the following described real estate in Lake County, in the State of Indiana:

Lots 18 and 19 in Block 11 in Carlson's First Addition to East Gary, as Per Plat Thereof, Recorded in Plat Book 11 Page 5, In the Office of the Recorder of Lake County, Indiana.

More Commonly Known As: 2775 Vanderburg Street, Lake Station, IN

Key #  
19-21-18  
19-21-19

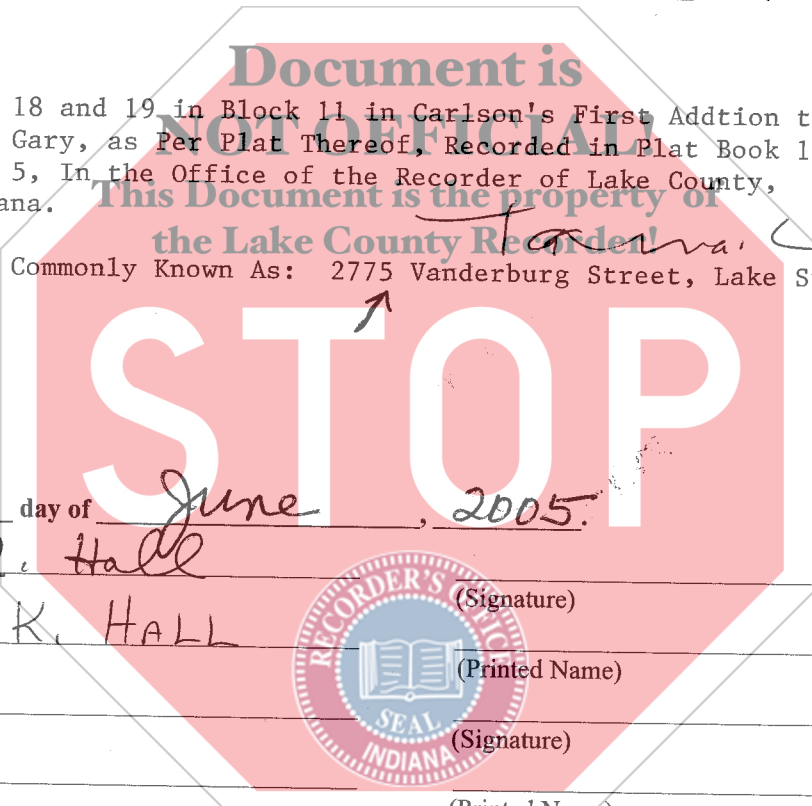

Dated this 11th day of June, 2005.

X Supan K. Hall  
(Signature)

SUPAN K. HALL  
(Printed Name)

(Signature)

(Printed Name)

(Signature)

(Printed Name)

(Signature)

(Printed Name)

STATE OF INDIANA, COUNTY OF Porter SS:

Before me, the undersigned, a Notary Public in and for said County and State, this 11th day of June, 2005 personally appeared: Supan K. Hall

and acknowledged the execution of the foregoing deed. In witness whereof, I have hereunto subscribed my name and affixed my official seal.

My commission expires: 1-21-07

Signature Barbara J. Hall

Resident of Porter

County Printed BARBARA J. HALL Notary Public

This instrument prepared by Keith F. Medved, Attorney at Law

Attorney No. 9866-45

MAIL TO:



© COPYRIGHT 1997, THE ALLEN COUNTY INDIANA BAR ASSOCIATION, INC. (REV. 2/97, 6/99)  
DULY ENTERED FOR TAXATION SUBJECT TO FINAL ACCEPTANCE FOR TRANSFER

JUN 15 2005

STEPHEN R. STIGLICH  
LAKE COUNTY AUDITOR

001332

CS  
1400  
AS