

2005 049118

2005 JUN 15 AM 9:20

Parcel No. 25-45-315-9

MICHAEL A. BOWMAN
RECORDER

WARRANTY DEED

ORDER NO. 920053390

THIS INDENTURE WITNESSETH, That Catherine L. Bowman

of Lake County, in the State of INDIANA (Grantor)
CONVEY(S) AND WARRANT(S)
to Roosevelt Bradley, Jr. and Lafonda A. Bradley, husband and wife

of Lake County, in the State of INDIANA (Grantee)
, for the sum of TEN AND 00/100 Dollars (\$ 10.00)

and other valuable consideration, the receipt and sufficiency of which is hereby acknowledged, the following described real estate in Lake County, State of Indiana:

Lots 9 and 10, Block 1, Lincoln Park Addition, in the City of Gary, as per plat thereof, recorded in Plat Book 6 page 17, in the Office of the Recorder of Lake County, Indiana.

Subject to real estate taxes for 2004 due and payable in 2005 and thereafter.

Subject to all covenants, conditions, restrictions, liens and easements of record.

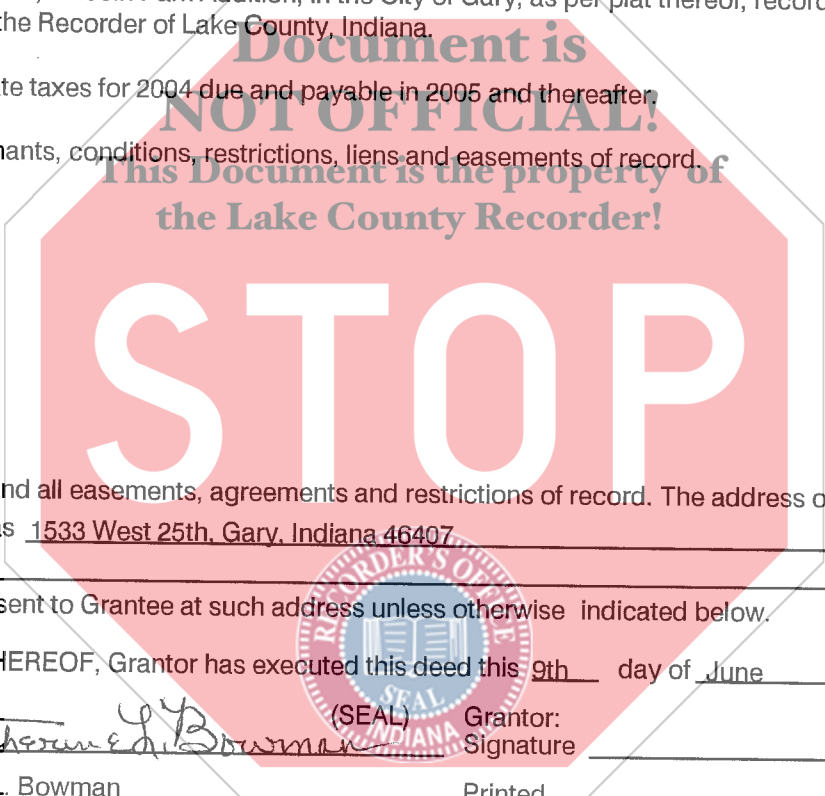

Subject to any and all easements, agreements and restrictions of record. The address of such real estate is commonly known as 1533 West 25th, Gary, Indiana 46407.

Tax bills should be sent to Grantee at such address unless otherwise indicated below.

IN WITNESS WHEREOF, Grantor has executed this deed this 9th day of June, 2005.

Grantor: Catherine L. Bowman (SEAL) Grantor: _____ (SEAL)
Signature _____ Signature _____

Printed Catherine L. Bowman Printed _____

STATE OF INDIANA }
COUNTY OF Lake } SS: ACKNOWLEDGEMENT

Before me, a Notary Public in and for said County and State, personally appeared Catherine L. Bowman who acknowledge the execution of the foregoing Warranty Deed, and who, having been duly sworn, stated that any representations therein contained are true.

Witness my hand and Notarial Seal this 9th day of June, 2005.

My commission expires: OCTOBER 2, 2009

Signature Paula Barrick
Printed PAULA BARRICK, Notary Name
Resident of LAKE County, Indiana.

This instrument prepared by Attny. Mark S. Lucas, 300 E. 90th Dr., Merrillville, In 46410
4120 W. 15th Ave., Gary, IN 46404
Return deed to 1533 West 25th, Gary, Indiana 46407
4120 W. 15th Ave., Gary, IN 46404
Send tax bills to 1533 West 25th, Gary, Indiana 46407

DULY ENTERED FOR TAXATION SUBJECT TO
FINAL ACCEPTANCE FOR TRANSFER

JUN 14 2005

STEPHEN R. STIGLICH
LAKE COUNTY AUDITOR

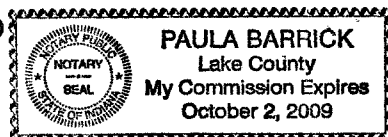

TICOR M001112

Handwritten initials: 14- ZP TI