

STATE OF INDIANA
LAKE COUNTY
FILED FOR RECORD

2005 048280

2005 JUN 10 AM 9:05

WARRANTY DEED

Mail tax bills to: 4615 Towle Avenue, Hammond, Indiana 46327

THIS INDENTURE WITNESSETH, That Ricky R. Martinez and Patricia A. Martinez, husband and wife ("Grantors"), of Lake County in the State of Indiana **CONVEYS AND WARRANTS TO** Earlina Mayo of Lake County in the State of Indiana in consideration of One Dollar (\$1.00) and other valuable consideration, the receipt and sufficiency of which are hereby acknowledged, the following described real estate in Lake County, in the State of Indiana:

Lot 8 and the North 1/2 of Lot 9 in Block 12 in Subdivision of the East part of the North Side Addition to the City of Hammond, as per plat thereof, recorded in Plat Book 1 page 97, in the Office of the Recorder of Lake County, Indiana.

Commonly known as: 4615 Towle Avenue, Hammond, Indiana 46327

Tax Property No.: 35-156-7

Subject to past and current year real estate taxes

Subject to easements, restrictions, and covenants of record, if any.

Dated this 6th day of June, 2005

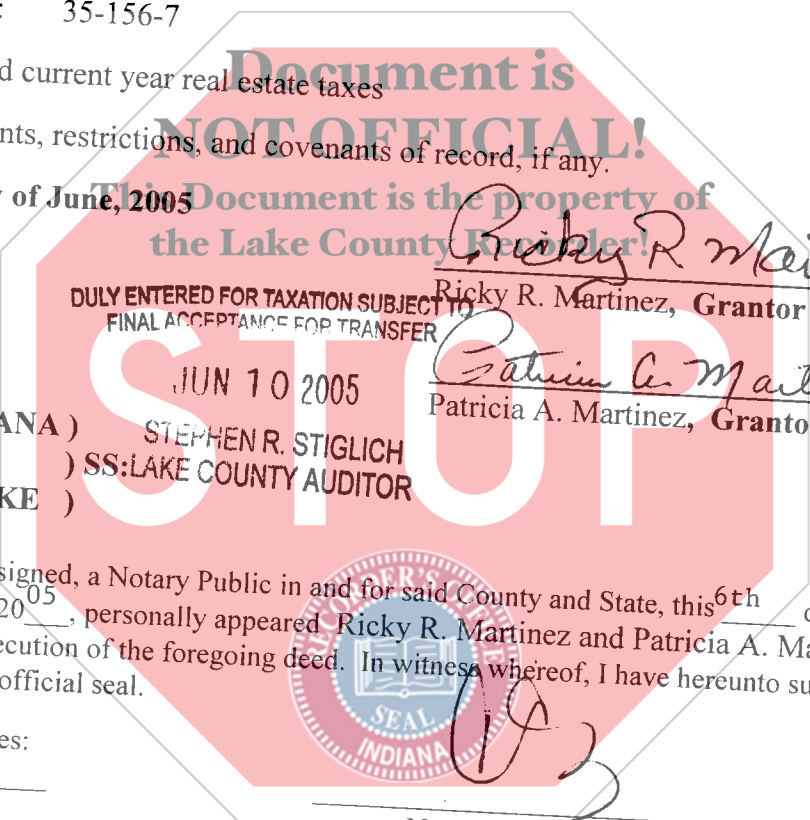

Ricky R Martinez
Ricky R. Martinez, Grantor
Patricia A. Martinez
Patricia A. Martinez, Grantor

STATE OF INDIANA)
) SS: LAKE COUNTY AUDITOR
COUNTY OF LAKE)

Before me, the undersigned, a Notary Public in and for said County and State, this 6th day of June, 2005, personally appeared Ricky R. Martinez and Patricia A. Martinez and acknowledged the execution of the foregoing deed. In witness whereof, I have hereunto subscribed my name and affixed my official seal.

My commission expires: 5/16/09

Resident of Lake County

Notary Signature
Corina Castel Ramos
Printed Notary Name



This instrument prepared by:

Marge E. Breclaw
Attorney I.D. No. 20810-45
735 West Glen Park Avenue
Griffith, Indiana 46319
(219) 934-9344

9-20053675

TICOR TITLE INSURANCE
2050-45TH AVE.
HIGHLAND, IN 46322

1400
00915 CP