

2

STATE OF INDIANA
LAKE COUNTY
FILED FOR RECORD

2005 048044

2005 JUN 10 AM 11:06

Mail Tax Bills to:
Betty A. Williams
6730 E. 85th Ct
Merrillville, IN 46410

PERSONAL REPRESENTATIVE'S DEED

MICHAEL A. TROWN
RECORDER

MTC - 1411K05

Elizabeth LaBorde, Personal Representative of the Estate of Robert L. Soltis, deceased, which estate is pending in the Lake Circuit Court under Cause Number 45CO1-0412-ED-171, by virtue of their power and authority granted to Administrators under the Indiana Code proceeding under Unsupervised Administration, and for good and sufficient consideration, conveys and warrants to:

BETTY A. WILLIAMS

the following described real estate in Lake County, State of Indiana, to-wit:

Lots Numbered 7 and 8 as shown on the recorded plat of Ross Meadow Farms recorded in Plat Book 47 page 45 in the Office of the Recorder of Lake County, Indiana. Parcel No. 08-15-0472-0007

* 08-15-0472-0008

Commonly known as 6730 E. 85th Court, Merrillville, IN 46410.

Subject to real estate taxes for 2005 due and payable in 2006 and thereafter.

Subject to all covenants, conditions, restrictions, liens and easements of record.

IN WITNESS WHEREOF, the said Elizabeth LaBorde, Personal Representative of the Estate of Robert L. Soltis, has hereunto set her hand and seal this 28 day of May, 2005.

Elizabeth LaBorde
Elizabeth LaBorde, Personal Representative of the Estate of Robert L. Soltis

HOLD FOR MERIDIAN TITLE CORP

1411K05

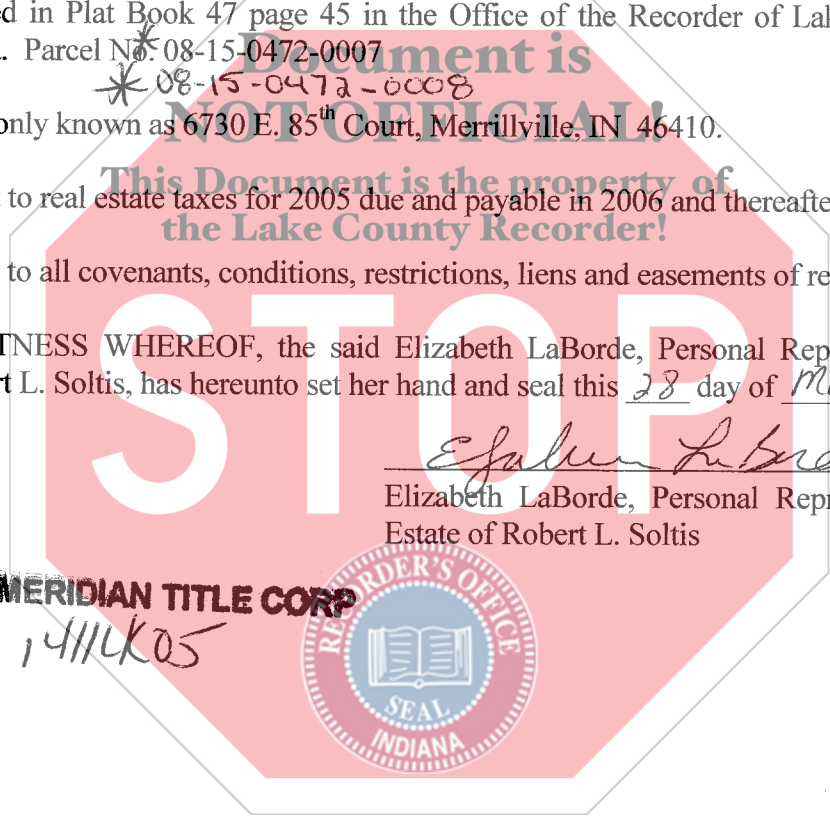

DULY ENTERED FOR TAXATION SUBJECT TO
FINAL ACCEPTANCE FOR TRANSFER

JUN 10 2005

STEPHEN R. STIGLICH
LAKE COUNTY AUDITOR

16-
ZP
MT

00939

STATE OF INDIANA)
)
) SS:
 COUNTY OF LAKE)

Before me the undersigned, a Notary Public for Lake County, State of Indiana, came Elizabeth LaBorde and acknowledged the execution of this Deed to be her voluntary act and deed for the uses and purposes expressed therein.

WITNESS MY HAND AND SEAL this 28 day of May, 2005.

My commission expires: _____
 Resident of Lake County Amanda Podnar, Notary Public

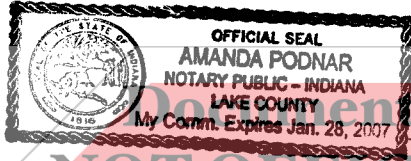

PREPARED BY: MARK S. LUCAS, 300 E. 90th DR., MERRILLVILLE, IN 46410

