

STATE OF INDIANA
LAKE COUNTY
FILED FOR RECORD

2005 047785

2005 JUN 10 AM 9:16

MICHAEL A. BROWN
RECORDER

WHEN RECORDED, MAIL TO:
MORTGAGE EXPRESS, INC.
7200 SOUTH 84TH STREET
LAVISTA, NEBRASKA 68128

This Instrument Prepared By: Angela Ramirez

Order Number:
Escrow Number:
Application Number:
Loan Number: LBM-6478256-78

[Space Above This Line For Recorder's Use]

1. Corporation Assignment of Mortgage

FOR VALUE RECEIVED, MORTGAGE EXPRESS, INC.

having its principal place of business at 7200 SOUTH 84TH STREET, LAVISTA, NEBRASKA 68128 ("Assignor"),

hereby grants, assigns and transfers to LONG BEACH MORTGAGE COMPANY, 1400 DOUGLAS ROAD, SUITE 100, ANAHEIM, CA 92806

("Assignee")

all of Assignor's rights, title and interest in, to, and under that certain Mortgage dated JUNE 1, 2005 executed and delivered by ASANTE M BROOKS AND BRANDY BROOKS H & W JTWROS

, Mortgagor,

and recorded either

concurrently herewith; or

as Instrument No.

on

in book

, page

County,

of Official Records in the County Recorder's office of LAKE

covering certain real estate and other property described therein, more particularly described as follows:

LOT 2 IN AUTUMN CREEK BLOCK 8, PHASE 2, AN ADDITION TO THE TOWN OR SCHEREVILLE, AS PER PLAT THEREOF, RECORDED IN PLAT BOOK 94 PAGE 99, IN THE OFFICE OF THE RECORDER OF LAKE COUNTY, INDIANA.
A.P.N. #: 13-127-13

TOGETHER with the note or notes therein described or referred to therein and secured thereby, the money due and to become due thereon with interest, and all rights accrued or to accrue under said Mortgage.

Mtg 2005-047785

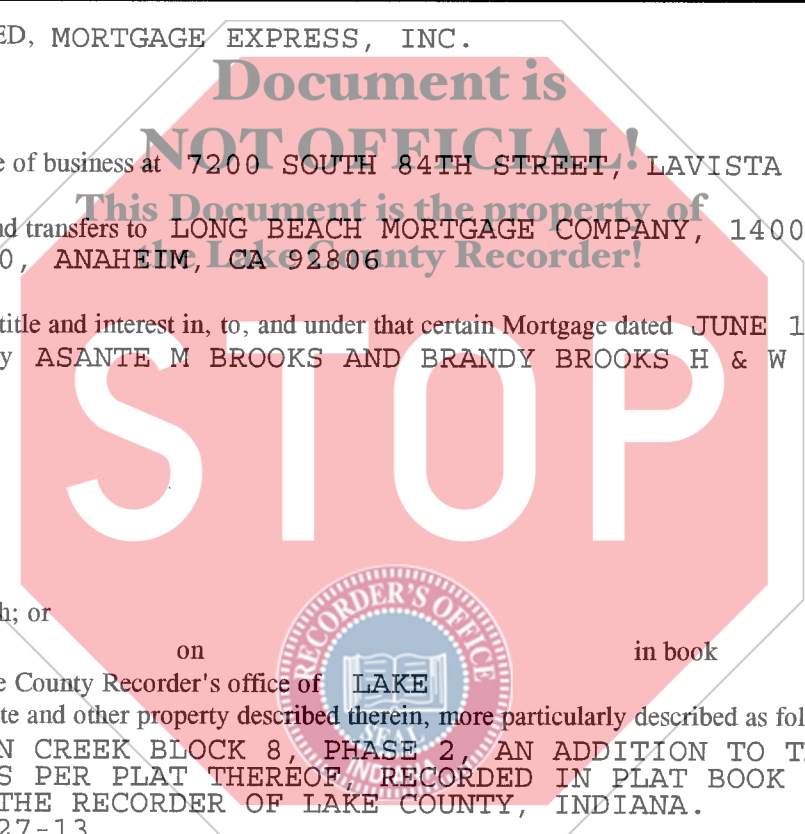

TICOR CP

920052822

12-
ZP
TI



IN WITNESS WHEREOF, Assignor has caused this Corporation Assignment of Mortgage to be executed by its duly authorized officer as of the day and year first written below.

STATE OF ~~INDIANA~~ Nebraska

COUNTY OF ~~LAKE~~ Douglas SS.

On JUNE 1ST 2005 before me,

ANGELA RAMIREZ Notary Public,

personally appeared

MELINDA REEDER, GENERAL MANAGER

personally known to me (or proved to me on the basis of satisfactory evidence) to be the person(s) whose name(s) is/are subscribed to the within instrument and acknowledged to me that he/she/they executed the same in his/her/their authorized capacity(ies), and that by his/her/their signature(s) on the instrument the person(s), or the entity upon behalf of which the person(s), acted, executed the instrument.

WITNESS my hand and official seal.

Signature

[Handwritten signature of Angela Ramirez]

ANGELA RAMIREZ

Name (Typed or Printed)
Notary Public in for said State

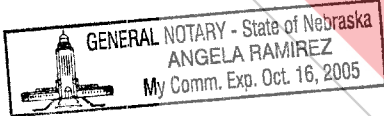

(Seal)

[Handwritten signature of Melinda Reeder]
MELINDA REEDER, GENERAL MANAGER

(This area for official notarial seal)

