

STATE OF INDIANA
LAKE COUNTY
FILED FOR RECORD

2005 047322

2005 JUN -9 AM 9:17

Parcel No. (20)13-465-16

WARRANTY DEED

MICHAEL A. BROWN
RECORDER

ORDER NO. 920053688

THIS INDENTURE WITNESSETH, That Michael L. Wolfe and Sherrill A. Wolfe, husband and wife

of Lake County, in the State of INDIANA CONVEY(S) AND WARRANT(S)
to Michael G. Poch

of Lake County, in the State of INDIANA, for the sum of TEN AND 00/100 Dollars (\$ 10.00)

and other valuable consideration, the receipt and sufficiency of which is hereby acknowledged, the following described real estate in Lake County, State of Indiana:

SUBJECT TO REAL ESTATE TAXES FOR 2004 PAYABLE 2005 TOGETHER WITH ANY DELINQUENCY AND PENALTY, IF ANY, AND ALL REAL ESTATE TAXES DUE AND PAYABLE THEREAFTER.

Lot 98 in Country Hills Estates, Unit 3, in the Town of Schererville, as per plat thereof, recorded in Plat Book 66 page 32, in the Office of the Recorder of Lake County, Indiana.

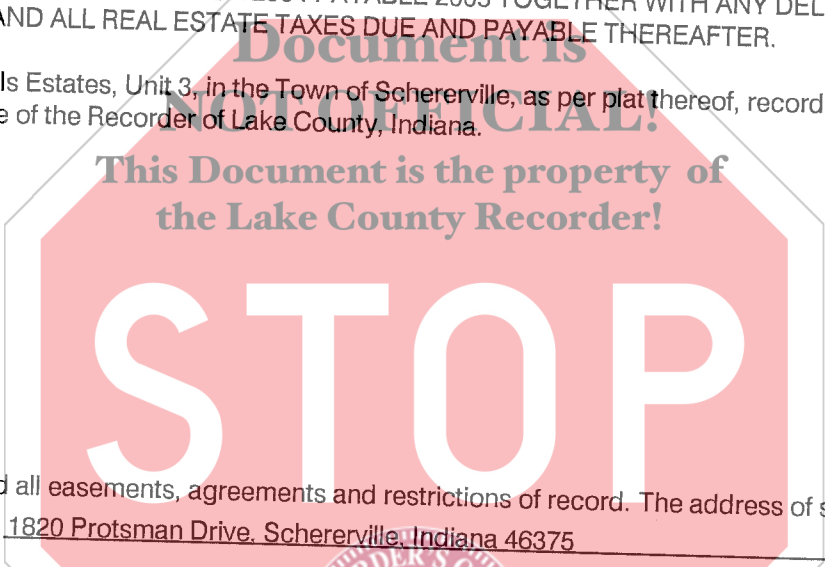

Subject to any and all easements, agreements and restrictions of record. The address of such real estate is commonly known as 1820 Protsman Drive, Schererville, Indiana 46375

Tax bills should be sent to Grantee at such address unless otherwise indicated below.

IN WITNESS WHEREOF, Grantor has executed this deed this 3rd day of June, 2005.

Grantor:
Signature [Signature]
Printed Michael L. Wolfe

(SEAL)

Grantor:
Signature [Signature]
Printed Sherrill A. Wolfe

(SEAL)

STATE OF INDIANA
COUNTY OF Lake

} SS: ACKNOWLEDGEMENT

Before me, a Notary Public in and for said County and State, personally appeared Michael L. Wolfe and Sherrill A. Wolfe, husband and wife who acknowledge the execution of the foregoing Warranty Deed, and who, having been duly sworn, stated that any representations therein contained are true.

Witness my hand and Notarial Seal this 3rd day of June, 2005.

My commission expires:
AUGUST 31, 2006

Signature [Signature]
Printed DENISE K. ZAWADA
Resident of LAKE County, Indiana.

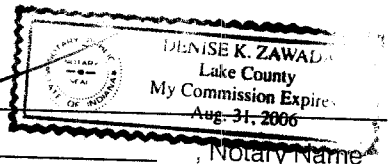

This instrument prepared by MARK S. LUCAS Attorney at Law

Return deed to 1820 Protsman Drive, Schererville, Indiana 46375

Send tax bills to 1820 Protsman Drive, Schererville, Indiana 46375

DULY ENTERED FOR TAXATION SUBJECT TO FINAL ACCEPTANCE FOR TRANSFER

JUN - 8 2005

STEPHEN R. STIGLICH
LAKE COUNTY AUDITOR

TICOR - SCHERERVILLE

00713

14-
ZP
TI