

STATE OF INDIANA
LAKE COUNTY
FILED FOR RECORD

2005 045764

2005 JUN -3 PM 1:21

MICHAEL A. BROWN
RECORDER

QUIT CLAIM DEED

This Indenture Witnesseth, That Adrian Lemus
of Lake County, in the State of Indiana Release and Quit-Claim to
María del Rosario Lemus of Lake County, in
the State of Indiana, for and in consideration of _____

Dollars, and other valuable consideration, the receipt and sufficiency of which is hereby acknowledged, the following
described *Real Estate* in Lake County in the State of Indiana to
wit:

Lots numbered six (6) and seven (7), excepting the
north 5 feet of lot no. seven (7), as marked
and laid down on the recorded plat of learning's
addition to Hammond, IN, Lake County, Indiana, as
the same appears of record in plat book 15,
page 20, in the recorder's office of Lake County,
Indiana. KEY # 26-34-0274-0005
Commonly known as: 6438 Madison, Hammond, IN 46324

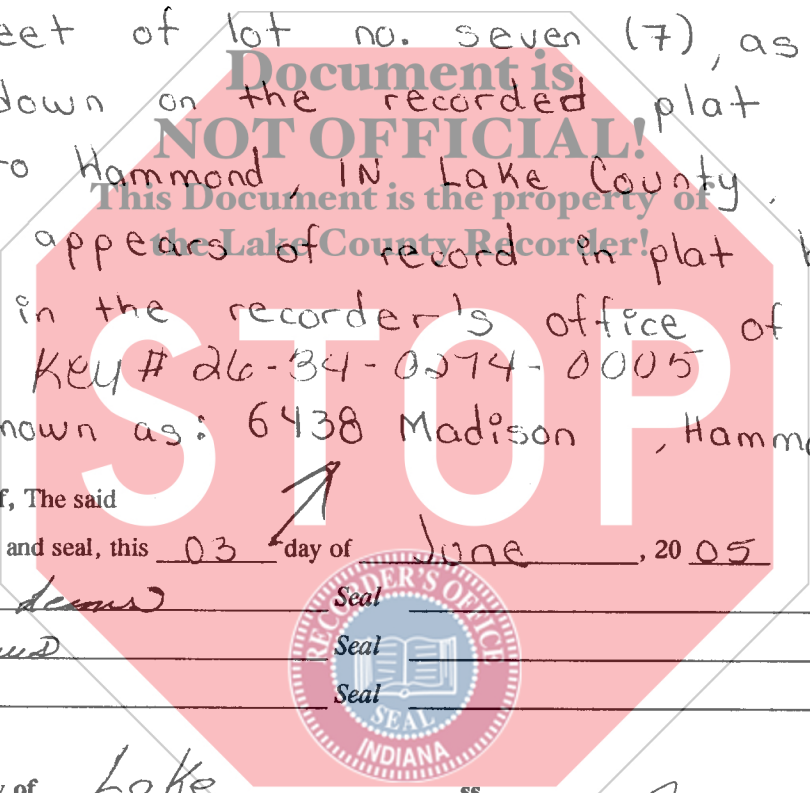

In Witness Whereof, The said
ha María del R. Lemus hereunto set hand and seal, this 03 day of June, 20 05

Adrian Lemus Seal Seal Seal
Seal Seal Seal

State of Indiana, County of Lake, ss

Before me, the undersigned, a Notary Public in and for said County this date June 3, 20 05
came, Adrian Lemus + María del Rosario Lemus and acknowledged the execution of
the foregoing Quit Claim Deed.

Witness my hand and official seal.

My commission expires _____, Notary Public
JENNIFER S. POPKA
Notary Public - State of Indiana
Lake County
My Commission Exp. Nov. 30, 2012

County of Residence Lake Jennifer S Popka (Printed)

This instrument prepared by: María del R Lemus Resident of Lake County



Form # 163

Jurisprudence Forms, LTD., P.O. Box 3222, Munster, IN 46321

Consult a lawyer if you doubt this form's fitness for your purpose and use. Jurisprudence, LTD., makes no representation or warranty, expressed or implied, with respect to the merchantability or fitness of this form for an intended use.

DOCUMENT FOR TAXATION SUBJECT TO
FINAL ACCEPTANCE FOR TRANSFER

JUN - 3 2005

000420

STEPHEN R. STIGLICH
LAKE COUNTY AUDITOR

14.00
08
CP