

2

STATE OF INDIANA  
LAKE COUNTY  
FILED FOR RECORD

# Quitclaim Deed

2005.045.138

2005 JUN -2 AM 11:10

Tax mail  
2428 Prospect Ave.  
Gary, IN  
46407

MICHAEL J. ...  
REC'D 20 05

THIS QUITCLAIM DEED, executed this 2nd day of June  
by first party, Grantor, Katherine Roby  
whose post office address is 2428 Prospect Ave Gary Ind  
to second party, Grantee, Larry G. Roby Sr, AKA Larry G. Roby  
whose post office address is 2253 Gary Indiana 46409

WITNESSETH, That the said first party, for good consideration and for the sum of five  
Dollars (\$ 5.00 )

paid by the said second party, the receipt whereof is hereby acknowledged, does hereby remise, release and quitclaim unto the  
said second party forever, all the right, title, interest and claim which the said first party has in and to the following described  
parcel of land, and improvements and appurtenances thereto in the County of Lake  
State of Indiana to wit:

Oak Park Add. 18. & B1. 11  
2428 Prospect Ave. Gary, Ind. 46409  
Key Number 25-46-139-8

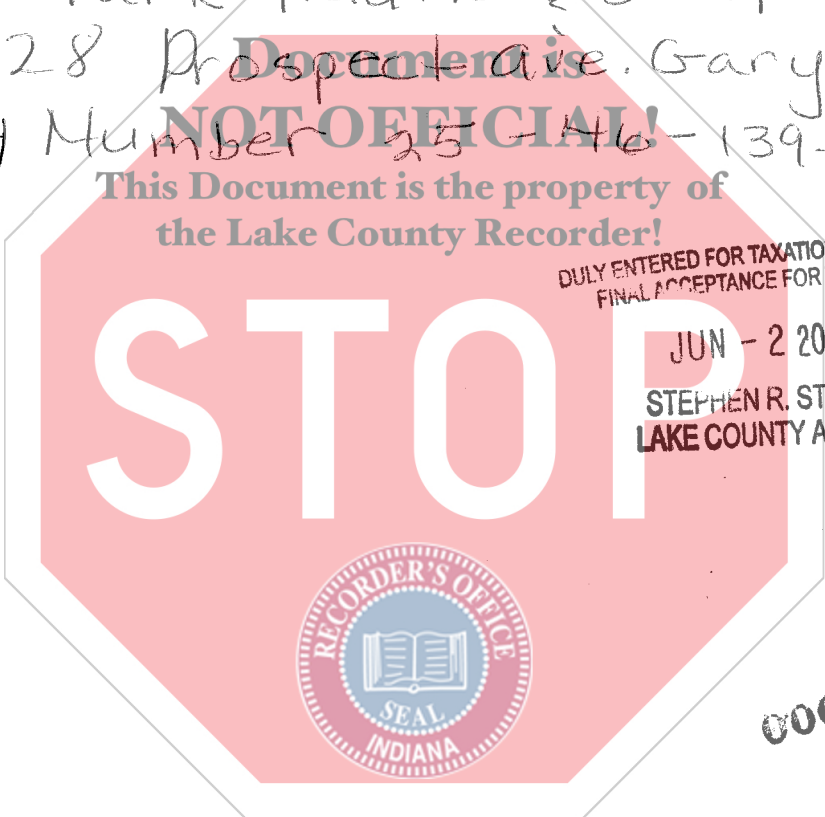

000251

Larry G. Roby Sr.  
Roby 2253 Gary 46409

1700  
03  
08

**IN WITNESS WHEREOF**, The said first party has signed and sealed these presents the day and year first above written. Signed, sealed and delivered in presence of:

Signature of Witness: Anita Simpson

Print name of Witness: Anita Simpson

Signature of Witness: Regina Adams

Print name of Witness: Regina Adams

Signature of First Party: Katherine Roby

Print name of First Party: Katherine Roby

Signature of Second Party: Larry G. Roby SR AKA Larry G. Roby

Print name of Second Party: Larry G. Roby SR AKA Larry G. Roby

Signature of Preparer: Larry G. Roby SR AKA Larry G. Roby

Print Name of Preparer: \_\_\_\_\_

Address of Preparer: \_\_\_\_\_

State of INDIANA  
County of LAKE

On July 2, 2009 before me, Mary G. Harris  
appeared Larry G. Roby

personally known to me (or proved to me on the basis of satisfactory evidence) to be the person(s) whose name(s) is/are subscribed to the within instrument and acknowledged to me that he/she/they executed the same in his/her/their authorized capacity(ies), and that by his/her/their signature(s) on the instrument the person(s), or the entity upon behalf of which the person(s) acted, executed the instrument.

WITNESS my hand and official seal.

Mary G. Harris  
Signature of Notary

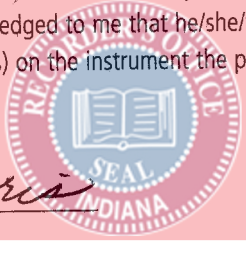

Affiant \_\_\_\_\_ Known \_\_\_\_\_ Produced ID \_\_\_\_\_  
Type of ID \_\_\_\_\_  
(Seal)

**MARY G. HARRIS**  
Notary Public, State of Indiana  
County of Lake  
My Commission Expires Mar 20, 2009