

STATE OF INDIANA  
LAKE COUNTY  
FILED FOR RECORD

P.O. Box 2155  
GARY, IN 46409

2005 044543

2005 JUN -1 AM 10:10

**SHERIFF'S DEED**

NAC-1078405

14-20-0102-0013

THIS INDENTURE WITNESSETH that John Buncich, Sheriff of Lake County, Indiana, conveys to Bank Coluemet Trust P4274 ("Purchaser"), in consideration of the sum of \$ 34,851.00 on sale made by virtue of an *Agreed and Default Judgment* of the Lake Circuit Court on February 12, 2001, in Cause No. 45C01-0010-CP-01416, wherein First Indiana Bank was Plaintiff and Larry C. Harper, Tonya M. Harper, The Cadle Company II, Inc. and Coast Partners Acceptance Corp. were Defendants, the fee simple of Real Estate located in Lake County, Indiana, more particularly described as follows:

Lot 13 in Block 5 in Rothermel's subdivision, in the City of Lake Station, as per plat thereof, recorded in Plat Book 20, page 5, in the Office of the Recorder of Lake County, Indiana.

K# 14-20-0102-0013

Commonly known as 2777 Jasper Street, Lake Station, Indiana 46405.

With the privileges and appurtenances to Purchaser, its grantees and assigns forever, in full and ample manner, with all rights, title and interests held or claimed by the aforesaid Defendants.

IN WITNESS WHEREOF, I, John Buncich, the undersigned Sheriff, have hereunto set my hand and seal this 1st day of June, 2001.

  
John Buncich  
Sheriff of Lake County

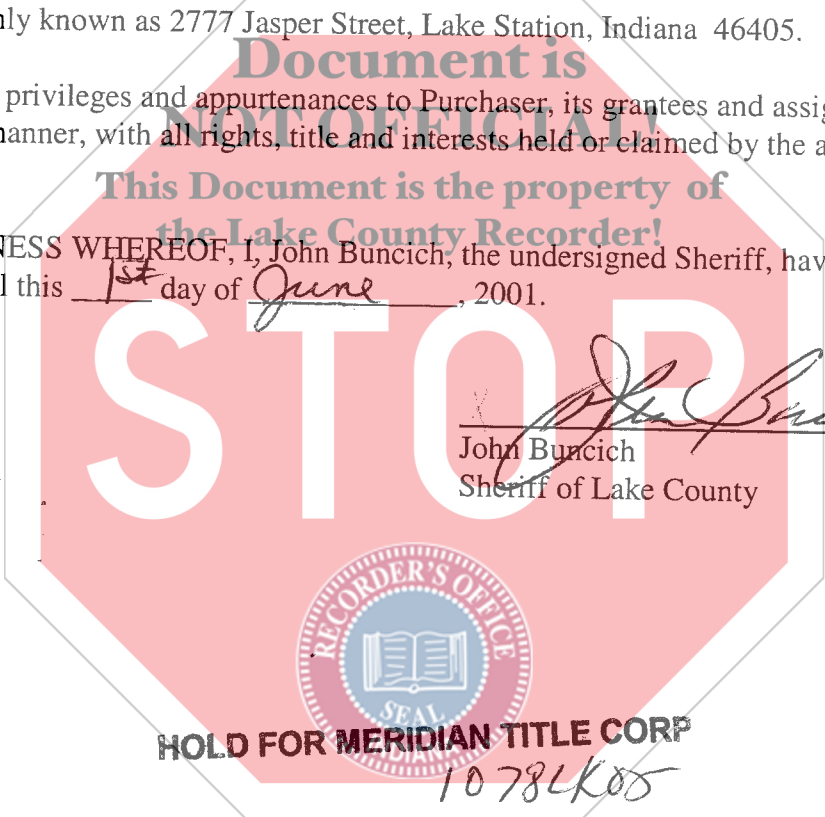

335215/maw (2-3683)

DULY ENTERED FOR TAXATION SUBJECT TO  
FINAL ACCEPTANCE FOR TRANSFER

JUN - 1 2005

STEPHEN R. STIGLICH  
LAKE COUNTY AUDITOR

00068

17-  
2P  
MT

STATE OF INDIANA )  
 ) SS:  
COUNTY OF LAKE )

On June 1st, 2001, before me a Notary Public, personally appeared John Buncich, Sheriff of Lake, Indiana, who acknowledged execution of the foregoing Sheriff's Deed.

Mary Ann Torres  
Notary Public

MARY ANN TORRES  
(Printed)

My Commission Expires:

April 5, 2001

County of Residence

Lake

This instrument prepared

**This Document is the property of  
the Lake County Recorder!**

SEND TAX STATEMENTS TO:

\_\_\_\_\_  
\_\_\_\_\_  
\_\_\_\_\_

